

B.M. 123.54 City Standard on S.W. corner 17th & Meridian.

NOTE: Contractor to clear right-of-way and grade parkings for proposed sidewalk. Sidewalk to be constructed by others.

B.M. 123.86 R.R. Spike E. side Bell Pole on W. side Meridian Sta. G+32

Scale: 1" = 20'

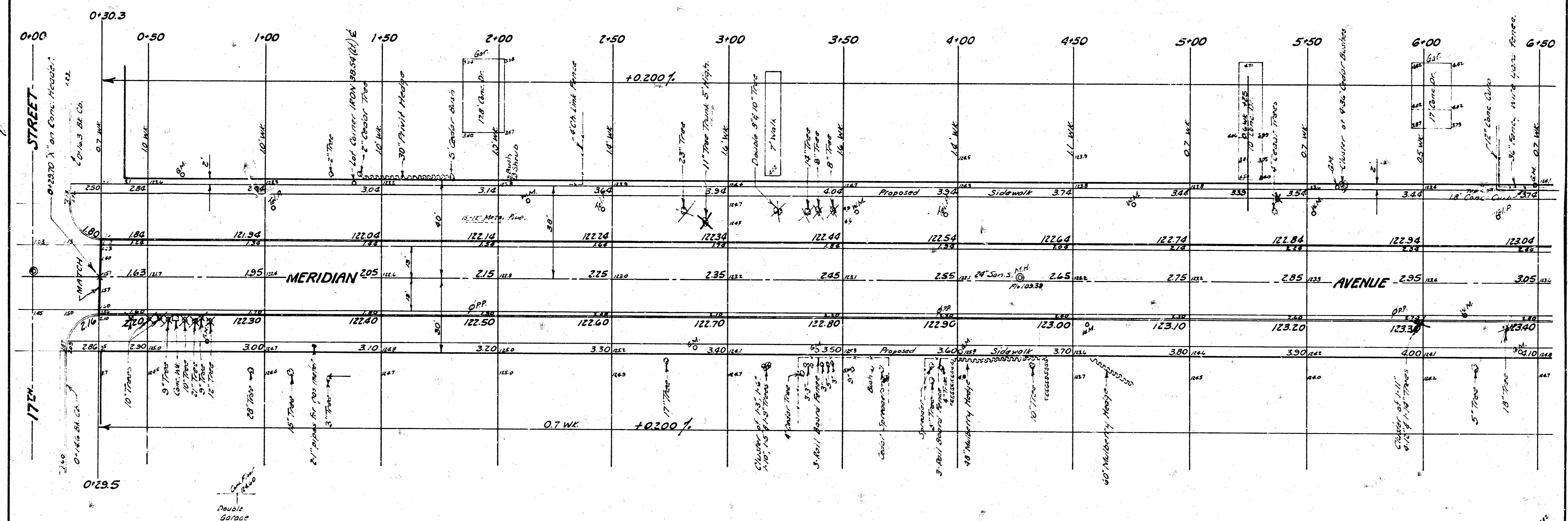

Surveyed by J.A. B. 1950
 City Engineer
 Checked by J.A. B.

EXCAVATION	
PROPERTY	CITY
3411 Cu. Yds.	6 Cu. Yds.
1106 341	1
Total 3752 Cu. Yds.	7 Cu. Yds.

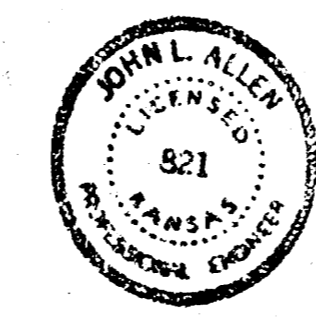

MERIDIAN AVENUE
 FROM N.L. 17th STREET
 to & INCLUDE CUL-DE-SAC
 26'-2'-30" Asph. Conc.
 B.E. SMITH CITY ENGINEER
 CITY OF WICHITA, KANSAS
 Date: OCT. 1957
 Project No. C17-54

1/4

