

B.M. 10.74 Standard W.M. Harry of Meridian
 B.M. 10.75 " " " " Top of US Sedgwick @ W. Merton.
 All measurements are R.L. of Lt. from E.

SCALE 1"=20'

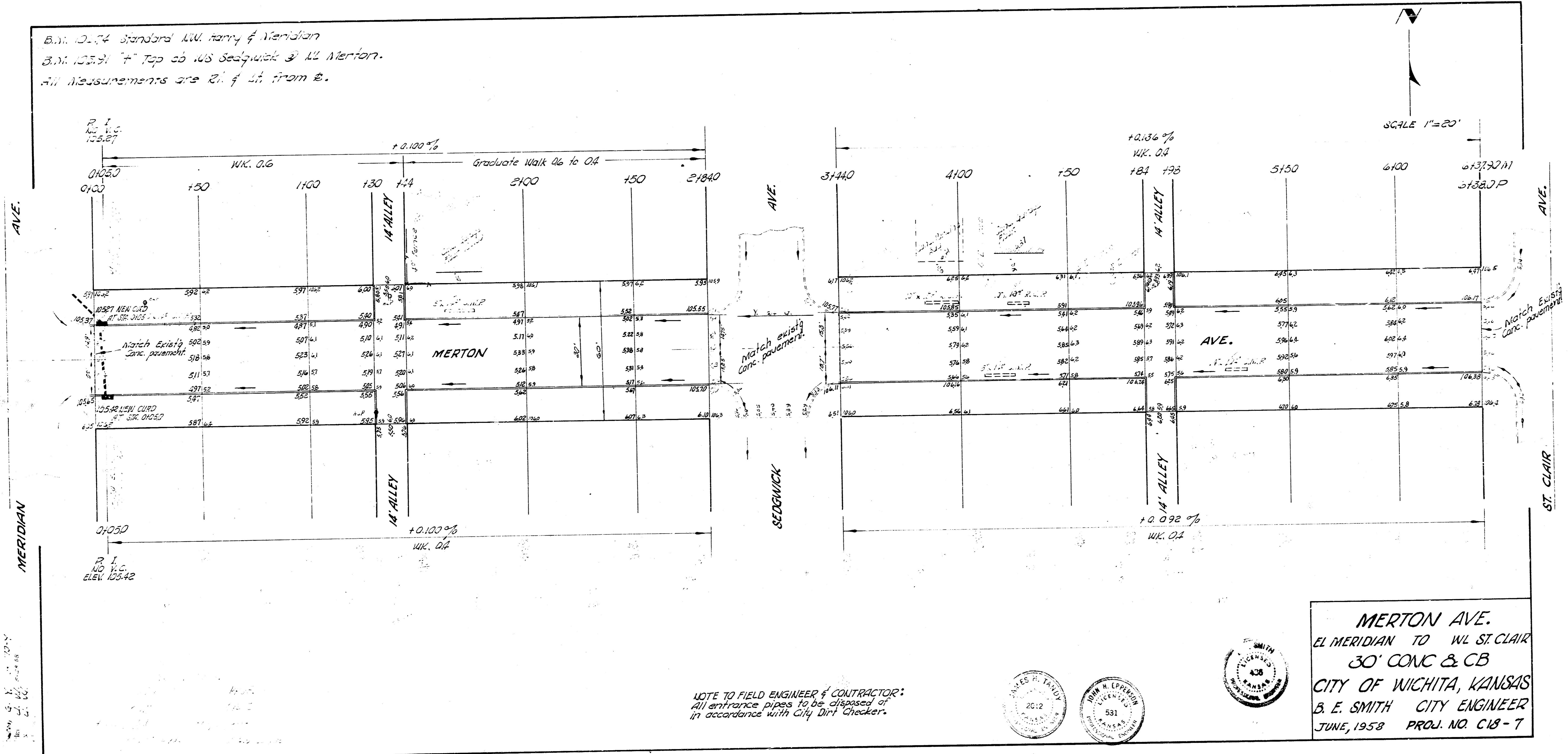

NOTE TO FIELD ENGINEER & CONTRACTOR:
 All entrance pipes to be disposed of
 in accordance with City Dirt Checker.

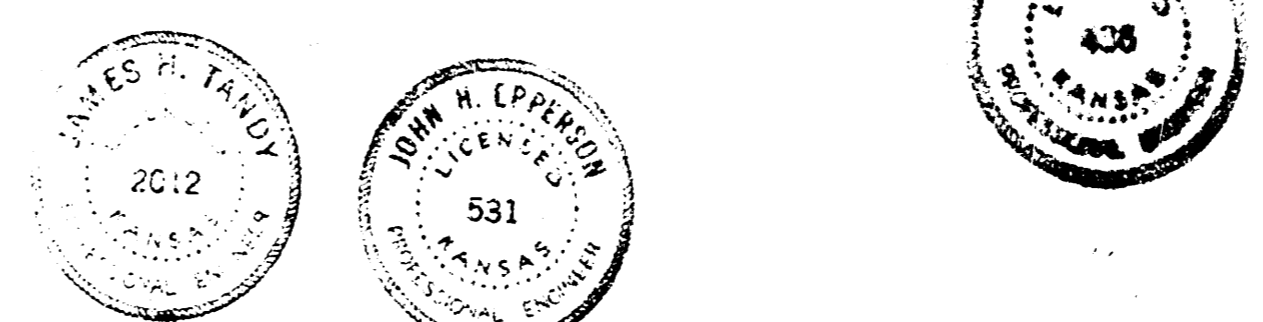

MERTON AVE.
 EL MERIDIAN TO WL ST. CLAIR
 30' CONC & CB
 CITY OF WICHITA, KANSAS
 B. E. SMITH CITY ENGINEER
 JUNE, 1958 PROJ. NO. C18-7