

BM-- 94.53 NW cor conc patch Ho# 1625 Webster.

BM-- 95.38 SW cor conc patch Ho# 5320 Millwood

Chaining N on East Property Lines.

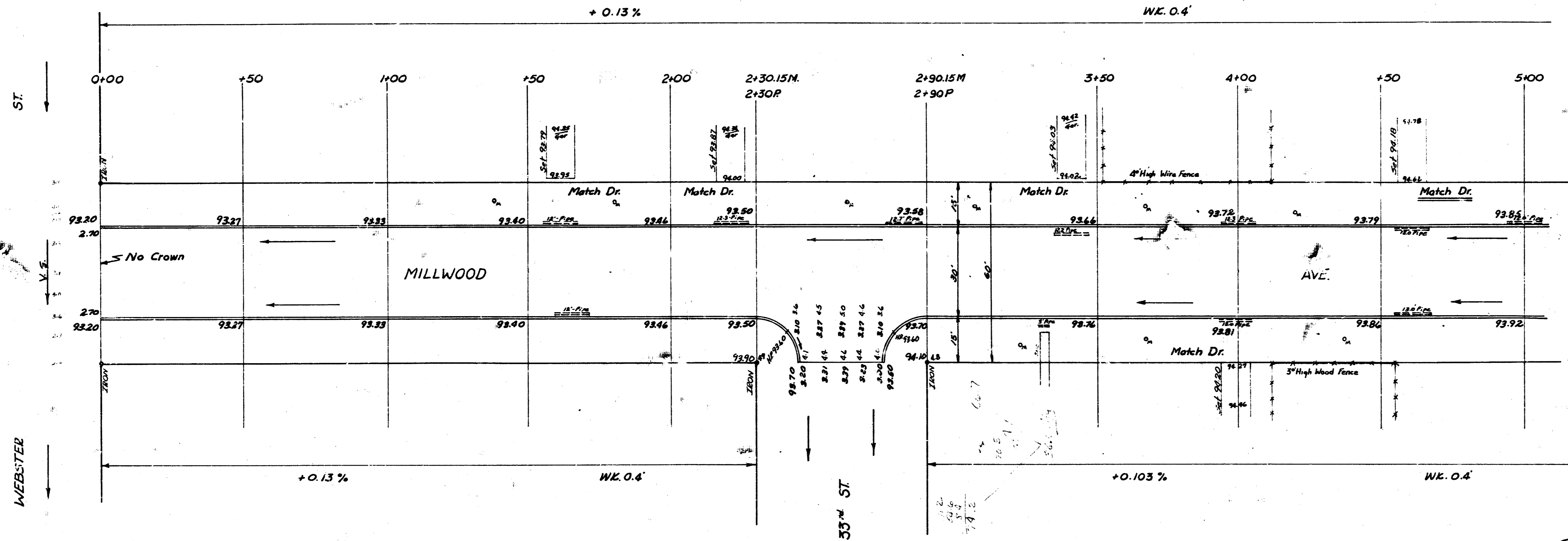

Surveyed by JAL:17
 Checked by [unclear]
 Date [unclear]

NOTICE TO CONTRACTOR:-
 All entrance pipes to be disposed of in accordance with Dirt Checker's instructions.

1
6

MILLWOOD AVE.
 NL Webster SL 31" St.
 30" Conc & Cb.
 CITY OF WICHITA, KANSAS
 B.E. SMITH CITY ENGINEER
 MAY 1956 PROJ NO C16-2B



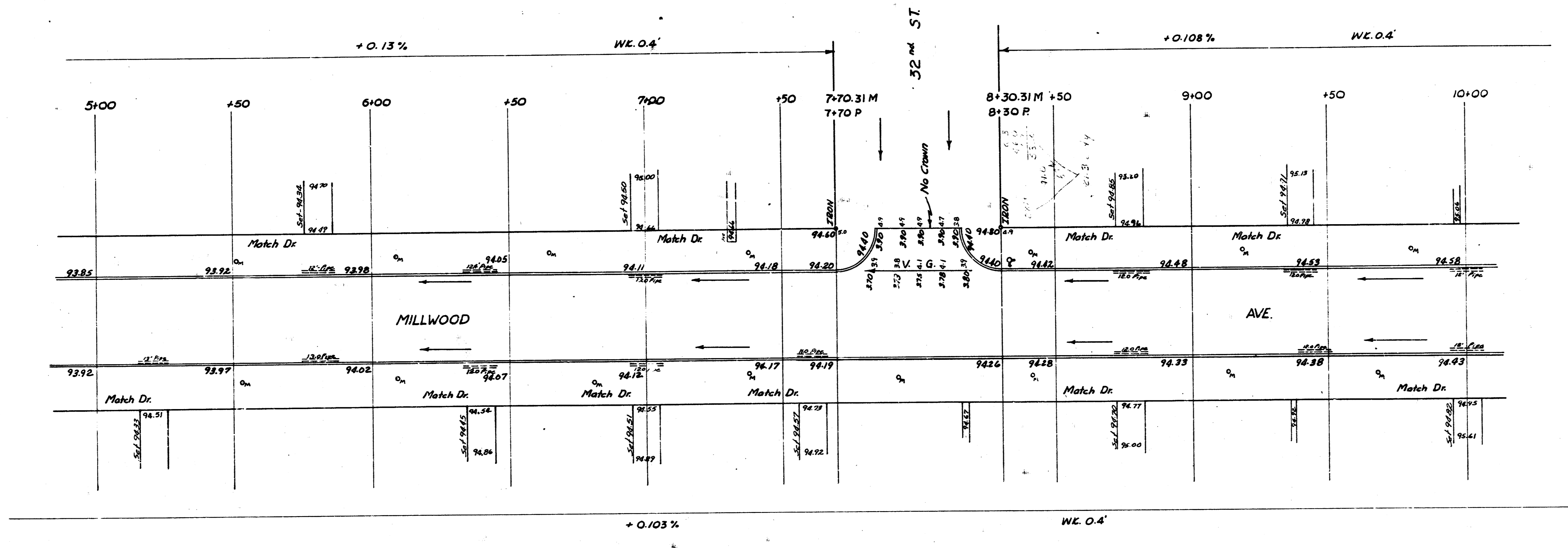
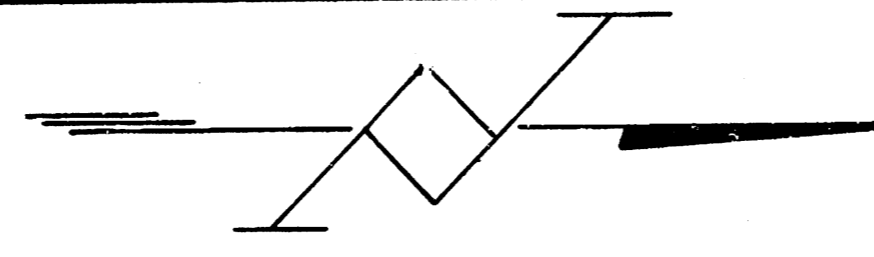

2
6

MILLWOOD AVE.
NL Webster to SL 31st St.
PROJ NO C16-28

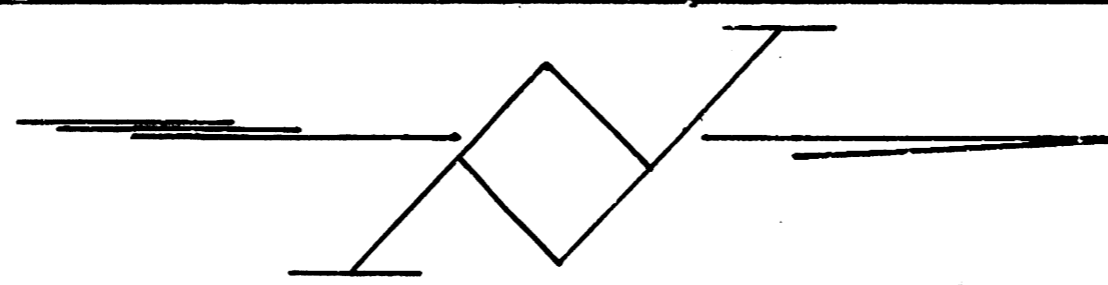

BM - 96.64 + " on E end N handrail R.C.D. @ 31st & Glenn.
 BM - 96.37 NW cor conc. patch to #1627 W 31st St. S.

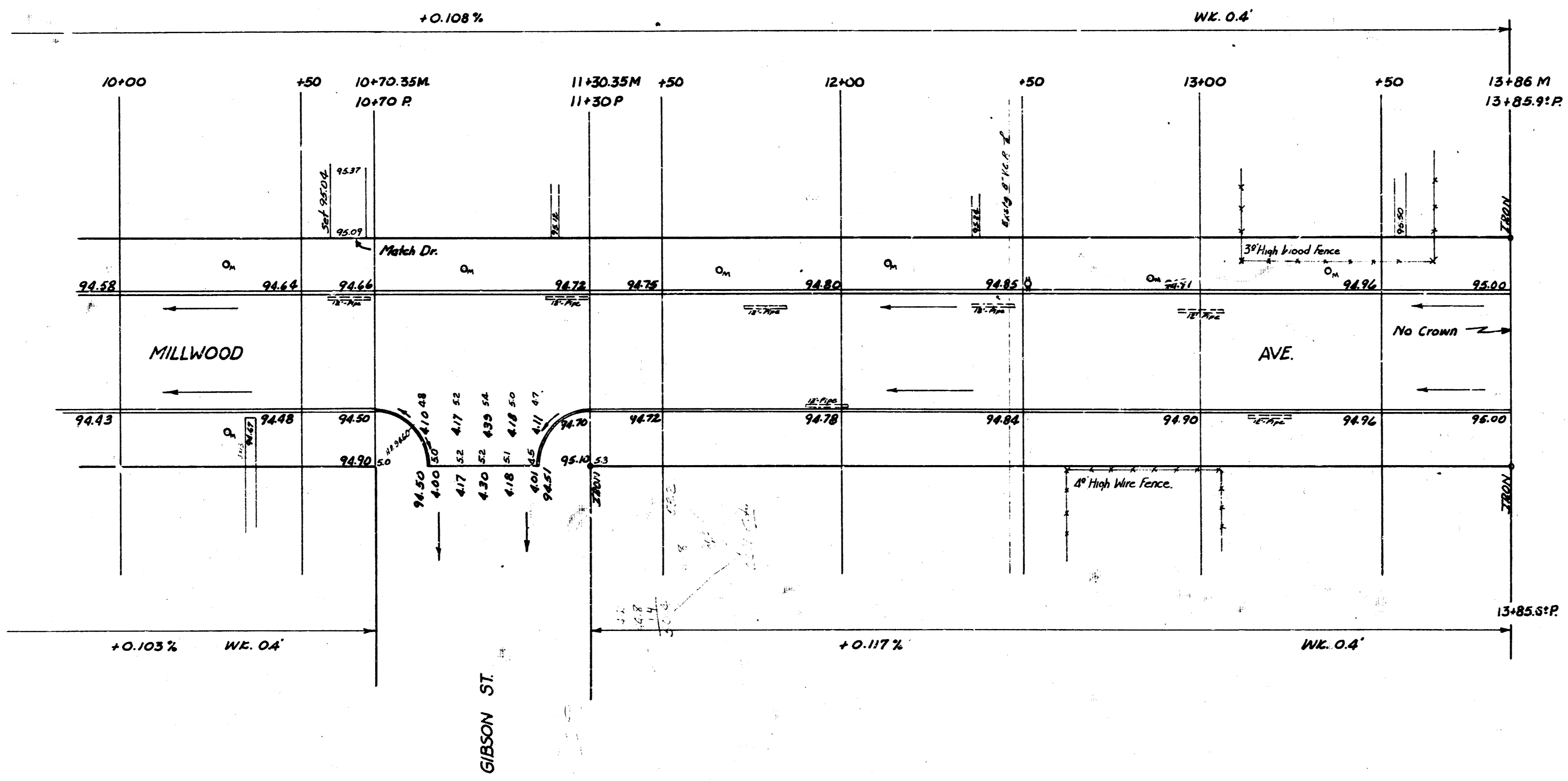

ST
 V.G.
 31st

3
 6

MILLWOOD AVE.
 NL Webster to SL 31st St.
 Proj No C16-28