

B.M. 108.01 "G" IN GLOBE E. END RAD. S.E. COR. EDWARDS & WHEELER
 B.M. 10776 "G" IN GLOBE W. END RAD. S.W. COR. MONROE & RICHMOND
 BASE LINE ON e

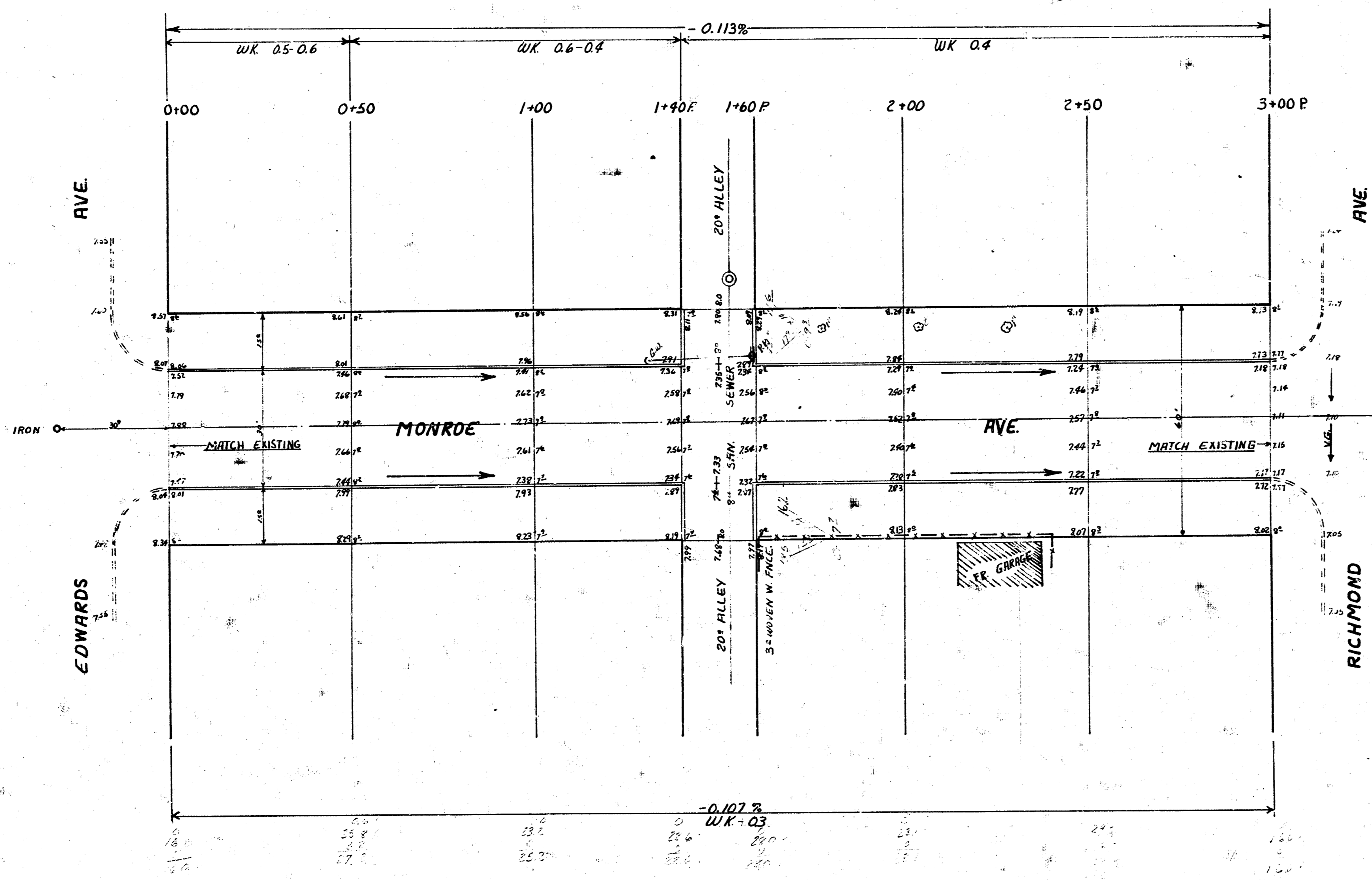

REV. RIGGS REF. 3-25-59
 KNIGHT 3-25-59
 10-27-59

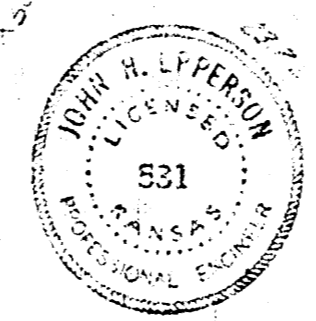
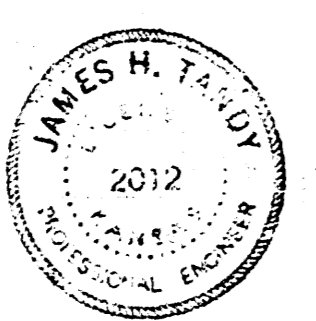

TOTAL EXCH.
 PROR. CITY
 256.2 367
 100 264 100 264
 356.2 471

MONROE AVE.
 E.L. EDWARDS W.L. RICHMOND
 30' CONC. & CB.
 CITY OF WICHITA, KANSAS
 B.E. SMITH CITY ENGINEER
 DATE APRIL 1959 PROJ. No. C19-23