

THE MOORINGS
PROJECT NO. 472-76-245-80603-000-000-001

KEYWEST-W.L. BLOCK I TO THE W.L. COBBLESTONE
 KEYWEST COURT - ADJ. TO LOTS 1 THRU 6 IN BLOCK I- S.L. KEYWEST TO
 AND INCL. CUL-DE-SAC
 KEYWEST COURT - ADJ. TO LOTS 8 THRU 19 IN BLOCK I- S.L. KEYWEST TO
 AND INCL. CUL-DE-SAC

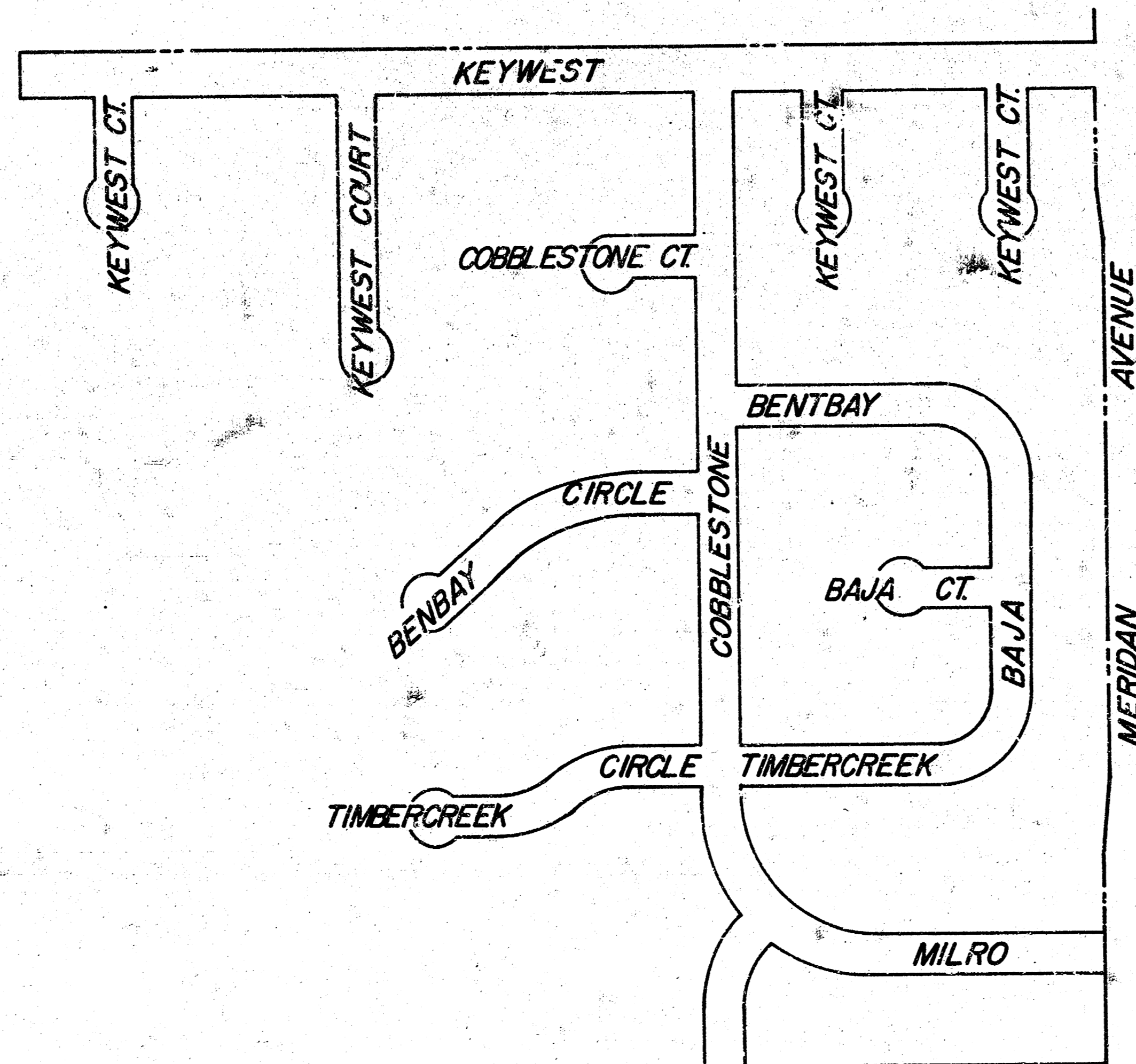

CITY of WICHITA
 DEAN SELLERS-ACTING CITY ENGINEER
 1980

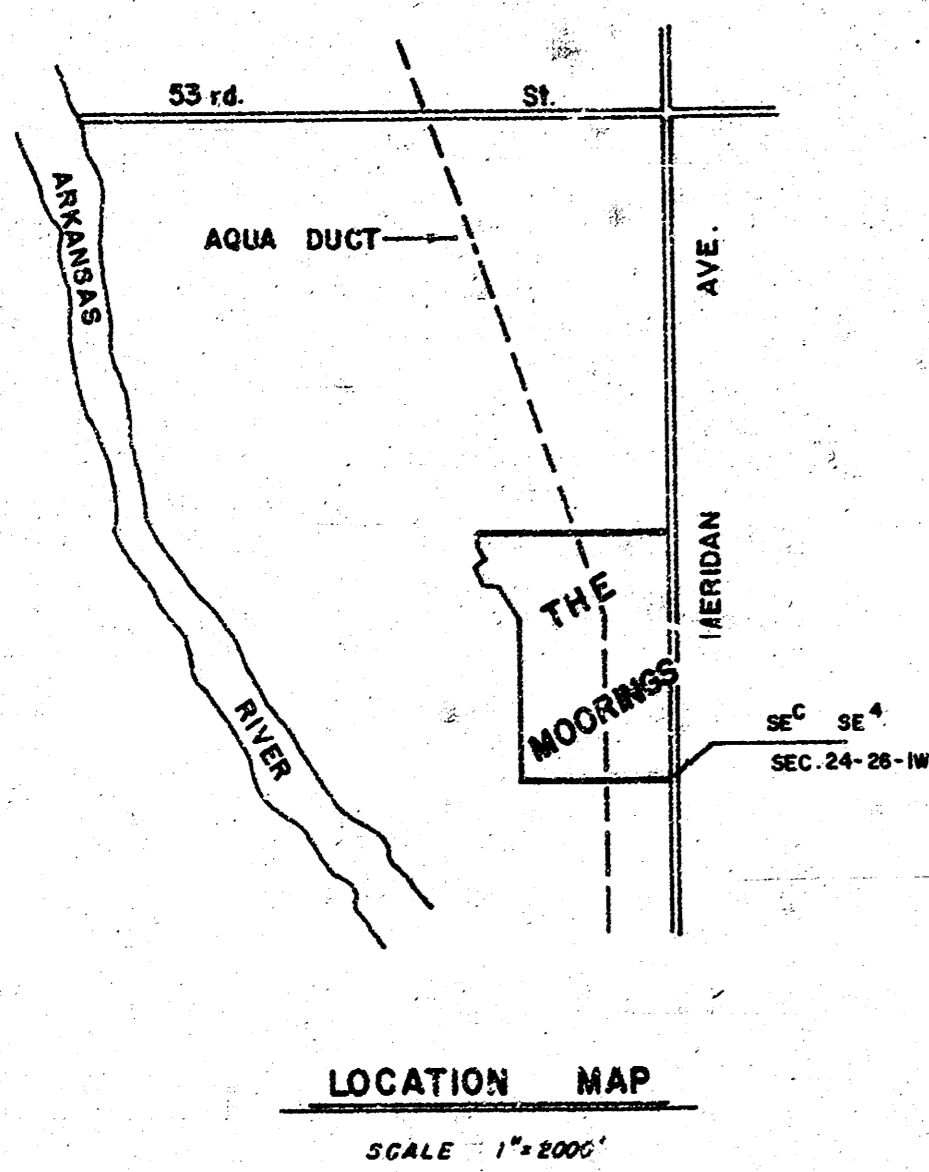
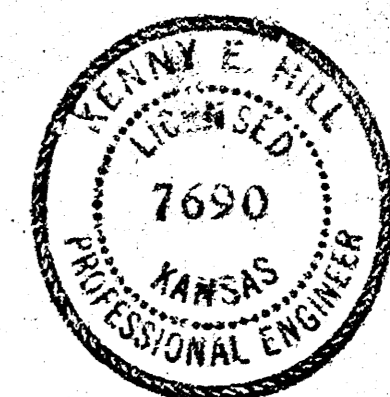

B.M. 141.07 "□" In S. Headwall, Culvert at 45th St. N and Meridian
 B.M. 142.46 Stepped Spike in Power Pole N. Side of Keywest, just E. of □ of Cobblestone

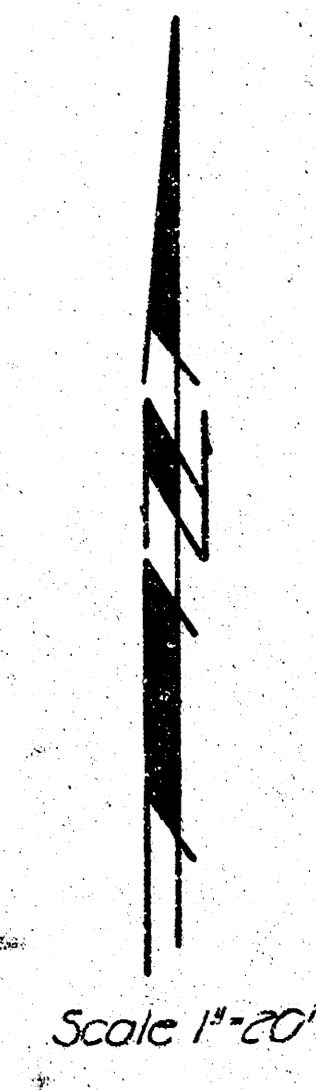
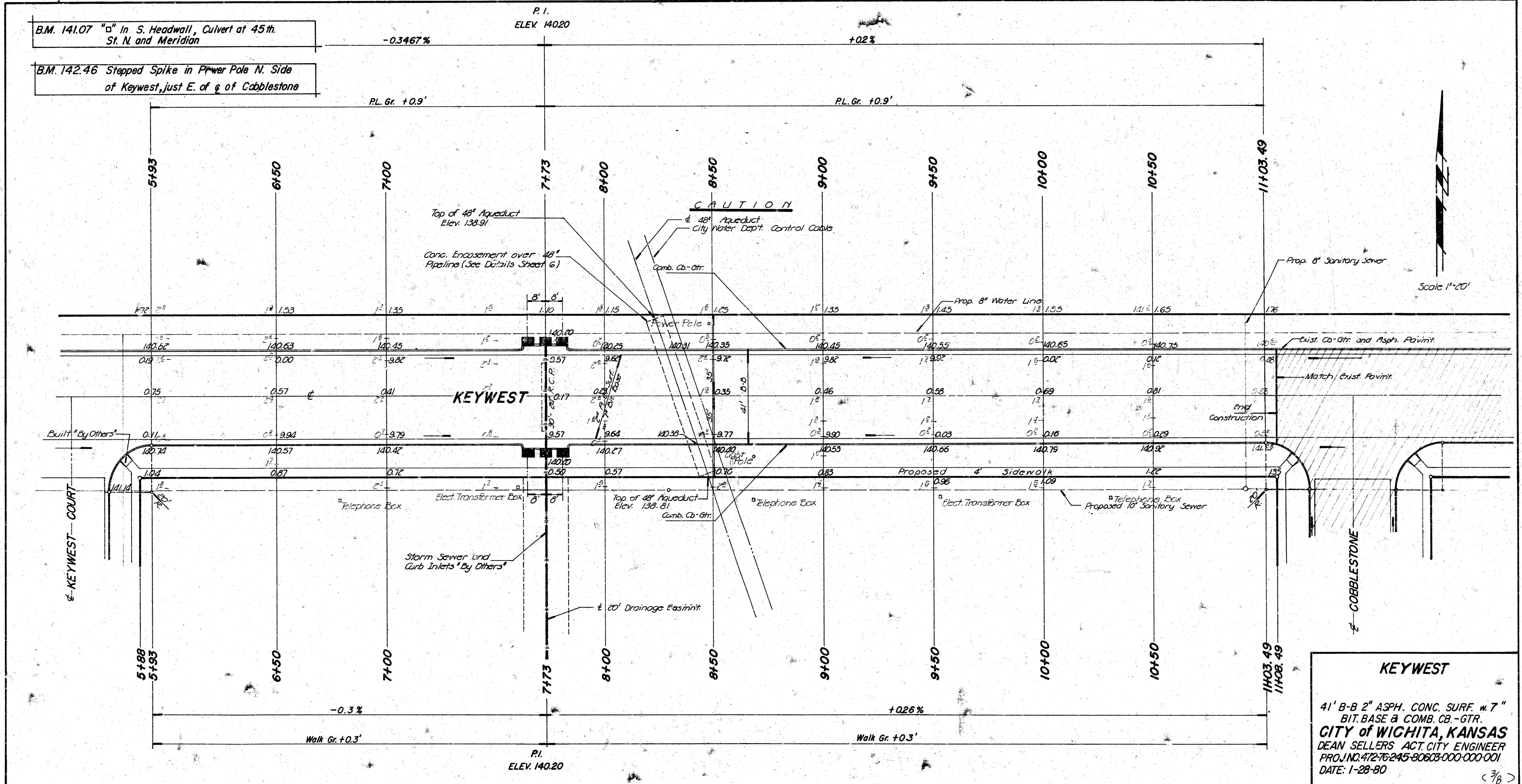

KEYWEST
 41' B-B 2" ASPH. CONC. SURF. w. 7" BIT. BASE & COMB. CB.-GTR.
CITY OF WICHITA, KANSAS
 DEAN SELLERS ACT. CITY ENGINEER
 PROJ. NO. 472-76-245-80603-000-001
 DATE: 1-28-80

3/8

B.M. 141.07 "□" in S. Headwall, Culvert at 45th. St N. and Meridian

B.M. 142.46 Stepped Spike in Power Pole N. Side of Keywest, just E. of e of Cobblestone

P.I.
ELEV. 142.02

PL. Gr. +0.3'
+0.3%

Scale 1"=20'

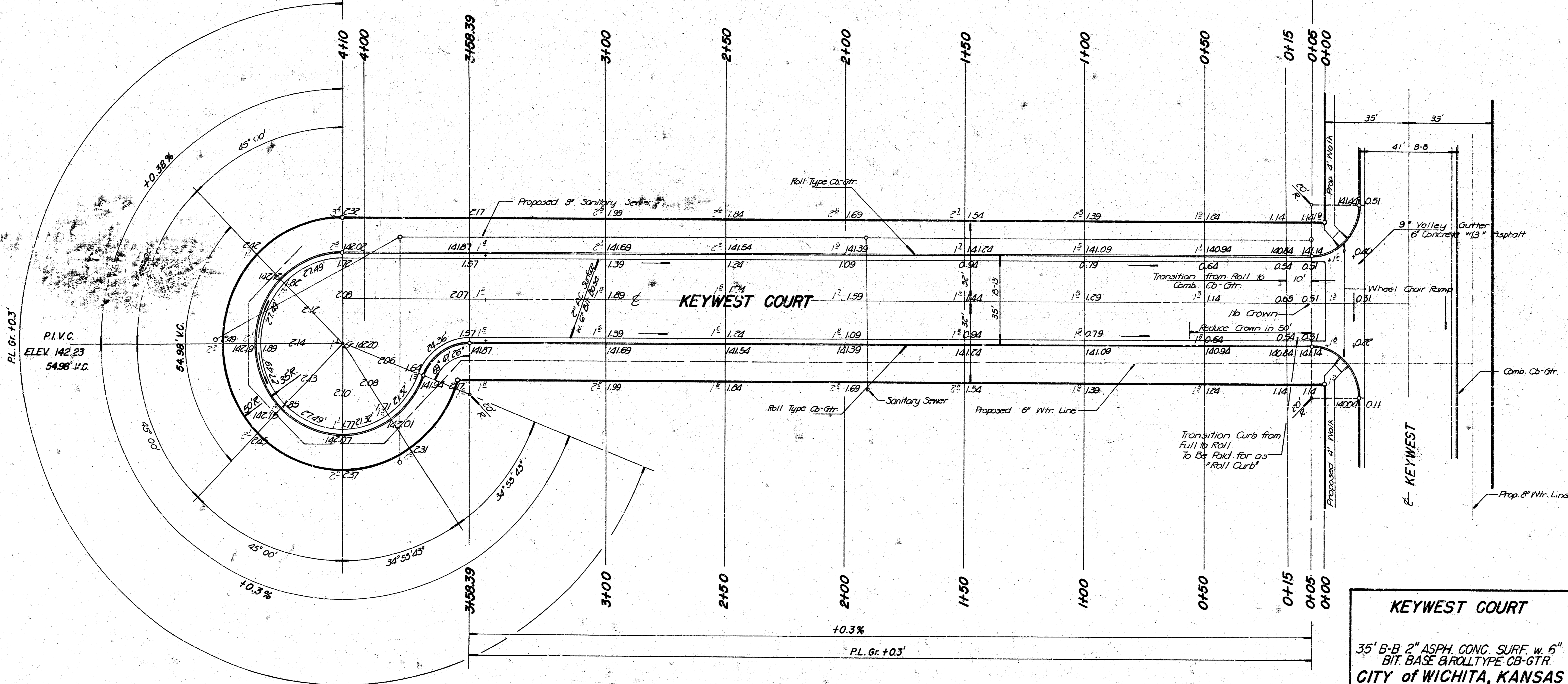

KEYWEST COURT

35' B-B 2" ASPH. CONG. SURF. w. 6" BIT. BASE & ROLLTYPE CB-GTR.
CITY OF WICHITA, KANSAS
DEAN SELLERS, ACT. CITY ENGINEER
PROJ. NO. 472-762-45-80603-000-000-00
DATE: 1-23-80

9/87

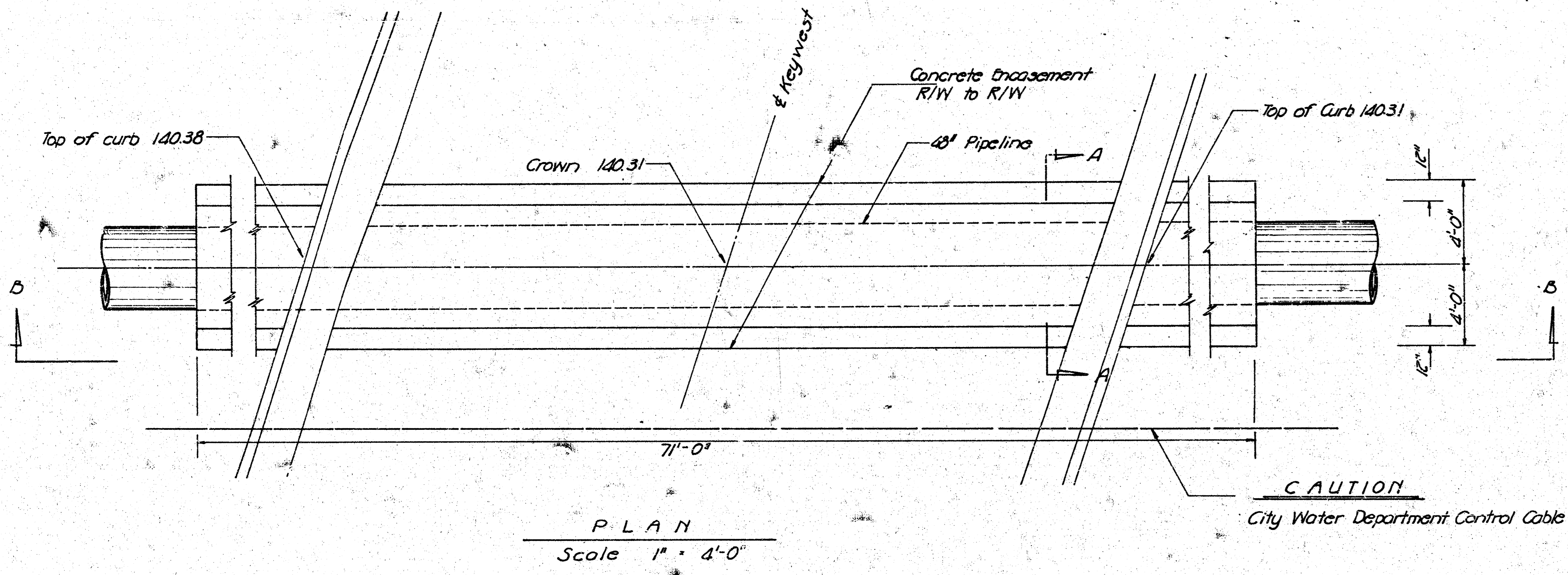

P L A N
Scale 1" = 4'-0"

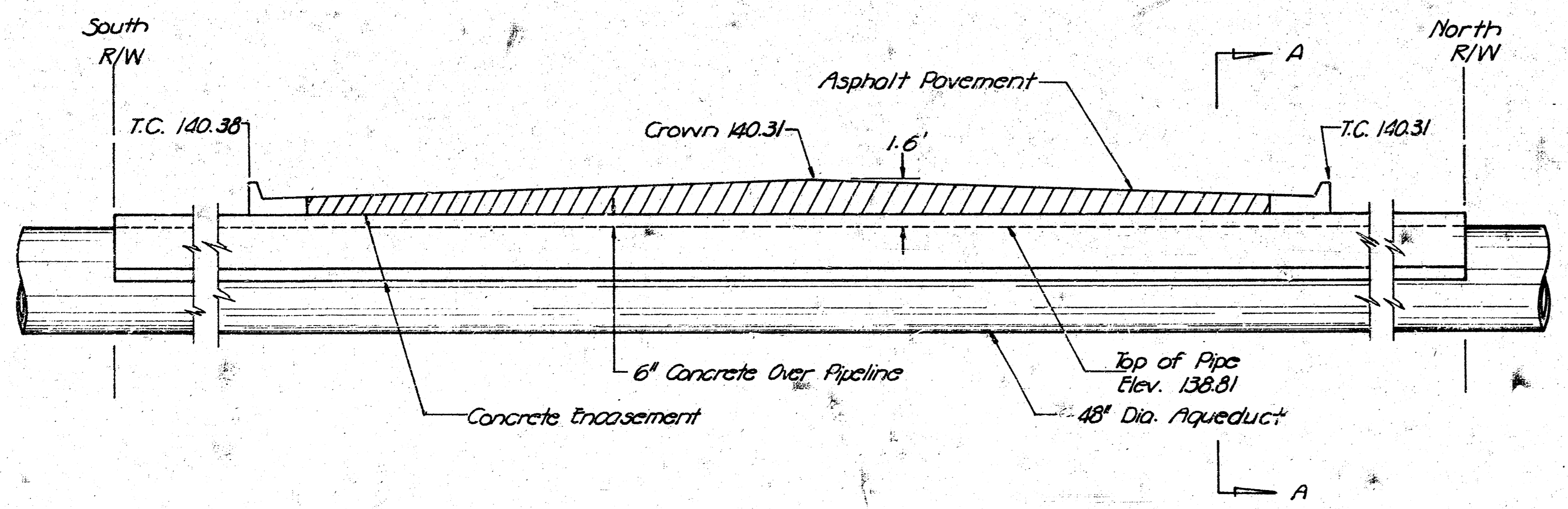

SECTION B - B
Scale 1" = 4'-0"



SECTION A - A
Scale 1" = 1'-0"

Volume of Concrete 26.9 Cu. Yds
Reinforcing Steel 36-#4 bars 20' long
140-#4 bars (vert)

CONCRETE ENCASEMENT
48" AQUEDUCT

CITY of WICHITA, KANSAS
DEAN SELLERS ACT CITY ENGINEER
PROJ. NO. 47276-245-80603-000-000-001
DATE: 1-28-80

c 4/8 D

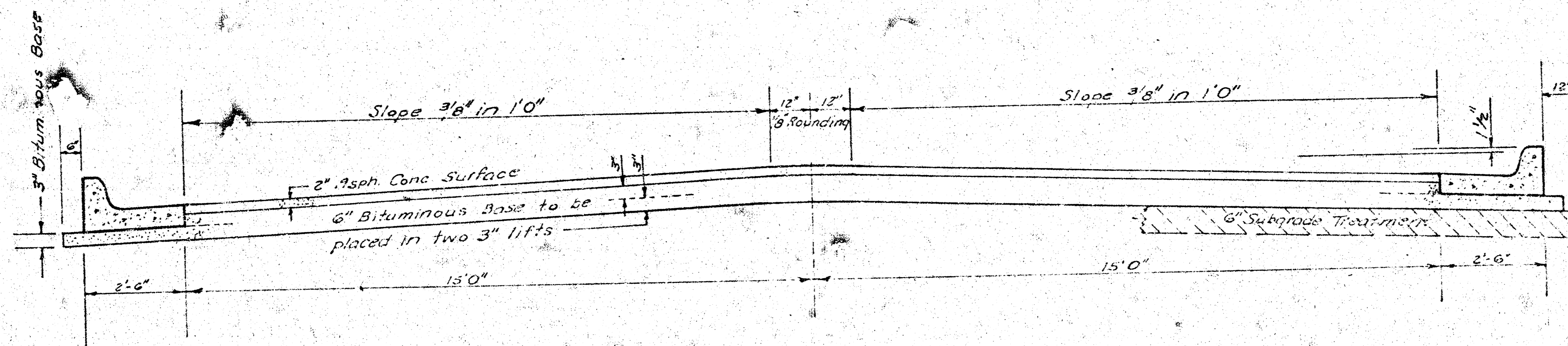

TYPICAL SECTION

35' ASPHALTIC CONCRETE PAVEMENT WITH BITUMINOUS BASE

*The A.C. Pavement between the curb & gutter shall be paid as Sq.Yds. 8" A.C. Pavement (6" Bituminous Base).
The Bituminous Base under the curb & gutter shall be paid as Sq.Yds. 3" Bituminous Base.*

A TACK COAT OF EMULSIFIER ASPHALT (SS-1H) SHALL BE APPLIED AT AN APPROXIMATE RATE 0.05 GALLONS PER SQ YD BETWEEN LIFTS OF ASPHALTIC MATERIALS WHEN ORDERED BY THE ENGINEER. TACK COAT WILL NOT BE PAID FOR DIRECTLY AND SHALL BE CONSIDERED AS SUBSIDIARY TO PRICE BID FOR ASPHALTIC PAVEMENT.
BITUMINOUS BASE AND ASPHALTIC CONCRETE WEARING SURFACE SHALL BE PLACED WITH A LAYDOWN MACHINE HAVING AUTOMATIC CONTROLS FOR CROWN AND GRADE. CONSTRUCTION JOINTS IN EACH LIFT SHALL BE STAGGERED A MINIMUM DISTANCE OF 1' WITH JOINTS IN PRECEDING LIFTS AND PLACED SUCH THAT A JOINT WILL BE CONSTRUCTED ON THE CENTERLINE IN THE TOP LIFT.

DETAIL OF TRANSVERSE CONSTRUCTION JOINTS

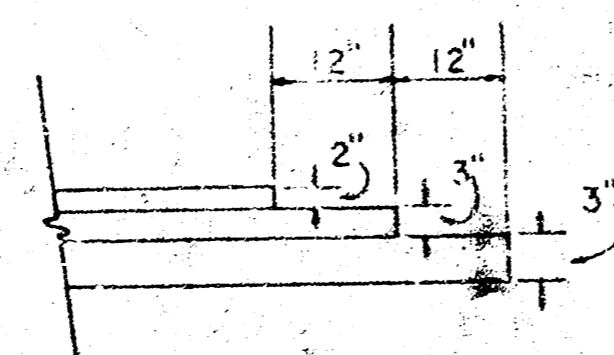

TRANSVERSE CONSTRUCTION JOINTS SHALL BE CONSTRUCTED IN FLEXIBLE BASE PAVEMENTS AT LOCATIONS WHERE PAVEMENT TEMPORARILY ENDS TO FACILITATE FUTURE PAVEMENT CONSTRUCTION AS SHOWN BY DETAIL. THE COST OF CONSTRUCTING THE TRANSVERSE CONSTRUCTION JOINTS SHALL NOT BE MEASURED OR PAID FOR DIRECTLY BUT SHALL BE INCLUDED IN THE BID PRICE FOR SQUARE YARDS OF ASPHALTIC CONCRETE PAVEMENT.

CONTINUED CURB & GUTTER

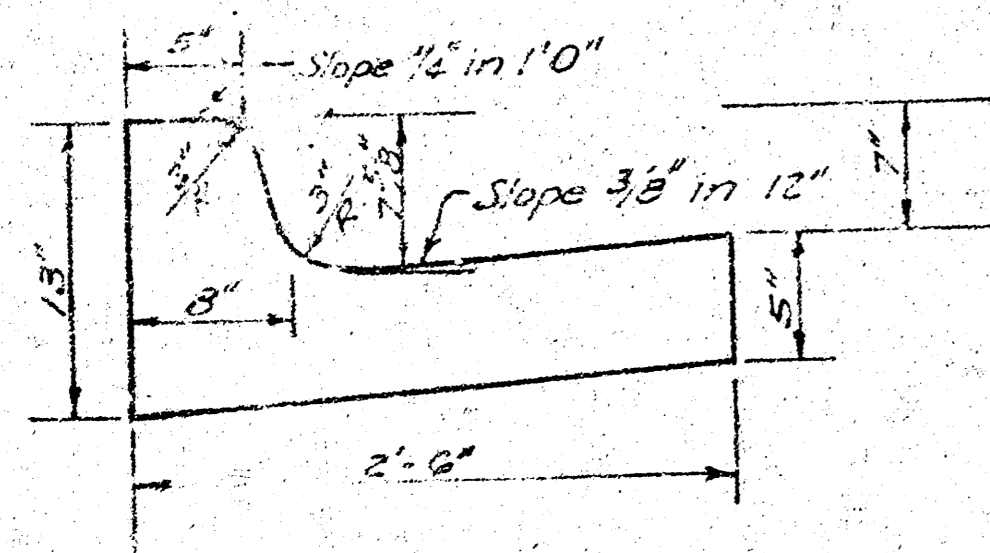

ROLL TYPE CURB & GUTTER

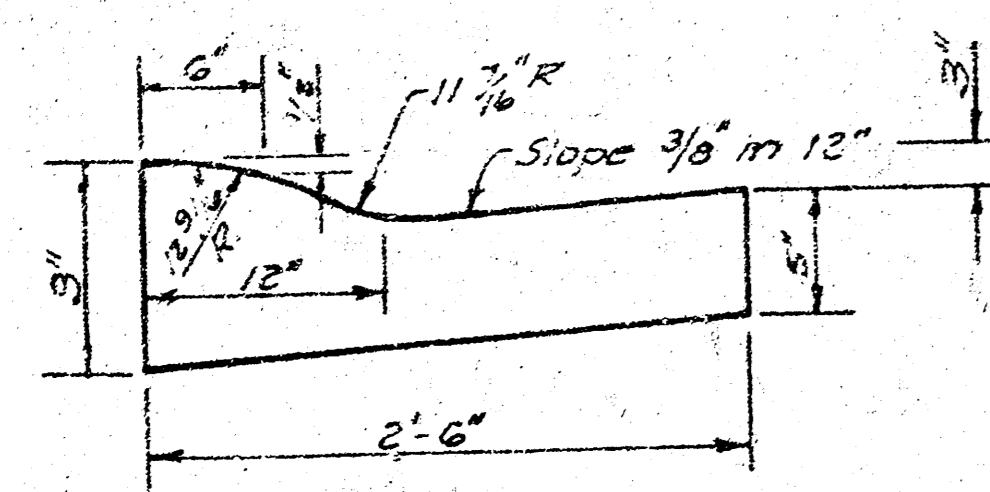

CITY OF WICHITA KANSAS

DEPARTMENT of PUBLIC WORKS - Engineering Division

DATE 1-28-80

Proj. No. 472-76-245-80603-000-000-001

(7/8)

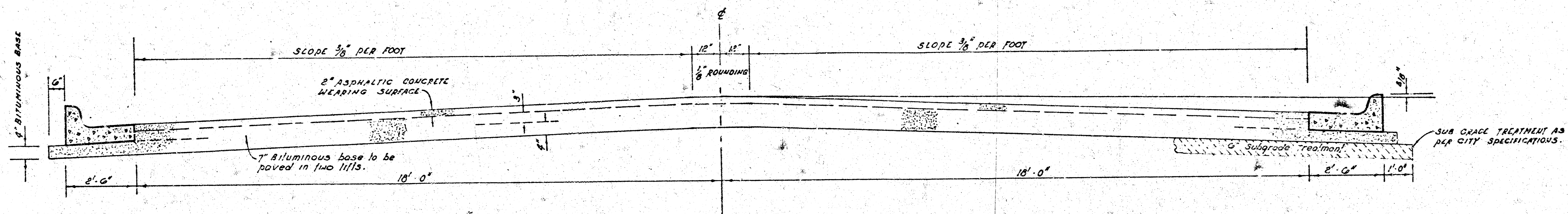

TYPICAL SECTION

4' ASPHALTIC CONCRETE PAVEMENT WITH BITUMINOUS BASE

The A.C. pavement between the curb & gutter shall be paid as 30 yds 9" A.C. pavement (1" Bituminous Base). The Bituminous Base under the curb & gutter shall be paid as 30 yds 9" Bituminous Base.

A TACK COAT OF EMULSIFIED ASPHALT (SS-1M) SHALL BE APPLIED AT AN APPROXIMATE RATE 0.05 GALLONS PER SQ YD BETWEEN LIFTS OF ASPHALTIC MATERIALS WHEN ORDERED BY THE ENGINEER. TACK COAT WILL NOT BE PAID FOR DIRECTLY AND SHALL BE CONSIDERED AS SUBSIDIARY TO PRICE BID FOR ASPHALTIC PAVEMENT. BITUMINOUS BASE AND ASPHALTIC CONCRETE WEARING SURFACE SHALL BE PLACED WITH A LAYDOWN MACHINE HAVING AUTOMATIC CONTROLS FOR CROWN AND GRADE. CONSTRUCTION JOINTS IN EACH LIFT SHALL BE STAGGERED A MINIMUM DISTANCE OF 1' WITH JOINTS IN PRECEDING LIFTS AND SUCH THAT A JOINT WILL BE CONSTRUCTED ON THE PAVEMENT CENTERLINE IN THE TOP LIFT.

COMBINED CURB & GUTTER

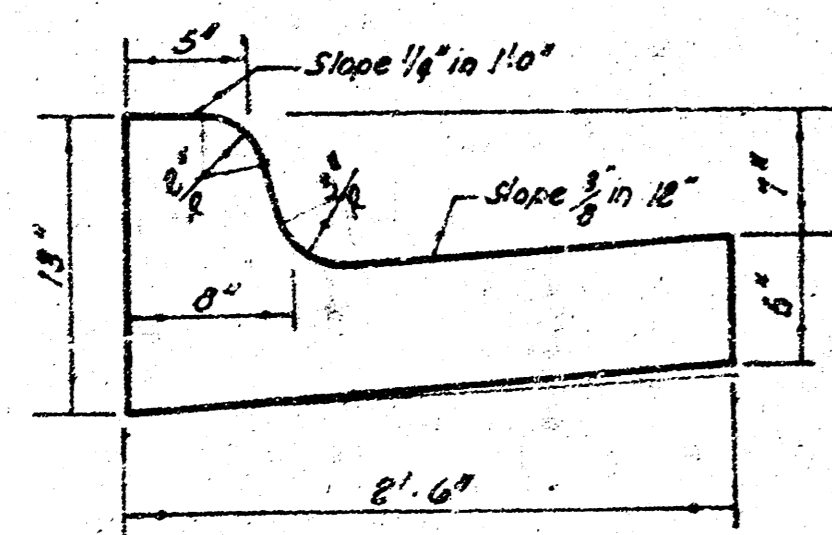

ROLL TYPE CURB & GUTTER

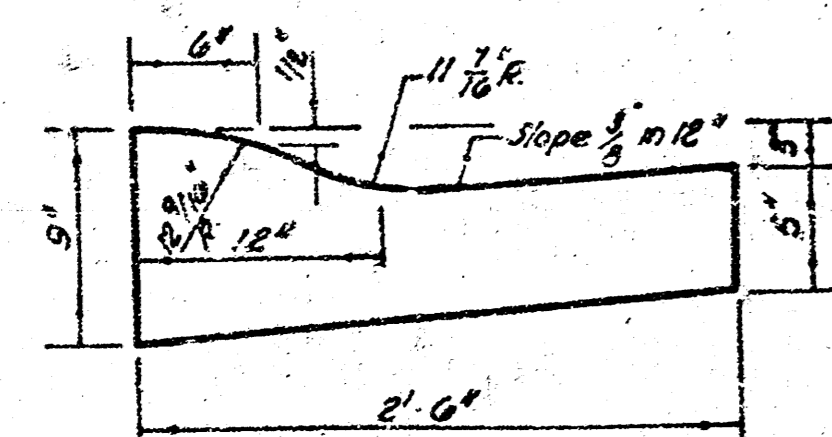

DETAIL OF TRANSVERSE CONSTRUCTION JOINTS

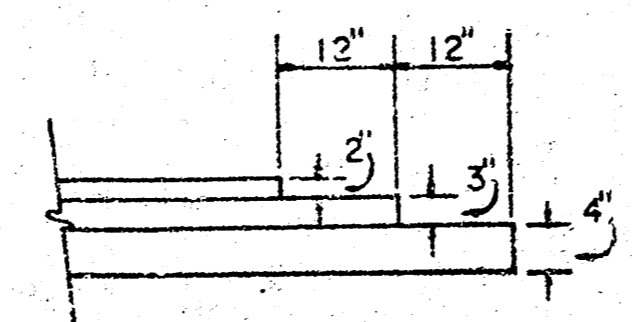

TRANSVERSE CONSTRUCTION JOINTS SHALL BE CONSTRUCTED IN FLEXIBLE BASE PAVEMENTS AT LOCATIONS WHERE PAVEMENT TEMPORARILY ENDS TO FACILITATE FUTURE PAVEMENT CONSTRUCTION AS SHOWN BY DETAIL. THE COST OF CONSTRUCTING THE TRANSVERSE CONSTRUCTION JOINTS SHALL NOT BE MEASURED OR PAID FOR DIRECTLY BUT SHALL BE INCLUDED IN THE BID PRICE FOR SQUARE YARDS OF ASPHALTIC CONCRETE PAVEMENT.

CITY OF WICHITA, KANSAS

DEPARTMENT of PUBLIC WORKS - Engineering Division

DATE 1-29-80

Proj. No. 472-76-245-80603-000-000-001 8/8