

OLIVER AVENUE
 SL THIRTEENTH TO SL 54.1 + SF RR. R/W

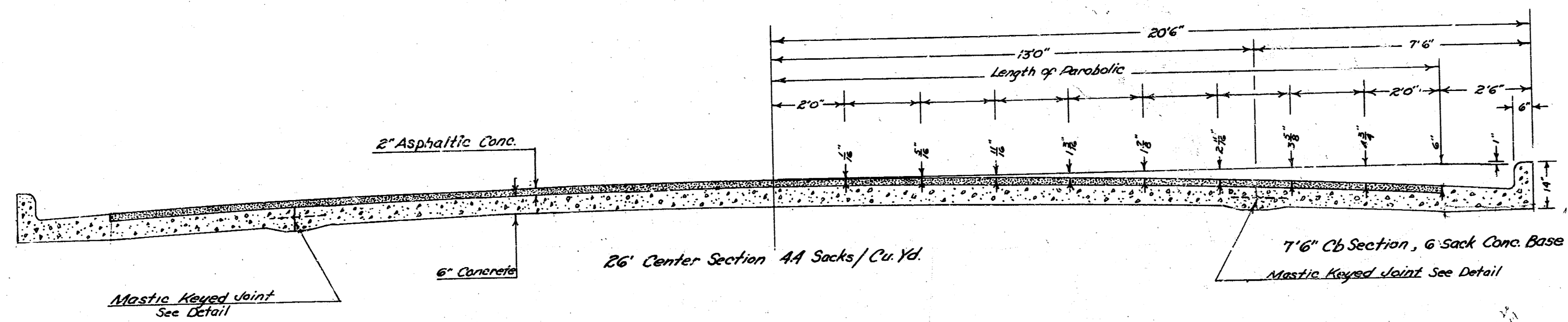

TYPICAL SECTION

Scale $\frac{1}{2}'' = 1'$

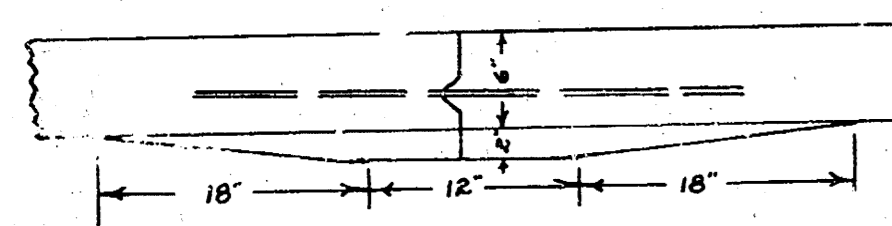

Detail of Keyed Joint
 No Scale

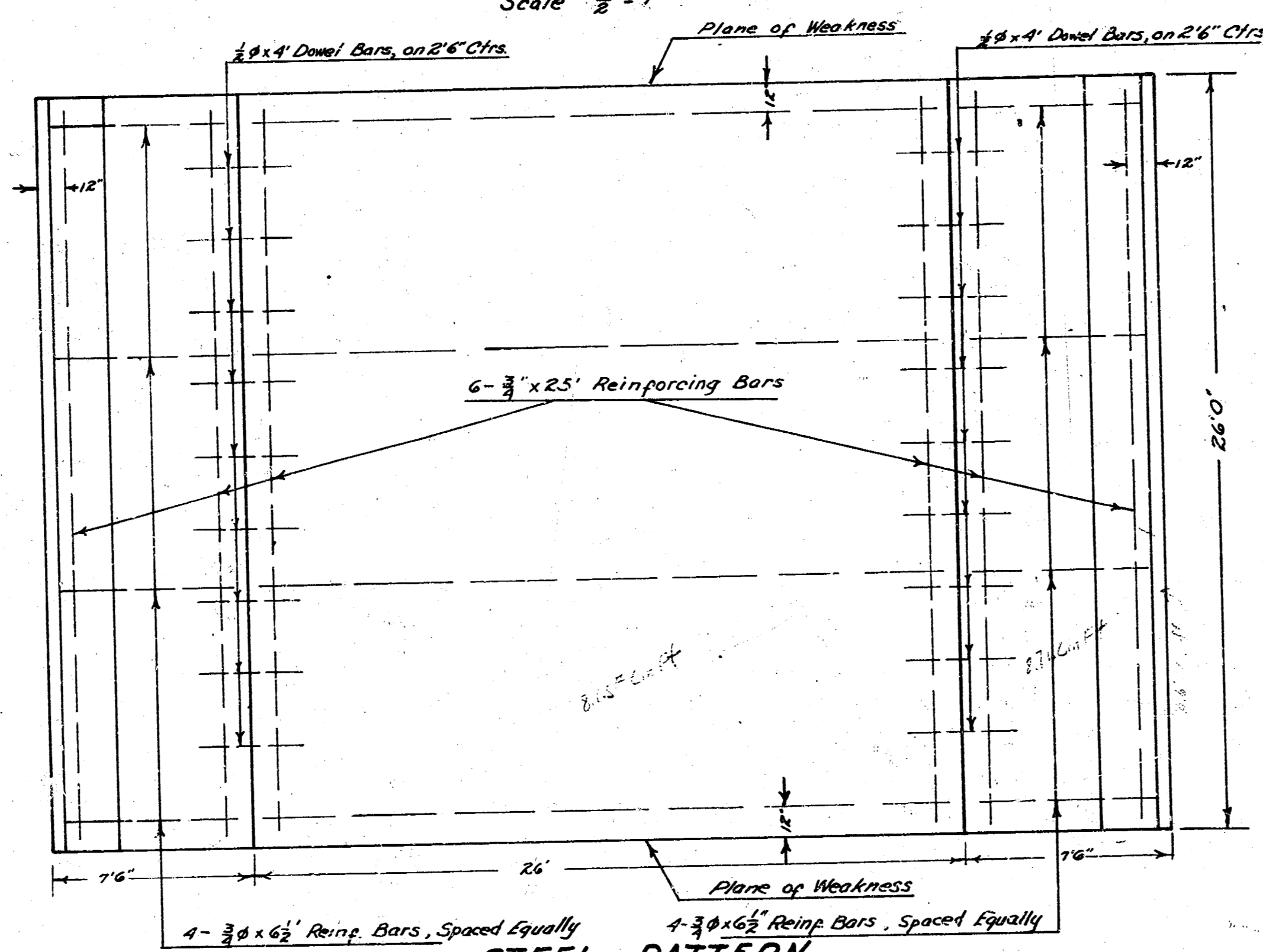

STEEL PATTERN

Scale $\frac{1}{4}'' = 1'$

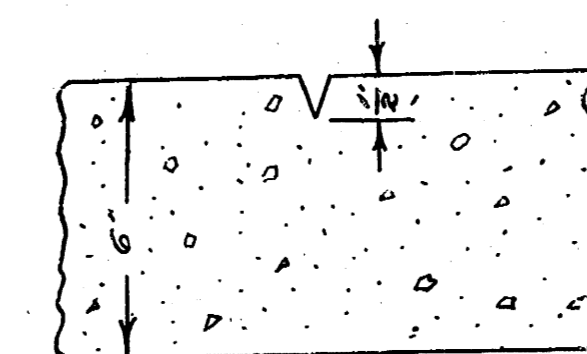

Detail Plane of Weakness
 Plane of Weakness to be cut with
 Double-Edge Groover to Depth as
 Shown in a Straight Line from
 Curb to Curb 26' ctr. to ctr.



264
MBS

B.M. 209.69 Curled 60" Nail W. Side Catalpa NE Cor. 13th & Oliver
B.M. 209.23 Stair. Oil Co. Sign E. Edge Metal Base Cap.

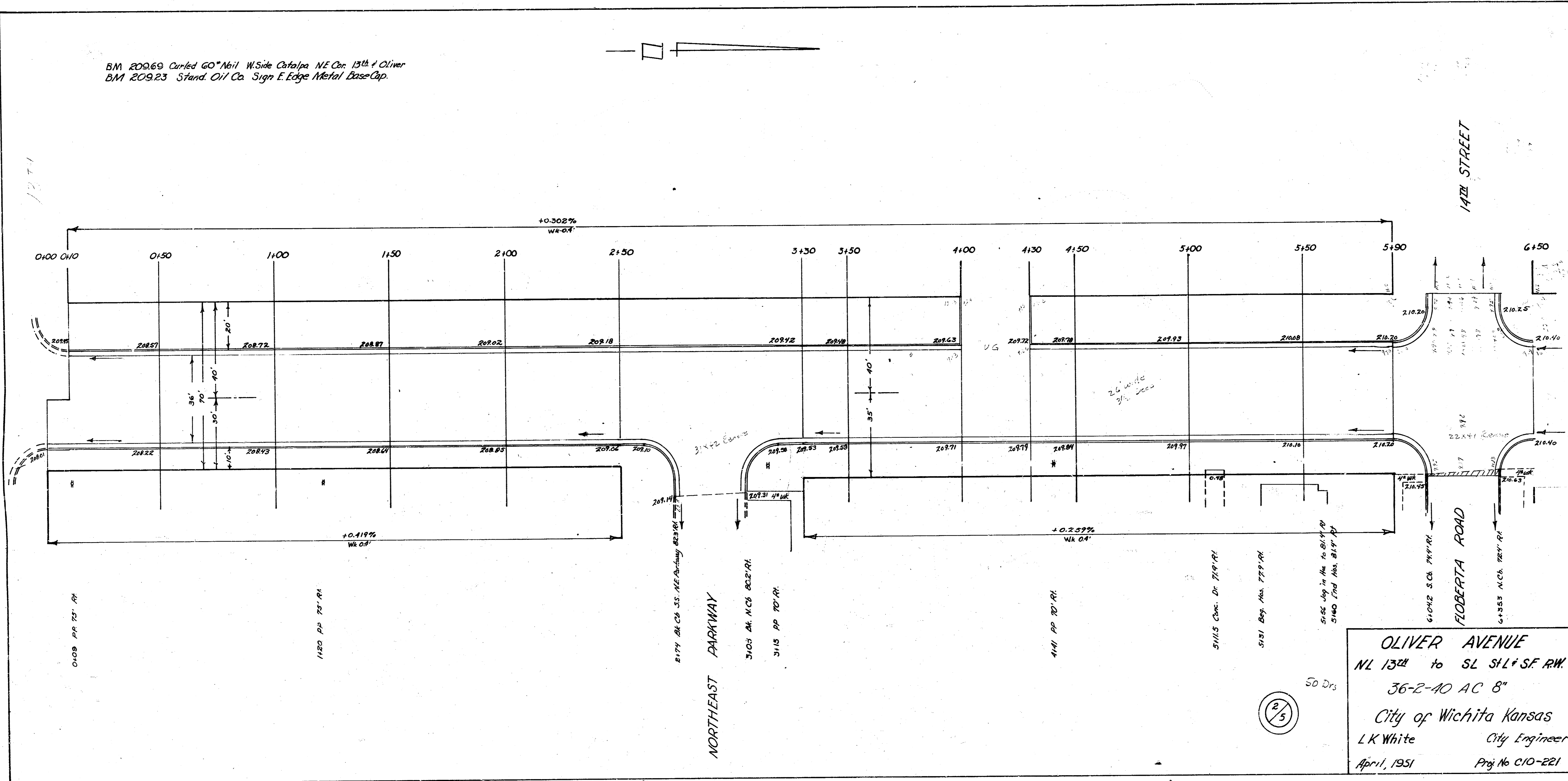

BM. 212.74 "M" in Mueller Fire Hydrant SE Cor. Fisher & Oliver.

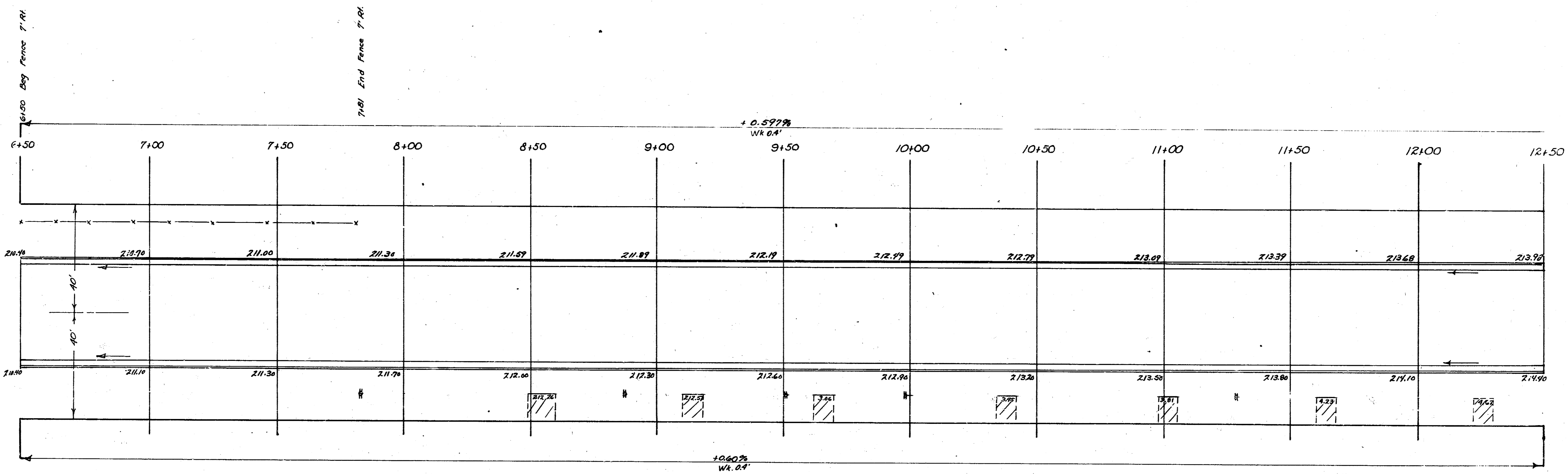
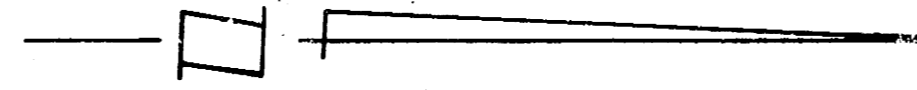

7+00 PP 20' RH

8+57 & Dr. 20' RH

8+87 RR 20' RH

9+14 & Dr. 20' RH

9+57 RR 20' RH

9+66 & Dr. 20' RH

9+98 RR 20' RH

10+38 & Dr. 20' RH

11+02 & Dr. 20' RH

11+59 RR 20' RH

11+65 & Dr. 20' RH

12+25 & Dr. 20' RH

OLIVER AVENUE
NL 13th to SL SAL & SF RM.

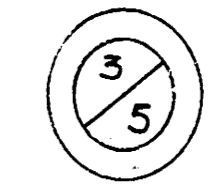

BM 216.83 "M" in Mueller Fire Hydrant SE Cor 15th & Oliver

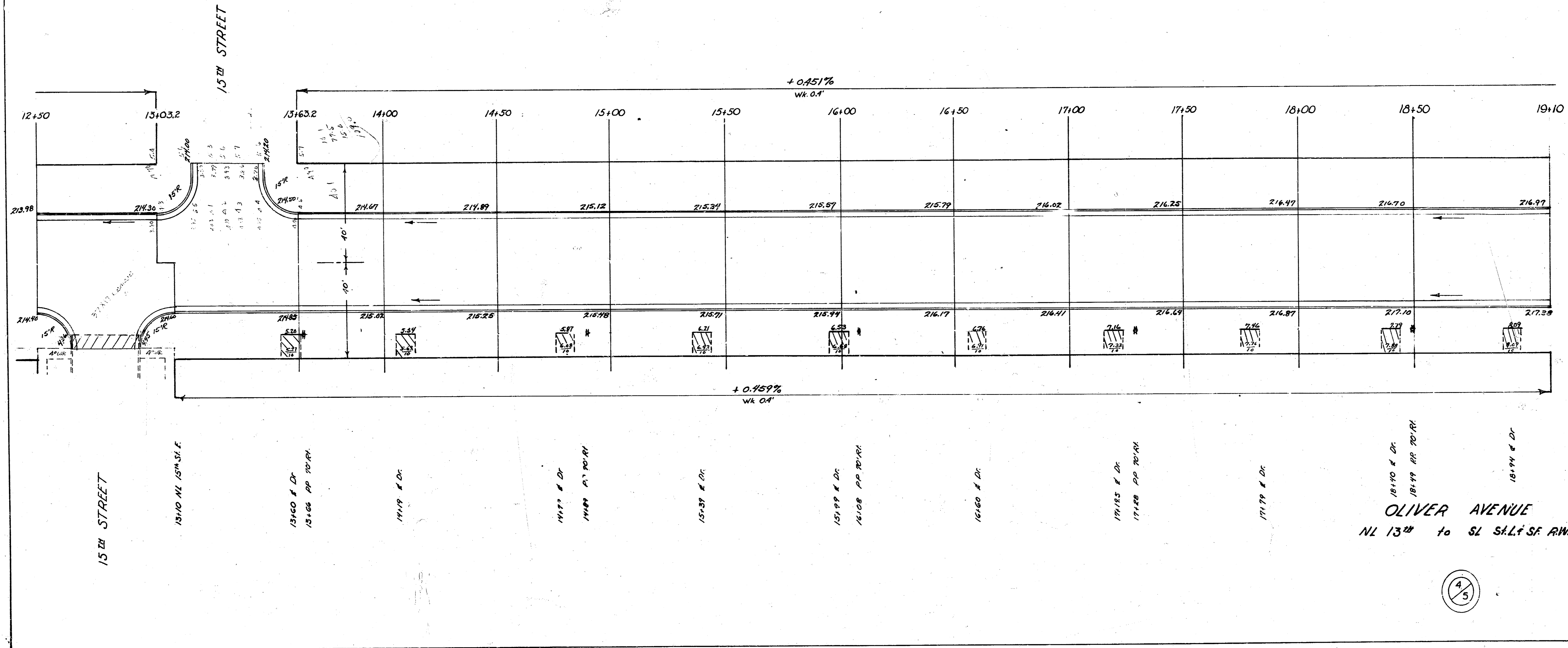
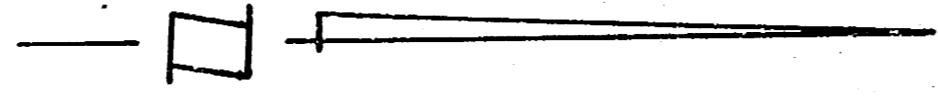

OLIVER AVENUE
NL 13th to SL S.L. + SE RM.

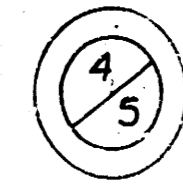

BM. 217.95 "G" in Globe Cont. WK. N.O.S. N. of N. Ch. Crestview, EL Oliver

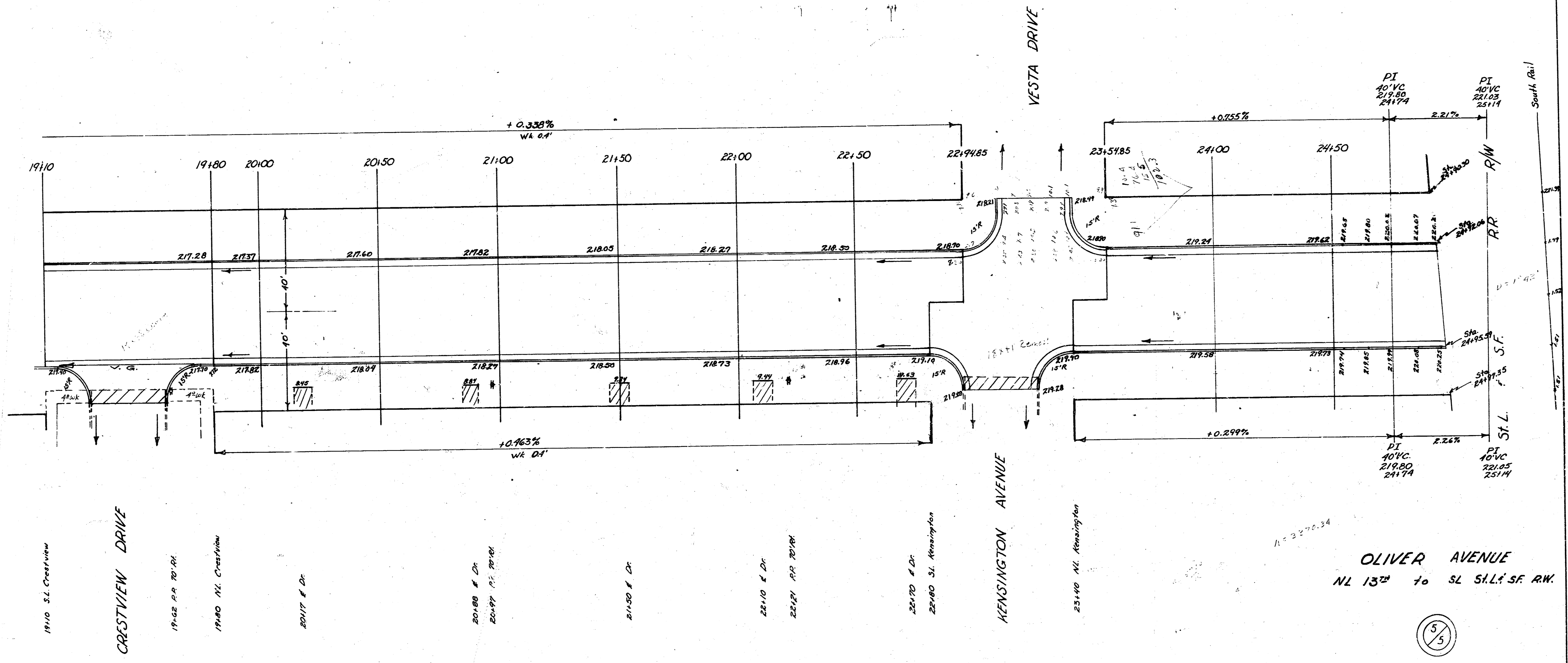

OLIVER AVENUE
NL 13th to SL 5th SF. RM.

