

181

Re Section BK-K8

BM 16266 'M' in Mueller F. Hyd. NW Cor. Lightner & Morris

Prop.	Exc.	City
202.6		0
217.8		
174.3		
148.0		
53.8		
54.5		
88.1		
919.7		
110.0		
1011.3		cu. YDS.

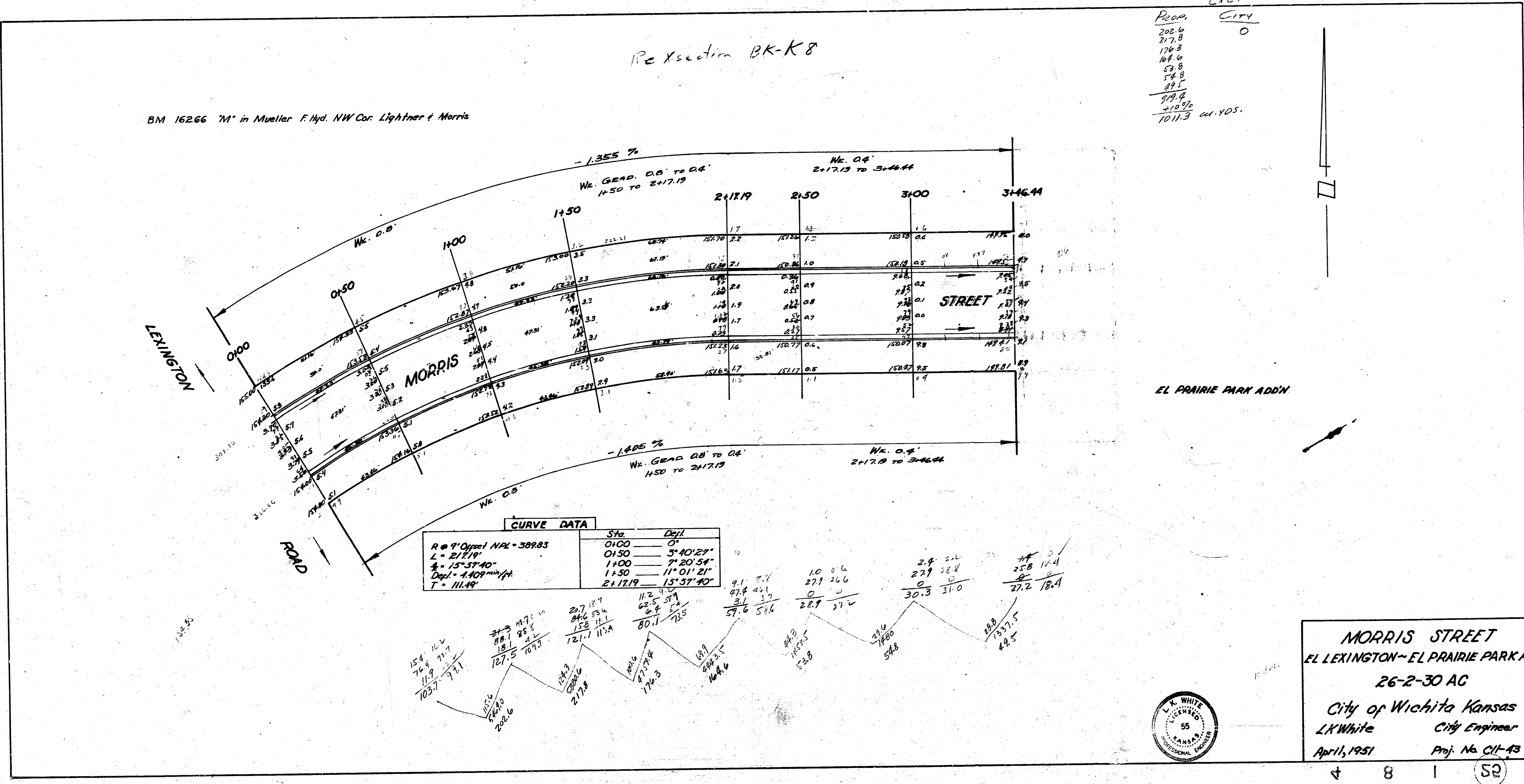

Sta.	Defl.
0+00	0°
0+50	3° 40' 27"
1+00	7° 20' 54"
1+50	11° 01' 21"
2+171.9	15° 37' 40"

MORRIS STREET
 EL LEXINGTON~EL PRAIRIE PARK A
 26-2-30 AC
 City of Wichita Kansas
 LK White City Engineer
 April, 1951 Proj. No. C11-43



BM 16266 'M' in Mueller F. Hyd. NW Cor. Lightner & Morris

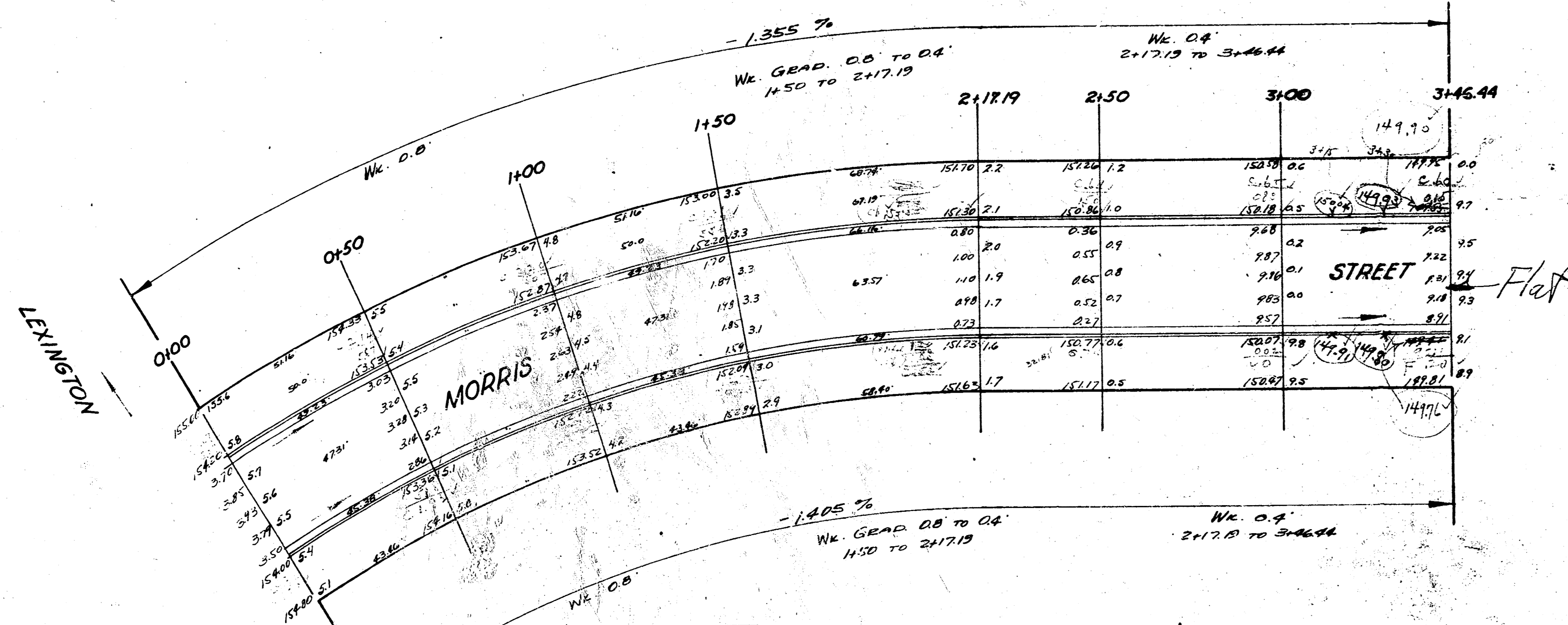

CURVE DATA	
Sta.	Defl.
0+00	0°
0+50	3°40'29"
1+00	7°20'54"
1+50	11°01'21"
2+17.19	15°37'40"

R @ 9' Offset NPL = 389.83
 L = 217.19'
 Δ = 15°37'40"
 Defl = 4.409 mm/ft
 T = 111.49'

184

Exc

Prop.	City
200.0	0
217.8	
198.8	
184.0	
53.8	
54.2	
22.1	
219.5	
1011.3	see YDS.

MORRIS STREET
 EL LEXINGTON-EL PRAIRIE PARK
 26-2-30 AC
 City of Wichita Kansas
 L.K. White City Engineer
 April, 1951. Proj. No. C11-43

