

H-8

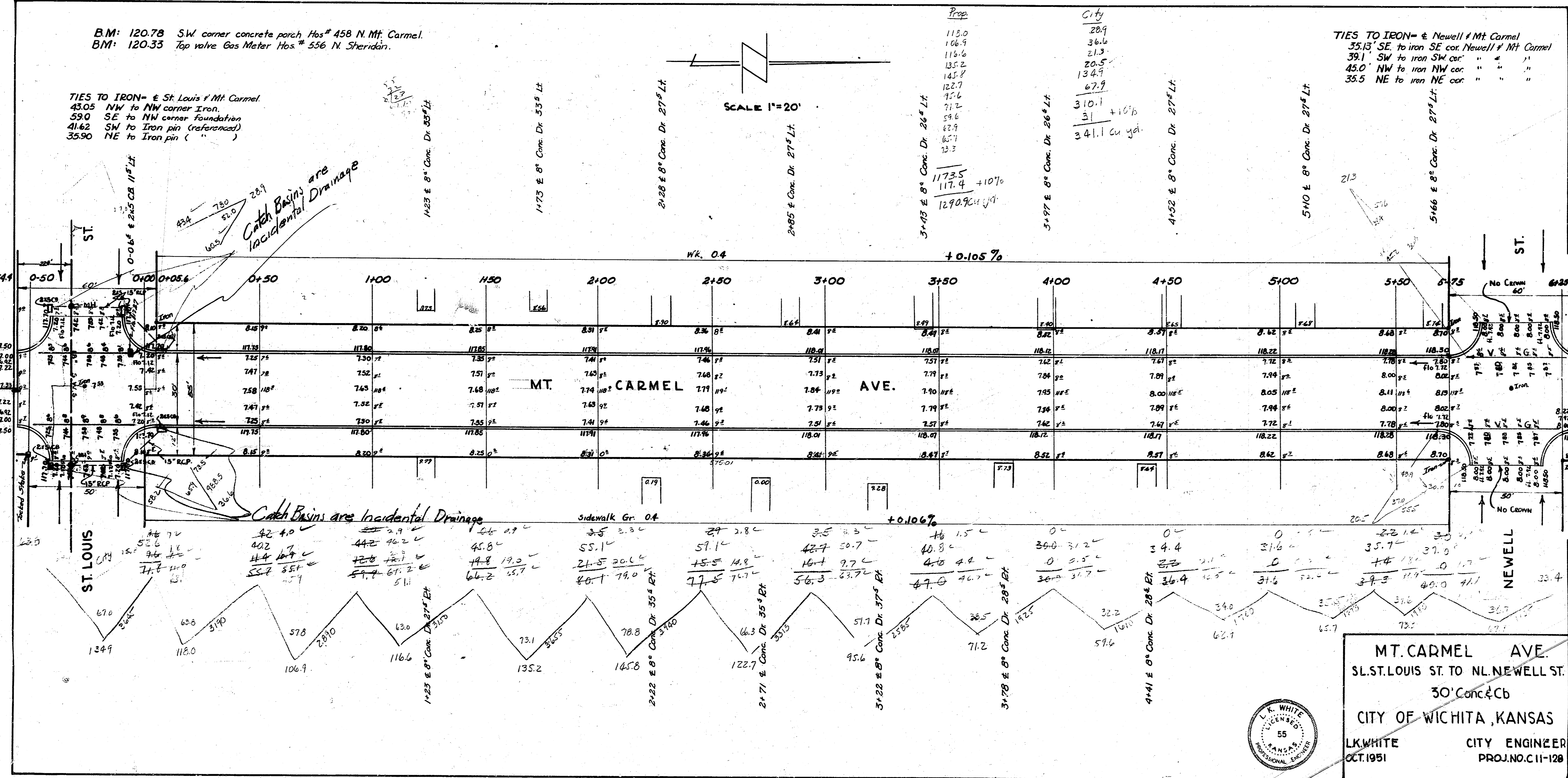

BM: 120.78 SW corner concrete porch, Hos # 458 N Mt. Carmel.
 BM: 120.33 Top valve Gas Meter Hos # 556 N. Sheridan.

TIES TO IRON - & St. Louis & Mt. Carmel
 43.05 NW to NW corner Iron.
 59.0 SE to NW corner foundation
 41.62 SW to Iron pin (reference)
 35.90 NE to Iron pin (" ")

TIES TO IRON - & Newell & Mt. Carmel
 35.13 SE to iron SE cor. Newell & Mt. Carmel
 39.1 SW to iron SW cor. " " "
 45.0 NW to iron NW cor. " " "
 35.5 NE to iron NE cor. " " "

Prop	City
113.0	28.9
116.9	36.0
135.2	21.3
145.8	20.5
122.7	134.9
75.6	67.9
71.2	310.1
59.6	31 + 10.6
67.9	341.1 Cu yd.
85.7	
72.2	
1172.5	
117.4	
1290.9 Cu yd.	

Preliminary Survey, Bl. 119 S83 12-4-51
 Elevation Data
 Bl. 119 S83 12-4-51
 Bl. 119 S83 12-4-51

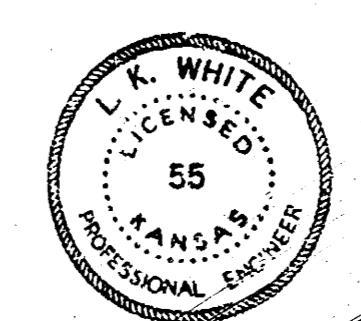

MT. CARMEL AVE.
 SL. ST. LOUIS ST. TO NL. NEWELL ST.
 30' Conc. & Cb
CITY OF WICHITA, KANSAS
 LK. WHITE CITY ENGINEER
 OCT. 1951 PROJ. NO. C11-128

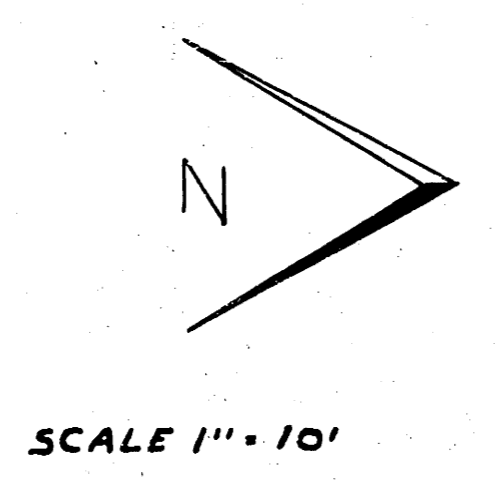

MT. CARMEL

ST.

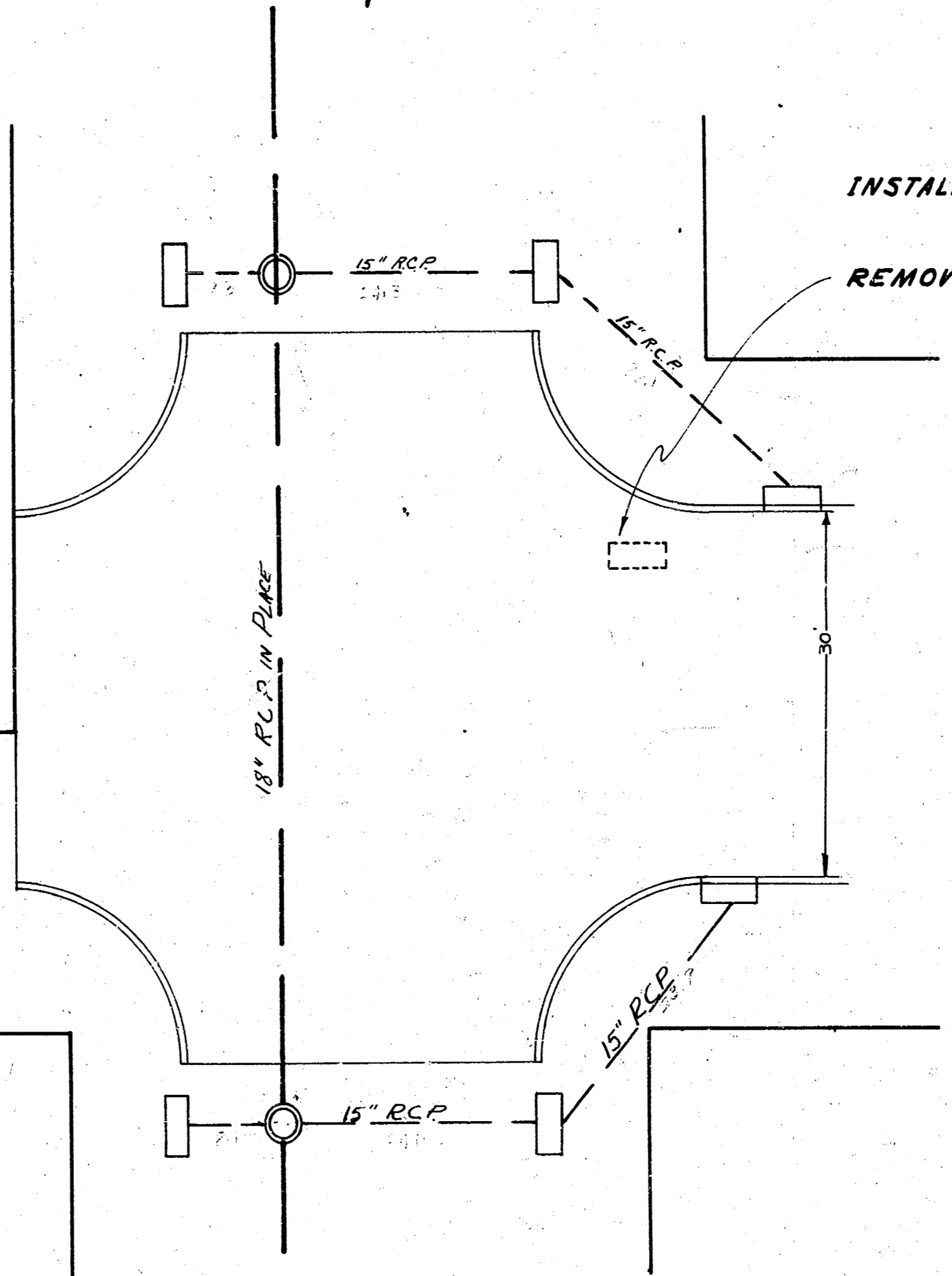

INSTALL 6 NEW CATCH BASINS 2' X 5'
REMOVE EXISTING CATCH BASIN & PLUG PIPE

AVE.

ST. LOUIS

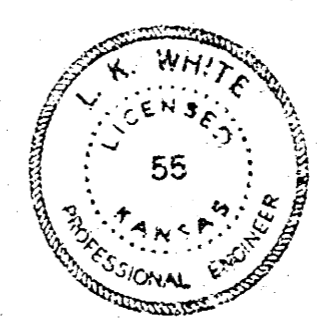

INCIDENTAL DRAINAGE
INTERSECTION OF MT. CARMEL & ST. LOUIS

LK WHITE CITY ENGINEER
FEB. 1952 PROJ. NO. C11-128