

BM: 10734 iron in thimble ± Bonn @ NL M<sup>c</sup>Cormick.

**NOTICE TO CONTRACTOR:**  
All entrance pipes are to be disposed of in accordance with instructions of City Ditch Checker.

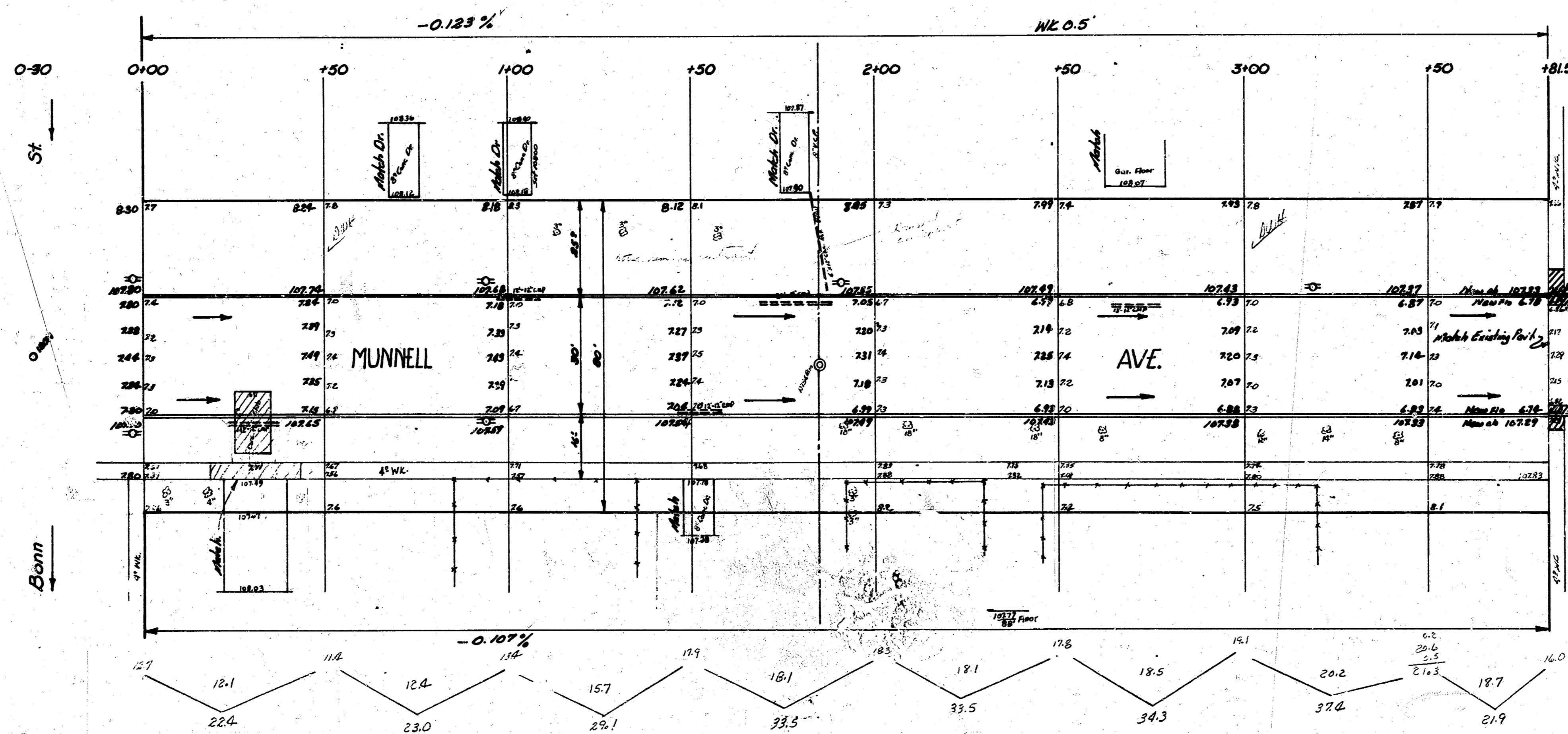

Survey Young BK 1857  
Checked JF



Excavation  
Property - City -  
235.1 0  
+10% 235  
253.6 Cu yds

**NOTICE TO CONTRACTOR & FIELD ENGINEER:**  
Remove 6 Lx 11 Comb Ch of Gutter and replace matching 11x existing pavement and to its grade as shown.

**NOTICE TO CONTRACTOR & FIELD ENGR:**  
Remove 20 Lx 10 of Comb Ch of Gutter and replace. Matching 11x of existing pavement and to its grade as shown.

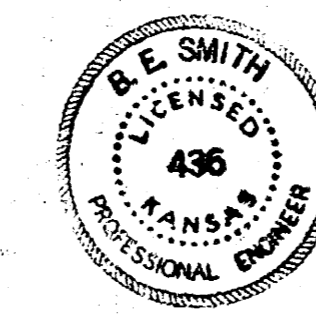

**MUNNELL AVE.**  
EL Bonn to WL Hiram  
30' Conc & Cb  
CITY OF WICHITA, KANSAS  
B.E. SMITH CITY ENGINEER  
Oct. 1956 PROJ. NO. C16-156

1 1 2 8