

B.M. 154.30 "X" on S.E. Hubpd. to Br. 100' W of Murray on 13th St.

NOTE:
ROLL CURB ENTIRE PROJ.

Survey
Measure
Plan
Exc.
Checked
S. Smith

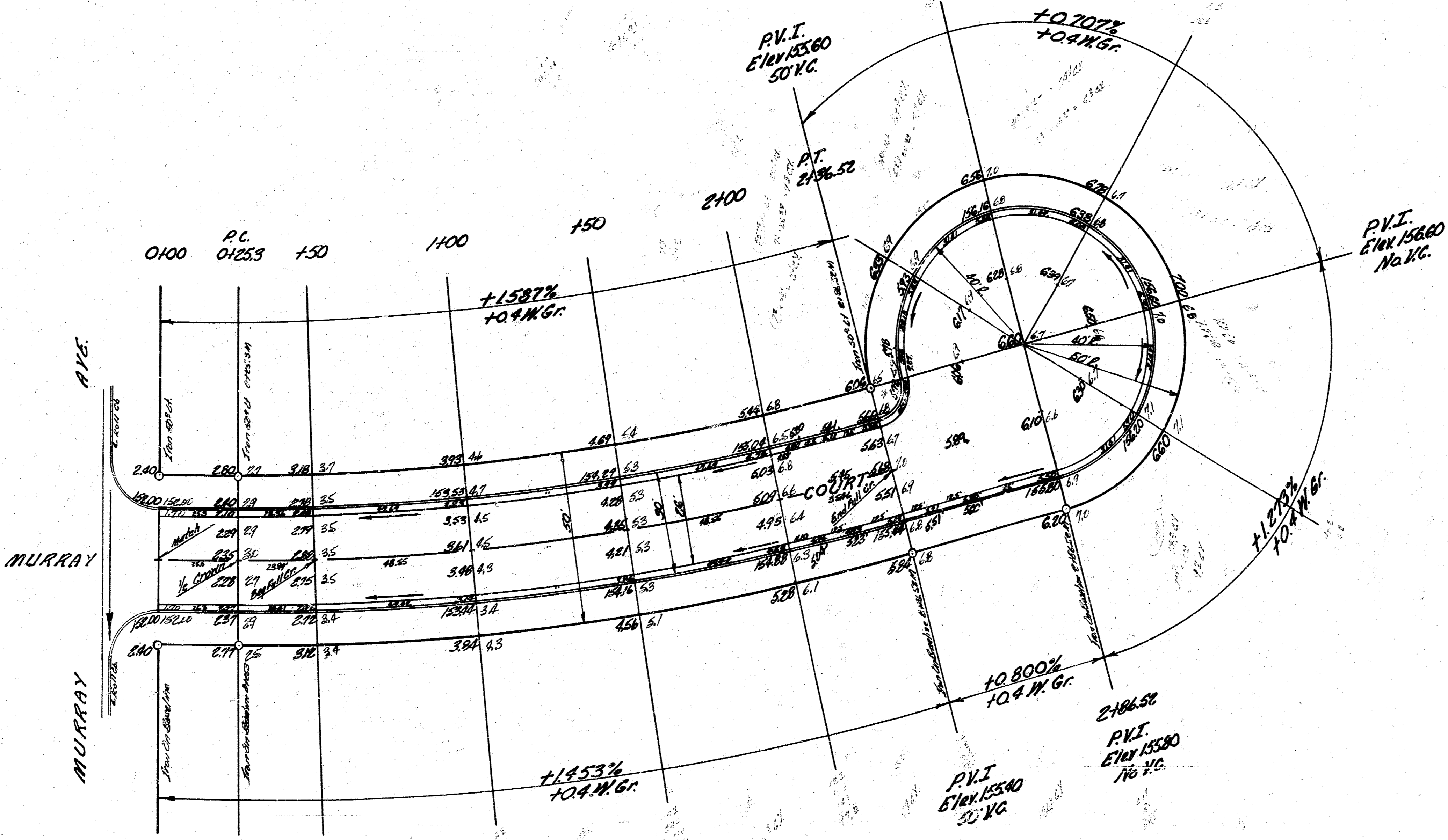
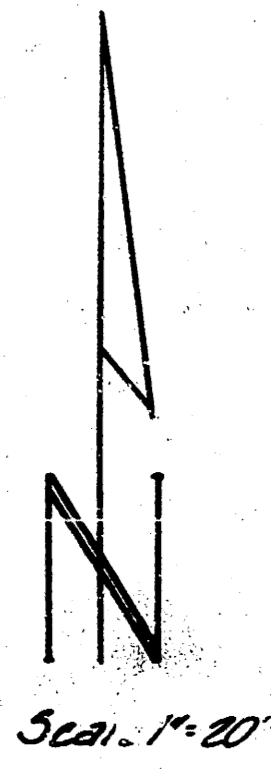

CURVE DATA BASED ON S 1/2 P. 86445 Δ = 14'-00"

Sta	Arc	Chord B' @ North Ch.	Chord B' @ South Ch.	Deflection	Total Def'ls.
PC 0+253					
150	247	23.33	24.64	0° 49' 07"	0° 49' 07"
1+00	320	47.21	47.87	1° 37' 25"	2° 26' 32"
150					4° 07' 57"
2+00	320	47.21	47.87	1° 37' 25"	5° 45' 22"
PT 2+496.52	362	34.50	36.04	1° 12' 38"	7° 00' 00"

198645 MINUTE

Excavation
Prop.
878.9 CY
87.9 +10%
966.8 CY Total

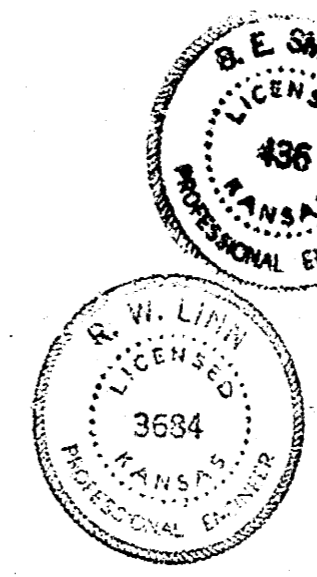

MURRAY COURT
E.L. MURRAY AVE TO AND
INCLUDING Cul-de-sac
26'-2"-30" AC.
CITY OF WICHITA, KANSAS
B. E. SMITH CITY ENGINEER
DATE MAY 1966 Proj. G-1A-39