

B.M. 12060 "D" in PHS, N. of Elm & E.L. Nevada.
 B.M. 12277 "G" in Globe, W. of Nevada & N.L. Murdock W.
 B.M. 12373 "4" N. of S.E. cor. conc. pa., 115' N. of Murdock & W.S. Nevada.

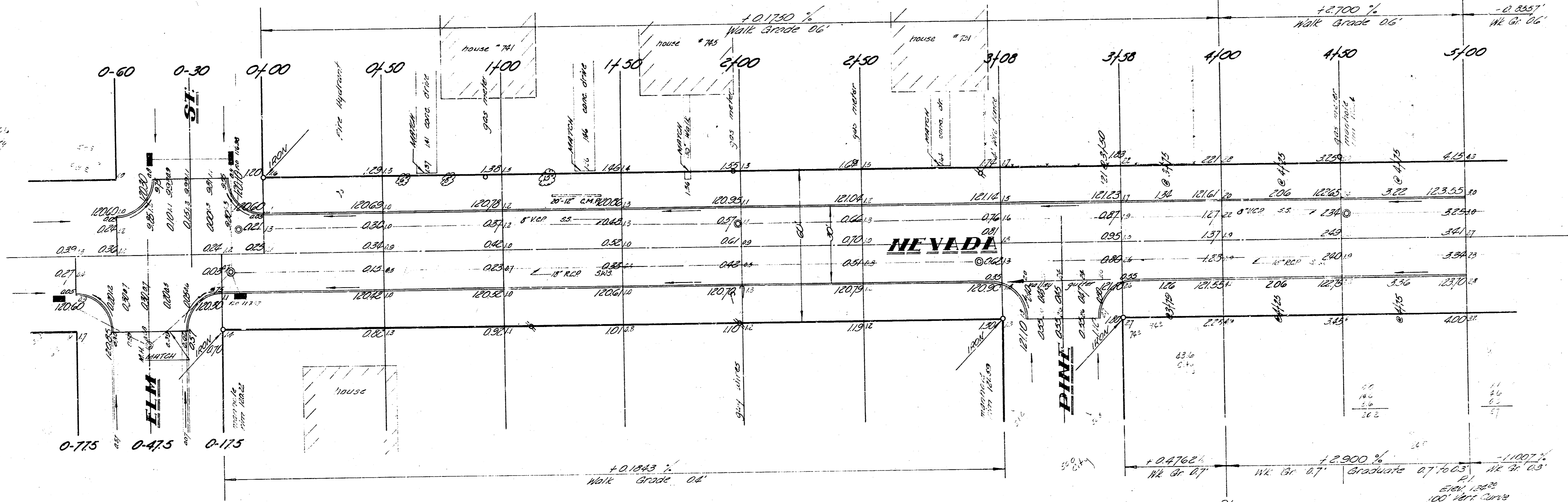
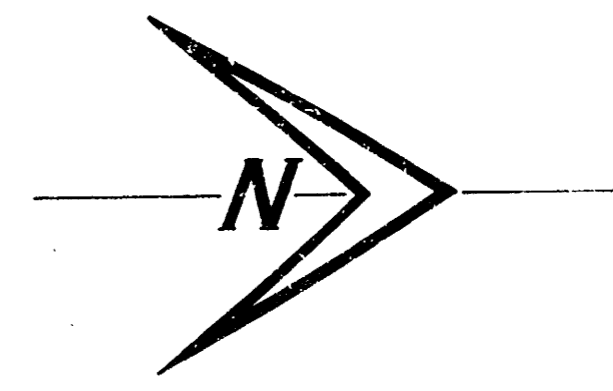

CHAS. W. JONES
 5-6-47

11.3	21.7	26.8	33.8	34.3	41	46	59	59	67	78.1	78.1	82.5
13.7	16.8	17.6	27	27	32.6	32.6	32.6	32.6	32.6	32.6	32.6	32.6
20.2	19.8	46.8	46.1	46.1	32.6	32.6	32.6	32.6	32.6	32.6	32.6	32.6

EXCAVATION

Property	City
10326	3542
10333	356
11579	3096

NEVADA
 S.L. Elm to N.L. Murdock
30' Conc. & Cb.
 City of Wichita, Kansas
 B.E. Smith City Engineer
 Date: March 1947, Proj. No. 019-124

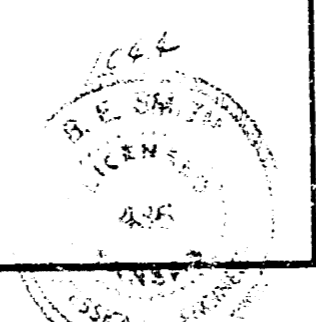

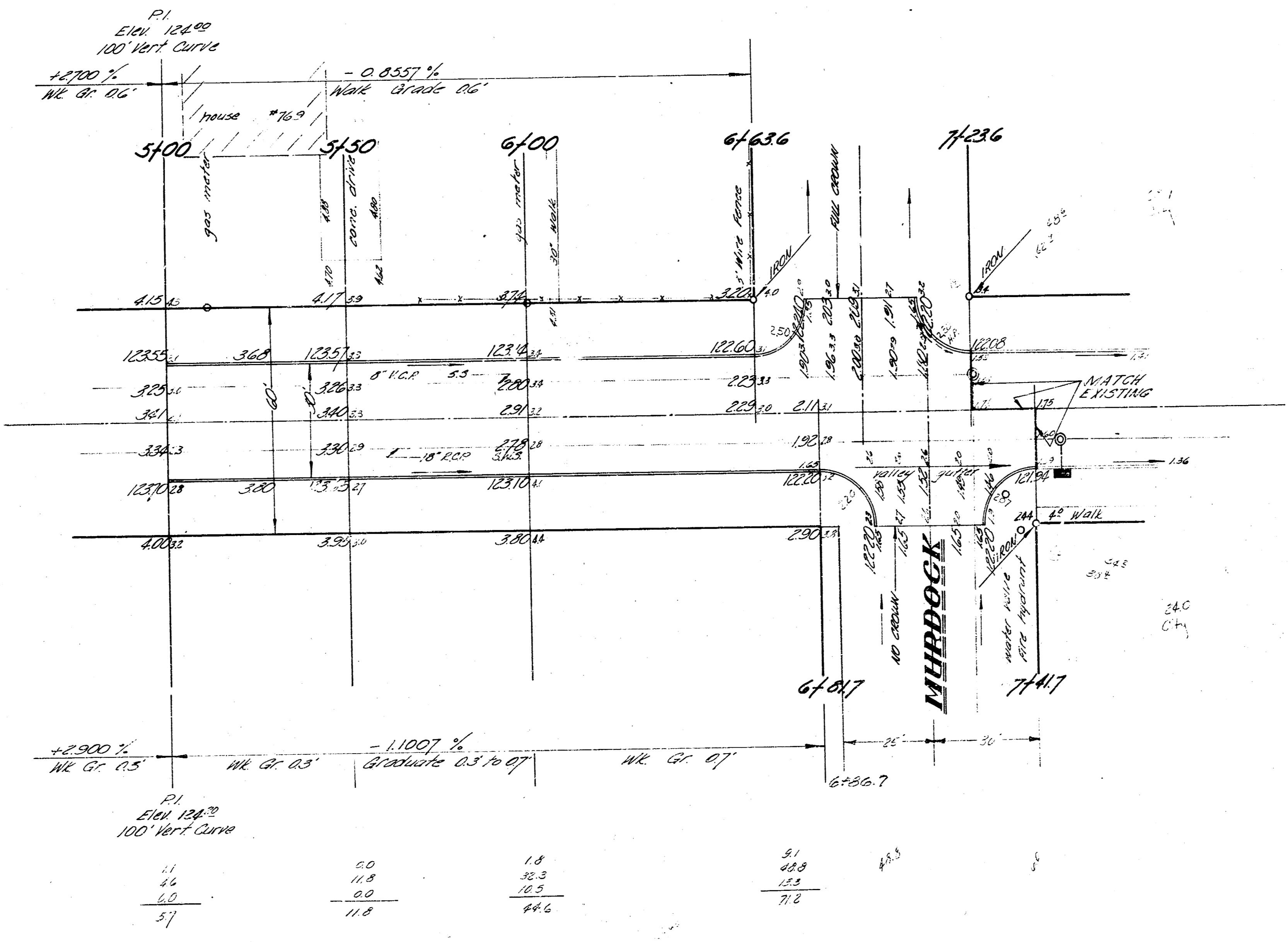
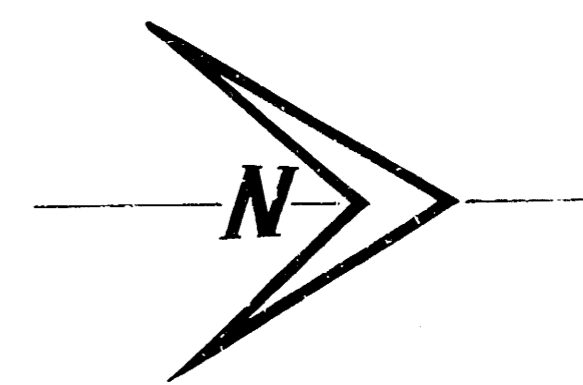

NEVADA
30' CONC. & CO.
019-124

162 322 1506 720 617