

NEVADA Ave.
 EL. LYNNHURST Ave. to SL 16th St.
TYPICAL SECTIONS OF 30" CONCRETE PAVEMENT
 Project No. DAKS575075

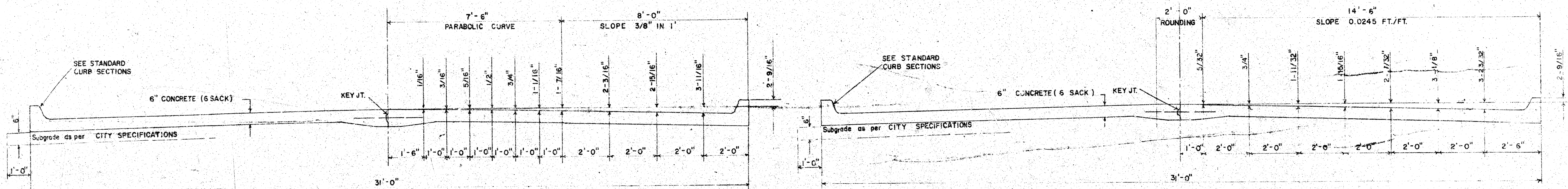

TYPICAL SECTION WITH STANDARD CROWN

TYPICAL SECTION WITH ALTERNATE CROWN

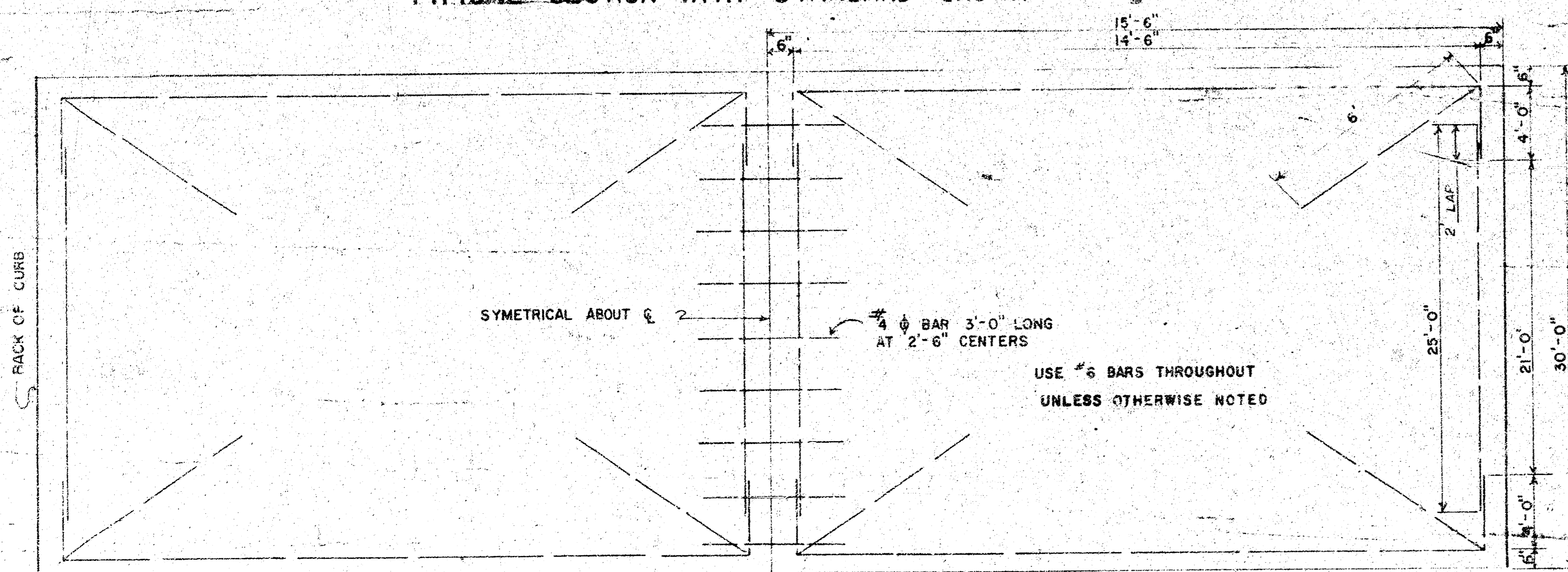

STEEL PATTERN

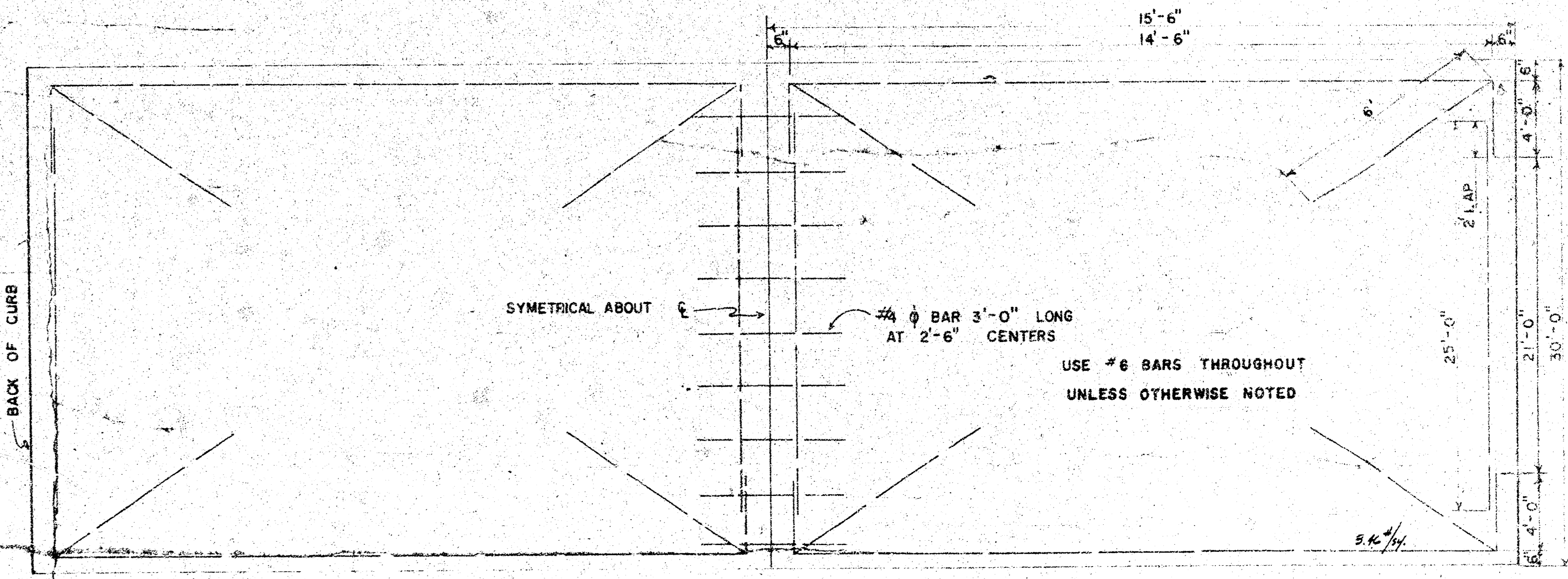

STEEL PATTERN

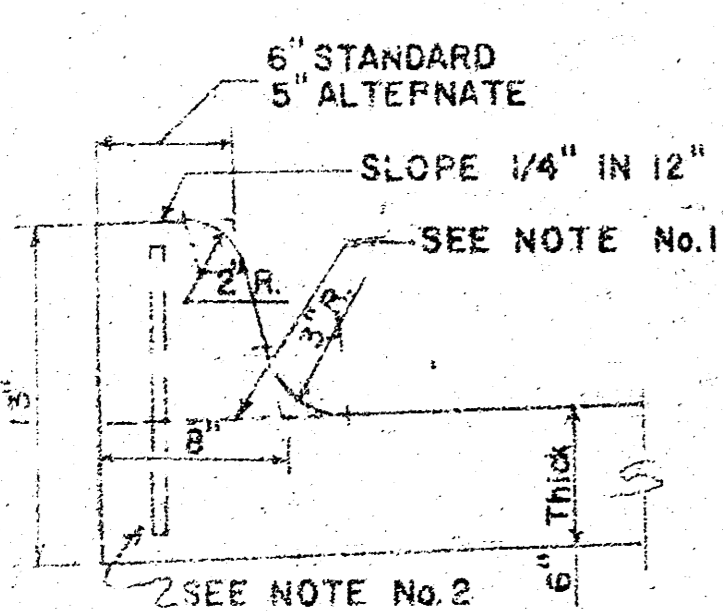

INTEGRAL CURB

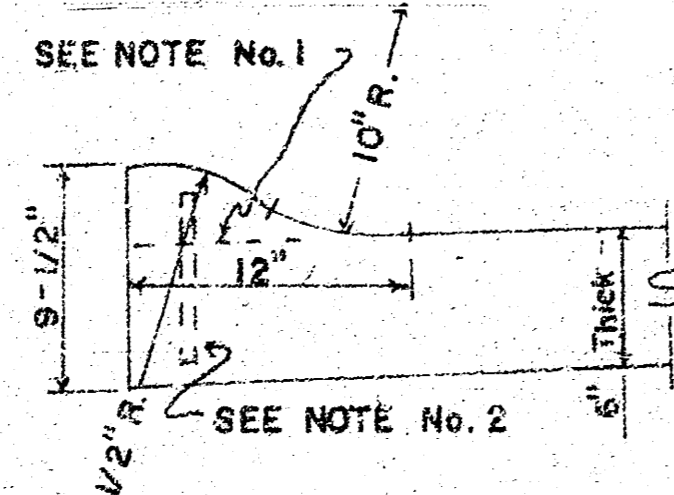

ROLL-TYPE

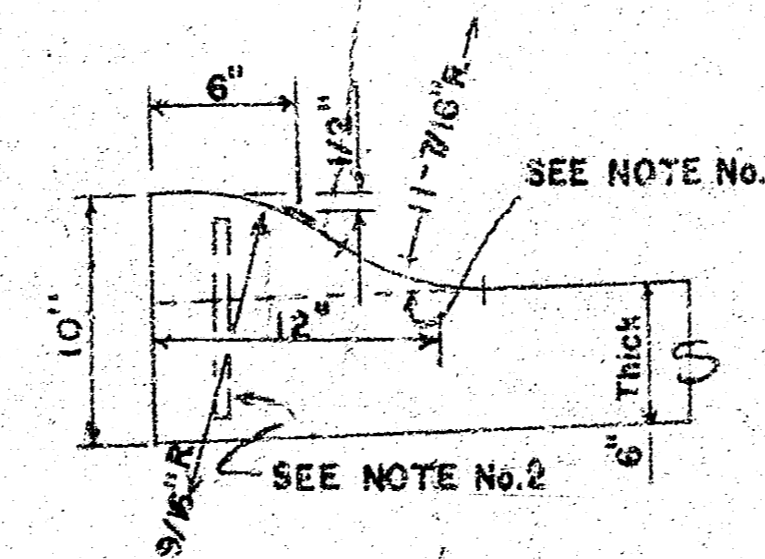

ALTERNATE ROLL-TYPE

STANDARD SECTIONS OF

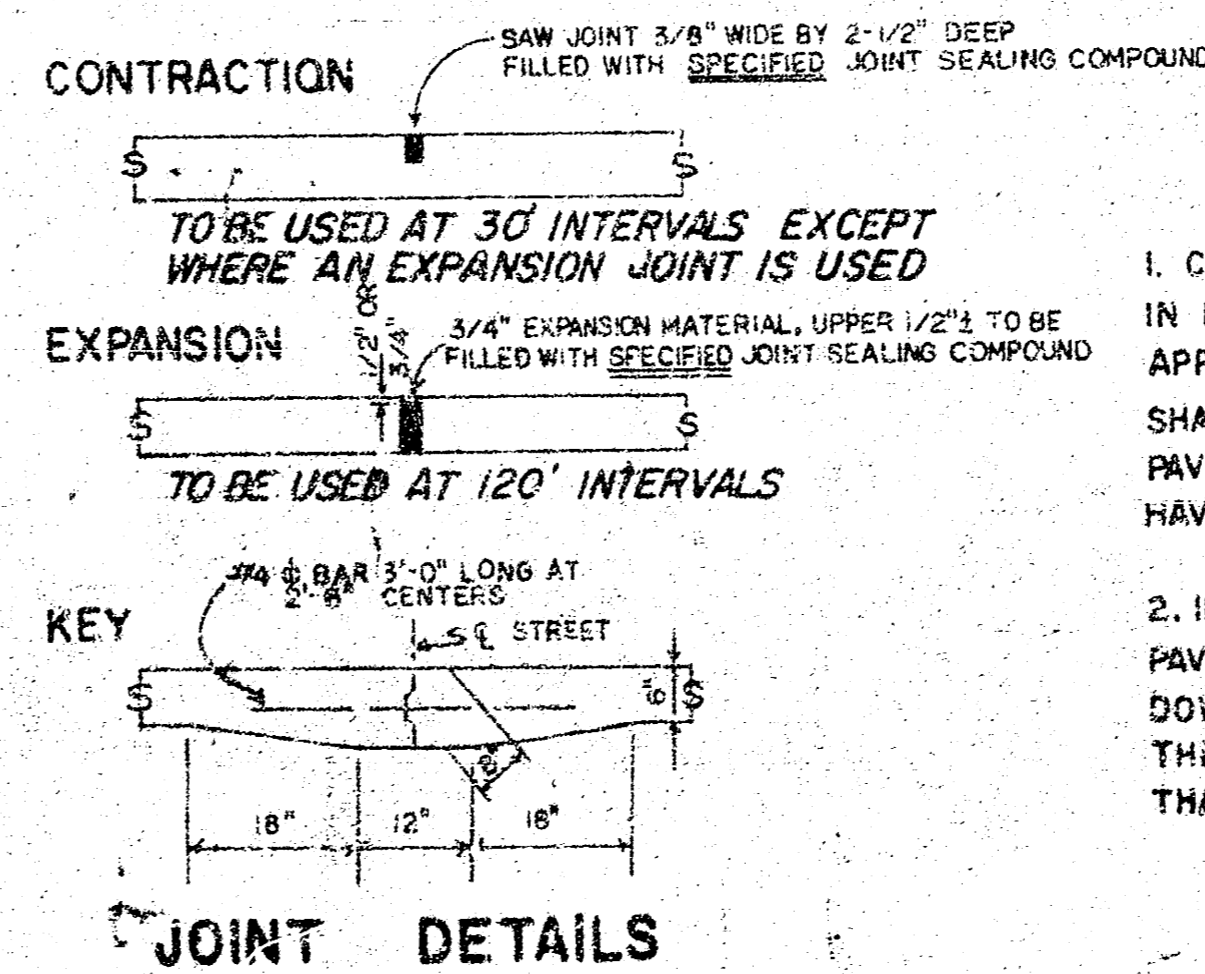

GENERAL NOTES

- CONTRACTION JOINTS MAY BE CONSTRUCTED IN INTEGRAL CURB BY SAWING WITH AN APPROVED CONCRETE SAW. THE SAW CUT SHALL EXTEND THROUGH THE CURB TO THE PAVEMENT. SAWED CONTRACTION JOINTS SHALL HAVE A MAXIMUM SPACING OF 120'.
- INTEGRAL CURB SHALL BE TIED TO THE PAVEMENT BASE WITH SHORT DEFORMED DOWEL BARS SPACED AT 2'-6" INTERVALS. THESE DOWEL BARS SHALL NOT BE LESS THAN 1/2" OR MORE THAN 3/4" IN DIAMETER.

CITY OF WICHITA, KANSAS
 Department of Public Works Engineering Division
 R.W. Linn City Engineer
 Date: _____ Project No. DAKS575075

Survey A. RIGGS 88 79
 P.B.P. J.D. MEFARLAND
 P.R. J.D.M.
 Checked

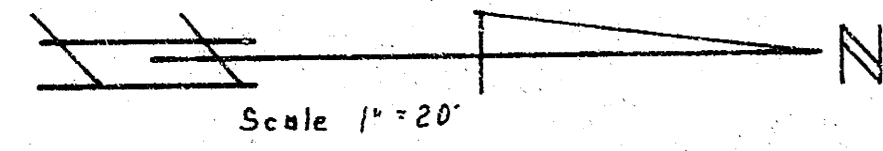

B.M. 128.05 R.R. Spike, E.S. PP, N.W. Cor. OTT St. & LYNNHURST Ave.
 B.M. 128.44 "G" in GLOBE W.L. SABIN St.
 B.M. 127.18 "a" Cut Top Cb. W.L. NEVADA N. Side 16th St.
 E is E

EARTHWORK

PROPERTY	CITY
Excavation:	
"x" section 566.3 c.y.	493 c.y.
10% 56.6	4.9
total 622.9 c.y.	54.2 c.y.
Manipulation:	
1575 sy.	152 sy.

GENERAL NOTES:
 1 Contractor to Contact Property Owner Concerning Matching Drive Behind R. at Sta. 1+09 Lt.

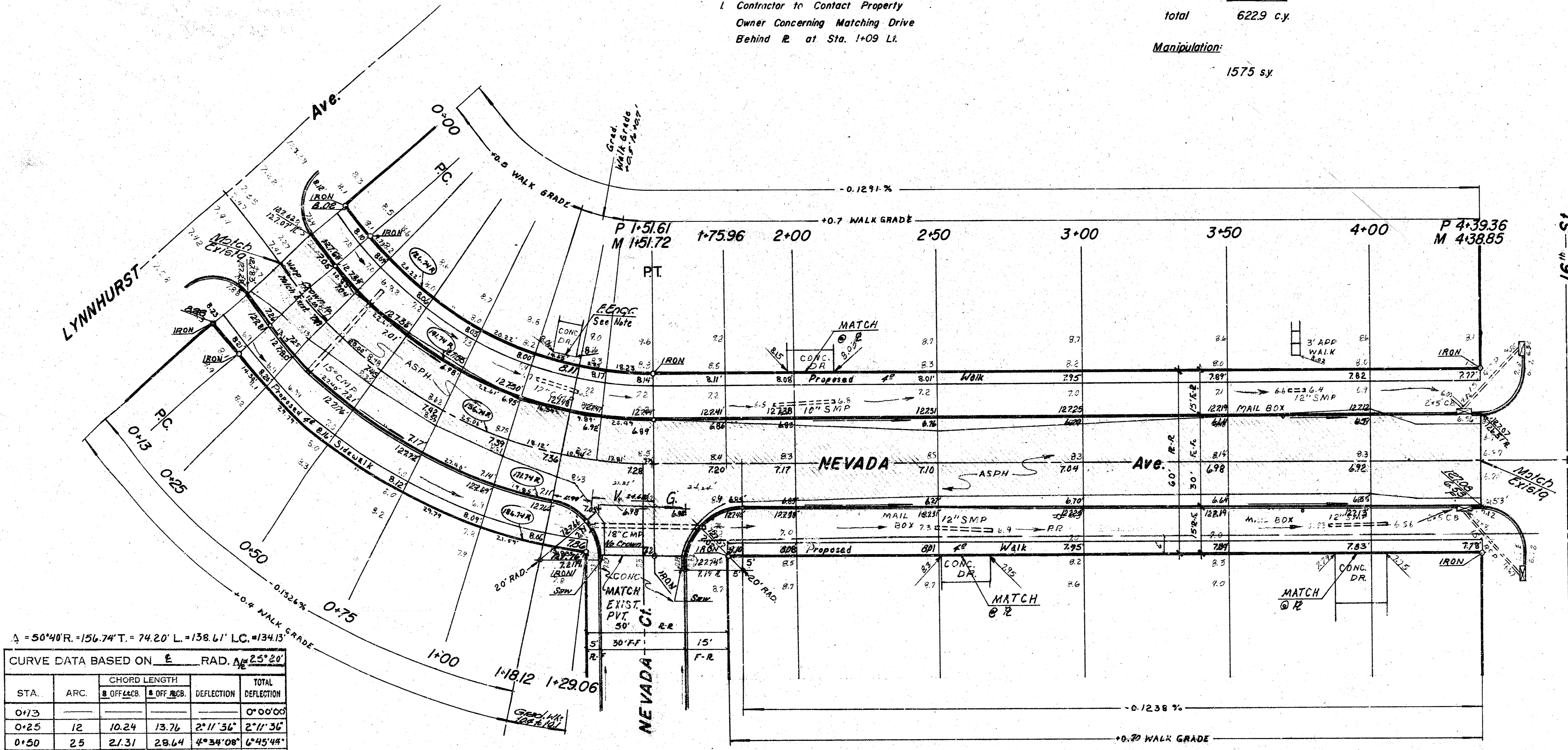

Δ = 50°40' R. = 156.74' T. = 74.20' L. = 138.61' LC. = 134.13'

CURVE DATA BASED ON E RAD. $\Delta = 25^{\circ}20'$

STA.	ARC	CHORD LENGTH	OFF. L. C.B.	OFF. B.C.B.	DEFLECTION	TOTAL DEFLECTION
0+13						0°00'00"
0+25	12	10.24	13.76	2'11'36"	2'11'36"	2'11'36"
0+50	25	21.31	28.64	4'34'08"	4'34'08"	4'34'08"
0+75	25	21.31	28.64	4'34'08"	11'19'53"	11'19'53"
1+00	25	21.31	28.64	4'34'08"	15'54'02"	15'54'02"
1+18.12	18.12	15.45	13.86	3'18'42"	19'12'44"	19'12'44"
1+29.06	10.94	9.33	12.54	1'59'59"	21'12'43"	21'12'43"
1+51.61	22.55	19.22	25.84	4'07'17"	25'28'00"	25'28'00"

DEFLECTION = 10.96637902 min Δ

SUB-GRADE
 TYPE OF SUB-GRADE TREATMENT SHALL BE DETERMINED BY THE FIELD ENGINEER. SUB-GRADE TREATMENT MAY CONSIST OF LIME TREATMENT, CEMENT TREATMENT, SUB-GRADE MODIFICATION, OR ANY COMBINATION OF THESE.

NOTE 1: FIELD ENGINEER & CONTRACTOR Grade parking and clear right-of-way for proposed sidewalk. Compact fill to sidewalk area. TO BE CONSTRUCTED BY "OTHERS".

NEVADA Ave.
 E.L. LYNNHURST to S.L. 16th St.
 6" CONCRETE
City of Wichita, Ks.

R.W. LINN _____ City Engineer
 DATE: _____ PROJ. NO. DAKS 575075