

1941
OHIO - N.L. 12TH TO S.L. 13TH
30' CONC.

NOTE: BUILD C.B. ON WEST
SIDE, 15' N. OF N.L. 12TH

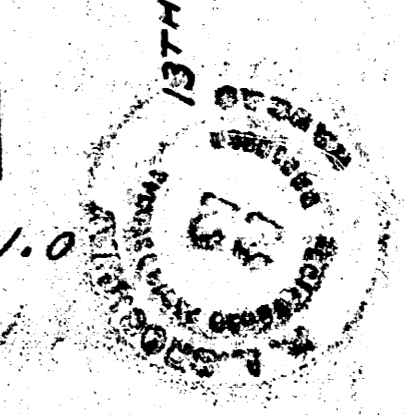
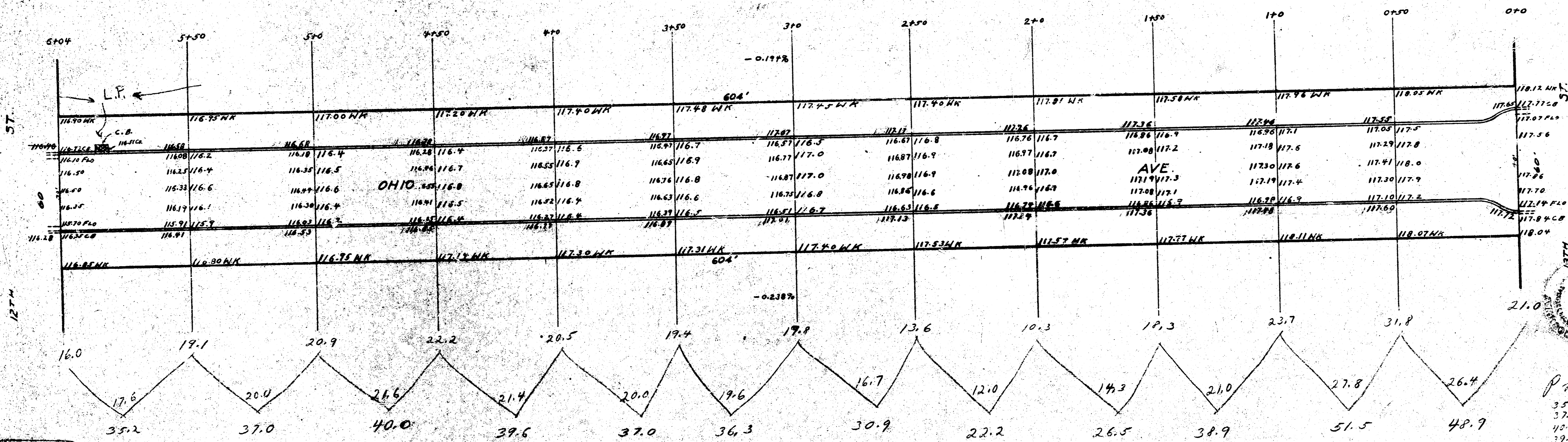

prep

35.2
37.0
40.0
39.6
37.0
36.3
30.9
22.2
26.5
38.9
51.5
27.8
31.8
26.4
48.9
21.0
44.0
44.9
48.7

B.M. 11725 'K' IN KEELER. CTR. WM. S. N.E. COR. 13TH + OHIO (ON OR CE)
(ASSUMED EQUAL TO OLD BENCH 'F' IN FLETCHER)

Survey Plan
1941
Ohio Ave.
N.L. 12TH
to
S.L. 13TH