

BM. 147-98 R.R. Spike in Transformer Pole North of Studio Club

— N —

+0.5462%
+0.4 WALK.

Property

City

14.2
12.3
33.3
59.8
4.0
110%
65.8 An. yds.

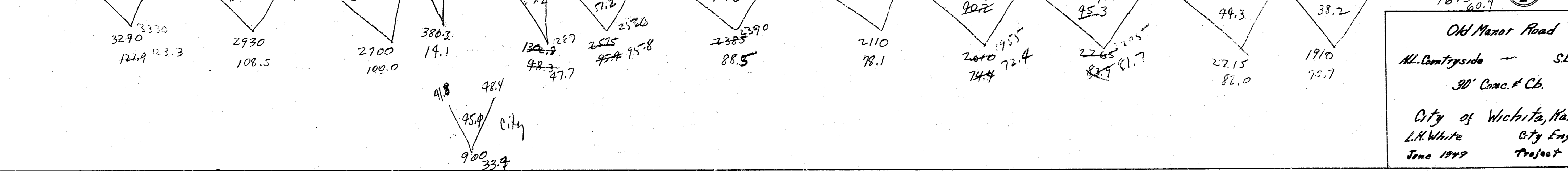
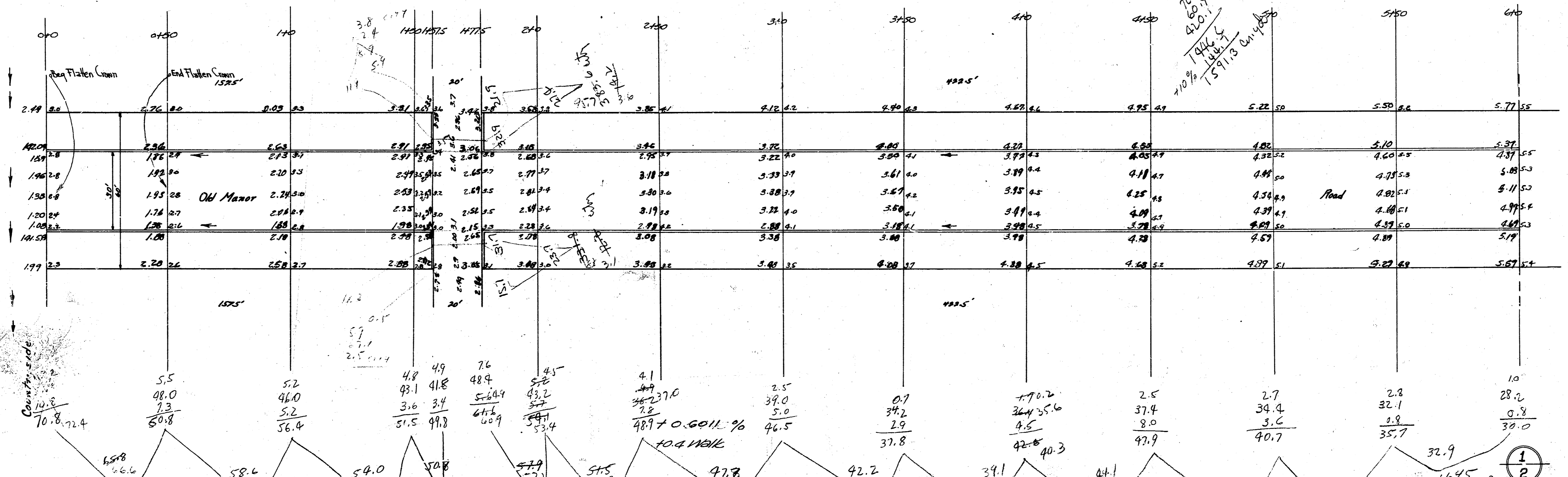

Old Manor Road
 N. Cantonside — S.L. Harry
 30' Conc. & Cb.
 City of Wichita, Kansas
 L.K. White City Engineer
 June 1949 Project C19-107

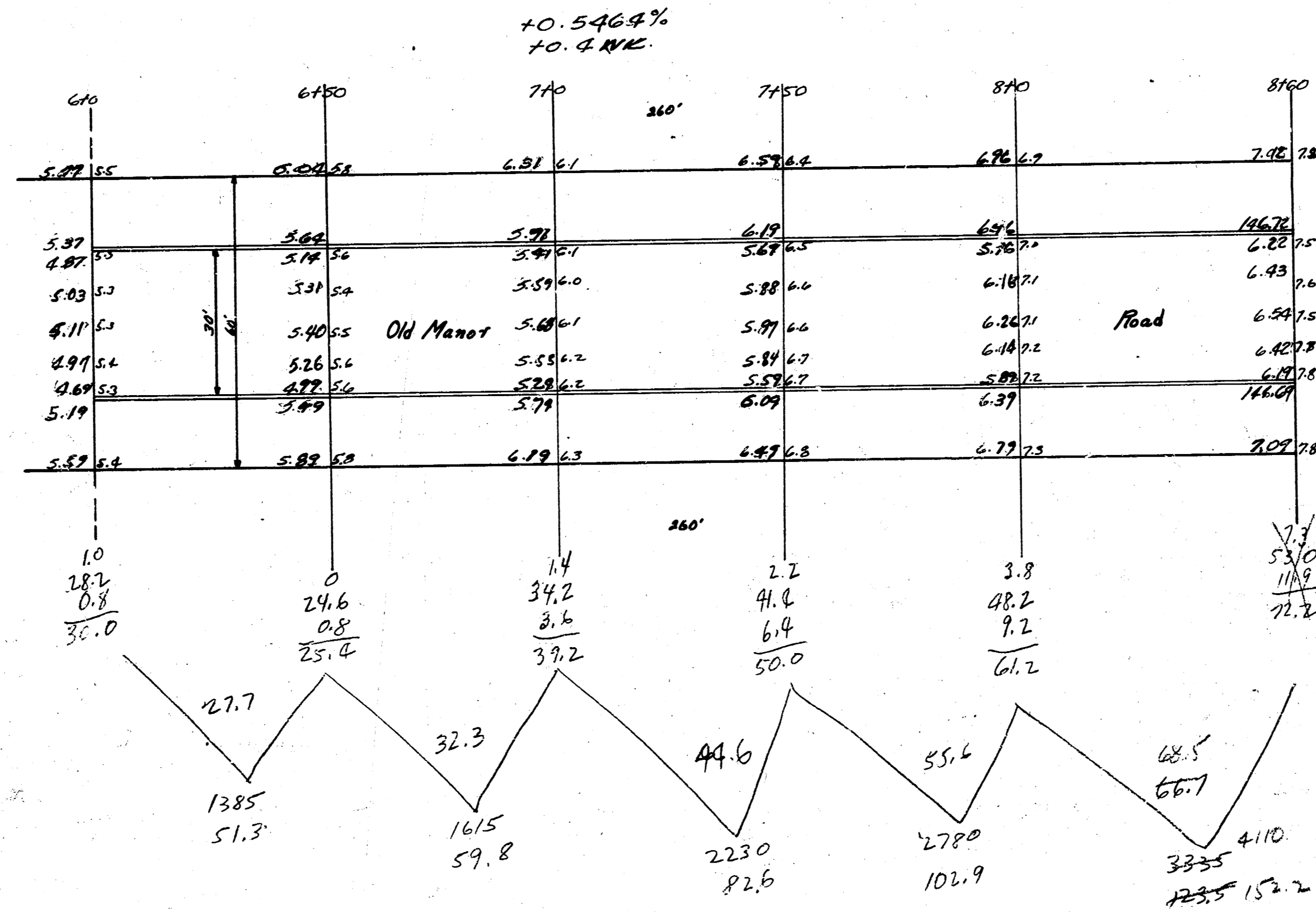

Install CIP.
Fill ditch & make
Connection with
Block Top or
Block Base
with Block Base
RBF

Property
123.5
102.9
82.6
59.8
51.3
920.1 cur-yds

2
2

SS