

TYPICAL 4' PAVEMENT DETAILS

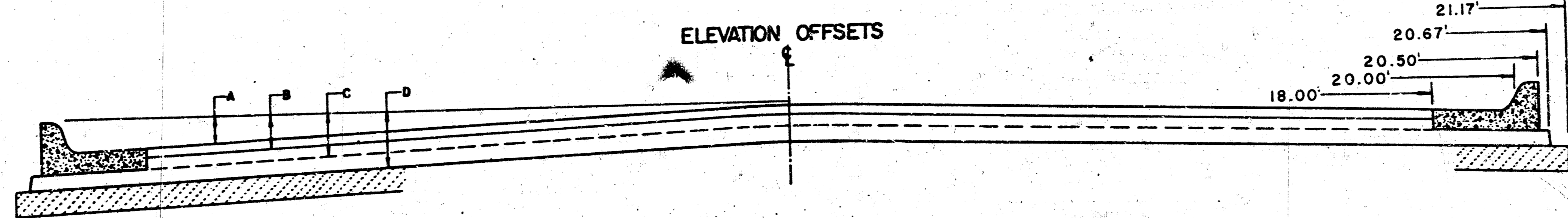

	DISTANCE FROM CENTERLINE (LT. & RYS)													
	0	2	4	6	8	10	12	14	16	18	20	20.5	20.67	21.17
A: TOP OF CURBS TO TOP OF SURFACE LIFT	-.05	-.01	.05	.11	.18	.24	.30	.36	.43	.49	—	—	—	—
B: TOP OF CURBS TO TOP OF UPPER BASE LIFT	.11	.16	.22	.28	.34	.40	.47	.53	.59	.65	—	—	—	—
C: TOP OF CURBS TO TOP OF LOWER BASE LIFT	.36	.41	.47	.53	.59	.65	.72	.78	.84	.90	.97	.98	.99	—
D: TOP OF CURBS TO TOP OF SUBGRADE	.61	.66	.72	.78	.84	.90	.97	1.03	1.09	1.15	1.22	1.23	1.24	1.25

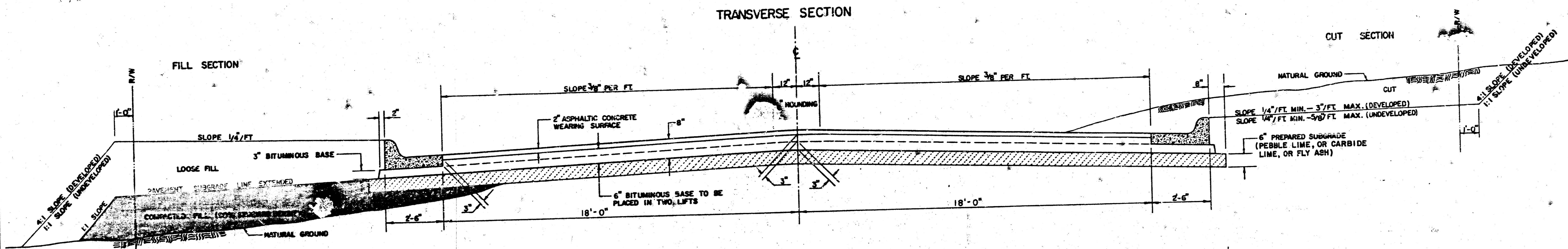
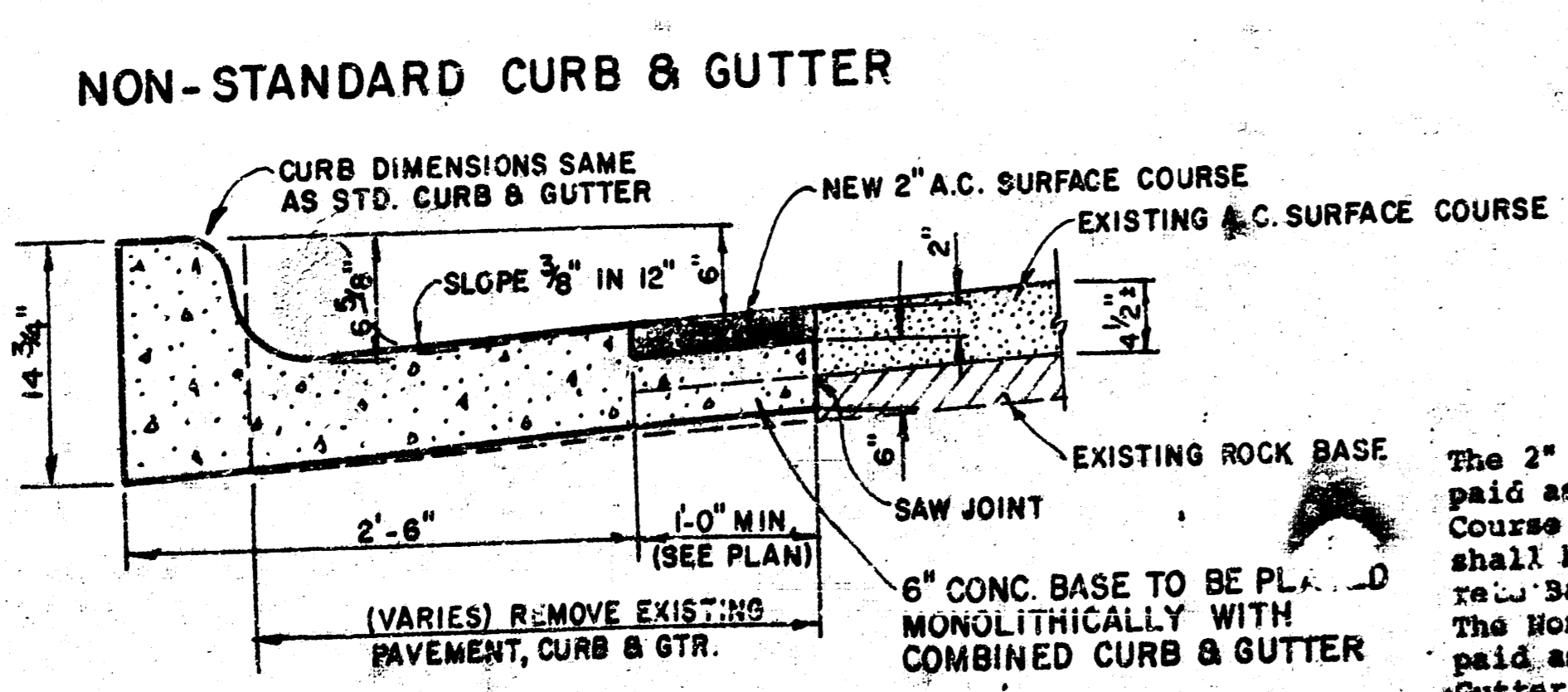
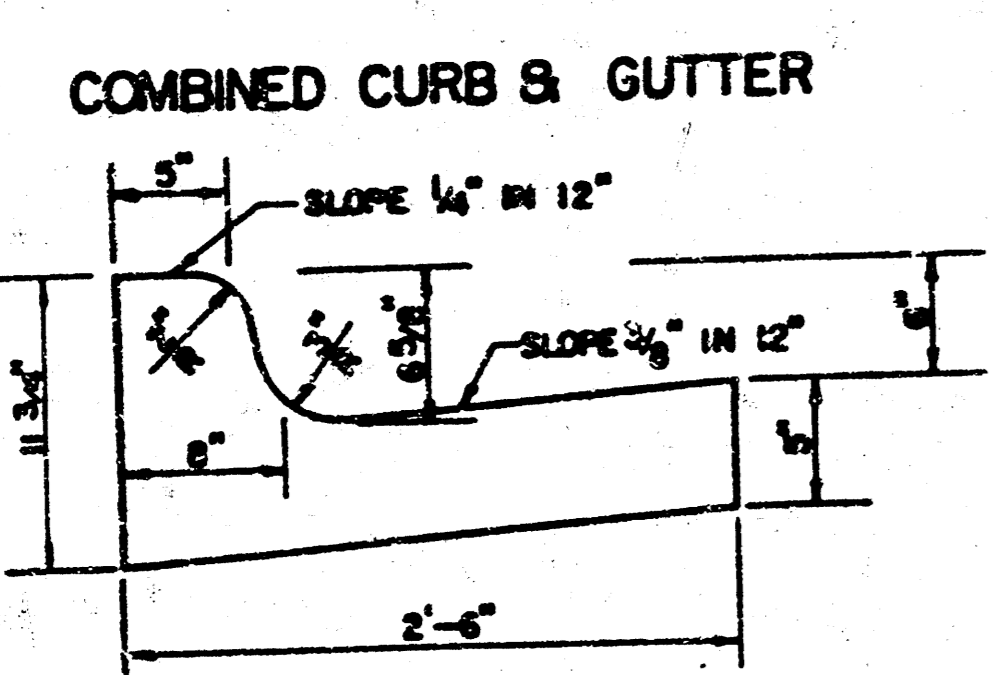

NOTE
 The 2\"/>

GENERAL NOTES

- 1) THE ASPHALTIC CONCRETE PAVEMENT BETWEEN THE COMBINED CURB AND GUTTER SHALL BE PAID AS SQUARE YARDS OF 3\"/>
- 2) THE BITUMINOUS BASE UNDER AND BEHIND THE COMBINED CURB AND GUTTER SHALL BE PAID AS SQUARE YARDS OF 3\"/>
- 3) A TACK COAT OF EMULSIFIED ASPHALT (SC-1H OR CSS-1H) SHALL BE APPLIED AT AN APPROXIMATE RATE OF 0.05 GALLONS PER SQUARE YARD BETWEEN EACH LIFT OF ASPHALTIC MATERIAL.
- 4) BITUMINOUS BASE AND ASPHALTIC CONCRETE WEARING SURFACE SHALL BE PLACED WITH A LAYDOWN MACHINE MONITORING AUTOMATIC CONTROLS FOR LINE AND GRADE.
- 5) CONSTRUCTION JOINTS IN EACH LIFT SHALL BE STAGGERED A MINIMUM DISTANCE OF ONE (1) FOOT FROM JOINTS IN PRECEDING LIFTS AND PLACED SO THAT A JOINT WILL BE CONSTRUCTED ON THE CENTERLINE OF THE TOP LIFT.
- 6) CONTRACTOR TO BID ONLY ONE SUBGRADE TREATMENT ALTERNATE WHEN ALTERNATES A & B PROVIDED IN THE PROPOSAL AND CONTRACT. THE ALTERNATE CHOSEN BY THE SUCCESSFUL BIDDER SHALL BE USED IN CONSTRUCTING THIS PROJECT.

TRANSVERSE CONSTRUCTION JOINTS

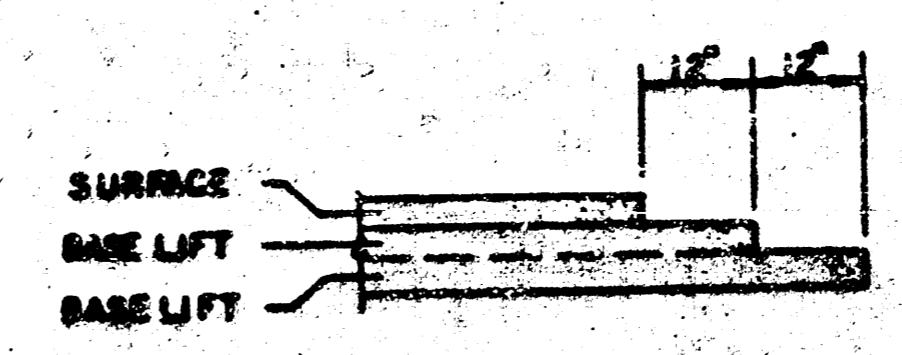

TRANSVERSE CONSTRUCTION JOINTS SHALL BE CONSTRUCTED IN FLEXIBLE BASE PAVEMENTS AT LOCATIONS WHERE PAVEMENT JOINTS EXISTING FLEXIBLE BASE PAVEMENT AS SHOWN BY THE DETAIL. ALL COSTS ASSOCIATED WITH THE CONSTRUCTION OF THE TRANSVERSE JOINT SHALL BE INCLUDED IN THE BID PRICE FOR SQUARE YARDS OF ASPHALTIC CONCRETE (6\"/>

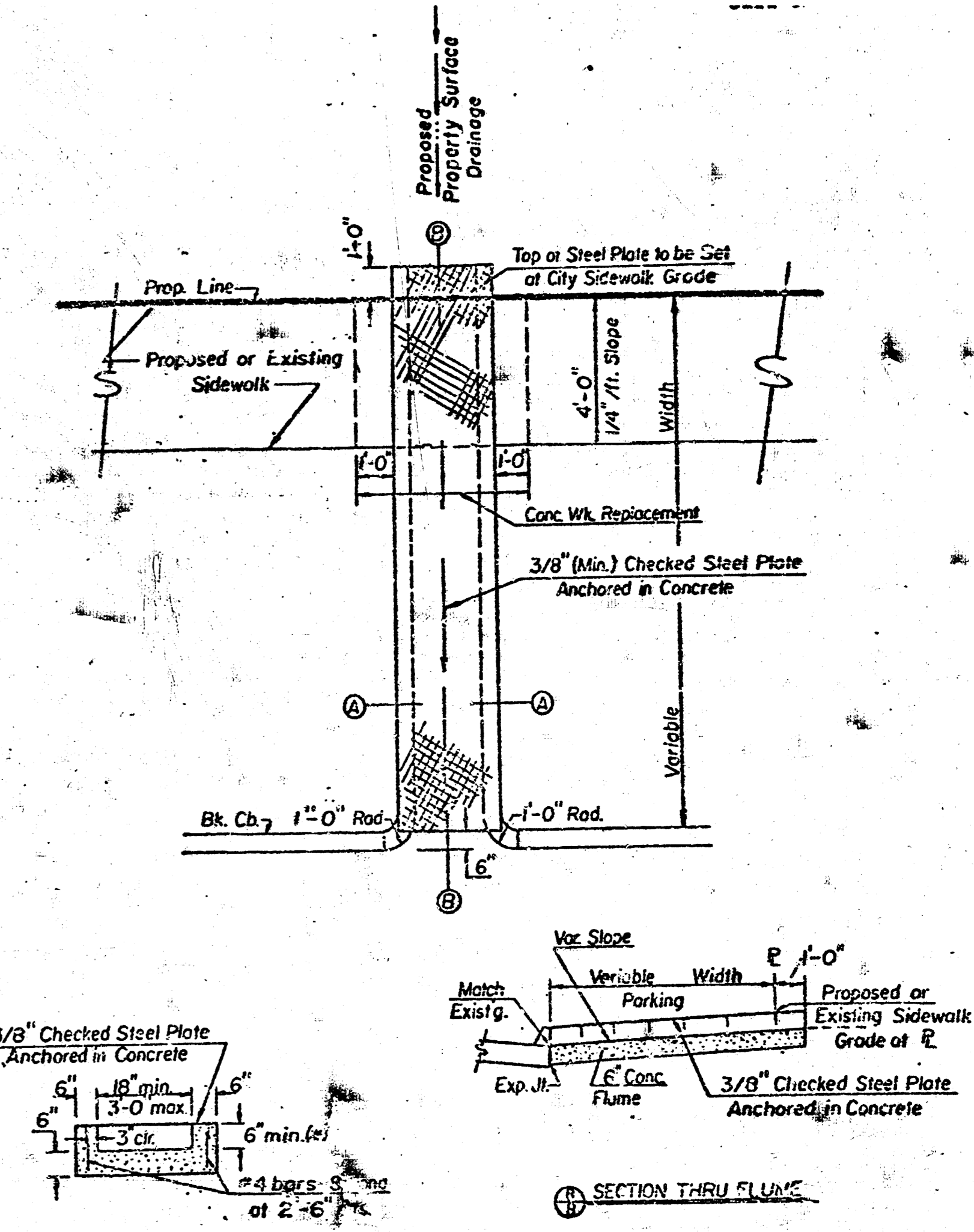

CONCRETE FLUME DETAIL (Thru Street Parings)

8 INCH RESIDENTIAL ASPHALTIC CONCRETE PAVEMENT WITH 6 INCH BITUMINOUS BASE
CITY OF WICHITA, KANSAS
 PROJECT NUMBER
 472-78-245-81280-000-000-001

2/6

BENCH MARK: CITY OF WICHITA DMC,
56.2' N. & 55' W. OF Q. CENTRAL & TYLER,
ELEV. 143.20

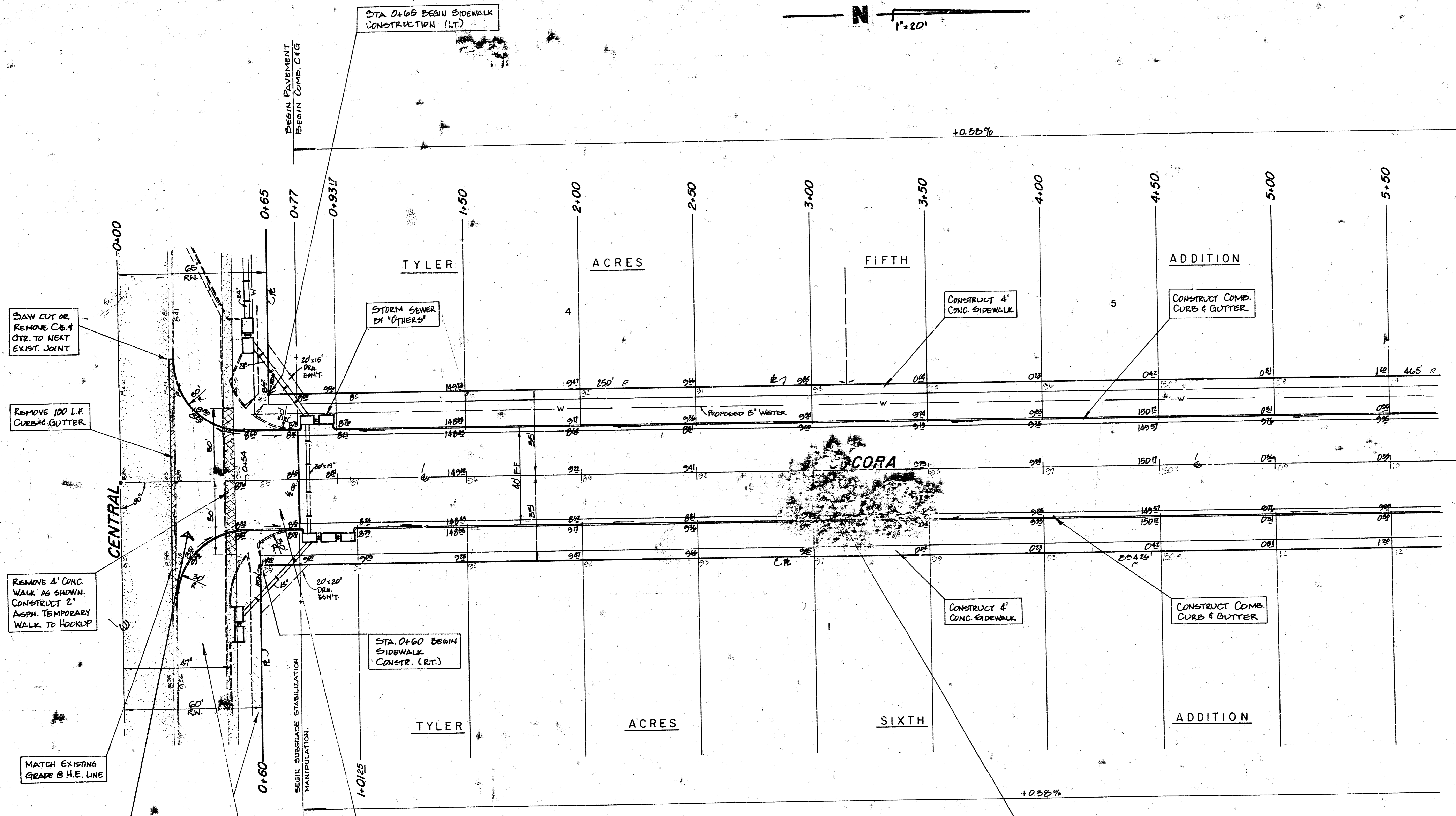
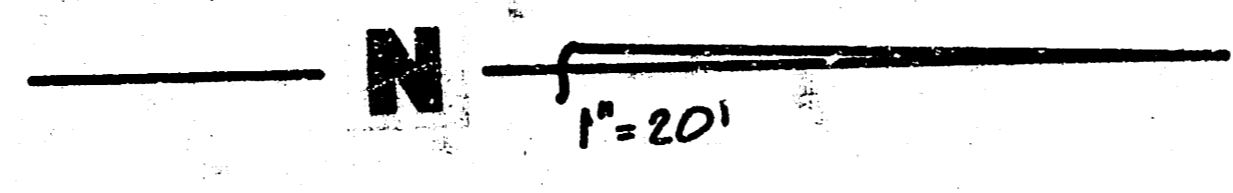

SAW CUT OR REMOVE C&G QTR. TO NEXT EXIST. JOINT

REMOVE 100 L.F. CURB & GUTTER

REMOVE 4' CONC. WALK AS SHOWN. CONSTRUCT 2" ASPH. TEMPORARY WALK TO HOOLUP

MATCH EXISTING GRADE @ H.E. LINE

STA. 0+65 BEGIN SIDEWALK CONSTRUCTION (LT.)

STORM SEWER BY "OTHERS"

STA. 0+60 BEGIN SIDEWALK CONSTR. (RT.)

CONSTRUCT TEMPORARY 5" ASPHALT PAVT. WITH 2" ASPH. CURB TO STA. 0+77
2" ASPH. CURB SHALL BE CONSIDERED AS INCIDENTAL TO THE END ITEM (5" TEMPORARY ASPH. PAVT.)

NEW PAVEMENT AND SIDEWALK ON CENTRAL BY "OTHERS"

- DENOTES REMOVAL W/ THIS PROJECT
- DENOTES FUTURE CONSTRUCTION

NOTE: 5" TEMPORARY ASPHALT PAVEMENT TO BE PLACED ON (UNTREATED) SUBGRADE, COMPACTED TO 95% STD. DENSITY. CONSTRUCTION OF THIS SUBGRADE TO BE SUBSIDIARY & 50 YDS 5" TEMPORARY ASPH. PAVT.

EARTHWORK QUANTITIES	
EXCAVATION = 3087.2 CY	COMPACTED FILL = 28.5 CY
+ 10 % = 308.7 CY	+ 10 % = 2.9 CY
TOTAL = 3395.9 CY	TOTAL = 31.4 CY
MANIPULATION = 4685 SY	



SOCORA

Project no. 472-76-245-81240-000-001

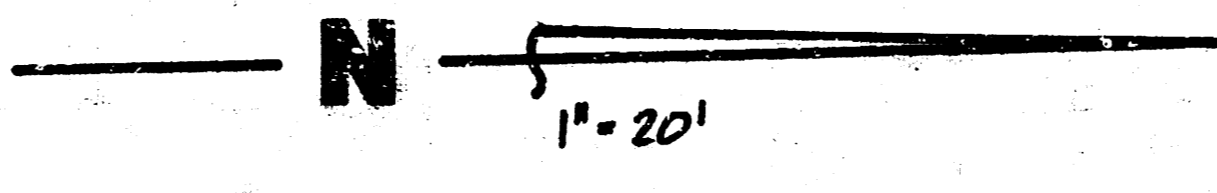

CURVE DATA (LEFT CURB)
 STA. 9+64.8 TO 10+59.52
 BASED ON FACE OF CURB R=1015'

Sta. (on Tan.)	Length (on Tan.)	Length of Arc	Offset from Tan.
9+64.8 P.C.	-	-	-
10+00	35.2'	55.21'	0.40'
10+25	25'	25.05'	1.79'
10+50	25'	25.07'	3.58'
10+59.52 P.I.	9.52'	9.56'	4.43'

* TANGENT OFFSETS ARE TRUE FOR ANY CURB OFFSET.

EXTEND WALK NORTH AS REQUIRED TO CONNECT TO EXISTING WALK.

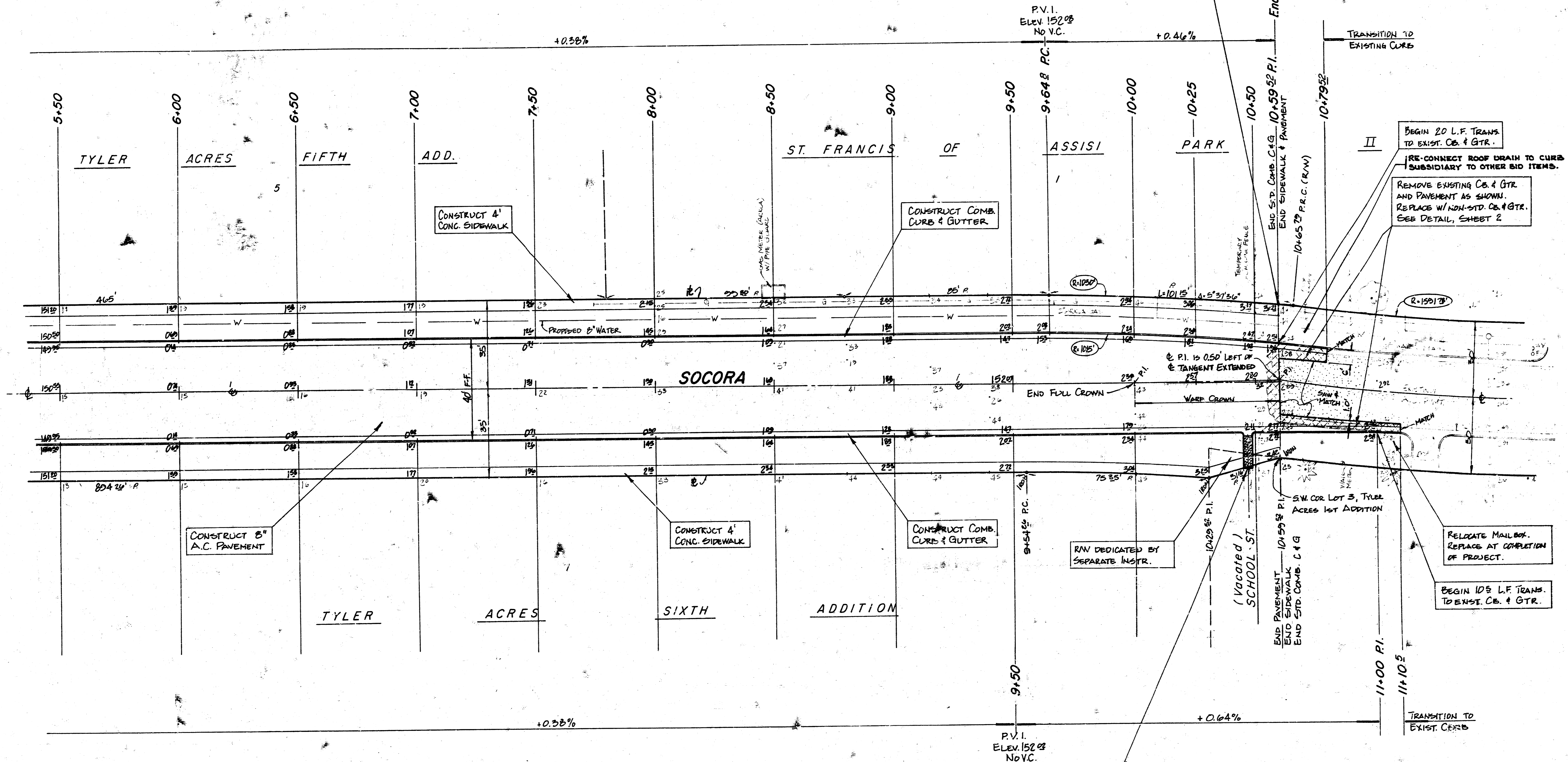

BEGIN 20 L.F. TRANS. TO EXIST. CB. & GTR.
 RE-CONNECT ROOF DRAIN TO CURB SUBSIDIARY TO OTHER SID ITEMS.
 REMOVE EXISTING CB. & GTR. AND PAVEMENT AS SHOWN. REPLACE W/ NON-STD. CB. & GTR. SEE DETAIL, SHEET 2

RELOCATE MAILBOX. REPLACE AT COMPLETION OF PROJECT.
 BEGIN 10.5 L.F. TRANS. TO EXIST. CB. & GTR.

STA. 10+47.5 CONSTRUCT 3'-0" CONCRETE FLUME FL. @ P.L. = 152.88 TOP @ P.L. = 153.34 SEE DETAIL, SHEET 2

SOCORA

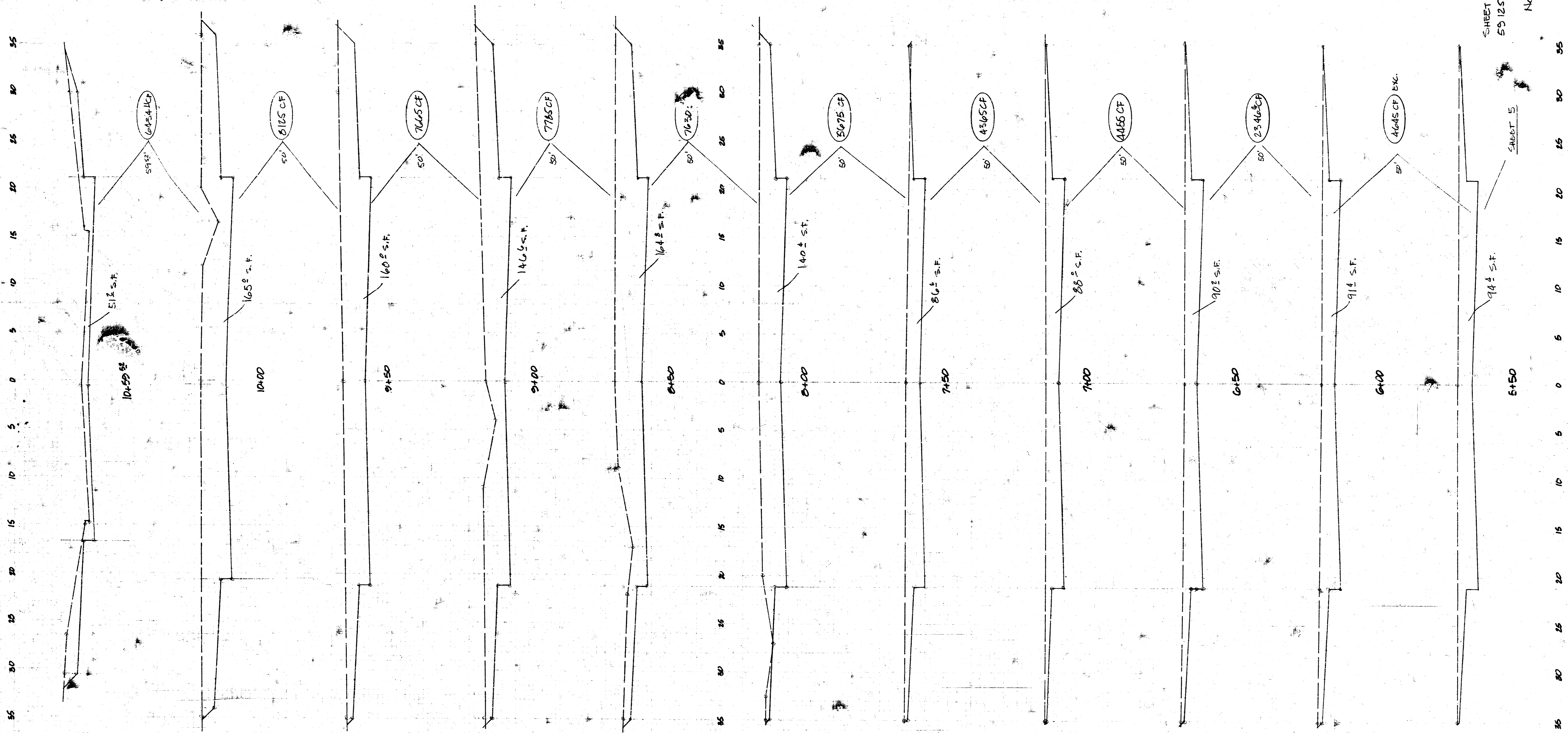

SHEET TOT
59 125 S1 CF EXC.

NO FILL

SHEET 5

SHEET 5 24280 CF
 SHEET 6 59125 S1 CF
 83395 CF
 = 3087 CF EXC.

28³ CY
 0
 28³ CY Comp FILL

SOCORA

PROJ. NO. 472-74-20-81260-00-000-001

8/6