

TAFT STREET
E. L. TRACY STREET TO W. L. FLORENCE STREET
PROJ. No. 472-76-245-80677000-000-001

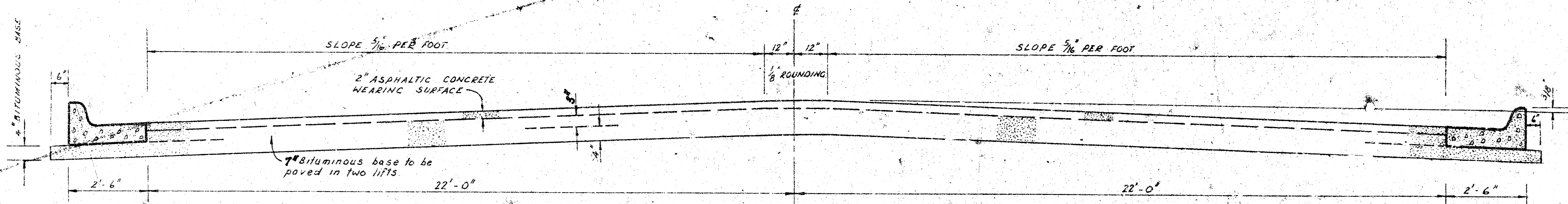

TYPICAL SECTION

The A.C. pavement between the comb. curb & gutter shall be paid as sq. yds. 9" A.C. pavement (7" Bituminous Base).
 The Bituminous Base under the comb. curb & gutter shall be paid as sq. yds. 4" Bituminous Base.

48' ASPHALTIC CONCRETE PAVEMENT WITH BITUMINOUS BASE

A TACK COAT OF EMULSIFIED ASPHALT SS 113 SHALL BE APPLIED AT AN APPROXIMATE RATE 0.05 GALLONS PER SQ. YD. BETWEEN LIFTS OF ASPHALTIC MATERIALS WHEN ORDERED BY THE ENGINEER. TACK COAT WILL NOT BE PAID FOR DIRECTLY AND SHALL BE CONSIDERED AS SUBSIDIARY TO PRICE BID FOR ASPHALTIC PAVEMENT. BITUMINOUS BASE AND ASPHALTIC CONCRETE WEARING SURFACE SHALL BE PLACED WITH A LAYDOWN MACHINE HAVING AUTOMATIC CONTROLS FOR CROWN AND GRADE. CONSTRUCTION JOINTS IN EACH LIFT SHALL BE STAGGERED A MINIMUM DISTANCE OF 1' WITH JOINTS IN PRECEDING LIFTS AND SUCH THAT A JOINT WILL BE CONSTRUCTED ON THE PAVEMENT CENTERLINE IN THE TOP LIFT.

DETAIL OF TRANSVERSE CONSTRUCTION JOINTS.

TRANSVERSE CONSTRUCTION JOINTS SHALL BE CONSTRUCTED IN FLEXIBLE BASE PAVEMENTS AT LOCATIONS WHERE PAVEMENT TEMPORARILY ENDS TO FACILITATE FUTURE PAVEMENT CONSTRUCTION AS SHOWN BY DETAIL. THE COST OF CONSTRUCTING THE TRANSVERSE CONSTRUCTION JOINTS SHALL NOT BE MEASURED OR PAID FOR DIRECTLY BUT SHALL BE INCLUDED IN THE BID PRICE FOR SQUARE YARDS OF ASPHALTIC CONCRETE PAVEMENT.

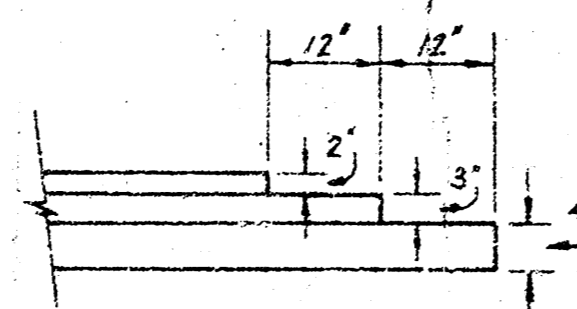

COMBINED CURB & GUTTER

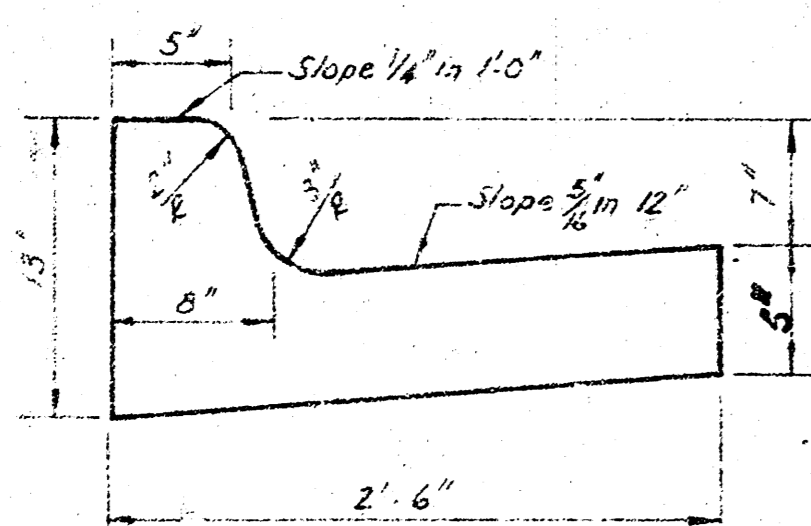

ROLL TYPE CURB & GUTTER

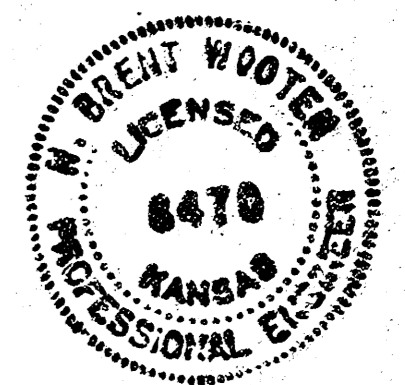
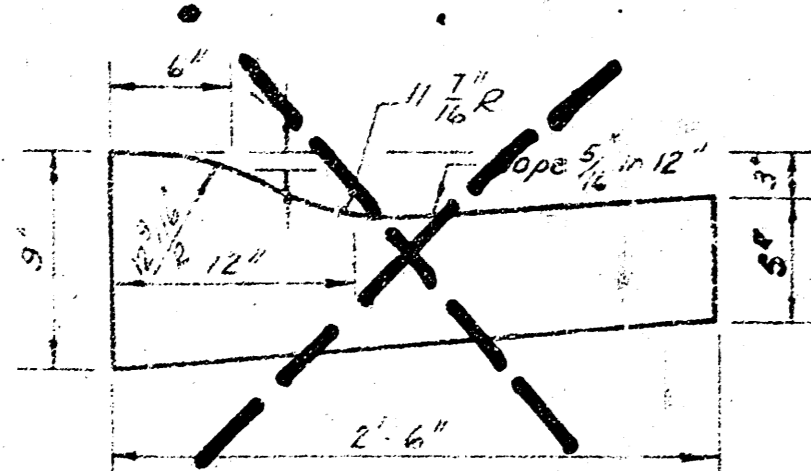

CITY OF WICHITA, KANSAS.

DEPARTMENT of PUBLIC WORKS - Engineering Division.

DEAN SELLERS Acting City Engineer

DATE _____

14

B.M. 120.12 'D' Top on 2.5' Diameter concrete base to light tower 53' East of $\frac{1}{4}$ of Tracy and 90.5' South of $\frac{1}{4}$ of Taft.

Scale: 1" = 80'

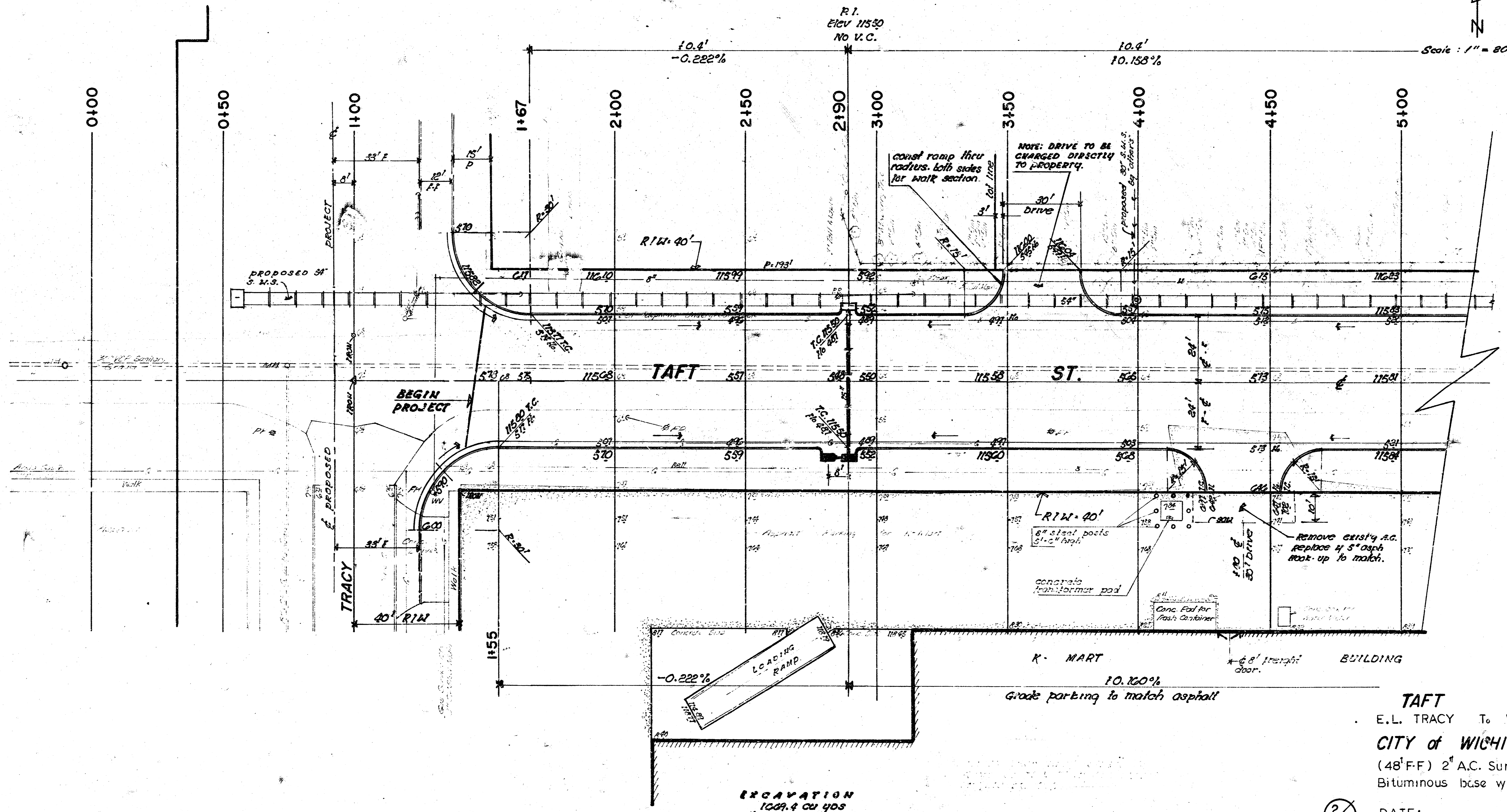

EXCAVATION
 1029.4 cu yds
 18% 184.9
 1836.5 cu yds

NO SUBGRADE MODIFICATION ON THIS PROJECT

2/5

TAFT STREET
 E.L. TRACY To W.L. FLORENCE
 CITY OF WICHITA, KANSAS
 (48' F.F.) 2" A.C. Surface — 7"
 Bituminous base w/ comb curb & gtr.
 DATE: _____
 Proj No. 472-76-245-80677000-000-001

FILMED FROM THE BEST AVAILABLE COPY.....

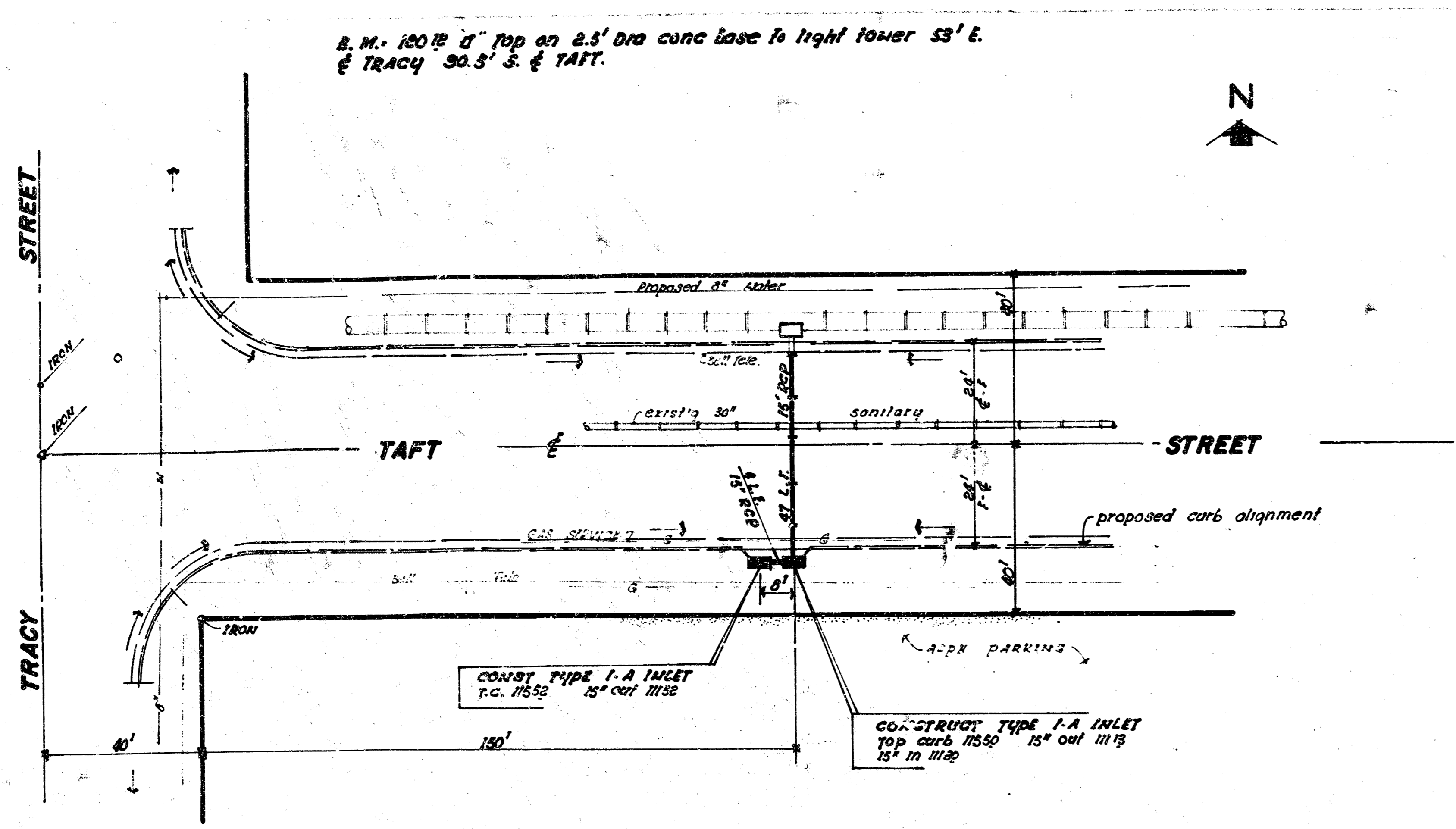

3. M. 100 lb d' top on 2.5' dia conc base to light tower SS' E.
of Tracy 30.3' S. of TAFT.

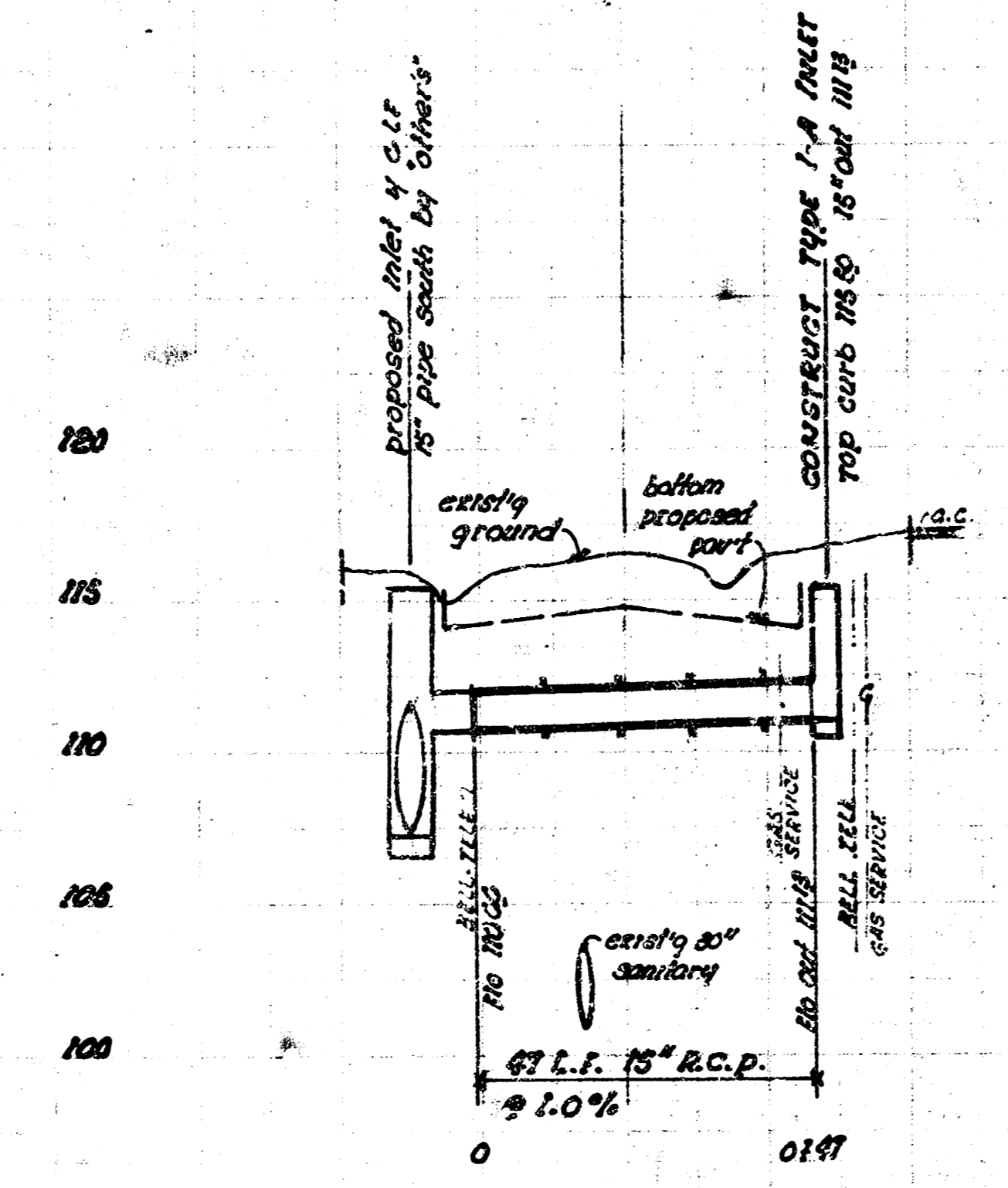

DRAINAGE in connection with paving
TAFT STREET E.L. TRACY TO
 W.L. FLORENCE.
CITY OF WICHITA, KANSAS
 DEAN SELLERS Acting City Engineer
 Date:
 Proj No. 472-76-245-80677000-000-002 4/5

FILMED FROM THE BEST
 AVAILABLE COPY