

B.M. 115.43 N.W. cor. conc. porch Ho. #402 Sheridan
 T.B.M. 114.40 "M" in Mueller fire hyd. N.E. cor. Taft & Sheridan
 T.B.M. 113.43 "M" in Mueller fire hyd. N.E. cor. Custer & Taft

TIES TO IRON & TAFT CUSTER
 250' E to wall in bottle cap W.S. Mulberry tree
 36.02' N.E. to wall in bottle cap N.W. side Bell pole
 42.44' N.W. to R. Iron on N.W. cor. of Taft & Custer

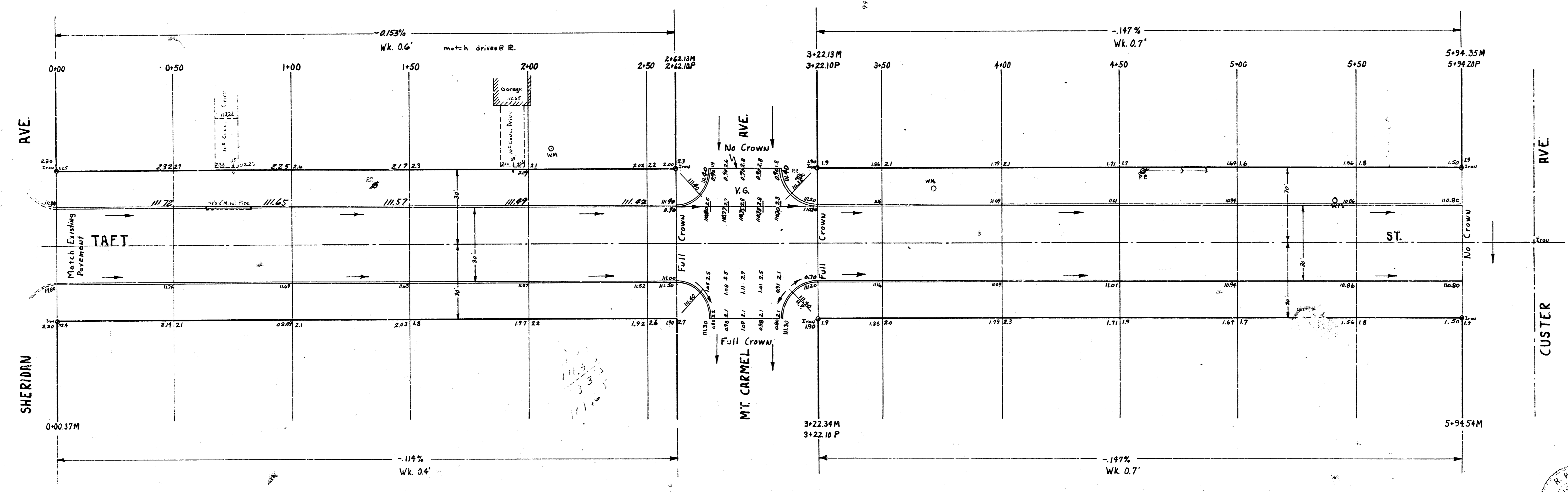

Survey done by E. W. Smith, J. W. Smith, L. W. Swickard
 7/15/58

Excavation
 Prop: 12x96 Cu Yds.
 10% 1250
 13520 Cu Yds.
 City: 2169 Cu Yds.
 10% 217
 2386 Cu Yds.



TAFT ST.
 E.L. Sheridan to W.L. Custer
 30' Conc & Cb.
 CITY OF WICHITA, KANSAS
 B.E. SMITH CITY ENGINEER
 DATE: JULY 1958 PROJ. NO. C16-217

1/2

