

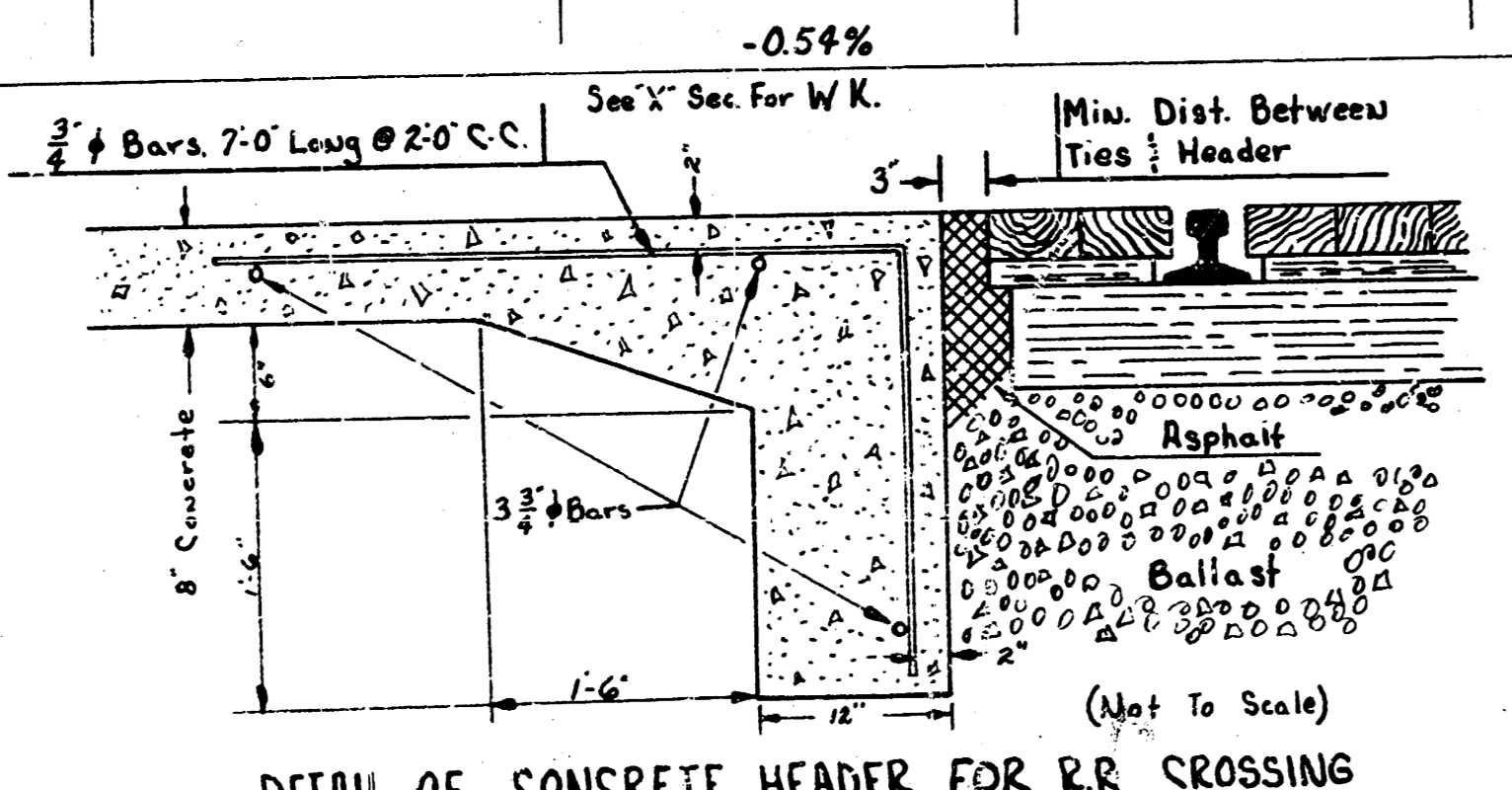

B.M. 112.14 on E. cb. McLean @ Taft.  
 B.M. 111.35 on E. end of cb. Taft, 397' E. of Sycamore St.  
 B.M. 102.19 Iron in thimble @ Sycamore & Hendrix.

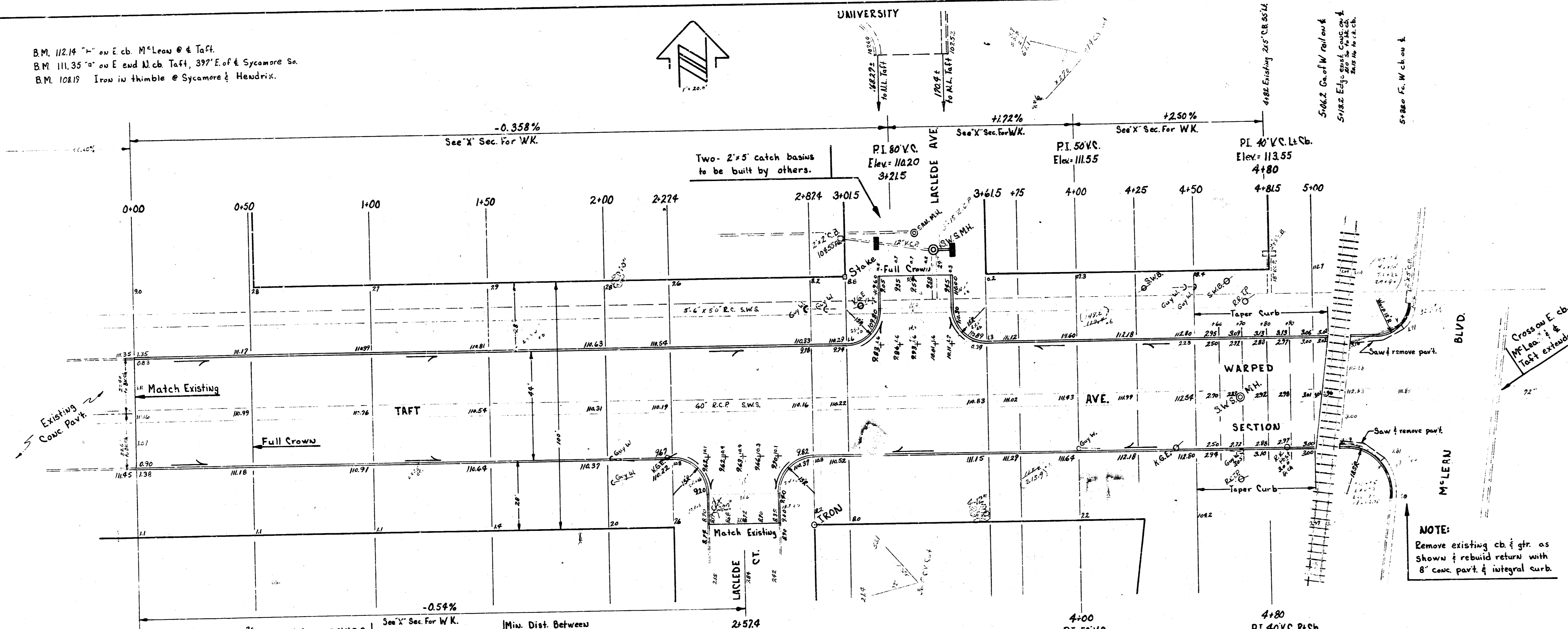
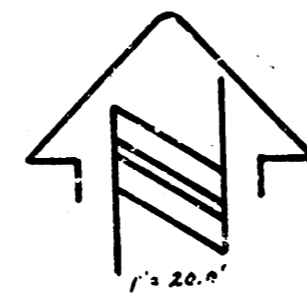

DETAIL OF CONCRETE HEADER FOR RR CROSSING

TOTAL CITY EXCAVATION:

1381.1 Cu Yds. Cut
+0%
1513.2 Cu Yds. Cut

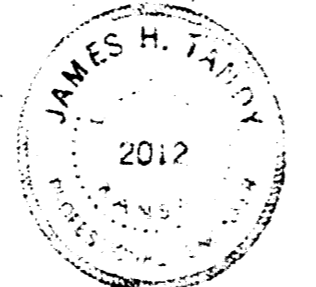

**TAFT AVE.**  
 397' E. OF Sycamore to W.L. McLEAN  
 44\"/>

**CITY OF WICHITA, KANSAS**  
 B.E. SMITH CITY ENGINEER  
 DATE: MARCH, 1959 PROJ. NO. C19-12

2/3