

B.M. 183.70 "M" in Mueller on Fire Hyd. N.W. Armour & Central

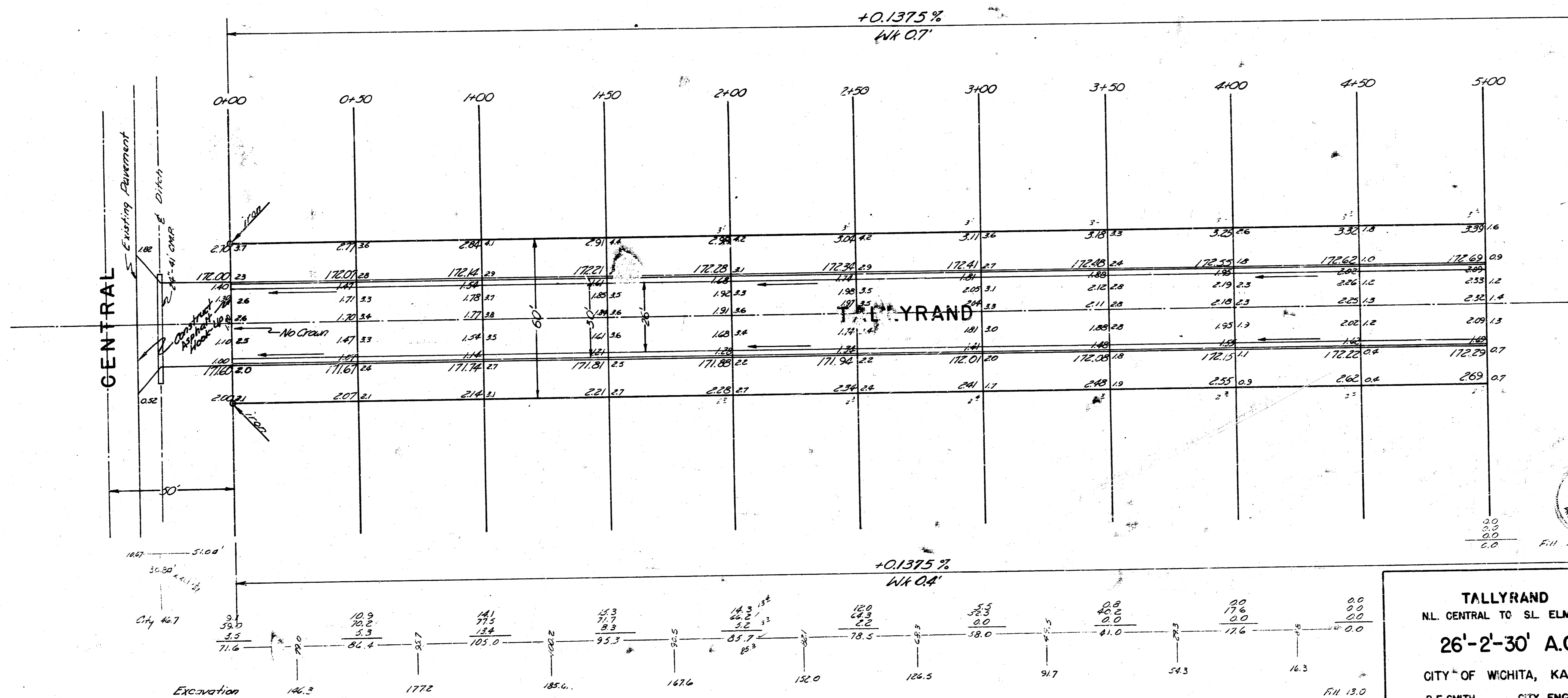

Earthwork		City
Excavation	Property	Excavation
1840.1	44.4	46.7
+ 10% 1841.0	44.4	46.7
1997.6 cu. yd.	48.8 cu. yd.	51.4



E. Young
 Young & Jones
 7-10-29
 Lincoln, D.C.



TALLYRAND
 N.L. CENTRAL TO SL. ELM ST
26'-2'-30' A.C.
 CITY OF WICHITA, KANSAS
 B.E. SMITH CITY ENGINEER
 DATE: JULY 1929 PROJ. NO. C18-205

Sheet 1 of 2

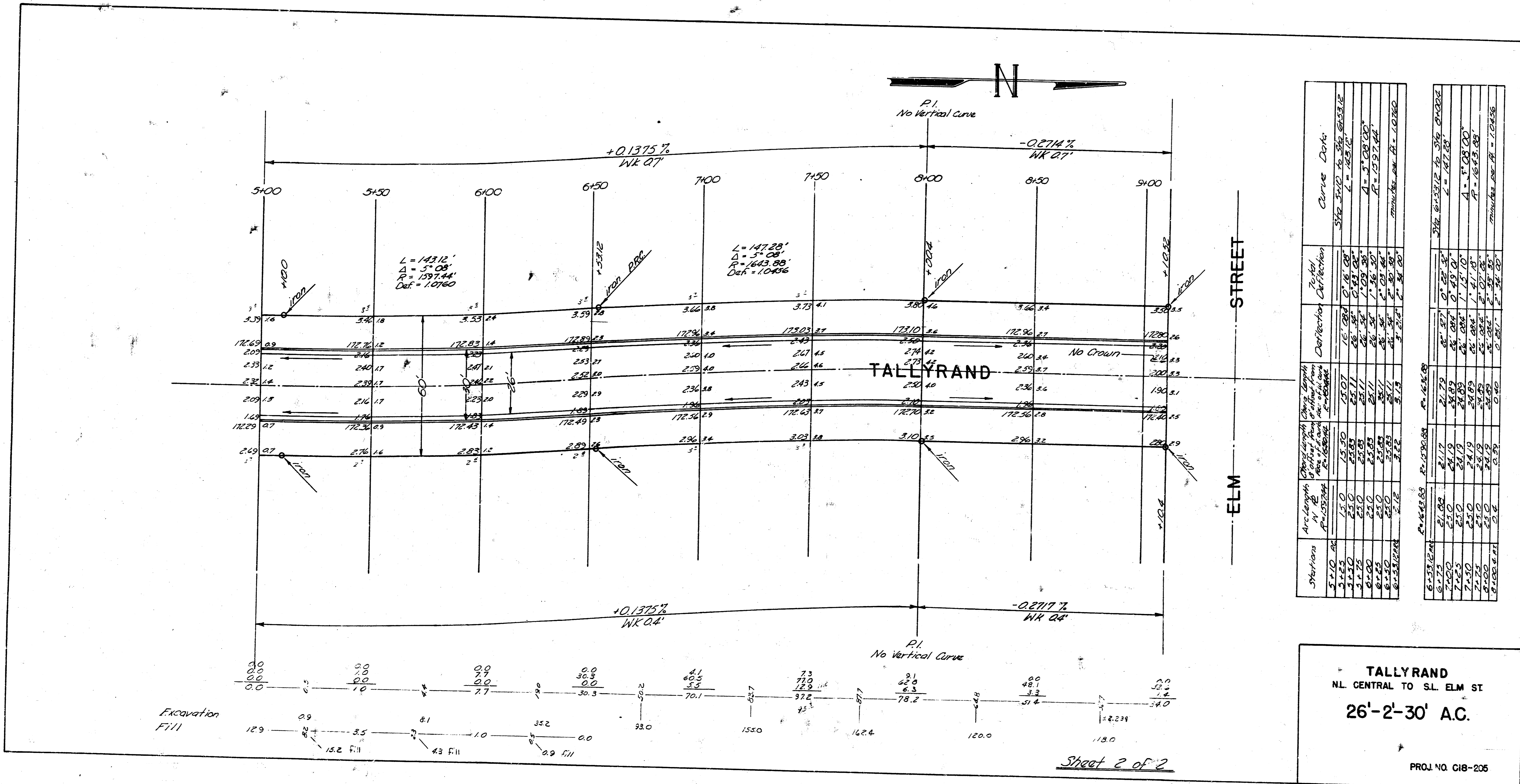

Station	Area	Volume	Deflection	Curve Data
5+10	15.0	15.0	0.18	5% to 3.5% to 3.5% to 5%
5+25	15.0	30.0	0.36	5% to 3.5% to 3.5% to 5%
5+50	15.0	45.0	0.54	5% to 3.5% to 3.5% to 5%
6+00	15.0	60.0	0.72	5% to 3.5% to 3.5% to 5%
6+25	15.0	75.0	0.90	5% to 3.5% to 3.5% to 5%
6+50	15.0	90.0	1.08	5% to 3.5% to 3.5% to 5%
7+00	15.0	105.0	1.26	5% to 3.5% to 3.5% to 5%
7+25	15.0	120.0	1.44	5% to 3.5% to 3.5% to 5%
7+50	15.0	135.0	1.62	5% to 3.5% to 3.5% to 5%
8+00	15.0	150.0	1.80	5% to 3.5% to 3.5% to 5%
8+25	15.0	165.0	1.98	5% to 3.5% to 3.5% to 5%
8+50	15.0	180.0	2.16	5% to 3.5% to 3.5% to 5%
9+00	15.0	195.0	2.34	5% to 3.5% to 3.5% to 5%
9+25	15.0	210.0	2.52	5% to 3.5% to 3.5% to 5%
9+50	15.0	225.0	2.70	5% to 3.5% to 3.5% to 5%
10+00	15.0	240.0	2.88	5% to 3.5% to 3.5% to 5%
10+25	15.0	255.0	3.06	5% to 3.5% to 3.5% to 5%
10+50	15.0	270.0	3.24	5% to 3.5% to 3.5% to 5%
11+00	15.0	285.0	3.42	5% to 3.5% to 3.5% to 5%
11+25	15.0	300.0	3.60	5% to 3.5% to 3.5% to 5%
11+50	15.0	315.0	3.78	5% to 3.5% to 3.5% to 5%
12+00	15.0	330.0	3.96	5% to 3.5% to 3.5% to 5%
12+25	15.0	345.0	4.14	5% to 3.5% to 3.5% to 5%
12+50	15.0	360.0	4.32	5% to 3.5% to 3.5% to 5%
13+00	15.0	375.0	4.50	5% to 3.5% to 3.5% to 5%
13+25	15.0	390.0	4.68	5% to 3.5% to 3.5% to 5%
13+50	15.0	405.0	4.86	5% to 3.5% to 3.5% to 5%
14+00	15.0	420.0	5.04	5% to 3.5% to 3.5% to 5%
14+25	15.0	435.0	5.22	5% to 3.5% to 3.5% to 5%
14+50	15.0	450.0	5.40	5% to 3.5% to 3.5% to 5%
15+00	15.0	465.0	5.58	5% to 3.5% to 3.5% to 5%
15+25	15.0	480.0	5.76	5% to 3.5% to 3.5% to 5%
15+50	15.0	495.0	5.94	5% to 3.5% to 3.5% to 5%
16+00	15.0	510.0	6.12	5% to 3.5% to 3.5% to 5%
16+25	15.0	525.0	6.30	5% to 3.5% to 3.5% to 5%
16+50	15.0	540.0	6.48	5% to 3.5% to 3.5% to 5%
17+00	15.0	555.0	6.66	5% to 3.5% to 3.5% to 5%
17+25	15.0	570.0	6.84	5% to 3.5% to 3.5% to 5%
17+50	15.0	585.0	7.02	5% to 3.5% to 3.5% to 5%
18+00	15.0	600.0	7.20	5% to 3.5% to 3.5% to 5%
18+25	15.0	615.0	7.38	5% to 3.5% to 3.5% to 5%
18+50	15.0	630.0	7.56	5% to 3.5% to 3.5% to 5%
19+00	15.0	645.0	7.74	5% to 3.5% to 3.5% to 5%
19+25	15.0	660.0	7.92	5% to 3.5% to 3.5% to 5%
19+50	15.0	675.0	8.10	5% to 3.5% to 3.5% to 5%
20+00	15.0	690.0	8.28	5% to 3.5% to 3.5% to 5%
20+25	15.0	705.0	8.46	5% to 3.5% to 3.5% to 5%
20+50	15.0	720.0	8.64	5% to 3.5% to 3.5% to 5%
21+00	15.0	735.0	8.82	5% to 3.5% to 3.5% to 5%
21+25	15.0	750.0	9.00	5% to 3.5% to 3.5% to 5%
21+50	15.0	765.0	9.18	5% to 3.5% to 3.5% to 5%
22+00	15.0	780.0	9.36	5% to 3.5% to 3.5% to 5%
22+25	15.0	795.0	9.54	5% to 3.5% to 3.5% to 5%
22+50	15.0	810.0	9.72	5% to 3.5% to 3.5% to 5%
23+00	15.0	825.0	9.90	5% to 3.5% to 3.5% to 5%
23+25	15.0	840.0	10.08	5% to 3.5% to 3.5% to 5%
23+50	15.0	855.0	10.26	5% to 3.5% to 3.5% to 5%
24+00	15.0	870.0	10.44	5% to 3.5% to 3.5% to 5%
24+25	15.0	885.0	10.62	5% to 3.5% to 3.5% to 5%
24+50	15.0	900.0	10.80	5% to 3.5% to 3.5% to 5%
25+00	15.0	915.0	10.98	5% to 3.5% to 3.5% to 5%
25+25	15.0	930.0	11.16	5% to 3.5% to 3.5% to 5%
25+50	15.0	945.0	11.34	5% to 3.5% to 3.5% to 5%
26+00	15.0	960.0	11.52	5% to 3.5% to 3.5% to 5%
26+25	15.0	975.0	11.70	5% to 3.5% to 3.5% to 5%
26+50	15.0	990.0	11.88	5% to 3.5% to 3.5% to 5%
27+00	15.0	1005.0	12.06	5% to 3.5% to 3.5% to 5%
27+25	15.0	1020.0	12.24	5% to 3.5% to 3.5% to 5%
27+50	15.0	1035.0	12.42	5% to 3.5% to 3.5% to 5%
28+00	15.0	1050.0	12.60	5% to 3.5% to 3.5% to 5%
28+25	15.0	1065.0	12.78	5% to 3.5% to 3.5% to 5%
28+50	15.0	1080.0	12.96	5% to 3.5% to 3.5% to 5%
29+00	15.0	1095.0	13.14	5% to 3.5% to 3.5% to 5%
29+25	15.0	1110.0	13.32	5% to 3.5% to 3.5% to 5%
29+50	15.0	1125.0	13.50	5% to 3.5% to 3.5% to 5%
30+00	15.0	1140.0	13.68	5% to 3.5% to 3.5% to 5%
30+25	15.0	1155.0	13.86	5% to 3.5% to 3.5% to 5%
30+50	15.0	1170.0	14.04	5% to 3.5% to 3.5% to 5%
31+00	15.0	1185.0	14.22	5% to 3.5% to 3.5% to 5%
31+25	15.0	1200.0	14.40	5% to 3.5% to 3.5% to 5%
31+50	15.0	1215.0	14.58	5% to 3.5% to 3.5% to 5%
32+00	15.0	1230.0	14.76	5% to 3.5% to 3.5% to 5%
32+25	15.0	1245.0	14.94	5% to 3.5% to 3.5% to 5%
32+50	15.0	1260.0	15.12	5% to 3.5% to 3.5% to 5%
33+00	15.0	1275.0	15.30	5% to 3.5% to 3.5% to 5%
33+25	15.0	1290.0	15.48	5% to 3.5% to 3.5% to 5%
33+50	15.0	1305.0	15.66	5% to 3.5% to 3.5% to 5%
34+00	15.0	1320.0	15.84	5% to 3.5% to 3.5% to 5%
34+25	15.0	1335.0	16.02	5% to 3.5% to 3.5% to 5%
34+50	15.0	1350.0	16.20	5% to 3.5% to 3.5% to 5%
35+00	15.0	1365.0	16.38	5% to 3.5% to 3.5% to 5%
35+25	15.0	1380.0	16.56	5% to 3.5% to 3.5% to 5%
35+50	15.0	1395.0	16.74	5% to 3.5% to 3.5% to 5%
36+00	15.0	1410.0	16.92	5% to 3.5% to 3.5% to 5%
36+25	15.0	1425.0	17.10	5% to 3.5% to 3.5% to 5%
36+50	15.0	1440.0	17.28	5% to 3.5% to 3.5% to 5%
37+00	15.0	1455.0	17.46	5% to 3.5% to 3.5% to 5%
37+25	15.0	1470.0	17.64	5% to 3.5% to 3.5% to 5%
37+50	15.0	1485.0	17.82	5% to 3.5% to 3.5% to 5%
38+00	15.0	1500.0	18.00	5% to 3.5% to 3.5% to 5%
38+25	15.0	1515.0	18.18	5% to 3.5% to 3.5% to 5%
38+50	15.0	1530.0	18.36	5% to 3.5% to 3.5% to 5%
39+00	15.0	1545.0	18.54	5% to 3.5% to 3.5% to 5%
39+25	15.0	1560.0	18.72	5% to 3.5% to 3.5% to 5%
39+50	15.0	1575.0	18.90	5% to 3.5% to 3.5% to 5%
40+00	15.0	1590.0	19.08	5% to 3.5% to 3.5% to 5%
40+25	15.0	1605.0	19.26	5% to 3.5% to 3.5% to 5%
40+50	15.0	1620.0	19.44	5% to 3.5% to 3.5% to 5%
41+00	15.0	1635.0	19.62	5% to 3.5% to 3.5% to 5%
41+25	15.0	1650.0	19.80	5% to 3.5% to 3.5% to 5%
41+50	15.0	1665.0	19.98	5% to 3.5% to 3.5% to 5%
42+00	15.0	1680.0	20.16	5% to 3.5% to 3.5% to 5%
42+25	15.0	1695.0	20.34	5% to 3.5% to 3.5% to 5%
42+50	15.0	1710.0	20.52	5% to 3.5% to 3.5% to 5%
43+00	15.0	1725.0	20.70	5% to 3.5% to 3.5% to 5%
43+25	15.0	1740.0	20.88	5% to 3.5% to 3.5% to 5%
43+50	15.0	1755.0	21.06	5% to 3.5% to 3.5% to 5%
44+00	15.0	1770.0	21.24	5% to 3.5% to 3.5% to 5%
44+25	15.0	1785.0	21.42	5% to 3.5% to 3.5% to 5%
44+50	15.0	1800.0	21.60	5% to 3.5% to 3.5% to 5%
45+00	15.0	1815.0	21.78	5% to 3.5% to 3.5% to 5%
45+25	15.0	1830.0	21.96	5% to 3.5% to 3.5% to 5%
45+50	15.0	1845.0	22.14	5% to 3.5% to 3.5% to 5%
46+00	15.0	1860.0	22.32	5% to 3.5% to 3.5% to 5%
46+25	15.0	1875.0	22.50	5% to 3.5% to 3.5% to 5%
46+50	15.0	1890.0	22.68	5% to 3.5% to 3.5% to 5%
47+00	15.0	1905.0	22.86	5% to 3.5% to 3.5% to 5%
47+25	15.0	1920.0	23.04	5% to 3.5% to 3.5% to 5%
47+50	15.0	1935.0	23.22	5% to 3.5% to 3.5% to 5%
48+00	15.0	1950.0	23.40	5% to 3.5% to 3.5% to 5%
48+25	15.0	1965.0	23.58	5% to 3.5% to 3.5% to 5%
48+50	15.0	1980.0	23.76	5% to 3.5% to 3.5% to 5%
49+00	15.0	1995.0	23.94	5% to 3.5% to 3.5% to 5%
49+25	15.0	2010.0	24.12	5% to 3.5% to 3.5% to 5%
49+50	15.0	2025.0	24.30	5% to 3.5% to 3.5% to 5%
50+00	15.0	2040.0	24.48	5% to 3.5% to 3.5% to 5%
50+25	15.0	2055.0	24.66	5% to 3.5% to 3.5% to 5%
50+50	15.0	2070.0	24.84	5% to 3.5% to 3.5% to 5%
51+00	15.0	2085.0	25.02	5% to 3.5% to 3.5% to 5%
51+25	15.0	2100.0	25.20	5% to 3.5% to 3.5% to 5%
51+50	15.0	2115.0	25.38	5% to 3.5% to 3.5% to 5%
52+00	15.0	2130.0	25.56	5% to 3.5% to 3.5% to 5%
52+25	15.0	2145.0	25.74	5% to 3.5% to 3.5% to 5%
52+50	15.0	2160.0	25.92	5% to 3.5% to 3.5% to 5%
53+00	15.0	2175.0	26.10	5% to 3.5% to 3.5% to 5%
53+25	15.0	2190.0	26.28	5% to 3.5% to 3.5% to 5%
53+50	15.0	2205.0	26.46	5% to 3.5% to 3.5% to 5%
54+00	15.0	2220.0	26.64	5% to 3.5% to 3.5% to 5%
54+25	15.0	2235.0	26.82	5% to 3.5% to 3.5% to 5%
54+50	15.0	2250.0	27.00	5% to 3.5% to 3.5% to 5%
55+00	15.0	2265.0	27.18	5% to 3.5% to 3.5% to 5%
55+25	15.0	2280.0	27.36	5% to 3.5% to 3.5% to 5%
55+50	15.0	2295.0	27.54	5% to 3.5% to 3.5% to 5%
56+00	15.0	2310.0	27.72	5% to 3.5% to 3.5% to 5%
56+25	15.0	2325.0	27.90	5% to 3.5% to 3.5% to 5%
56+50	15.0	2340.0	28.08	5% to 3.5% to 3.5% to 5%
57+00	15.0	2355.0	28.26	5% to 3.5% to 3.5% to 5%
57+25	15.0	2370.0	28.44	5% to 3.5% to 3.5% to 5%
57+50	15.0	2385.0	28.62	5% to 3.5% to 3.5% to 5%
58+00	15.0	2400.0	28.80	5% to 3.5% to 3.5% to 5%
58+25	15.0	2415.0	28.98	5% to 3.5% to 3.5% to 5%
58+50	15.0	2430.0	29.16	5% to 3.