

B.M. 12038 R.R. Spike N. face P.P. South east
Cor 18TH and WASHINGTON.

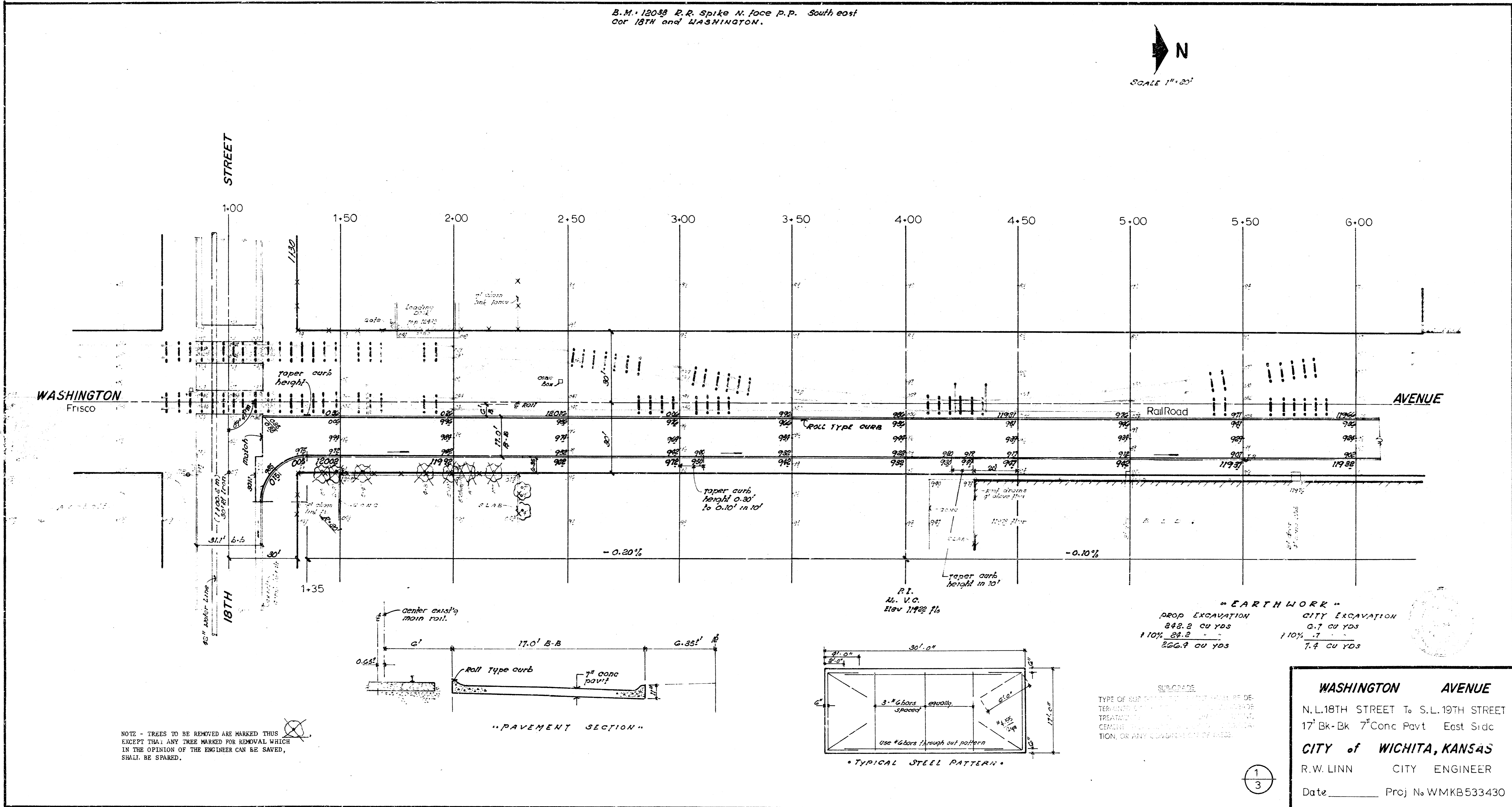

SURV. 11/10/00 E. J. W. 223
 PLAN 11/10/00
 1/2" = 10'

NOTE - TREES TO BE REMOVED ARE MARKED WITH
 EXCEPT THOSE ANY TREE MARKED FOR REMOVAL WHICH
 IN THE OPINION OF THE ENGINEER CAN BE SAVED,
 SHALL BE SPARED.

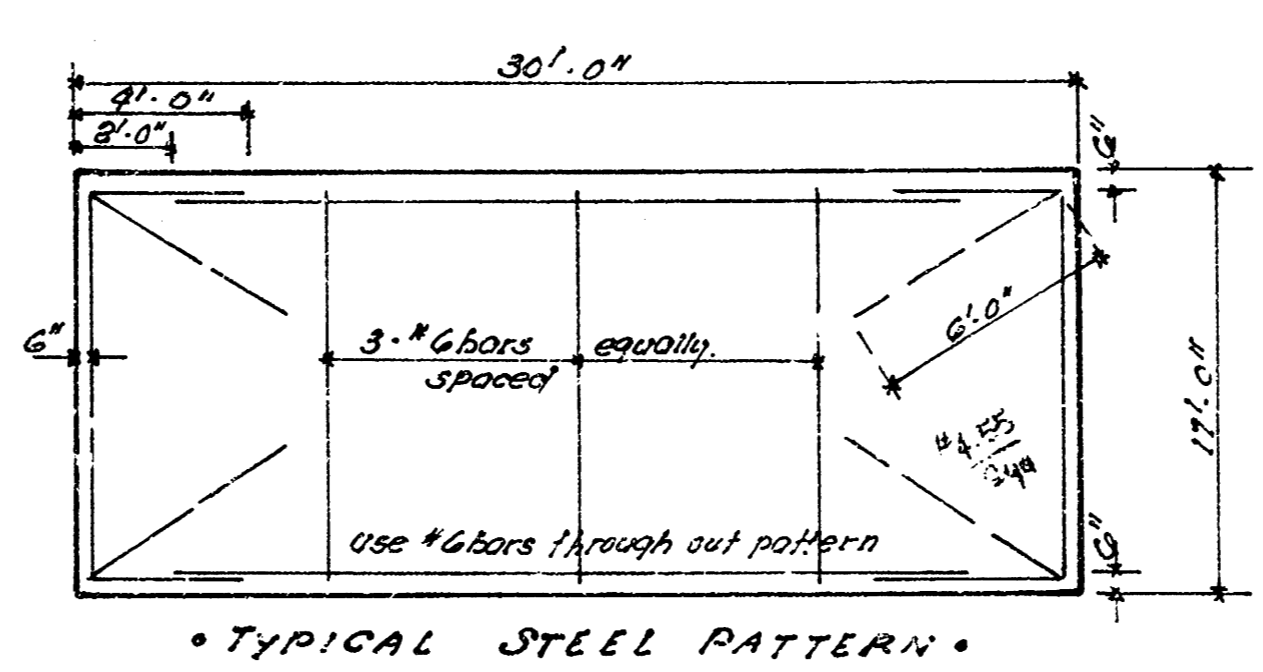
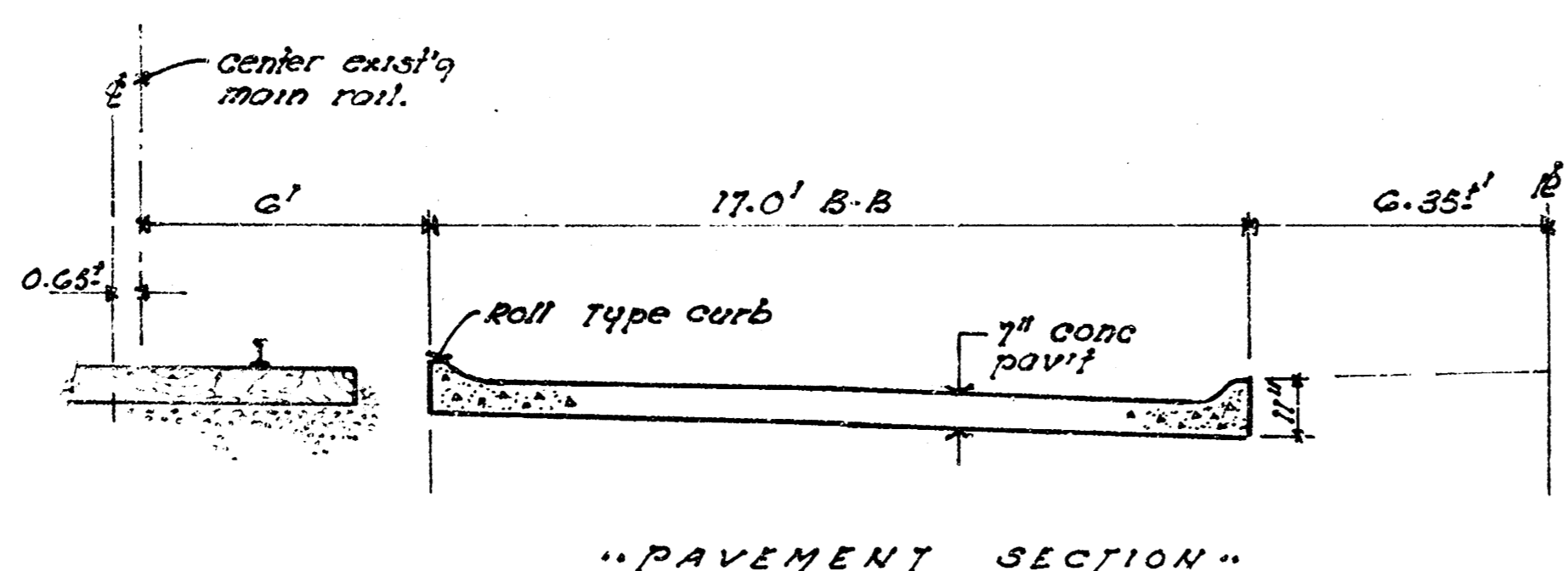

"EARTH WORK"

PROP EXCAVATION	CITY EXCAVATION
848.2 cu yds	0.7 cu yds
110% 28.2	110% .7
266.9 cu yds	7.4 cu yds

SUBGRADE
 TYPE OF SUBGRADE TO BE USED SHALL BE DE-
 TERMINED BY THE ENGINEER. THE SUBGRADE
 TREATMENT SHALL BE AS FOLLOWS: GRAVEL,
 CEMENT STABILIZED SOIL, OR OTHER MATERIAL,
 OR ANY COMBINATION OF THESE.

WASHINGTON AVENUE
 N.L. 18TH STREET To S.L. 19TH STREET
 17" Bk-Bk 7" Conc Pavt East Side
CITY of WICHITA, KANSAS
 R.W. LINN CITY ENGINEER
 Date _____ Proj No WMKB53430

1
3

