

BM 9363 Base of 3rd Fence Post from end of fence NE cor. Wassall Hydraulic.

BM 9642 RR Spike in NS KGE Pole SS Wassall - ES Rose Marie Ct.

Excavation  
 340.4  
 340.7  
 3750.3 cu yds

Fill  
 348.8  
 313.7 cu yds

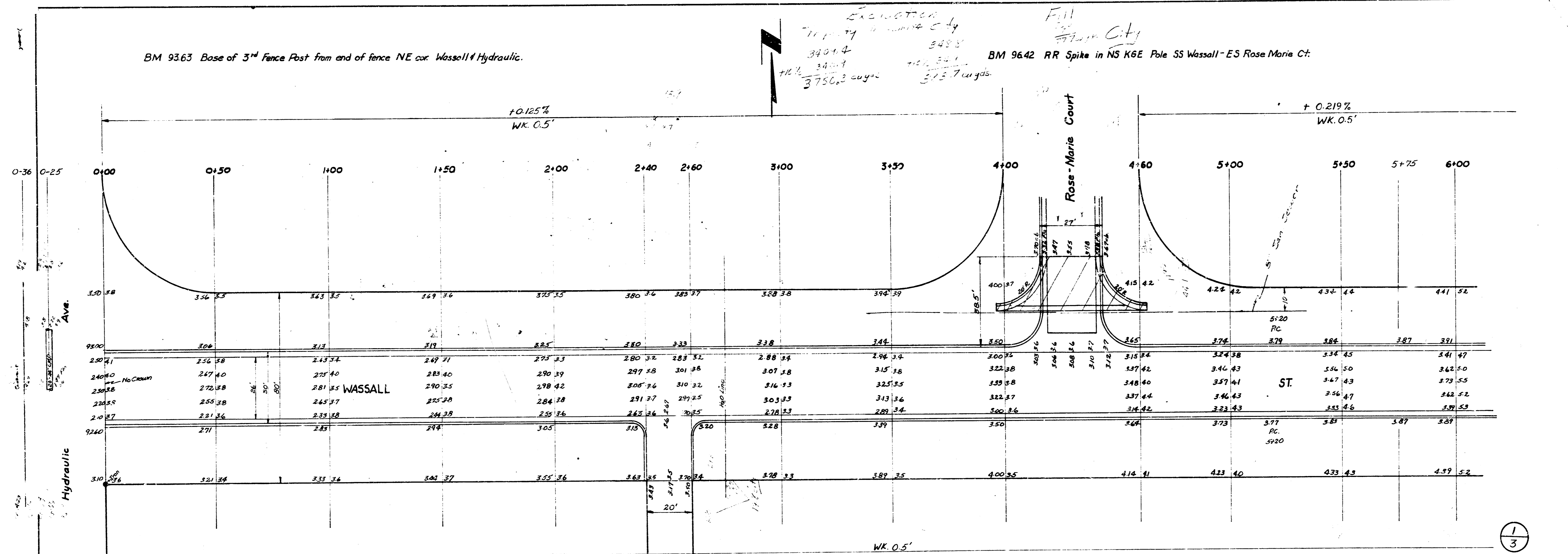

1/2" = 1' WASSALL ST  
 WL. Madison to WL. K-15  
 36-2-40 AC Proj. No. C11-183

WASSALL ST.  
 EL Hydraulic to WL. Madison  
 26-2-30 AC.

CITY OF WICHITA, KANSAS  
 LK. WHITE CITY ENGINEER  
 October 1951 PROJ. NO. C11-184

Handwritten notes and calculations at the bottom of the page, including stationing and elevation data.

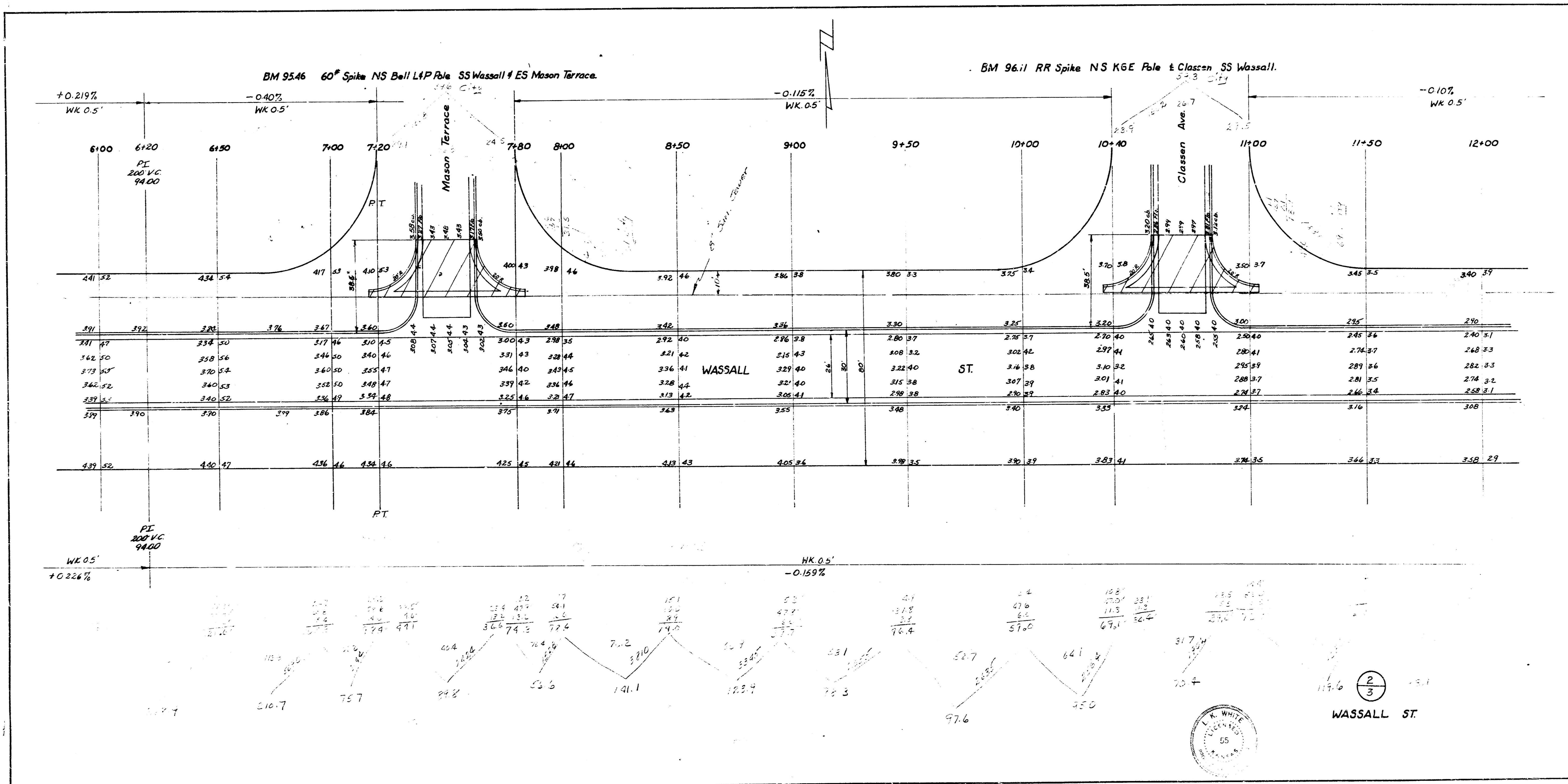

S-8

42.1

