

F.E. Short

B.M. 11547 S.W. Cor. lower Conc. step No. 1009 E. 10th St.
N.E. Cor. 10th & Washington

B.M. 11769 High point top limestone Cor. post
N.S. No. 1149 N. Washington

Ties to iron on W.S. Wash 15' S. of N. PL 10th St.
1. 18.60' N.E. to 4" in Keller BK WK.
2. 28.35' to gauge of W. rail
3. 15.00' N. to cut in Wk.

Ties to iron on E.S. Wash 15' S. of N. PL 10th St.
1. 22.00' W. to gauge of W. rail
2. 22.76' N.E. to 4" in Keller Ctr. WK. E.
3. 30.00' N. to tacked Stake

Property

73.5
66.5
60.9
55.9
51.0
46.1
41.2
36.3
31.4
26.5
21.6
16.7
11.8
6.9
2.0
-2.9
-7.8
-12.7
-17.6
-22.5
-27.4
-32.3
-37.2
-42.1
-47.0
-51.9
-56.8
-61.7
-66.6
-71.5
-76.4
-81.3
-86.2
-91.1
-96.0
-100.9
-105.8
-110.7
-115.6
-120.5
-125.4
-130.3
-135.2
-140.1
-145.0
-149.9
-154.8
-159.7
-164.6
-169.5
-174.4
-179.3
-184.2
-189.1
-194.0
-198.9
-203.8
-208.7
-213.6
-218.5
-223.4
-228.3
-233.2
-238.1
-243.0
-247.9
-252.8
-257.7
-262.6
-267.5
-272.4
-277.3
-282.2
-287.1
-292.0
-296.9
-301.8
-306.7
-311.6
-316.5
-321.4
-326.3
-331.2
-336.1
-341.0
-345.9
-350.8
-355.7
-360.6
-365.5
-370.4
-375.3
-380.2
-385.1
-390.0
-394.9
-399.8
-404.7
-409.6
-414.5
-419.4
-424.3
-429.2
-434.1
-439.0
-443.9
-448.8
-453.7
-458.6
-463.5
-468.4
-473.3
-478.2
-483.1
-488.0
-492.9
-497.8
-502.7
-507.6
-512.5
-517.4
-522.3
-527.2
-532.1
-537.0
-541.9
-546.8
-551.7
-556.6
-561.5
-566.4
-571.3
-576.2
-581.1
-586.0
-590.9
-595.8
-600.7
-605.6
-610.5
-615.4
-620.3
-625.2
-630.1
-635.0
-639.9
-644.8
-649.7
-654.6
-659.5
-664.4
-669.3
-674.2
-679.1
-684.0
-688.9
-693.8
-698.7
-703.6
-708.5
-713.4
-718.3
-723.2
-728.1
-733.0
-737.9
-742.8
-747.7
-752.6
-757.5
-762.4
-767.3
-772.2
-777.1
-782.0
-786.9
-791.8
-796.7
-801.6
-806.5
-811.4
-816.3
-821.2
-826.1
-831.0
-835.9
-840.8
-845.7
-850.6
-855.5
-860.4
-865.3
-870.2
-875.1
-880.0
-884.9
-889.8
-894.7
-899.6
-904.5
-909.4
-914.3
-919.2
-924.1
-929.0
-933.9
-938.8
-943.7
-948.6
-953.5
-958.4
-963.3
-968.2
-973.1
-978.0
-982.9
-987.8
-992.7
-997.6
-1002.5
-1007.4
-1012.3
-1017.2
-1022.1
-1027.0
-1031.9
-1036.8
-1041.7
-1046.6
-1051.5
-1056.4
-1061.3
-1066.2
-1071.1
-1076.0
-1080.9
-1085.8
-1090.7
-1095.6
-1100.5
-1105.4
-1110.3
-1115.2
-1120.1
-1125.0
-1129.9
-1134.8
-1139.7
-1144.6
-1149.5
-1154.4
-1159.3
-1164.2
-1169.1
-1174.0
-1178.9
-1183.8
-1188.7
-1193.6
-1198.5
-1203.4
-1208.3
-1213.2
-1218.1
-1223.0
-1227.9
-1232.8
-1237.7
-1242.6
-1247.5
-1252.4
-1257.3
-1262.2
-1267.1
-1272.0
-1276.9
-1281.8
-1286.7
-1291.6
-1296.5
-1301.4
-1306.3
-1311.2
-1316.1
-1321.0
-1325.9
-1330.8
-1335.7
-1340.6
-1345.5
-1350.4
-1355.3
-1360.2
-1365.1
-1370.0
-1374.9
-1379.8
-1384.7
-1389.6
-1394.5
-1399.4
-1404.3
-1409.2
-1414.1
-1419.0
-1423.9
-1428.8
-1433.7
-1438.6
-1443.5
-1448.4
-1453.3
-1458.2
-1463.1
-1468.0
-1472.9
-1477.8
-1482.7
-1487.6
-1492.5
-1497.4
-1502.3
-1507.2
-1512.1
-1517.0
-1521.9
-1526.8
-1531.7
-1536.6
-1541.5
-1546.4
-1551.3
-1556.2
-1561.1
-1566.0
-1570.9
-1575.8
-1580.7
-1585.6
-1590.5
-1595.4
-1600.3
-1605.2
-1610.1
-1615.0
-1619.9
-1624.8
-1629.7
-1634.6
-1639.5
-1644.4
-1649.3
-1654.2
-1659.1
-1664.0
-1668.9
-1673.8
-1678.7
-1683.6
-1688.5
-1693.4
-1698.3
-1703.2
-1708.1
-1713.0
-1717.9
-1722.8
-1727.7
-1732.6
-1737.5
-1742.4
-1747.3
-1752.2
-1757.1
-1762.0
-1766.9
-1771.8
-1776.7
-1781.6
-1786.5
-1791.4
-1796.3
-1801.2
-1806.1
-1811.0
-1815.9
-1820.8
-1825.7
-1830.6
-1835.5
-1840.4
-1845.3
-1850.2
-1855.1
-1860.0
-1864.9
-1869.8
-1874.7
-1879.6
-1884.5
-1889.4
-1894.3
-1899.2
-1904.1
-1909.0
-1913.9
-1918.8
-1923.7
-1928.6
-1933.5
-1938.4
-1943.3
-1948.2
-1953.1
-1958.0
-1962.9
-1967.8
-1972.7
-1977.6
-1982.5
-1987.4
-1992.3
-1997.2
-2002.1
-2007.0
-2011.9
-2016.8
-2021.7
-2026.6
-2031.5
-2036.4
-2041.3
-2046.2
-2051.1
-2056.0
-2060.9
-2065.8
-2070.7
-2075.6
-2080.5
-2085.4
-2090.3
-2095.2
-2100.1
-2105.0
-2109.9
-2114.8
-2119.7
-2124.6
-2129.5
-2134.4
-2139.3
-2144.2
-2149.1
-2154.0
-2158.9
-2163.8
-2168.7
-2173.6
-2178.5
-2183.4
-2188.3
-2193.2
-2198.1
-2203.0
-2207.9
-2212.8
-2217.7
-2222.6
-2227.5
-2232.4
-2237.3
-2242.2
-2247.1
-2252.0
-2256.9
-2261.8
-2266.7
-2271.6
-2276.5
-2281.4
-2286.3
-2291.2
-2296.1
-2301.0
-2305.9
-2310.8
-2315.7
-2320.6
-2325.5
-2330.4
-2335.3
-2340.2
-2345.1
-2350.0
-2354.9
-2359.8
-2364.7
-2369.6
-2374.5
-2379.4
-2384.3
-2389.2
-2394.1
-2399.0
-2403.9
-2408.8
-2413.7
-2418.6
-2423.5
-2428.4
-2433.3
-2438.2
-2443.1
-2448.0
-2452.9
-2457.8
-2462.7
-2467.6
-2472.5
-2477.4
-2482.3
-2487.2
-2492.1
-2497.0
-2501.9
-2506.8
-2511.7
-2516.6
-2521.5
-2526.4
-2531.3
-2536.2
-2541.1
-2546.0
-2550.9
-2555.8
-2560.7
-2565.6
-2570.5
-2575.4
-2580.3
-2585.2
-2590.1
-2595.0
-2600.0

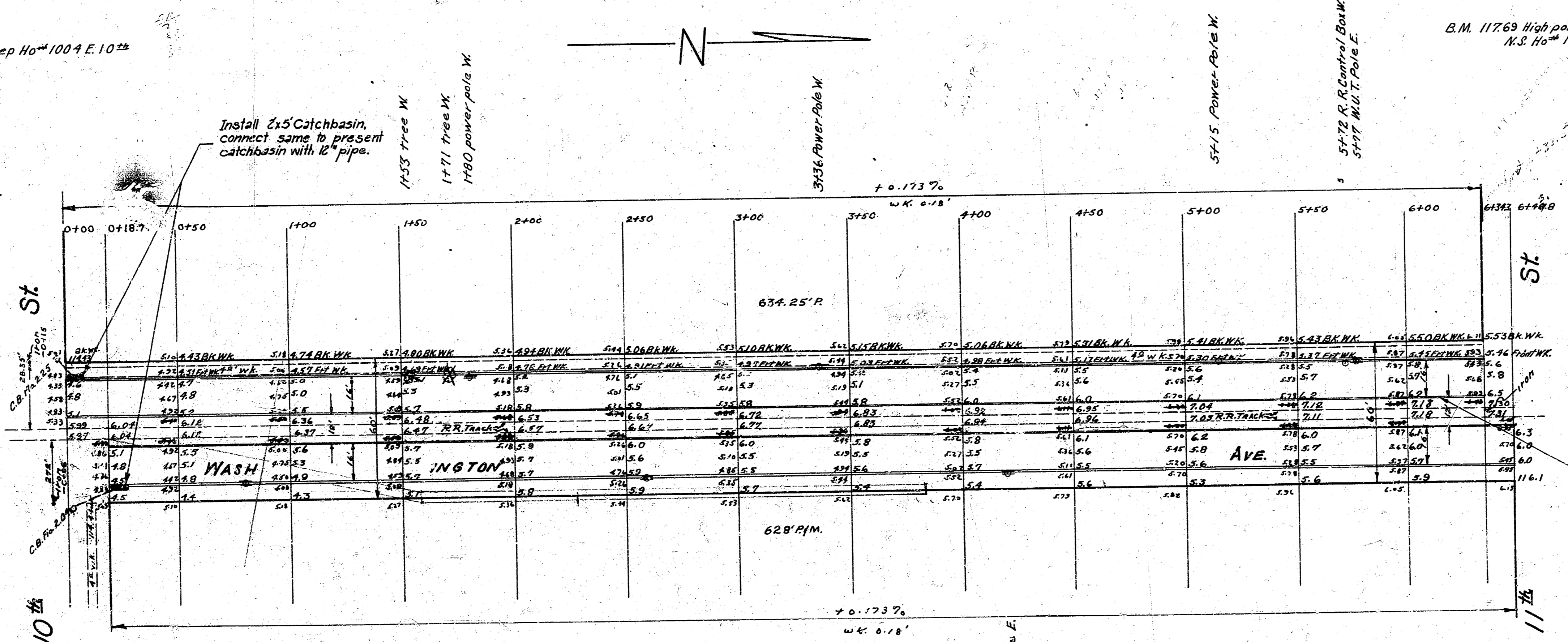

NOTE: Use ramp type ent

Ties to iron on Wash 14' N. Line in 11th St.
1. 18.5' N. of S.L. 11th St.
2. 1.15' N. to gauge of W. rail

NOTE: Curbs shown along rail road are not to be installed. Use Flow Line grades for elevation of edge of slab.

NOTE: Where elevations will permit pour new walk over old walk. Otherwise, the old walk shall be removed.

Washington Ave.
10th St. N.L. ~ 11th St. S.L.
32' Conc. & Curb
City of Wichita, Kansas
L.K. White ~ City Engineer
October 4, 1949 Proj. C-19-158