

B.M. 116.16 Standard S.W. Cor. Washington and 13th Streets.  
 B.M. 117.46 "L" in LeFever c.m. S.W. Cor. Wash. and 14th.  
 Base Line - Chaining N. on 1/4 Sec. Line.

SCALE: 1" = 20'

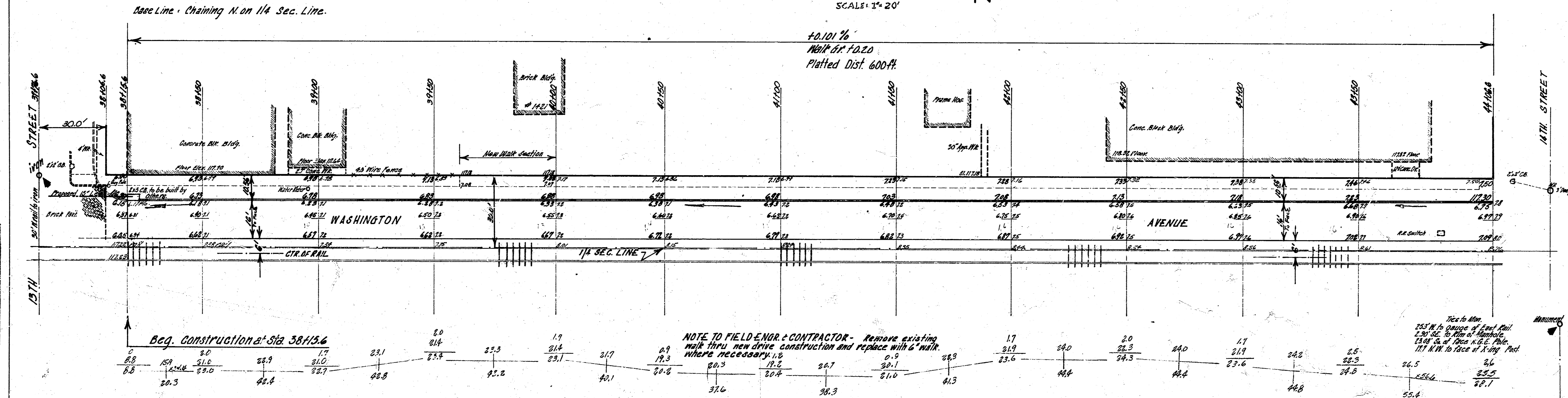

Survey by W.H. ...  
 Plan ...  
 Exc. ...  
 Checked by ...

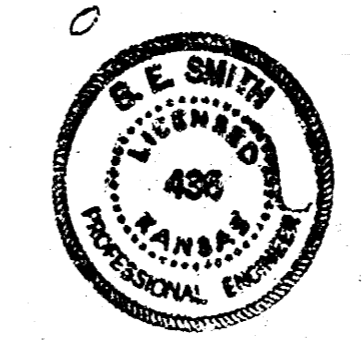

EXCAVATION TOTALS

PROP. 495.0  
 10% 49.5  
 544.5 cu. yds.

CITY

W 1/2 WASHINGTON AVE.  
 N. THIRTEENTH to S. FOURTEENTH  
 150' CONC + CB.  
 CITY OF WICHITA, KANSAS  
 B.E. SMITH CITY ENGINEER  
 DATE: JUNE 1939, PROJ. NO. CIT-77