

WATERMAN EL. Battin to EL. Pinecrest. 20' Asph. Conc.; Curb & Gutter. 5" Conc. Base 2" Asph. Conc. Surface.

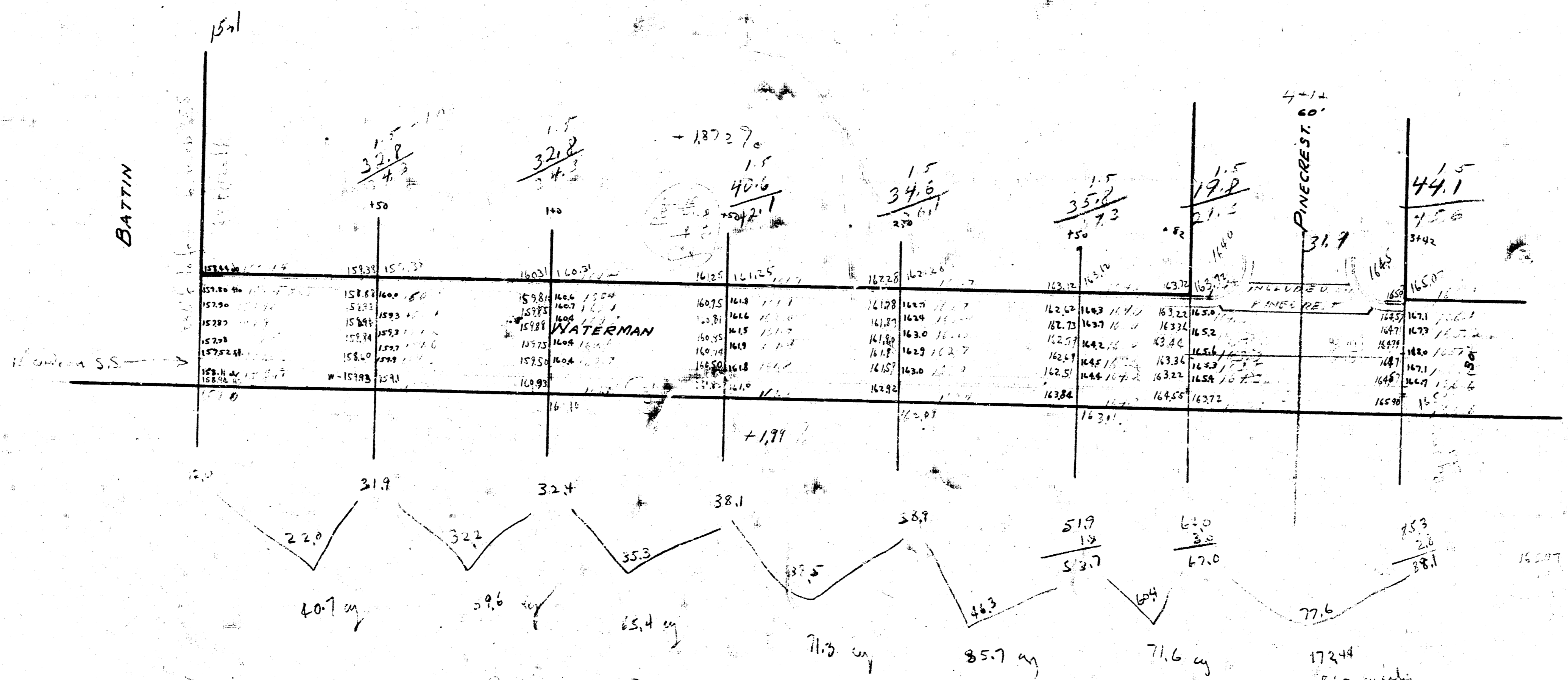

Bill's term - Waterman EL. Battin to EL. Pinecrest  
 Run - at right - 21.7' long in 100' sq.

Waterman EL. Pinecrest in New Old Map  
 Part of EL. Battin 1250 + for straight line  
 as shown in plan. (This part was 30' off)

Prop 480.5  
 41.1  
 521.6

CD 762  
 748

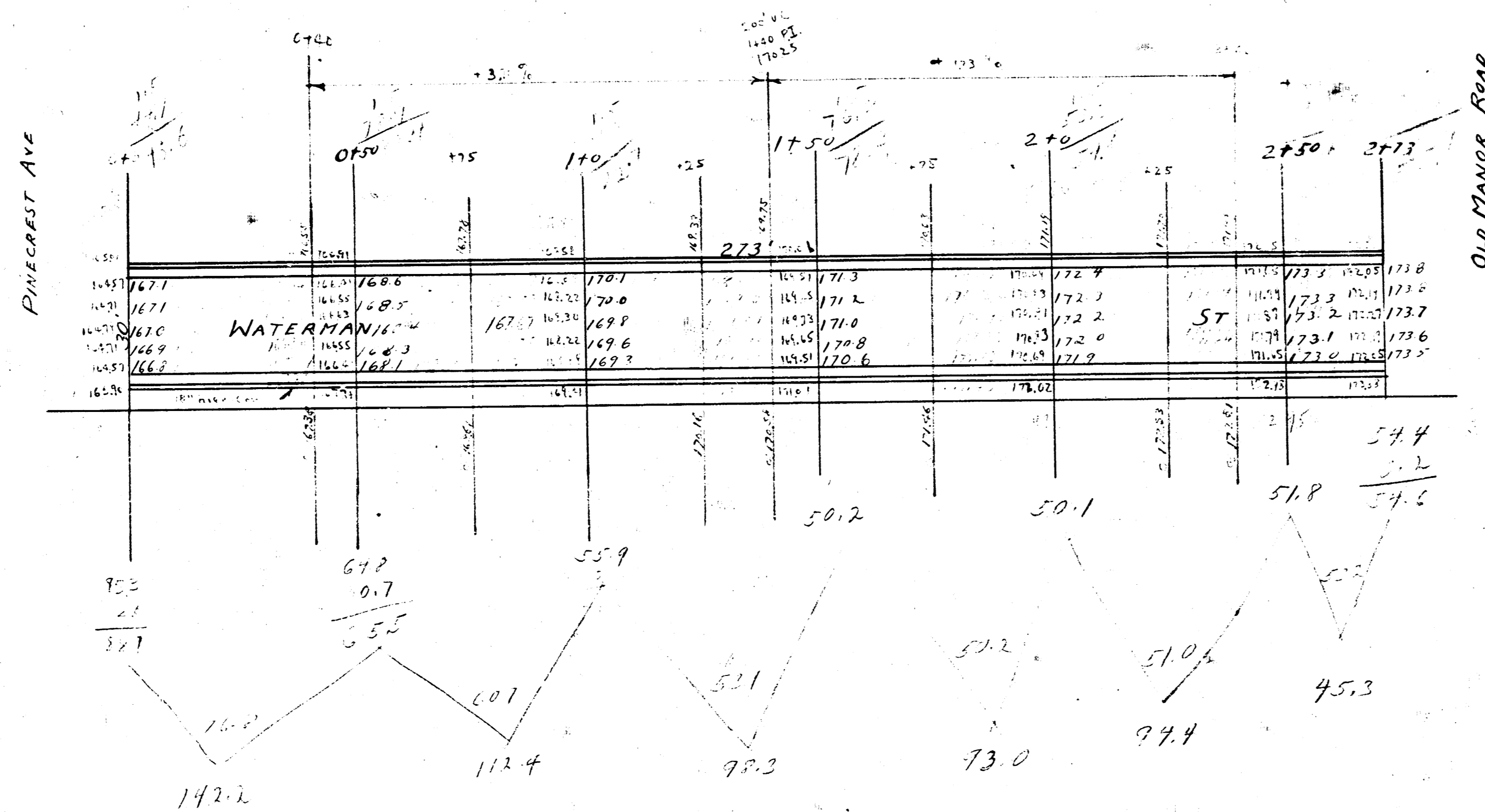

BM 6" IN GLOBE - C.B. NE COR. ENGLISH + PINECREST

B.M. 170.20 19245 East - Pinecrest - L.P. - 1924

142.2  
 112.4  
 79.2  
 73.0  
 94.4  
 45.3  
 54.4  
 54.6