

Sta On a 9° Offset from South R.  
 B.M. 139.98 + Top of 33 Stone Spher. Masonry 5" East of E. Corner of W. Armour 374 North of W. Armour Dr. Lincoln.  
 B.M. 143.98 NE Corner Bottom Step No. 227 W. Armour.  
 B.M. 157.35 1/2" Spike in Pine P.P. N. Side Lincoln, 678 West of West E. Longwellan.  
 B.M. 150.69 1/2" Spike S. Side N.L.P. 100' N. of N.L. Watson Lane, 128' East of N.L. Rockwell.  
 B.M. 142.42 RR Spike in W.S. H.P. 30' South of Lincoln, E. Side Rockwell.

**CURVE DATA**  
 Radius 6" @ S.C. 986.73 4-11° 22' 30"

Sta	6" S.C. Chord	6" Arc Chord	Dist.	Total Dist.
0+00	PC			
125	25.00	23.94	0°43'33"	0°43'33"
150	25.00	23.94	0°43'33"	1°27'06"
175	25.00	23.94	0°43'33"	2°10'39"
1+00	25.00	23.94	0°43'33"	2°54'12"
125	25.00	23.94	0°43'33"	3°37'45"
150	25.00	23.94	0°43'33"	4°21'18"
175	25.00	23.94	0°43'33"	5°04'51"
1+25	20.90	20.00	0°36'24"	5°41'15"

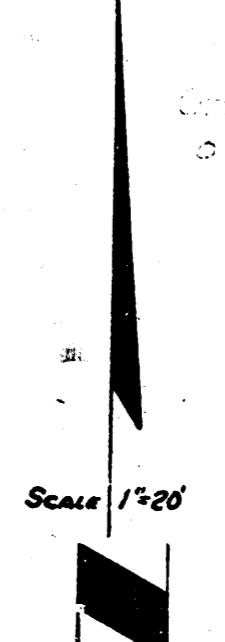

**NOTE**  
 Place 4 Extra Bars in Intersection Equally Spaced. Place Bars Perpendicular to Traffic Flow on Watson. Use Standard Concrete Steel Pattern.

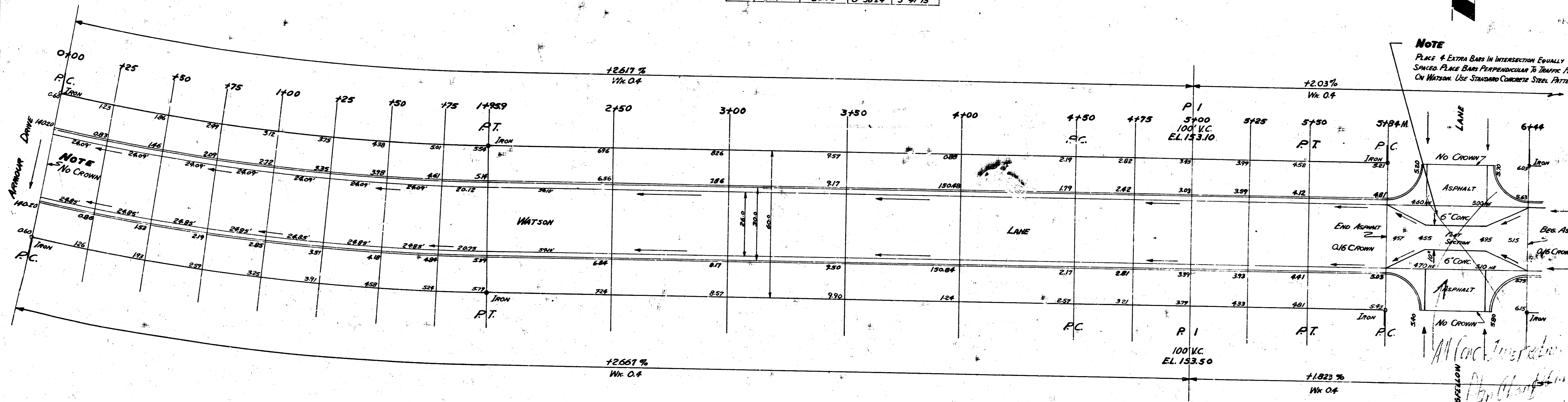

Surveyed by J. H. Smith  
 Plan  
 W.P.  
 Checked by J. H. Smith

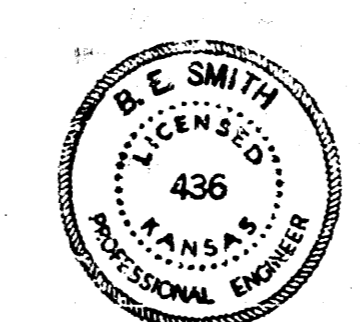

**WATSON LANE**  
 EL ARMOUR DR. TO W.L. ROCK Pk.  
 26-2-30 AC.  
 CITY OF WICHITA, KANSAS  
 B.E. SMITH  
 JAN. 1955  
 CITY ENGINEER  
 Proj. No. C14-170

D.M. 15735 1/2" Scale in N. Face P.P.K. Size Lincoln 671 W. Or. W.R. Lamson

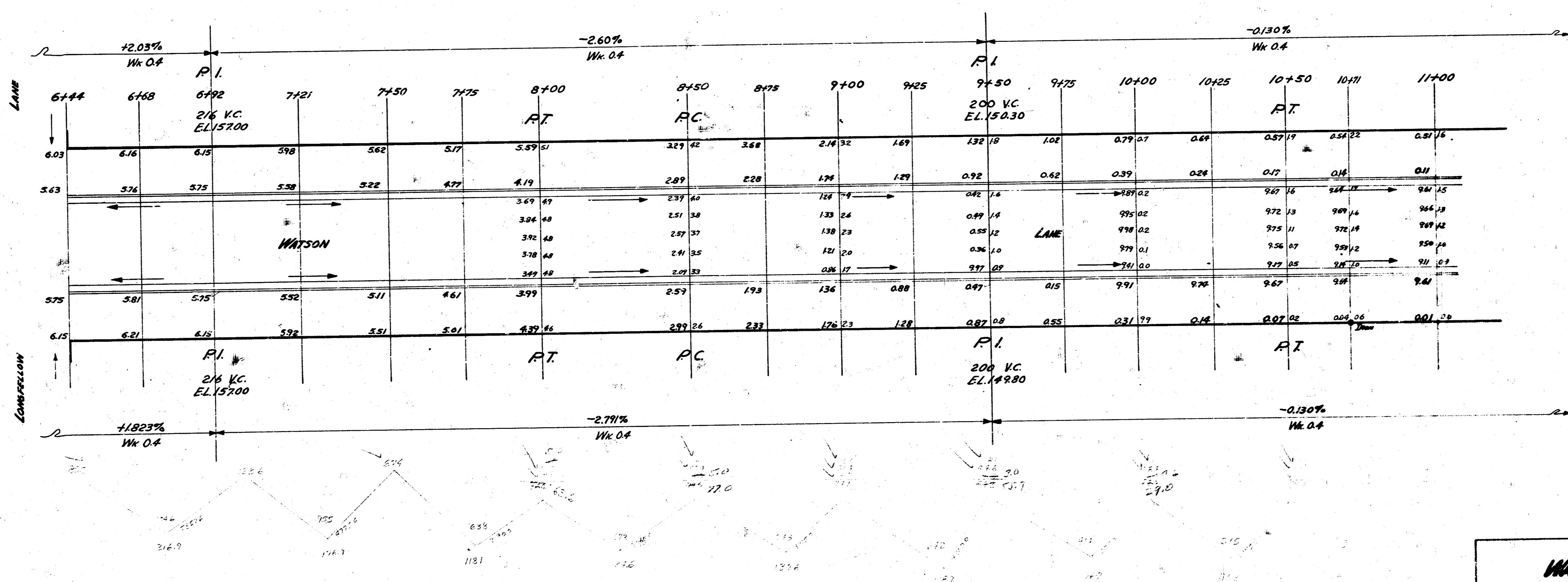

**WATSON LANE**  
 Proj. No. C14-170

3/8

B.M. 142.82 P.R. Spike in W.S. N.L.P. 30° South of Lincoln E Side Rock Road  
 B.M. 150.69 5" Spike S Side N.L.P. 100' N of N.L. Watson Lane 128° E of W.L. Rock Road

Excavation  
 City  
 P.S.M.  
 100' 0"

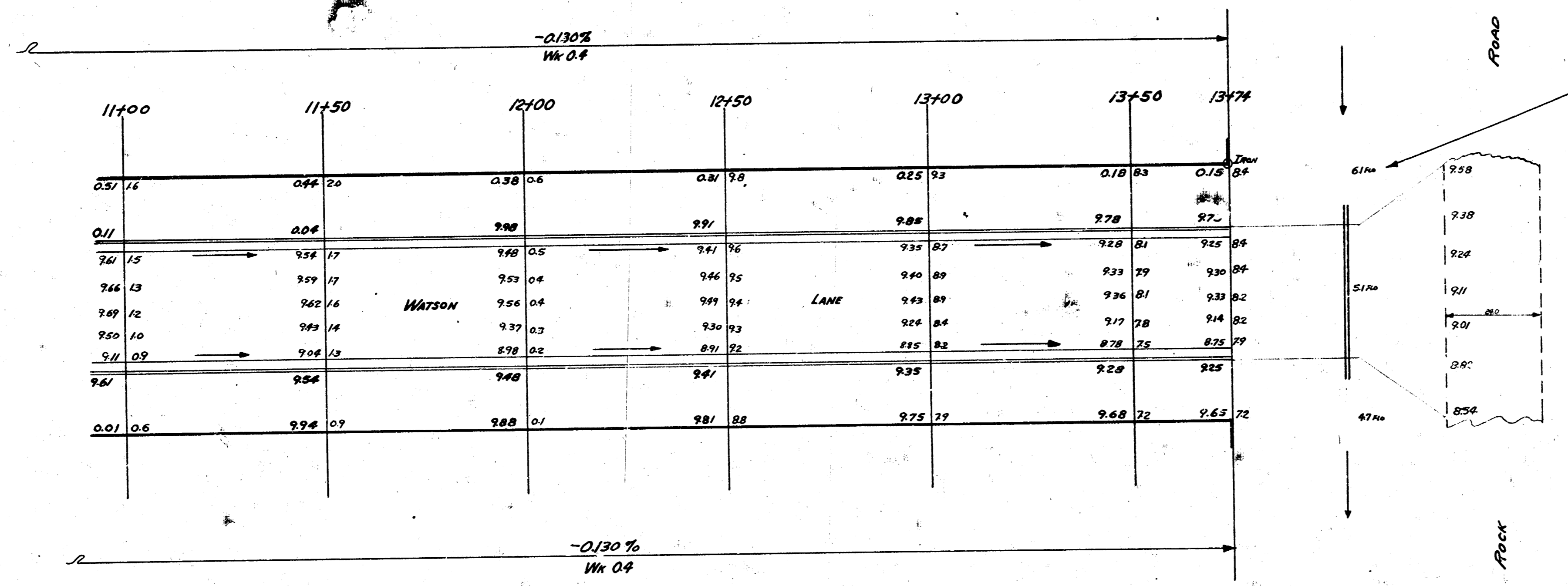
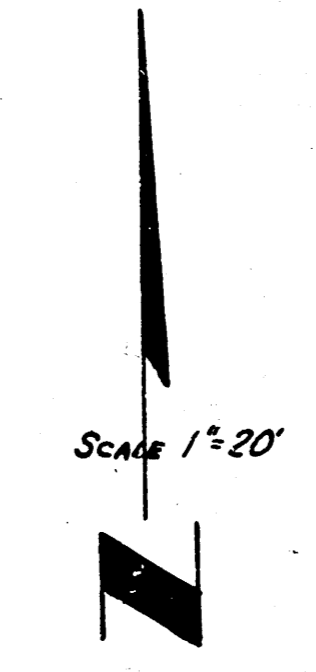

**NOTE**  
 INSTALL 40' OF 15" RCP IN DITCH FOR DRAINAGE

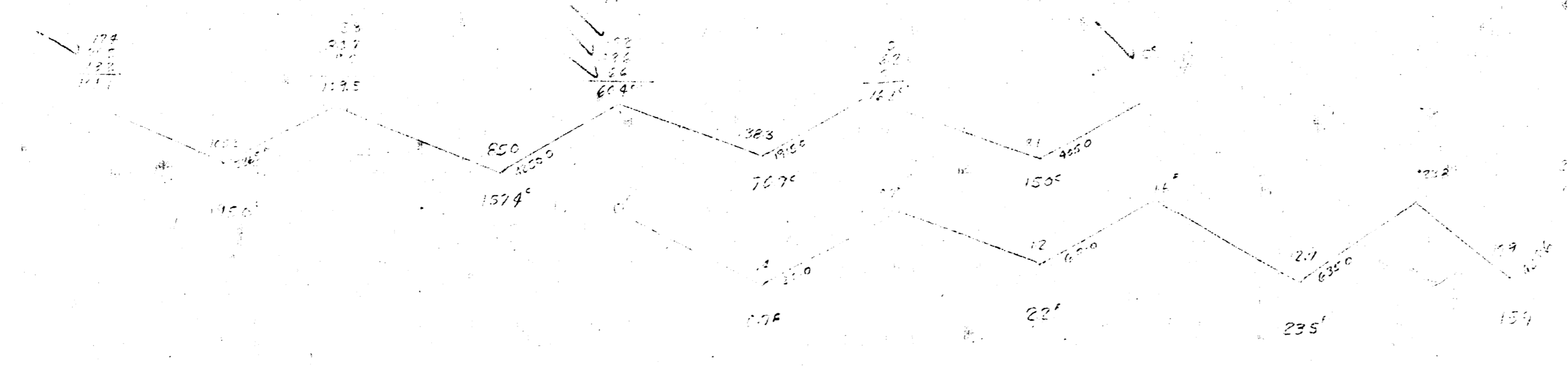

**WATSON LANE**  
 PROJECT No. C14-170

3/5