

B.M. 'G' IN GLOBE TOP CA. E.S. PORTER & S.S. 25TH. ELEV. 125.90
CHAIN NORTH ON E

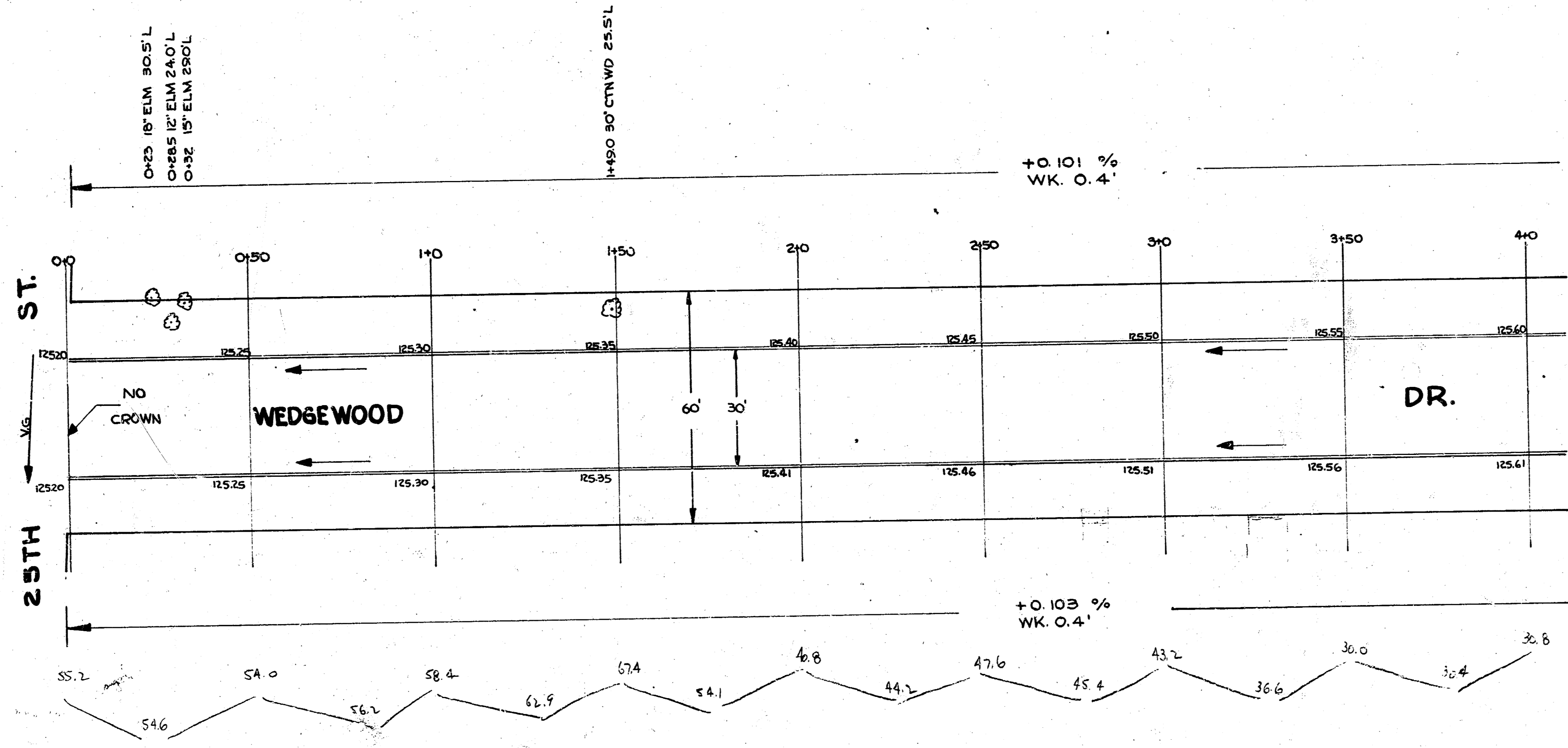

14796 20' x 40'
 15713 40' x 30'
 15713 40' x 30'

1/3



WEDGE WOOD DRIVE
 NL. 25TH TO S.L. PORTER
30' CONC. & CURB
CITY OF WICHITA, KANSAS
 B.E. SMITH CITY ENGINEER
 FEB. 1934 PROJ. NO. C13-131

N

NOTE

BEG. AT STA 6+95.55 CONSTRUCT
RADII OF 19.19' TO EAST CURB &
49.19' TO WEST CURB WITH A
Δ ANGLE OF 40°-17'-30"

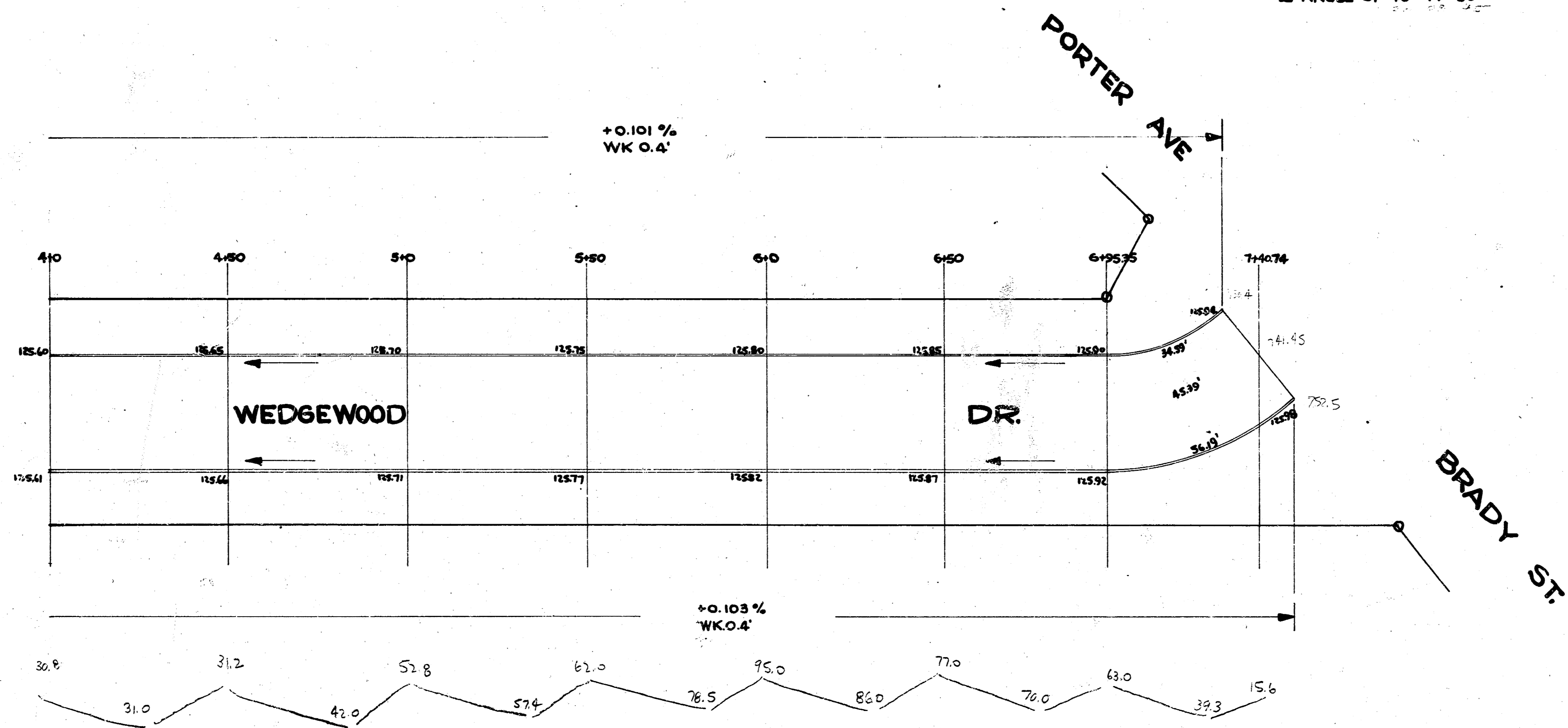

2/3

WEDGEWOOD DRIVE
PROJ. NO. C13-131