

**WELLINGTON PLACE**  
**N.L. 29TH STREET NORTH TO S.L. 32ND STREET NORTH**

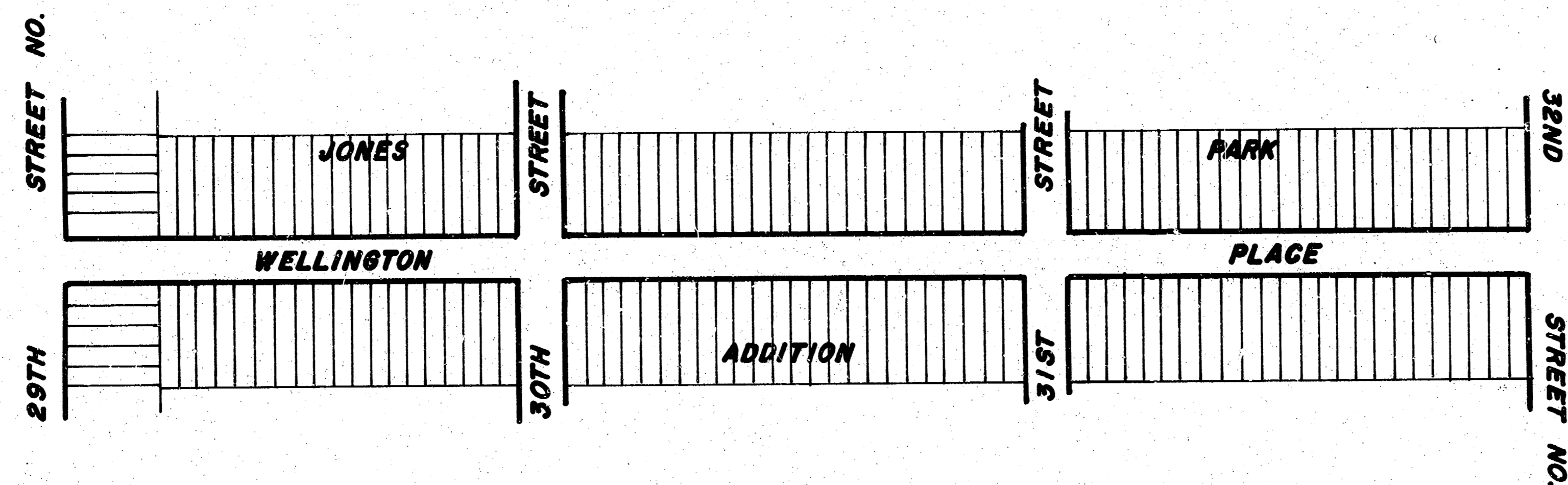

**CITY OF WICHITA, KANSAS**

R.W. BRUGGEMAN DIRECTOR OF ENGINEERING/CITY ENGINEER  
 PROJECT NO. 472-76-245-91107000 - 000 - 001

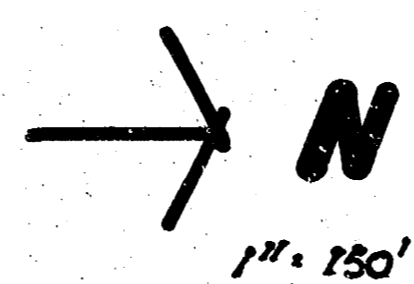
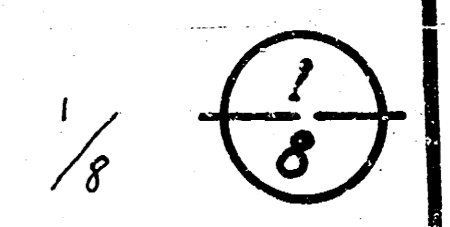
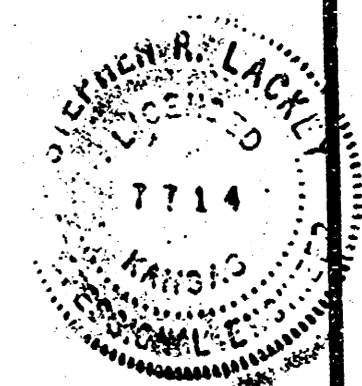

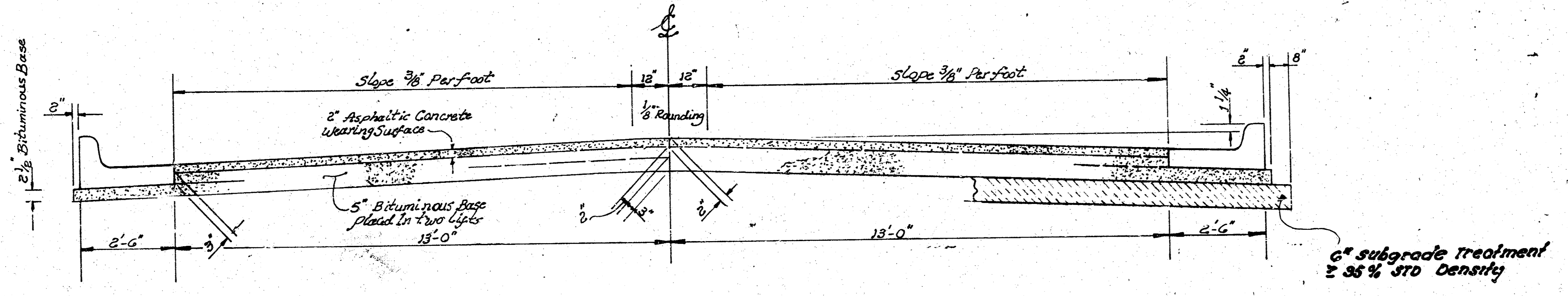

### TYPICAL SECTION

### 31' ASPHALTIC CONCRETE PAVEMENT WITH BITUMINOUS BASE

*The A.C. pavement between the Comb. Curb & Gutter shall be paid as Sec. 16. 7" A.C. Pavement (5" Bituminous Base). The Bituminous Base under the Comb. Curb & Gutter shall be paid as Sec. 16. 2 1/2" Bituminous Base.*

A TACK COAT OF EMULSIFIED ASPHALT (SS-1H) SHALL BE APPLIED AT AN APPROXIMATE RATE OF 0.05 GALLONS PER SQ. YD. BETWEEN LIFTS OF ASPHALTIC MATERIALS WHEN ORDERED BY THE ENGINEER. TACK COAT WILL NOT BE PAID FOR DIRECTLY AND SHALL BE CONSIDERED AS SUBSIDIARY TO PRICE BID FOR ASPHALTIC PAVEMENT. BITUMINOUS BASE AND ASPHALTIC CONCRETE WEARING SURFACE SHALL BE PLACED WITH A LAYDOWN MACHINE HAVING AUTOMATIC CONTROLS FOR CROWN AND GRADE. CONSTRUCTION JOINTS IN EACH LIFT SHALL BE STAGGERED A MINIMUM DISTANCE OF 1' WITH JOINTS IN PRECEDING LIFTS AND SUCH THAT A JOINT WILL BE CONSTRUCTED ON THE PAVEMENT CENTERLINE IN THE TOP LIFT.

### DETAIL OF TRANSVERSE CONSTRUCTION JOINTS

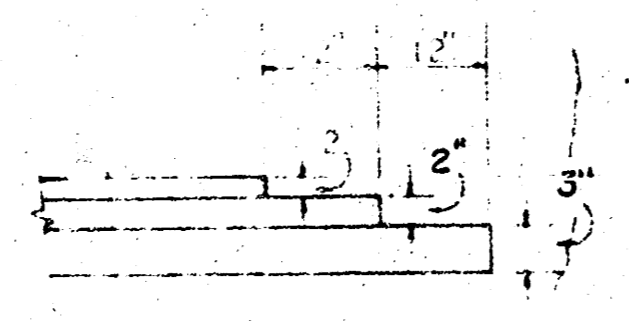

TRANSVERSE CONSTRUCTION JOINTS SHALL BE CONSTRUCTED IN FLEXIBLE BASE PAVEMENTS AT LOCATIONS WHERE PAVEMENT TEMPORARILY ENDS TO FACILITATE FUTURE PAVEMENT CONSTRUCTION AS SHOWN BY DETAIL. THE COST OF CONSTRUCTING THE TRANSVERSE CONSTRUCTION JOINTS SHALL NOT BE MEASURED OR PAID FOR DIRECTLY BUT SHALL BE INCLUDED IN THE BID PRICE FOR SQUARE YARDS OF ASPHALTIC CONCRETE PAVEMENT.

CITY OF WICHITA, KANSAS

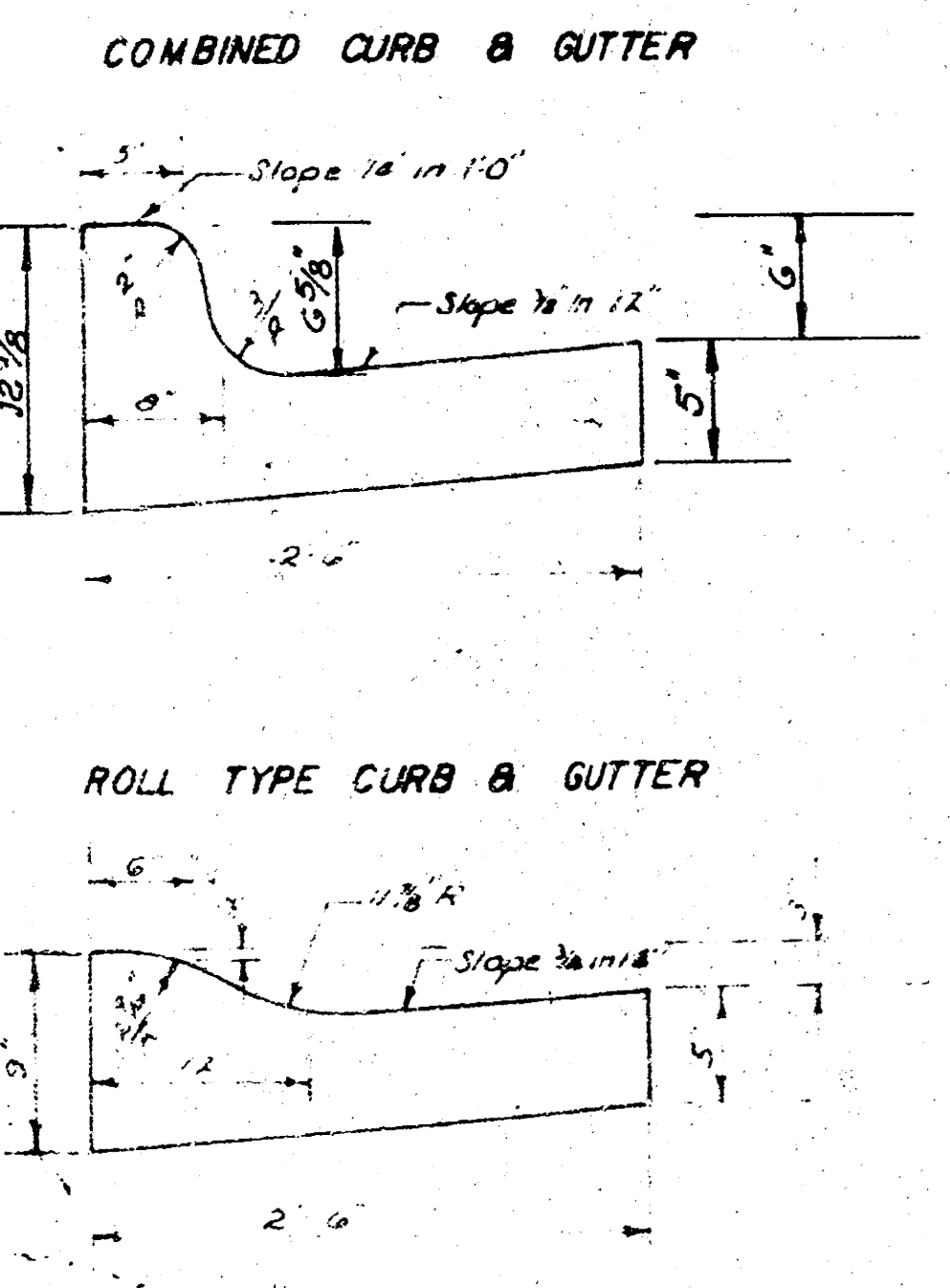
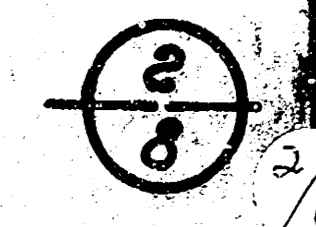



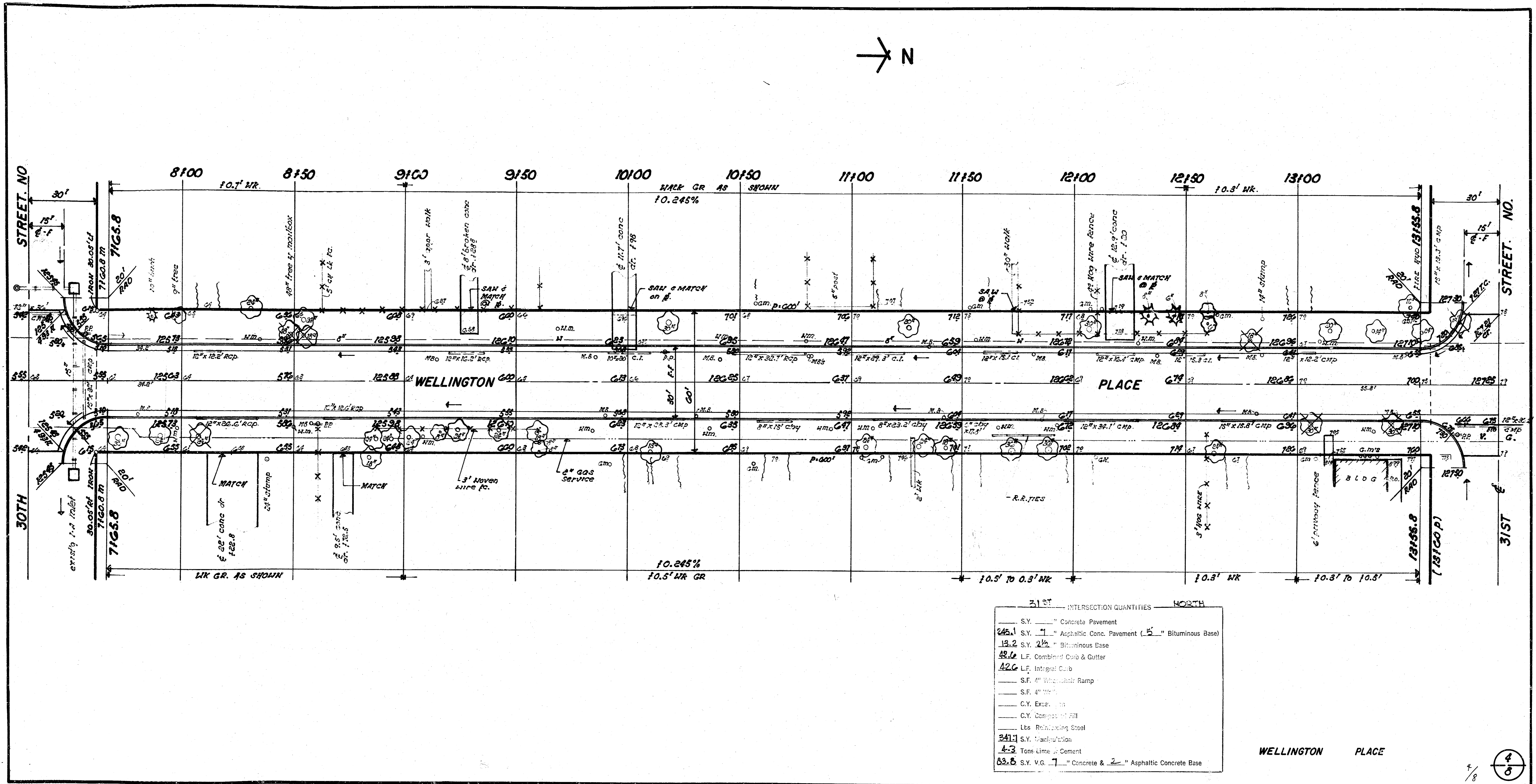

31ST INTERSECTION QUANTITIES NORTH

---	S.Y.	---	Concrete Pavement
245.1	S.Y.	7	Asphaltic Conc. Pavement (1.5" Bituminous Base)
13.2	S.Y.	2.5	Bituminous Base
42.6	L.F.		Combined Curb & Gutter
42.6	L.F.		Integral Curb
---	S.F.	4"	Wheelchair Ramp
---	S.F.	4"	W.P.
---	C.Y.		Excavation
---	C.Y.		Compacted Fill
---	Lbs.		Reinforcing Steel
341.1	S.Y.		Manhole
4.3	Tons		Lime + Cement
63.8	S.Y.	V.G.	7" Concrete & 2" Asphaltic Concrete Base

WELLINGTON PLACE

4/8

FILMED FROM THE BEST AVAILABLE COPY

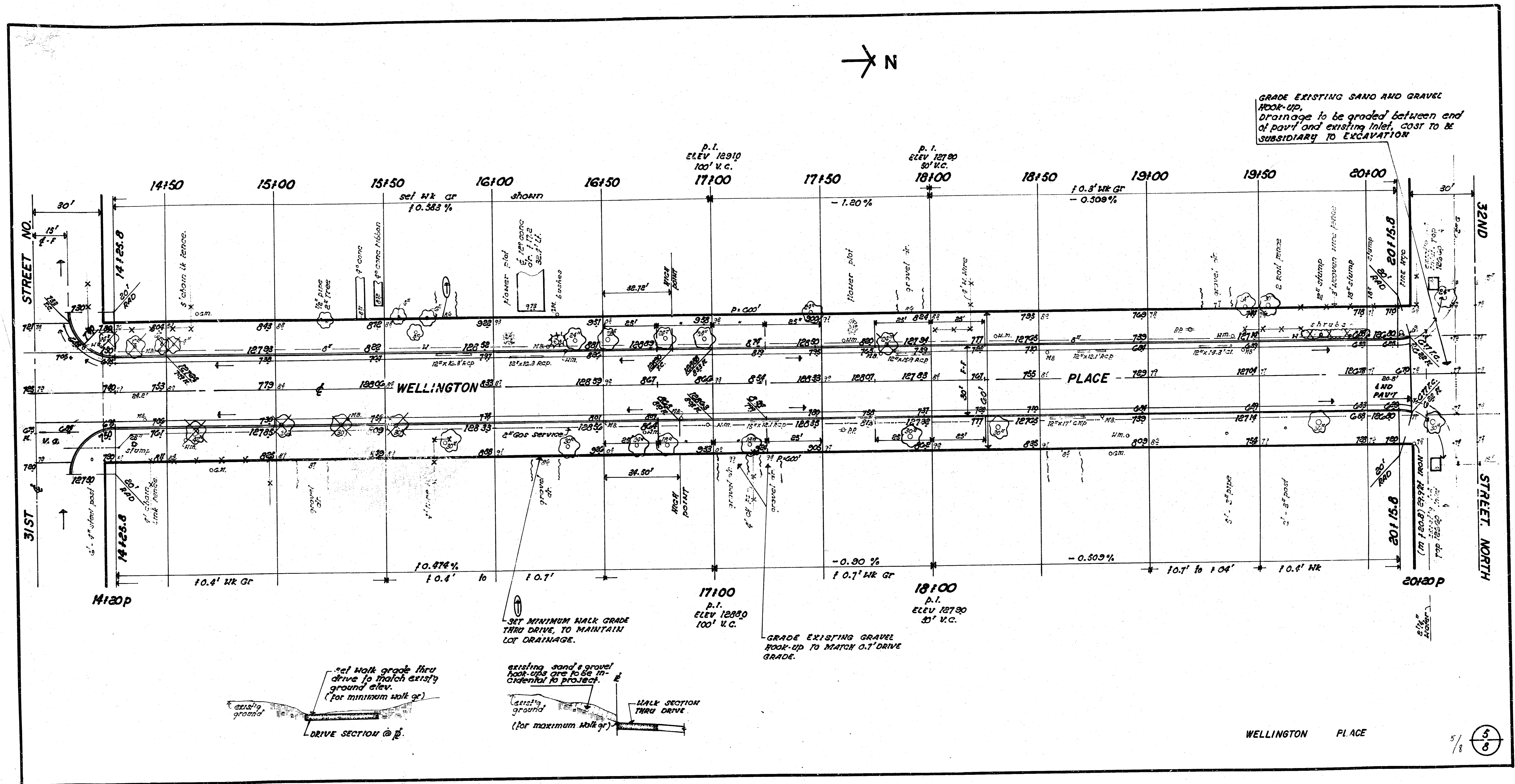

FILMED FROM THE BEST AVAILABLE COPY.....



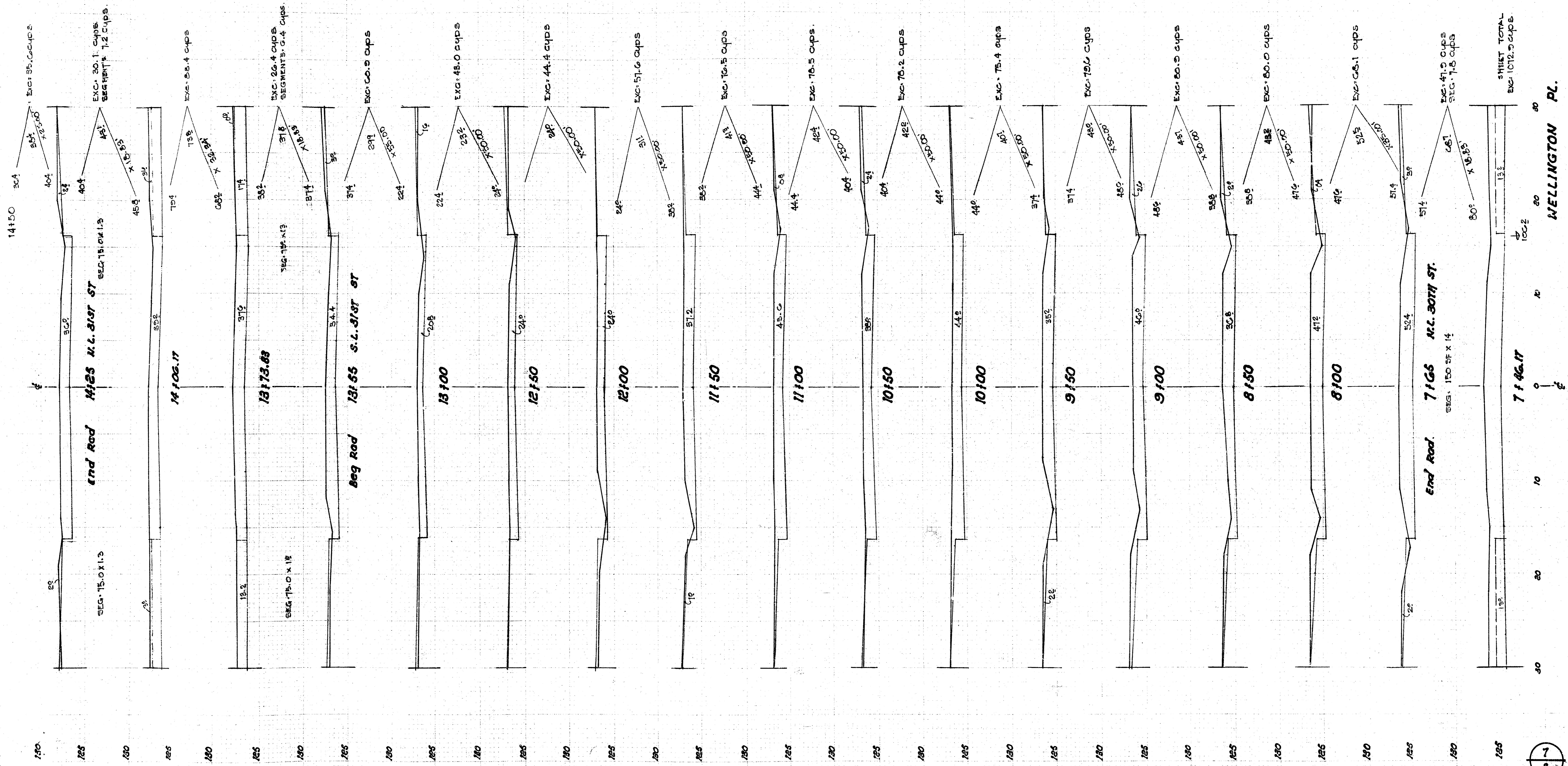

7  
8

FILMED FROM THE BEST AVAILABLE COPY

WELLINGTON PL.

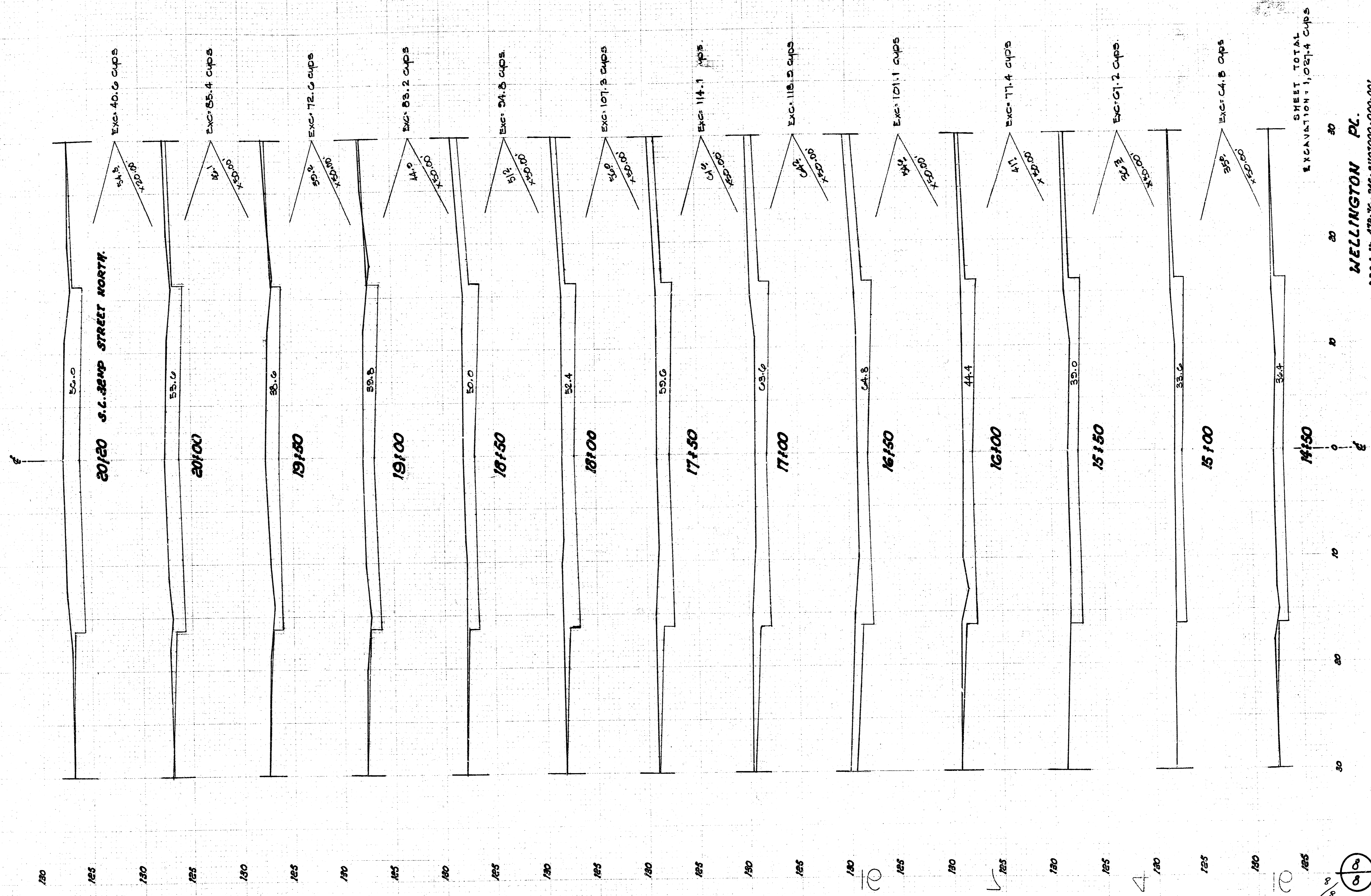

SHEET TOTAL  
 EXCAVATION = 1,021.4 cups  
**WELLINGTON PL.**  
 PROJ. No. 478-76-266-8107000-000-001

FILMED FROM THE BEST AVAILABLE COPY