

WELLINGTON PLACE
 S.L. 33rd St. N. to S.L. 35th St. N.
 472-76-245-81235-000-000-001

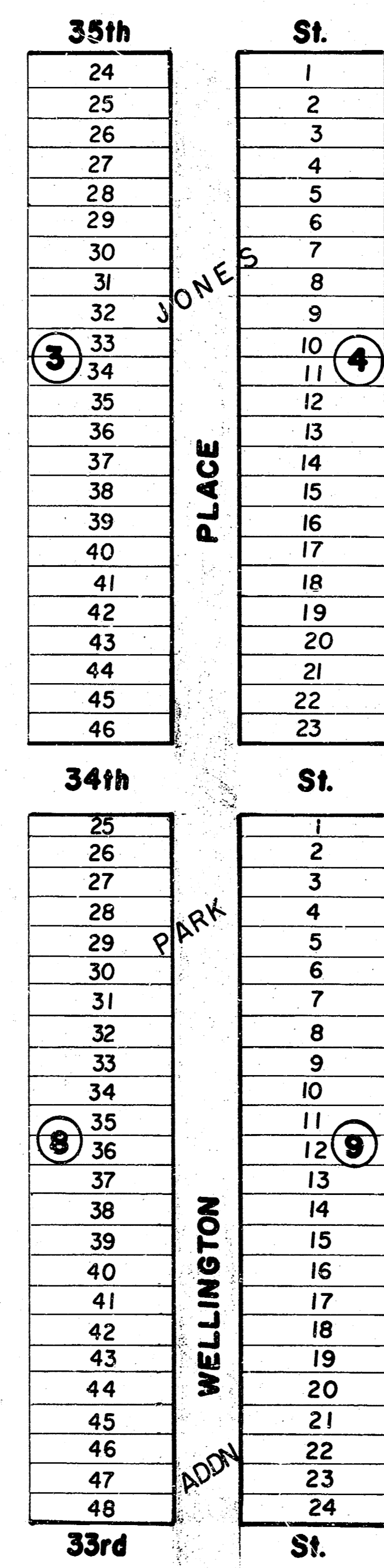

PROJECT DESCRIPTION			
WELLINGTON PLACE			
S.L. 33rd St. N. to S.L. 35th St. N.			
PROJECT NUMBER			
472-76-245-81235-000-000-001			
BOOK NO.	DRAWN BY	APPROVED BY	DATE
D 251	RAH	[Signature]	1/
CITY OF WICHITA			
M.E. LINDEBAK CITY ENGINEER			SCALE
			1" = 20'

TYPICAL 3' PAVEMENT DETAILS

2/7

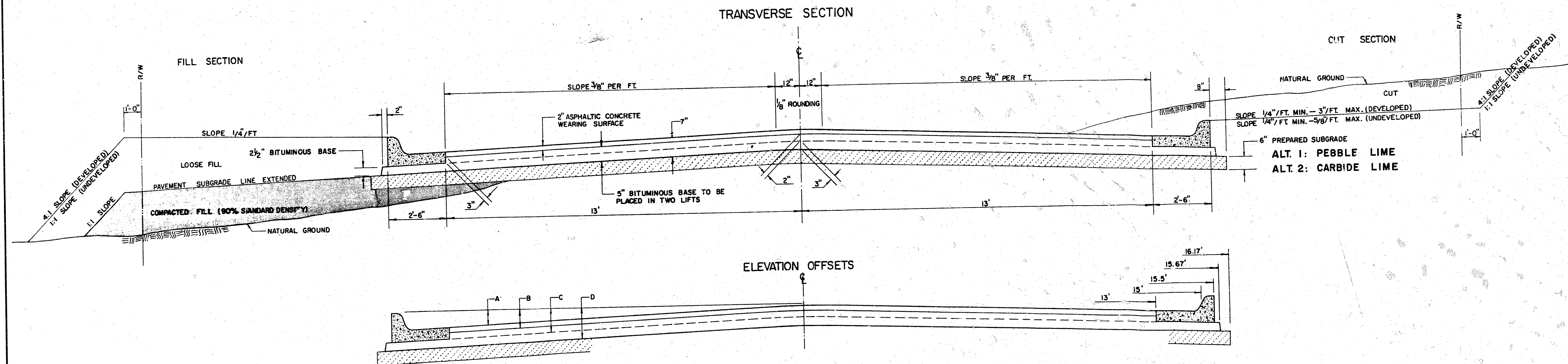

	DISTANCE FROM CENTERLINE (LT. & RT.)											
	0'	2'	4'	6'	7.5'	10'	12'	13'	15.5'	15.67'	16.17'	
A: TOP OF CURBS TO TOP OF SURFACE LIFT	0.10	0.14	0.21	0.27	0.32	0.39	0.46	0.49	—	—	—	—
B: TOP OF CURBS TO TOP OF UPPER BASE LIFT	0.27	0.31	0.38	0.44	0.49	0.56	0.63	0.66	—	—	—	—
C: TOP OF CURBS TO TOP OF LOWER BASE LIFT	0.44	0.49	0.57	0.64	0.70	0.79	0.87	0.90	0.98	1.00	1.00	—
D: TOP OF CURBS TO TOP OF SUBGRADE	0.69	0.73	0.80	0.87	0.93	1.01	1.08	1.12	1.19	1.21	1.21	1.23

COMBINED CURB & GUTTER

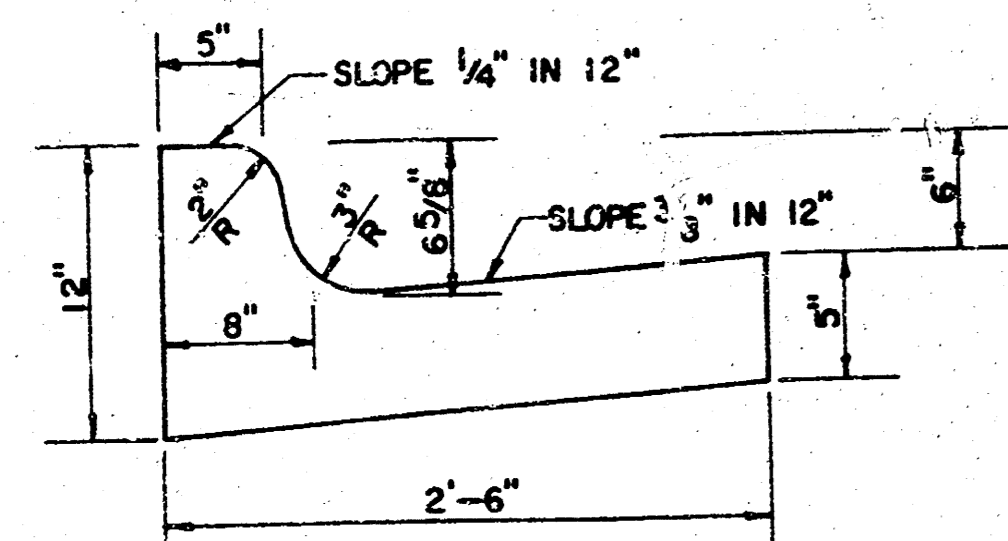

ROLL TYPE COMBINED CURB & GUTTER

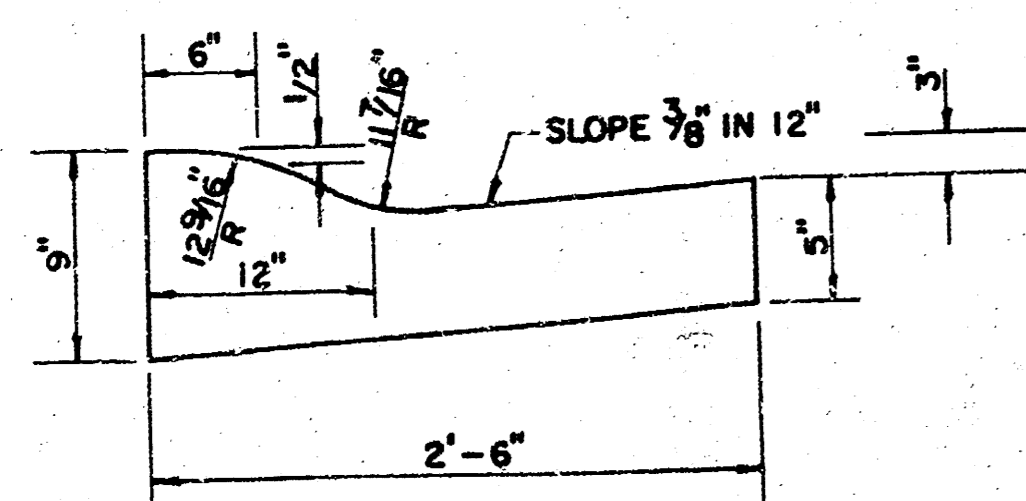

TRANSVERSE CONSTRUCTION JOINTS

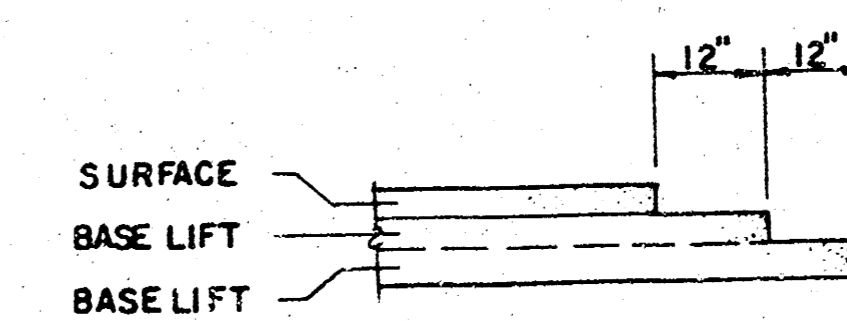

TRANSVERSE CONSTRUCTION JOINTS SHALL BE CONSTRUCTED IN FLEXIBLE BASE PAVEMENTS AT LOCATIONS WHERE PAVEMENT TEMPORARILY ENDS AS SHOWN BY THE DETAIL. THE COST OF CONSTRUCTION JOINTS SHALL BE INCLUDED IN THE BID PRICE FOR SQUARE YARDS 7" ASPHALTIC CONCRETE (5" BITUMINOUS BASE).

GENERAL NOTES

- 1) THE ASPHALTIC CONCRETE PAVEMENT BETWEEN THE COMBINED CURB AND GUTTER SHALL BE PAID AS SQUARE YARDS OF 7" ASPHALTIC CONCRETE (5" BITUMINOUS BASE).
- 2) THE BITUMINOUS BASE UNDER AND BEHIND THE COMBINED CURB AND GUTTER SHALL BE PAID AS SQUARE YARDS OF 2 1/2" BITUMINOUS BASE.
- 3) A TACK COAT OF EMULSIFIED ASPHALT (SC-1H OR CSS-1H) SHALL BE APPLIED AT AN APPROXIMATE RATE OF 0.05 GALLONS PER SQUARE YARD BETWEEN EACH LIFT OF ASPHALTIC MATERIAL.
- 4) BITUMINOUS BASE AND ASPHALTIC CONCRETE WEARING SURFACE SHALL BE PLACED WITH A LAYDOWN MACHINE HAVING AUTOMATIC CONTROLS FOR LINE AND GRADE.
- 5) CONSTRUCTION JOINTS IN EACH LIFT SHALL BE STAGGERED A MINIMUM DISTANCE OF ONE (1) FOOT FROM JOINTS IN PRECEDING LIFTS AND PLACED SO THAT A JOINT WILL BE CONSTRUCTED ON THE CENTERLINE OF THE TOP LIFT.
- 6) CONTRACTOR TO BID ONLY ONE SUBGRADE TREATMENT ALTERNATE WHEN ALTERNATES ARE PROVIDED IN THE PROPOSAL AND CONTRACT. THE ALTERNATE CHOSEN BY THE SUCCESSFUL BIDDER SHALL BE USED IN CONSTRUCTING THIS PROJECT.

7 INCH RESIDENTIAL ASPHALTIC CONCRETE
PAVEMENT WITH 5 INCH BITUMINOUS BASE
CITY OF WICHITA, KANSAS
PROJECT NUMBER
472-76-245-81235-000-000-001

B.M. 130.09 CITY STD DISC 25' N & 44' W OF C BROADWAY & 33RD
 B.M. 129.30 RR SPK IN NE-FACE LITE POLE AT STA 0+05, 27' LEFT
 B.M. 133.62 NW-CORNER CONC. PORCH 3460 WELLINGTON PLACE

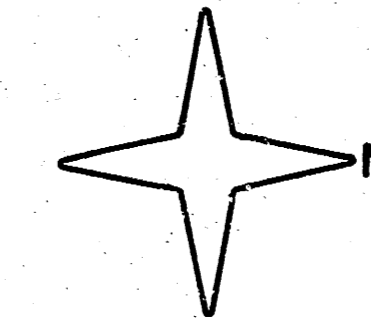

SCALE 1" = 20'

3/7

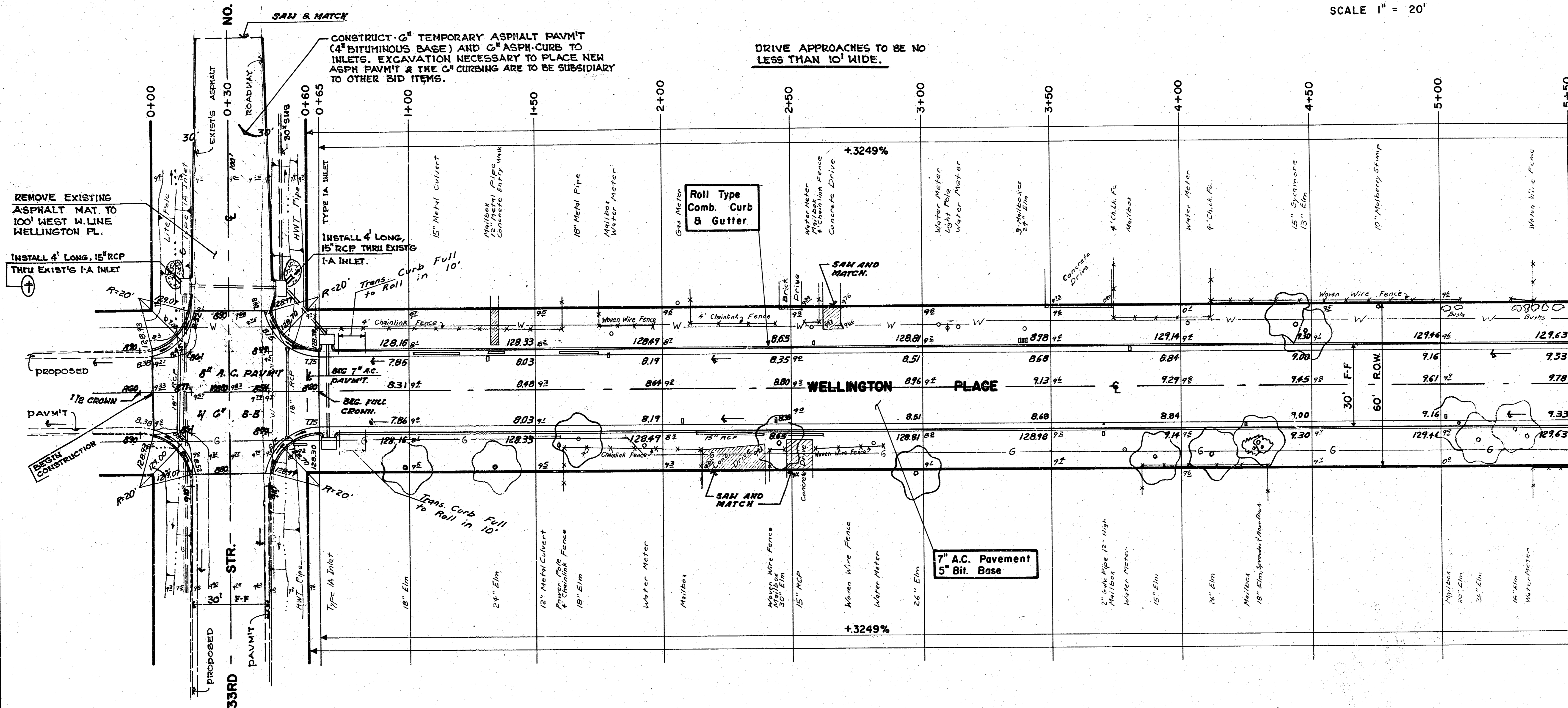

INTERSECTION QUANTITIES

316.8	S.Y.	Concrete Pavement
26.4	S.Y.	Asphaltic Conc. Pavement (6" Bituminous Base)
85.2	L.F.	Concrete Curb & Gutter
	L.F.	Integral Curb
	S.F.	4" Concrete Ramp
	S.F.	4" Concrete
	C.Y.	Excavation
	C.Y.	Compacted Fill
	Lbs.	Reinforcing Steel
3478	S.Y.	Manipulation
	Tons	Lime or Cement
	S.Y.	V.G. Concrete & Asphaltic Concrete Base

Construction of the intersection of 33rd and Wellington Place to be coordinated with construction of paving projects to south (W. Wellington Place - N.L. 33rd to S.L. 33rd) and east (33rd St. - E.L. Wellington Place to W.L. Park Place)

TRANSITION FROM FULL HEIGHT COMB. C & G TO ROLL TYPE COMB. C & G IS TO BE PAID AS BID FOR LIN. FT COMBINED CURB & GUTTER (ROLL TYPE 3 1/2" & 1 1/2").

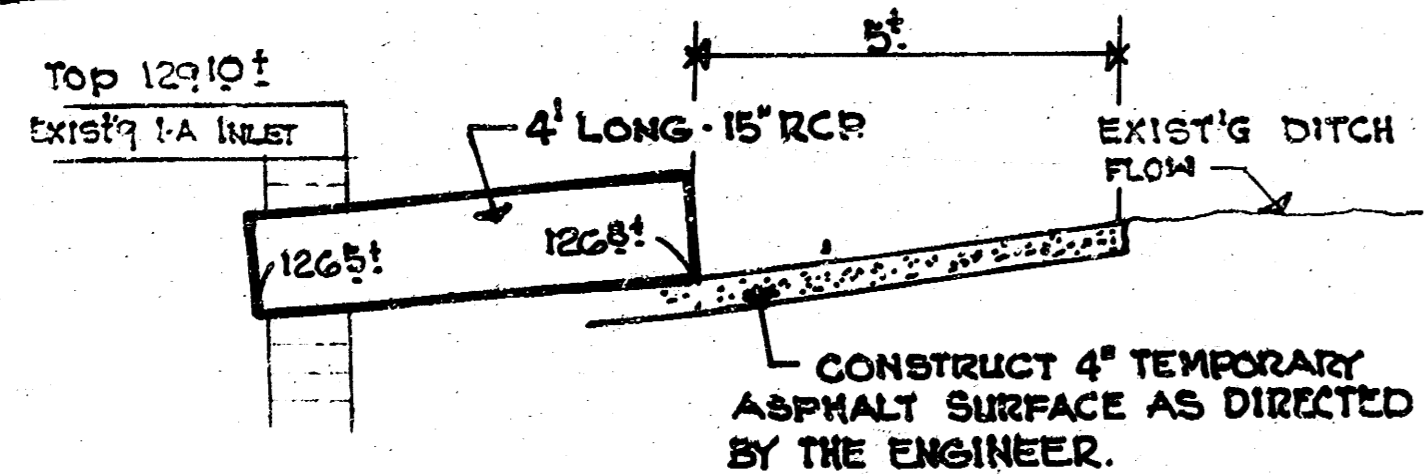

INSTALL 4" LONG, 15" R.C.P. THROUGH EXISTING I-A INLETS TO FLOW OF EXIST'G DITCH. LINE DITCHES WITH ASPHALT TO PREVENT EROSION AS DIRECTED BY THE ENGINEER. COSTS FOR ALL LABOR AND MATERIALS FOR ASPHALT, 15" RCP, PIPE INSTALLATION, AND NECESSARY EARTHWORK TO BE SUBSIDIARY TO OTHER BID ITEMS.

EXCAVATION
 2591.7 cu yds
 @ 10%
 257.2
 2850.9 cu yds
 5,075.0 SQ YDS MANIPULATION

PROJECT DESCRIPTION		
WELLINGTON PLACE		
S.L. 33RD STREET N. TO S.L. 35TH ST. NO.		
PROJECT NUMBER		
472-76-245-81235-000-001		
BOOK NO. DCD251	APPROVED BY	DATE
DRAWN BY RAH		REVISED
CITY OF WICHITA		
M. E. LINDEBAK	CITY ENGINEER	1" SCALE = 20'

INTERSECTION QUANTITIES

316.5	S.Y.	7"	Concrete Pavement
26.4	S.Y.	2 1/2"	Asphaltic Conc. Pavement (5" Bituminous Base)
26.4	S.Y.	2 1/2"	Bituminous Base
85.2	L.F.		Combined Curb & Gutter
	L.F.		Integral Curb
	S.F.	4"	Wheelchair Ramp
	S.F.	4"	Walk
	C.Y.		Excavation
	C.Y.		Compacted Fill
	Lbs.		Reinforcing Steel
37.5	S.Y.		Manipulation
	Tons		Lime or Cement
	S.Y.	V.G.	Concrete & Asphaltic Concrete Base

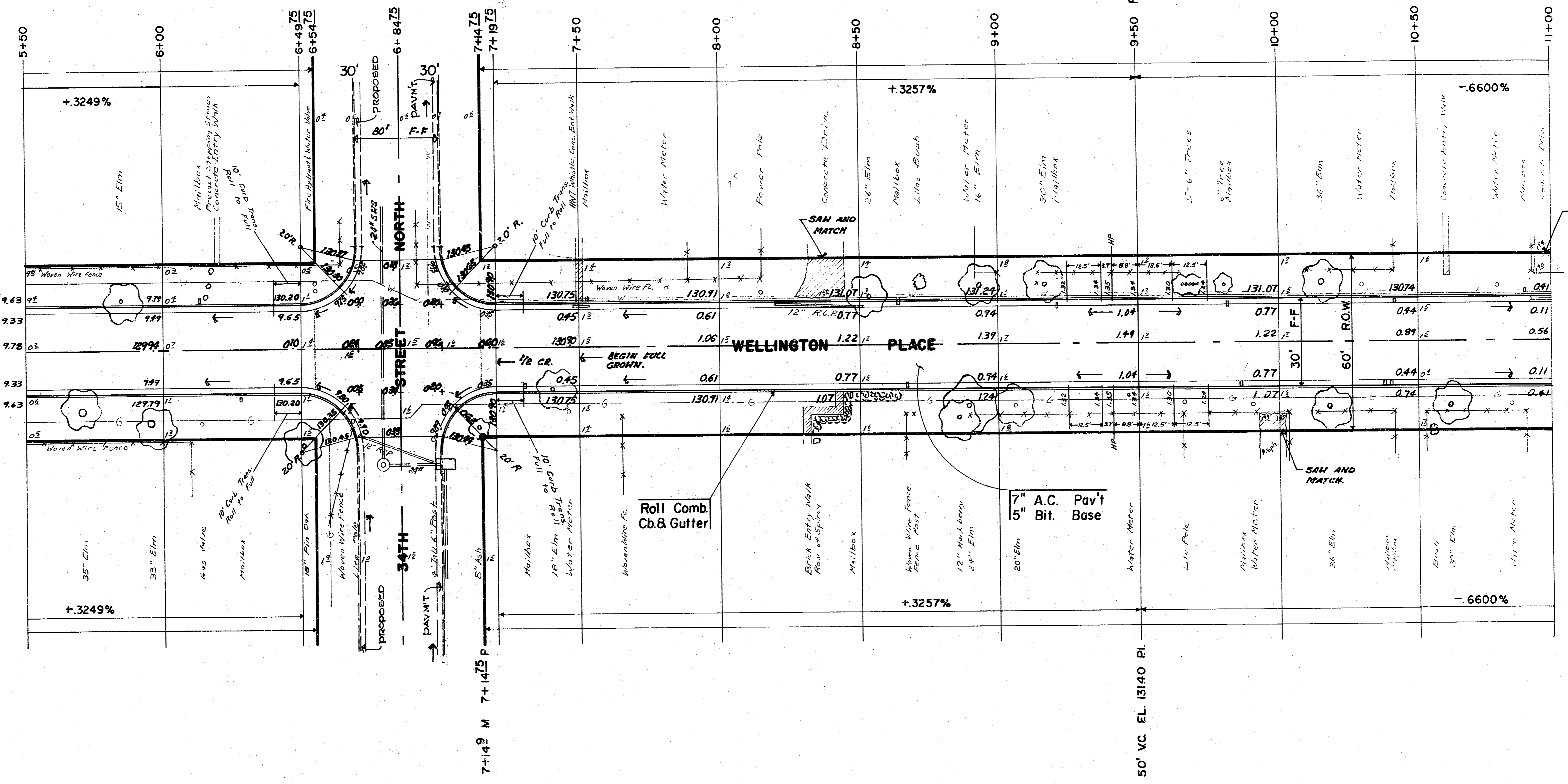
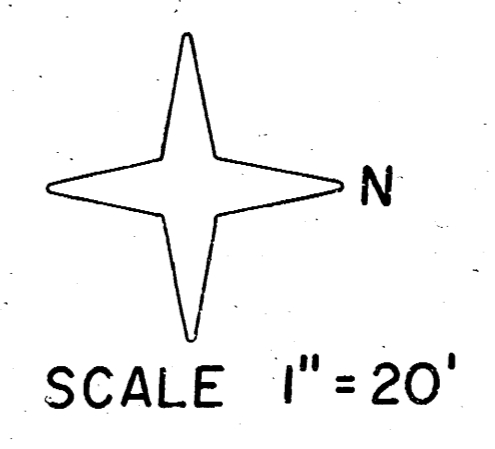

PROJECT DESCRIPTION	
WELLINGTON PLACE	
S.L. 33RD STREET N. TO S.L. 35TH ST. N.	
PROJECT NUMBER	
472-76-245-81235-000-000-001	

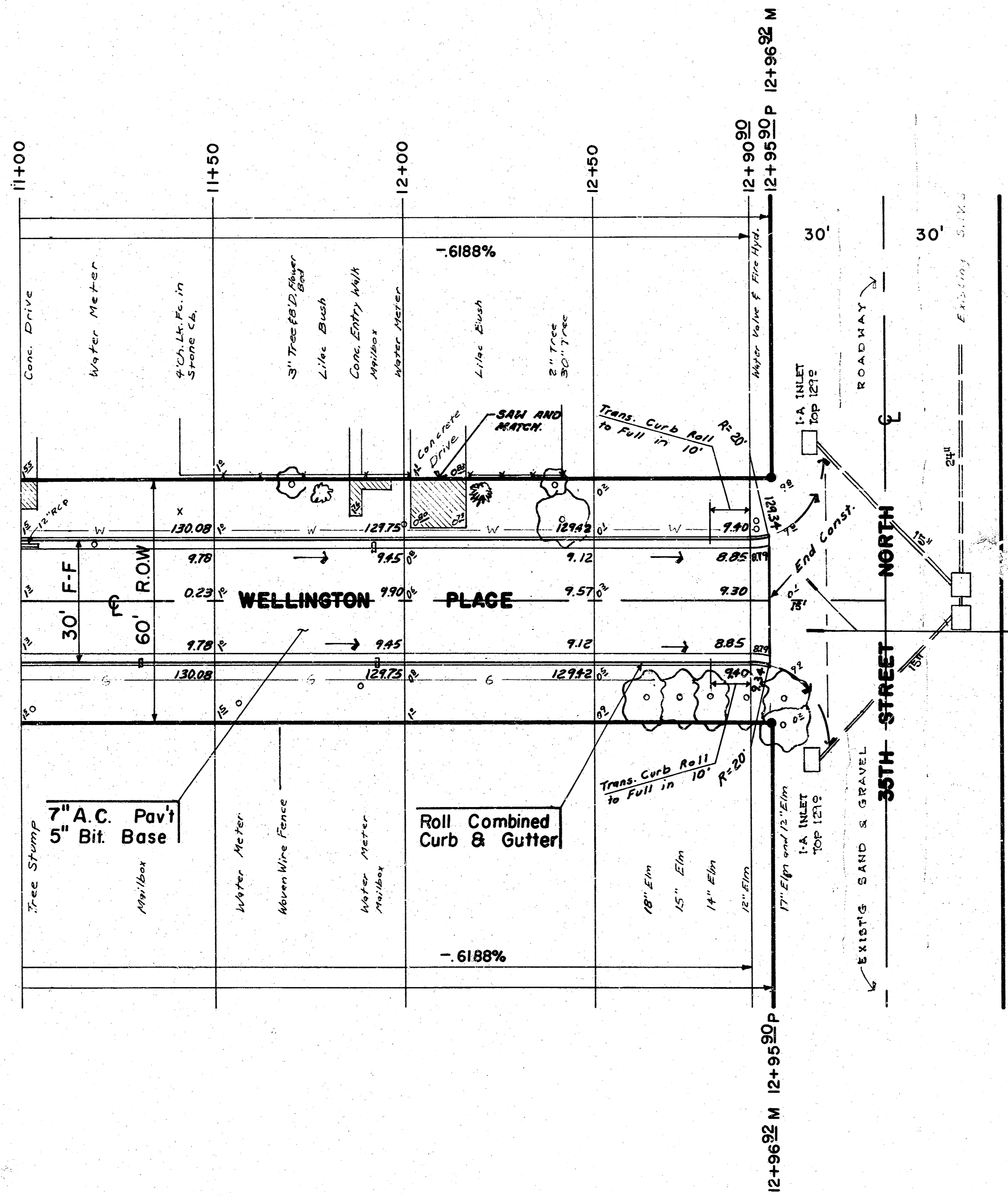
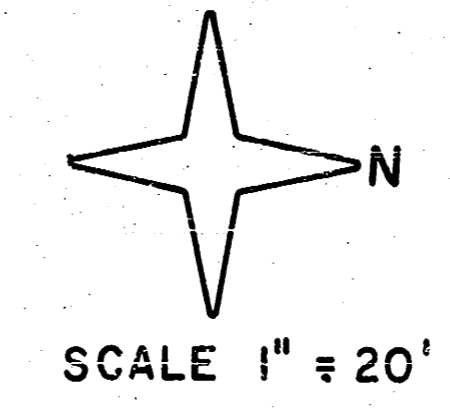

CONSTRUCT APPROACH & RE-GRADE WITH ROAD GRAVEL TO A DEPTH OF 2" FOR A DISTANCE OF 15'. PROVIDE DRAINAGE FROM END OF PAVT TO EXIST'G INLETS. EARTHWORK IS TO BE SUBSIDIARY TO OTHER BID ITEM'S.

PROJECT DESCRIPTION
WELLINGTON PLACE
S.L. 33RD STREET N. TO S.L. 35TH ST. N.
PROJECT NUMBER
472-76-245-81235-000-000-001 5/7

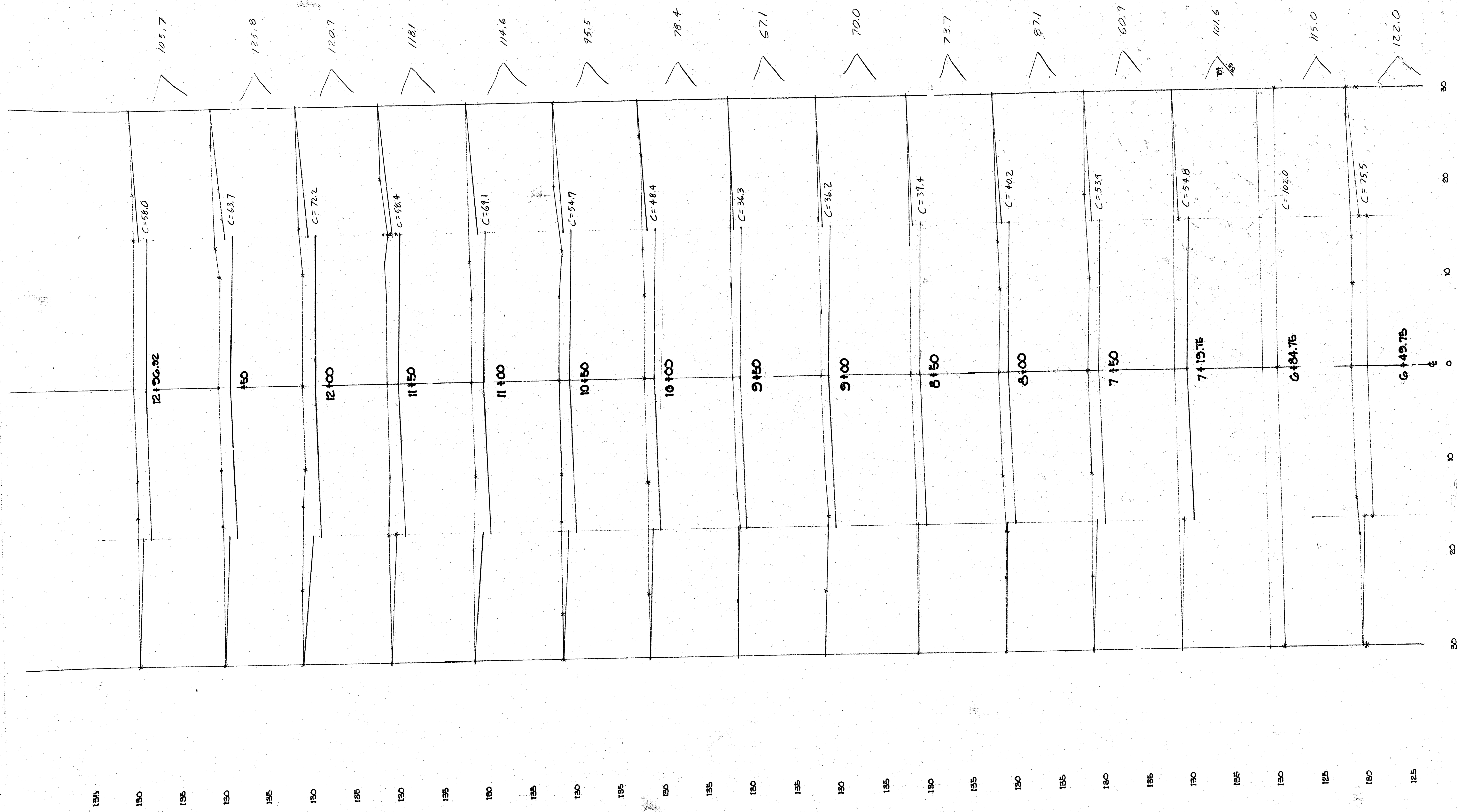

TOTAL EXCAVATION THIS SHEET 1456.4 CY

WELLINGTON PLACE
 S.L. 2349 ST. N. TO S.L. 2674 ST. N.
 PROJ. NO. 472-70-2148-81235-000-001

17

4 0 5 4