

WELLINGTON PLACE
N.L. 32nd St. N. to S.L. 33rd St. N.
472-76-245-81219-000-000-001

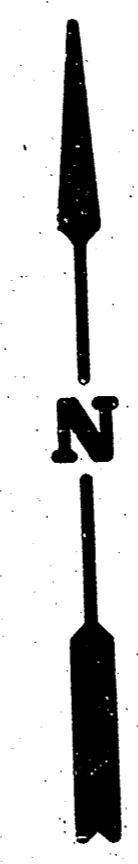

33RD		STREET
27		1
28		2
29		3
30		4
31		5
32		6
33		7
34		8
35		9
JONES 36	WELLINGTON PLACE	PARK 10
37		11
38		12
(2) 39		13 (13)
40		14
41		15
42		16
43		17
44		18
45 ADDN		19
46		20
47		21
48		22
49		23
50		24
51		25
52		26

32ND STREET

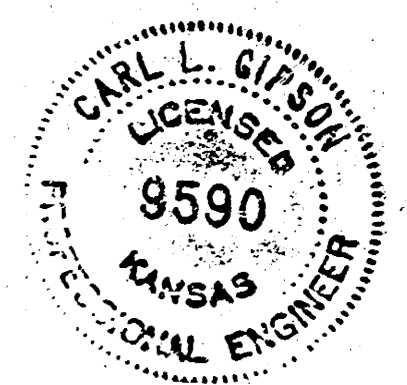

PROJECT DESCRIPTION		
WELLINGTON PLACE		
N.L. 32nd St. N. to S.L. 33rd St. N.		
PROJECT NUMBER		
472-76-245-81219-000-000-001		
BOOK NO. DCD197	APPROVED BY	DATE 6/83
DRAWN BY RAH	REVISOR	
CITY OF WICHITA		
M.L. LINDEBAK	CITY ENGINEER	SCALE 1" = 20'

TYPICAL 3' PAVEMENT DETAILS

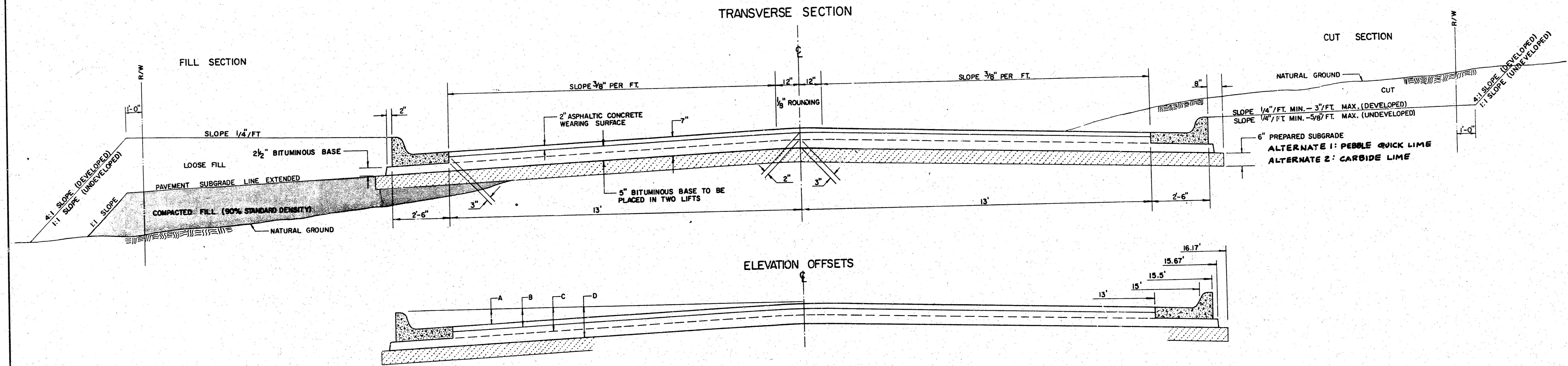

	DISTANCE FROM CENTERLINE (LT. & RT.)											
	0'	2'	4'	6'	7.5'	10'	12'	13'	15'	15.5'	15.67'	16.17'
A: TOP OF CURBS TO TOP OF SURFACE LIFT	0.10	0.14	0.21	0.27	0.32	0.39	0.45	0.49	---	---	---	---
B: TOP OF CURBS TO TOP OF UPPER BASE LIFT	0.27	0.31	0.38	0.44	0.49	0.56	0.63	0.66	---	---	---	---
C: TOP OF CURBS TO TOP OF LOWER BASE LIFT	0.44	0.49	0.57	0.64	0.70	0.79	0.87	0.90	0.98	1.00	1.00	---
D: TOP OF CURBS TO TOP OF SUBGRADE	0.69	0.75	0.80	0.87	0.93	1.01	1.08	1.12	1.19	1.21	1.21	1.23

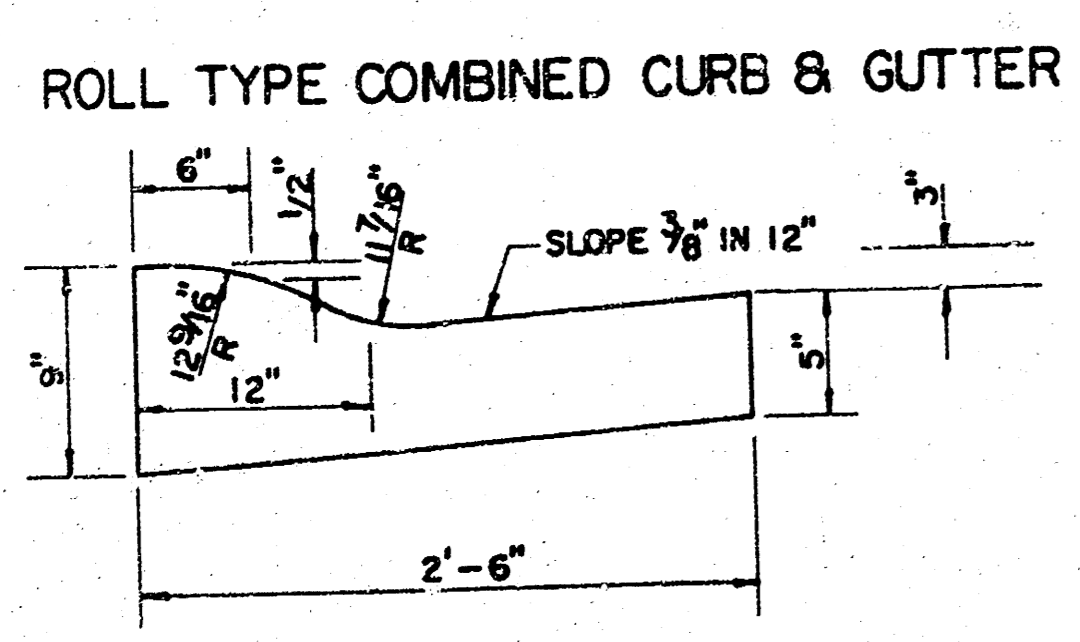
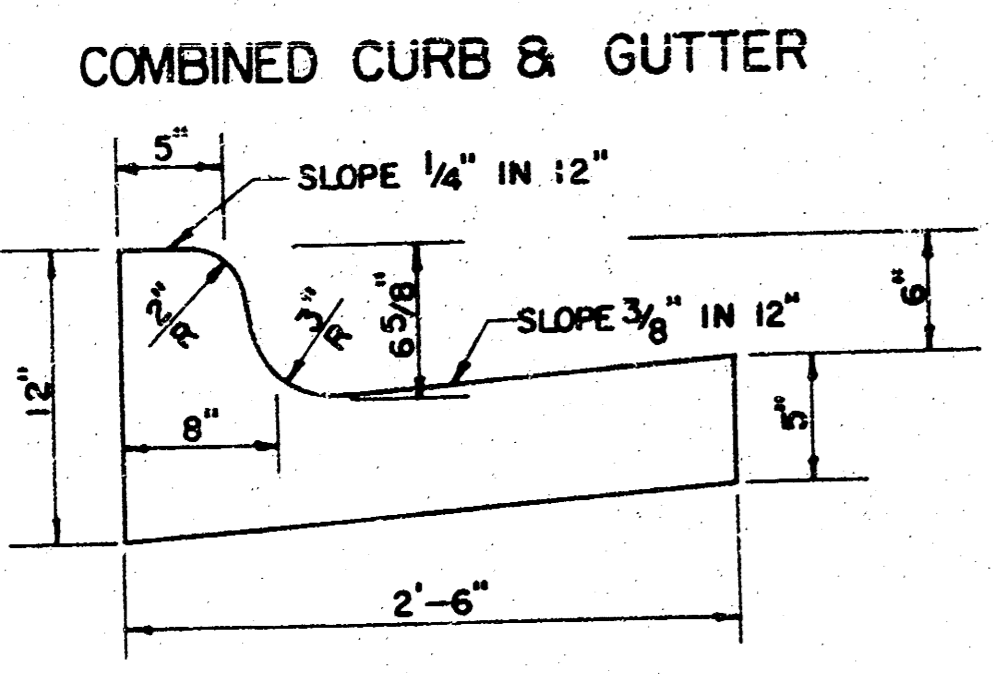

TRANSVERSE CONSTRUCTION JOINTS

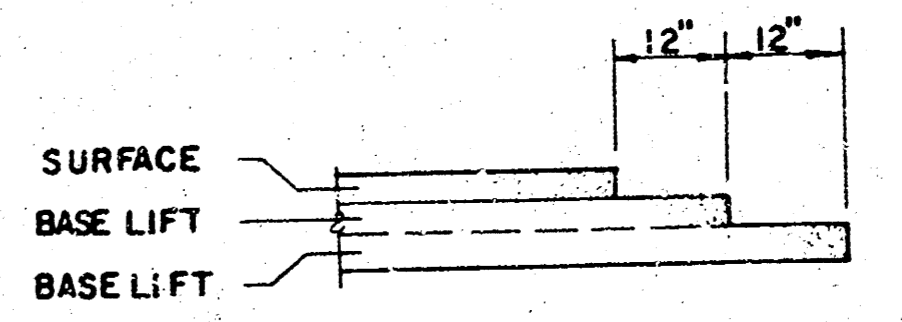

GENERAL NOTES

- 1) THE ASPHALTIC CONCRETE PAVEMENT BETWEEN THE COMBINED CURB AND GUTTER SHALL BE PAID AS SQUARE YARDS OF 7" ASPHALTIC CONCRETE (5" BITUMINOUS BASE).
- 2) THE BITUMINOUS BASE UNDER AND BEHIND THE COMBINED CURB AND GUTTER SHALL BE PAID AS SQUARE YARDS OF 2 1/2" BITUMINOUS BASE.
- 3) A TACK COAT OF EMULSIFIED ASPHALT (SC-1H OR CSS-1H) SHALL BE APPLIED AT AN APPROXIMATE RATE OF 0.05 GALLONS PER SQUARE YARD BETWEEN EACH LIFT OF ASPHALTIC MATERIAL.
- 4) BITUMINOUS BASE AND ASPHALTIC CONCRETE WEARING SURFACE SHALL BE PLACED WITH A LAYDOWN MACHINE HAVING AUTOMATIC CONTROLS FOR LINE AND GRADE.
- 5) CONSTRUCTION JOINTS IN EACH LIFT SHALL BE STAGGERED A MINIMUM DISTANCE OF ONE (1) FOOT FROM JOINTS IN PRECEDING LIFTS AND PLACED SO THAT A JOINT WILL BE CONSTRUCTED ON THE CENTERLINE OF THE TOP LIFT.
- 6) CONTRACTOR TO BID ONLY ONE SUBGRADE TREATMENT ALTERNATE WHEN ALTERNATES ARE PROVIDED IN THE PROPOSAL AND CONTRACT. THE ALTERNATE CHOSEN BY THE SUCCESSFUL BIDDER SHALL BE USED IN CONSTRUCTING THIS PROJECT.

TRANSVERSE CONSTRUCTION JOINTS SHALL BE CONSTRUCTED IN FLEXIBLE BASE PAVEMENTS AT LOCATIONS WHERE PAVEMENT TEMPORARILY ENDS AS SHOWN BY THE DETAIL. THE COST OF CONSTRUCTION JOINTS SHALL BE INCLUDED IN THE BID PRICE FOR SQUARE YARDS 7" ASPHALTIC CONCRETE (5" BITUMINOUS BASE).

7 INCH RESIDENTIAL ASPHALTIC CONCRETE PAVEMENT WITH 5 INCH BITUMINOUS BASE
CITY OF WICHITA, KANSAS
 PROJECT NUMBER
 472-76-245-81219-000-000-001

B.M. 130.09 CITY STD. DISC 25' N. & 44' W. OF C BROADWAY & 33rd
 B.M. 129.30 R.R. SPK. IN NE FACE LITE POLE AT S.W. CORNER WELLINGTON PLACE & 33rd

N
 SCALE 1" = 20'

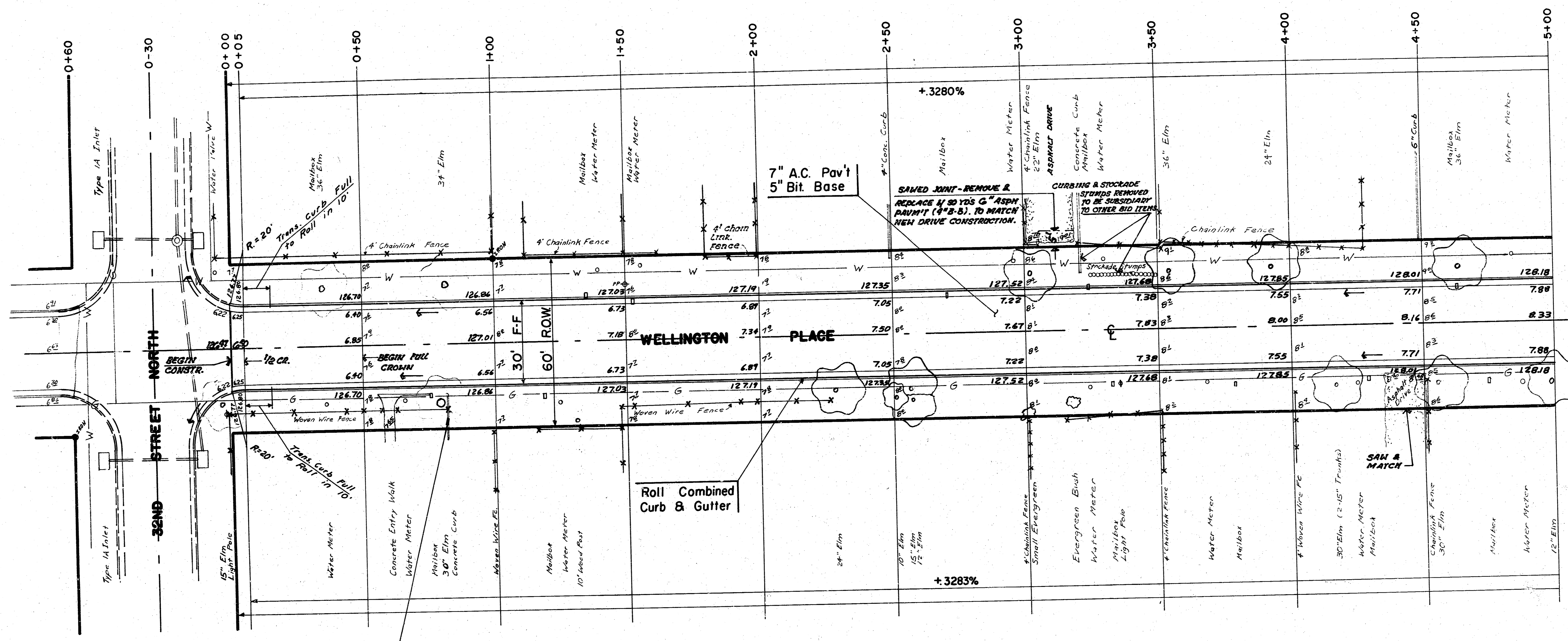

CURBING REMOVED TO BE SUBSIDIARY TO OTHER BID ITEMS.

NOTE: TRANSITION FROM FULL HEIGHT COMB CURB & GUTTER TO ROLL TYPE COMB CURB & GUTTER IS TO BE DAID AS BID FOR L.F. COMBINED CURB AND GUTTER (ROLL TYPE 3/8\"/>

MANIPULATION	2335.2 S.Y.	EXCAVATION	1214.6 C.Y.
		+ 10%	121.5 C.Y.
		TOTAL	1336.1 C.Y.

PROJECT DESCRIPTION		
WELLINGTON PLACE		
N.L. 32nd St. No. to S.L. 33rd St. No.		
PROJECT NUMBER		
472-76-245-81219-000-000-001		
BOOK NO. DCD197	APPROVED BY	DATE
DRAWN BY RAH		REVISED
CITY OF WICHITA		
M.E. LINDEBAK	CITY ENGINEER	SCALE 1" = 20'

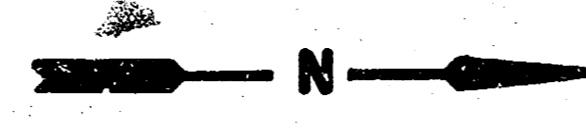

SCALE 1" = 20'

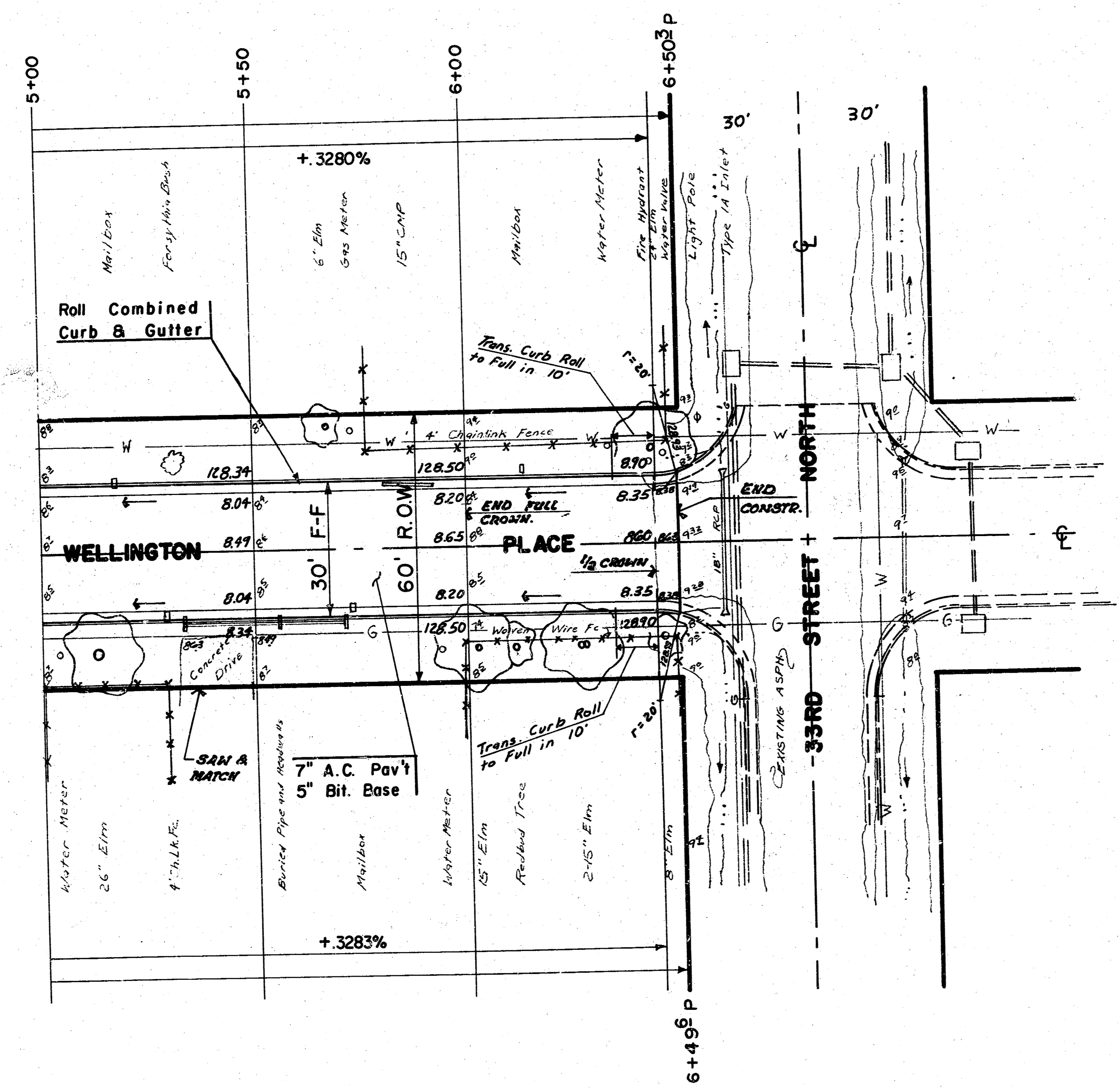

NOTE: HEAD WALLS REMOVED ON ENTRANCE DICES TO BE SUBSIDIARY TO L.F. ENTRANCE PIPE REMOVED.

PROJECT DESCRIPTION
WELLINGTON PLACE
N.L. 32nd Street N. to S.L. 33rd Street N.
PROJECT NUMBER
472-76-245-81219-000-001

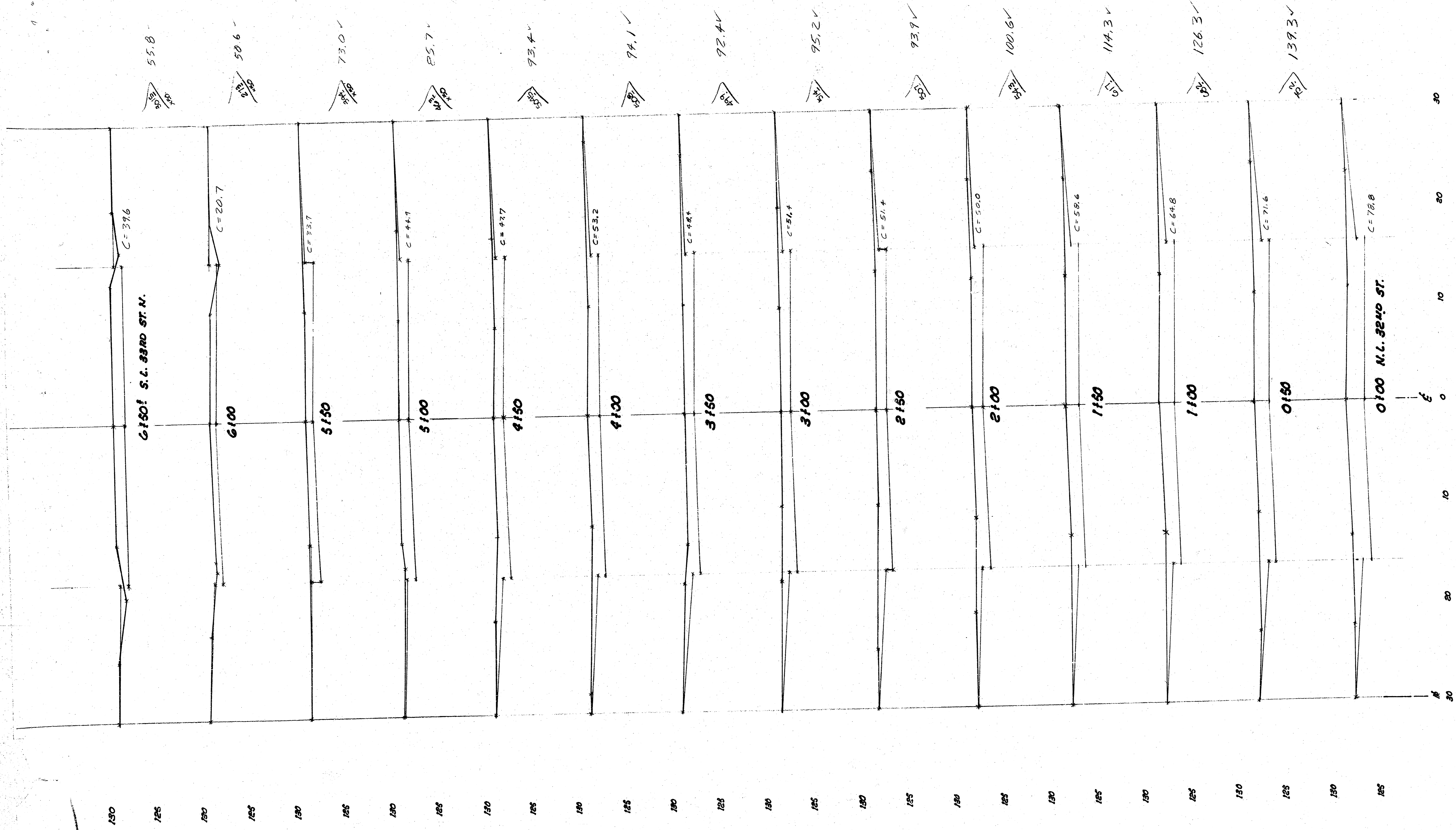

5/5

TOTAL EXCAVATION THIS JOB 1214.6

WELLINGTON PLACE
N.L. 32ND ST. N. TO S.L. 33RD ST. N.
PROJ. NO. 478-76-245-81214.00-00-01