



PAVING PLAN 1944

WELLINGTON PLACE N.L. 22<sup>ND</sup> ST TO S.L. 23<sup>RD</sup> ST

COMB. CURB & GUTTER & EXC.

B.M. ELEV. 125.46 "W" IN WHEELER C.W.K. W. N.W. WELLINGTON PLACE @ 22<sup>ND</sup> ST.

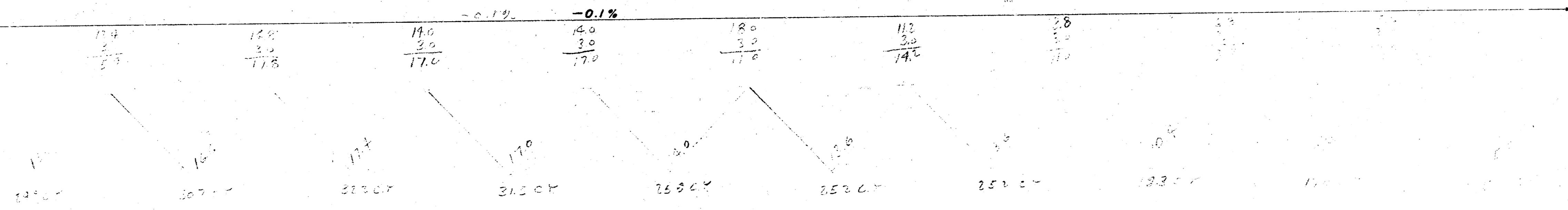
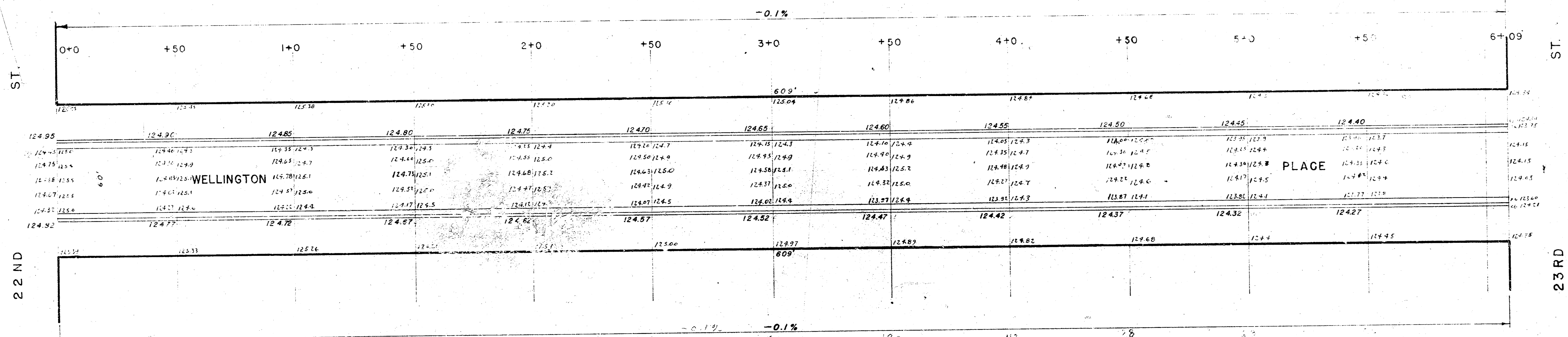

Prop. 3.000 Cu. Yd  
+10.1  
37.95



B.M. 123.11 "G" in Globe @ Back Curb On Walk Ctr. Wk. E. N.E. Cor. 21<sup>st</sup> f Fairview

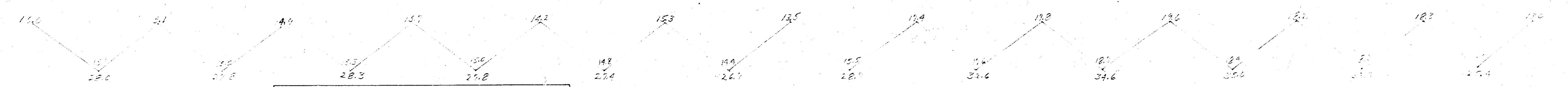
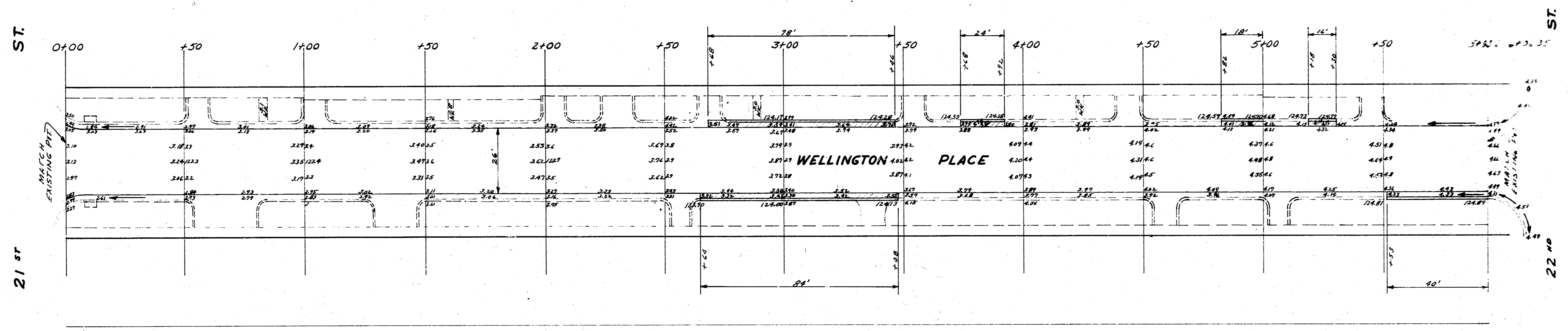
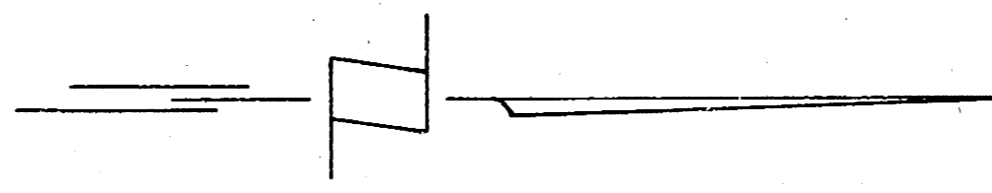

NOTE: REMOVE & REPLACE COMB. CTS AND PARTS OF DRIVE AS SHOWN BY CROSS HATCHED. ANY ADDITIONAL REMOVAL SHALL BE AUTHORIZED BY FIELD ENG.

Explanation  
 Prop. E.T.E.  
 7/1/57



WELLINGTON PLACE  
 NL 21<sup>st</sup> To SL 23<sup>rd</sup>  
 26 CONC  
 CITY OF WICHITA KAN  
 BESMITH CITY ENGINEER  
 July 1957 Proj No C16-219

