

B.M. 118.17 on conc. parking N.E. Cor. West St. & Douglas  
 O.M. 120.45 S.E. Cor. lower step Ho. #137 S.W. Cor. West & 1st St.

Scale: 1" = 20'

Exc.	Prop.	File	Lot
4567.3	472	526.2	30.4
+10.7	112	210.2	1.2
5678.0 m. yds.	484	526.2	31.6
		5787.2 m. yds.	21.8 m. yds.

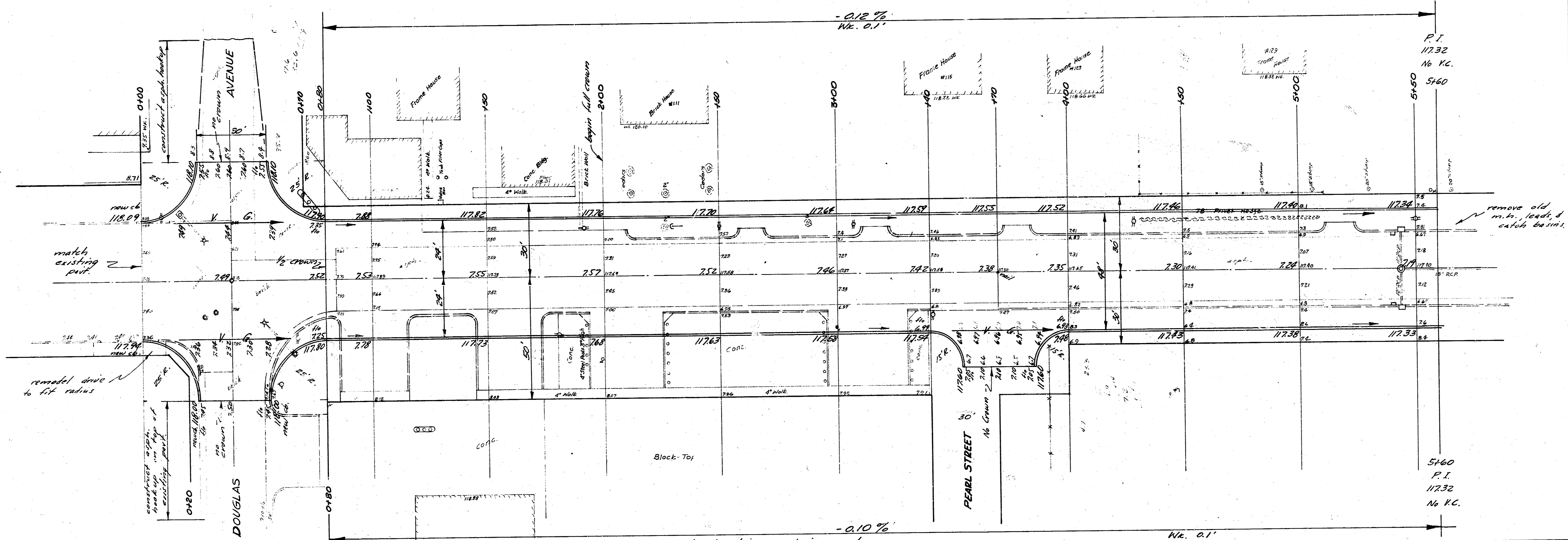

NOTE TO FIELD ENGR.: Check elevation on drives east of new curb & save east part of drives if possible (0180 to 3+40).

NOTE TO FIELD ENGR.: Take his to insure prior to construction of replace same. All driveways on 6' parking to be R202R type.

NOTE TO CONTRACTOR & FIELD ENGR.: Intersections @ Douglas, 2nd & 3rd are to be paved with hi-early cement. Intersections & hookups are to be completed & open to traffic as quickly as possible. Cost of hi-early cement to be incidental to project.



2/73

**WEST STREET**  
 SL Douglas to SL Central  
 48'-8" Conc.  
 CITY OF WICHITA, KANSAS  
 B. E. SMITH CITY ENGINEER  
 SEPT. 1958 PROJ. NO. C18-36





B.M. 171.88 S.E. Cor. lower step Tol. Bldg. 4341 N. West

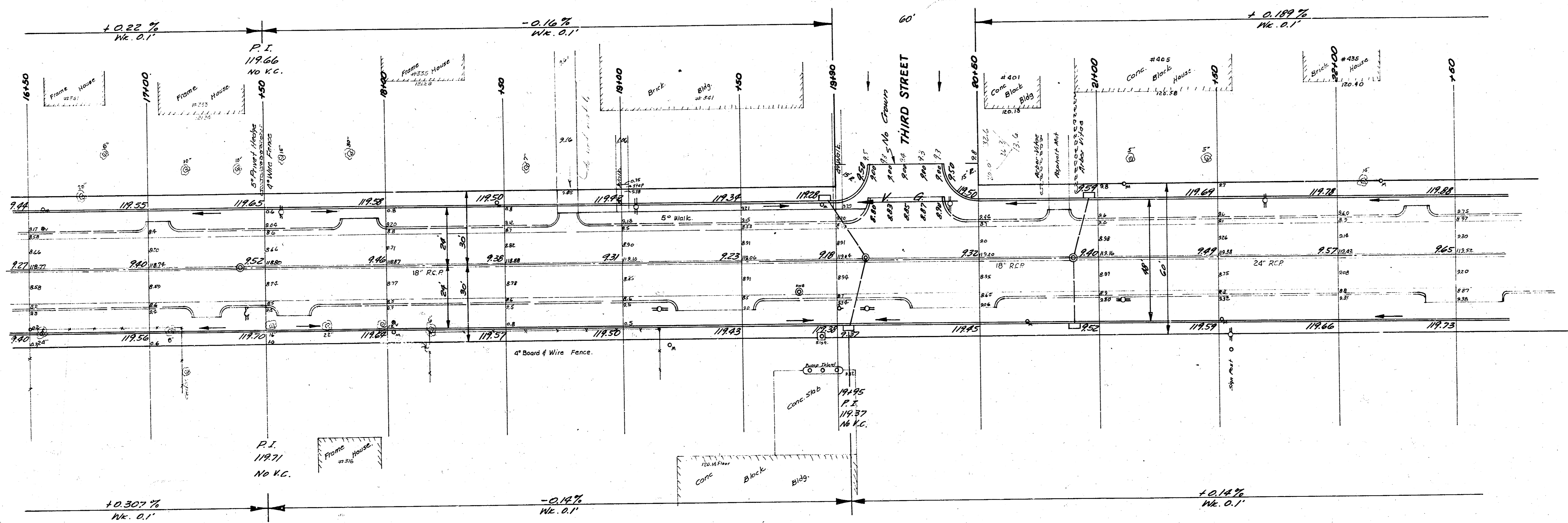
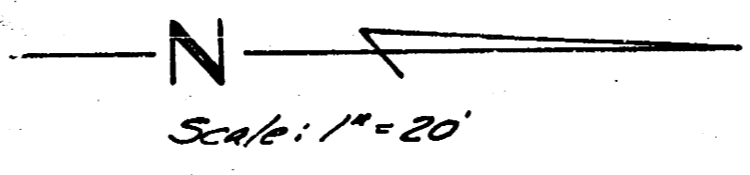

NOTE TO CONTRACTOR & FIELD ENGR.:  
Pave from 119.90 to 20+50 with hi-early  
cement. Cost of hi-early incidental to proj.

WEST STREET  
SL Douglas to SL Central  
Sheet 5 of 13 PROJ. NO. C18-36

B.M. 121.88 S.E. Cor. lower stop T&I Bldg. # 391 N. West

B.M. 121.72 N.W. cor. lower stop No. # 500 N. West

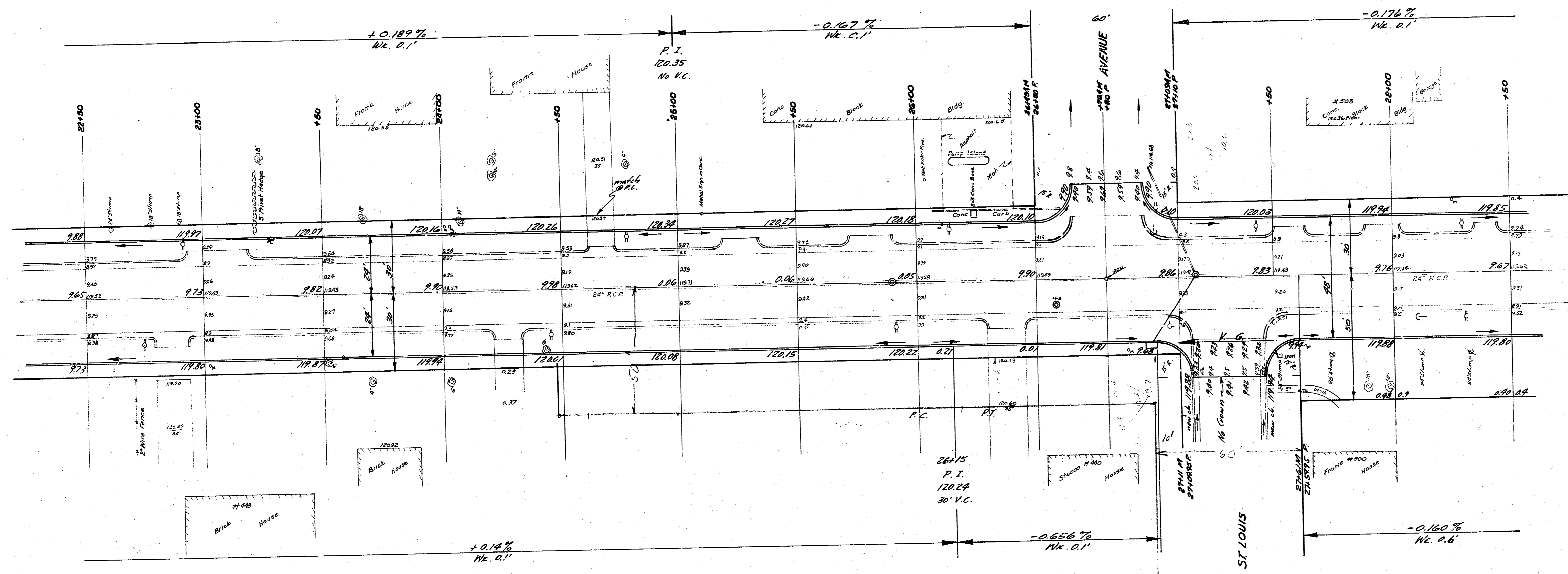
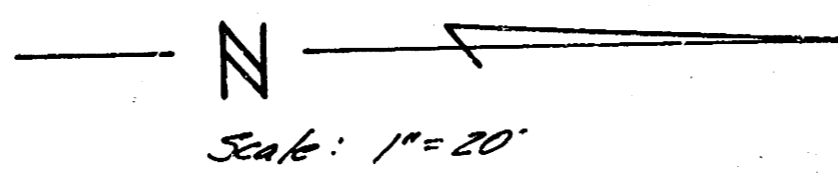

WEST STREET  
SL Douglas to SL Central  
Sheet 6 of 13 PROJ. NO. C18-36

B.M. 121.70 N.W. Cor. lower step 16. # 500 N. West

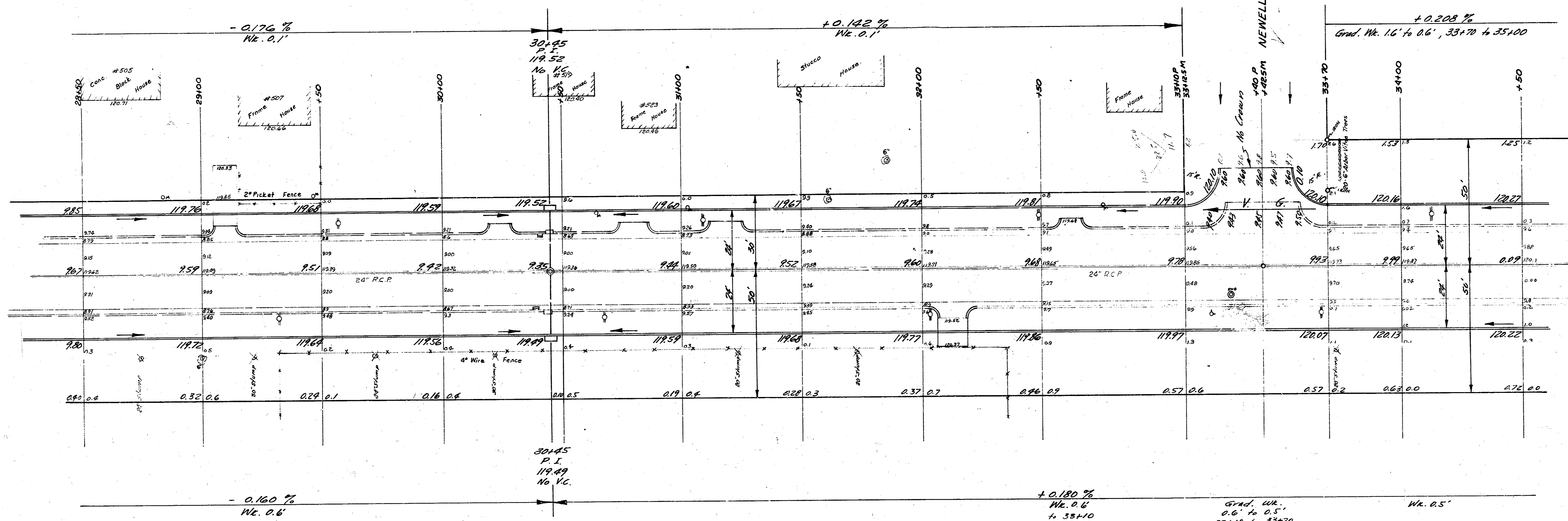
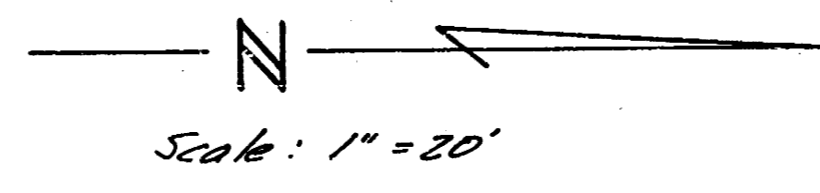

WEST STREET  
SL Douglas to SL Central  
Sheet 7 of 13 PROJ. NO. C18-55



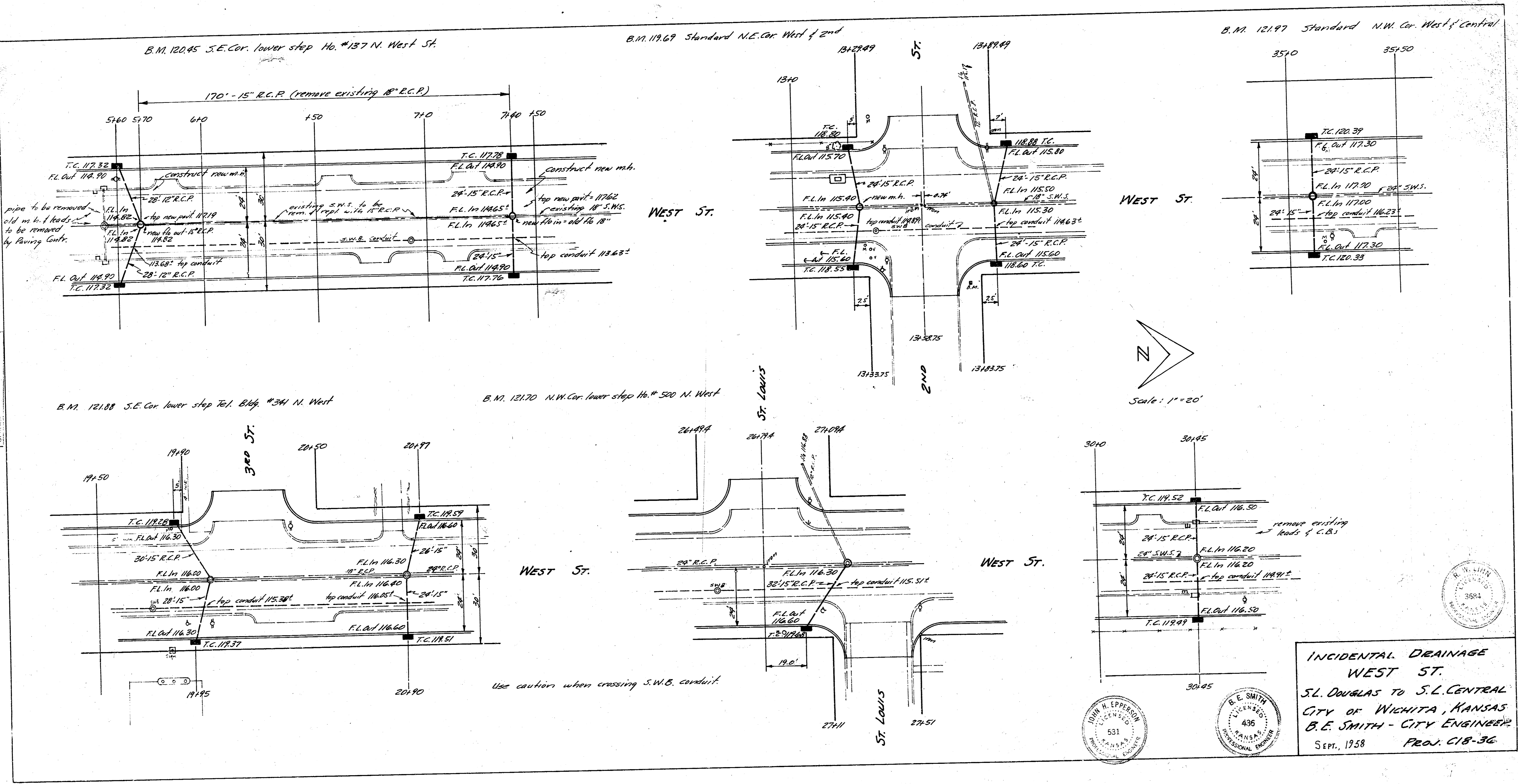

1. All work to be done in accordance with the specifications for the City of Wichita, Kansas.

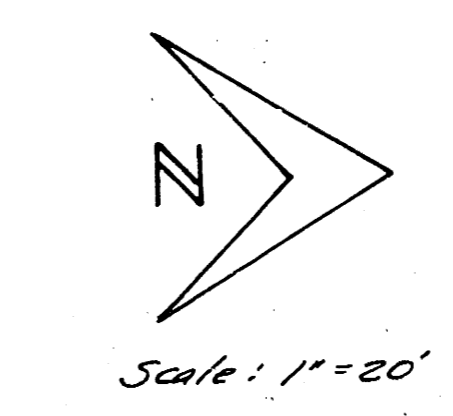

INCIDENTAL DRAINAGE  
 WEST ST.  
 S.L. DOUGLAS TO S.L. CENTRAL  
 CITY OF WICHITA, KANSAS  
 B.E. SMITH - CITY ENGINEER  
 SEPT., 1958      PROJ. C18-36

