

B.M.=128.53 R.R. Spike N. Side P.Pole on S.E. Cor West Lynn & Ott.  
 B.M.=128.44 "G" in Globe W.L. Sabin on N. Curb Ott.  
 B.M.=129.23 R.R. Spike W. Side P.Pole S. Side 16th St. at E.L.  
 Womers West Lynn 2nd Add.

Base Line is on Center Line.

Scale 1"= 20'

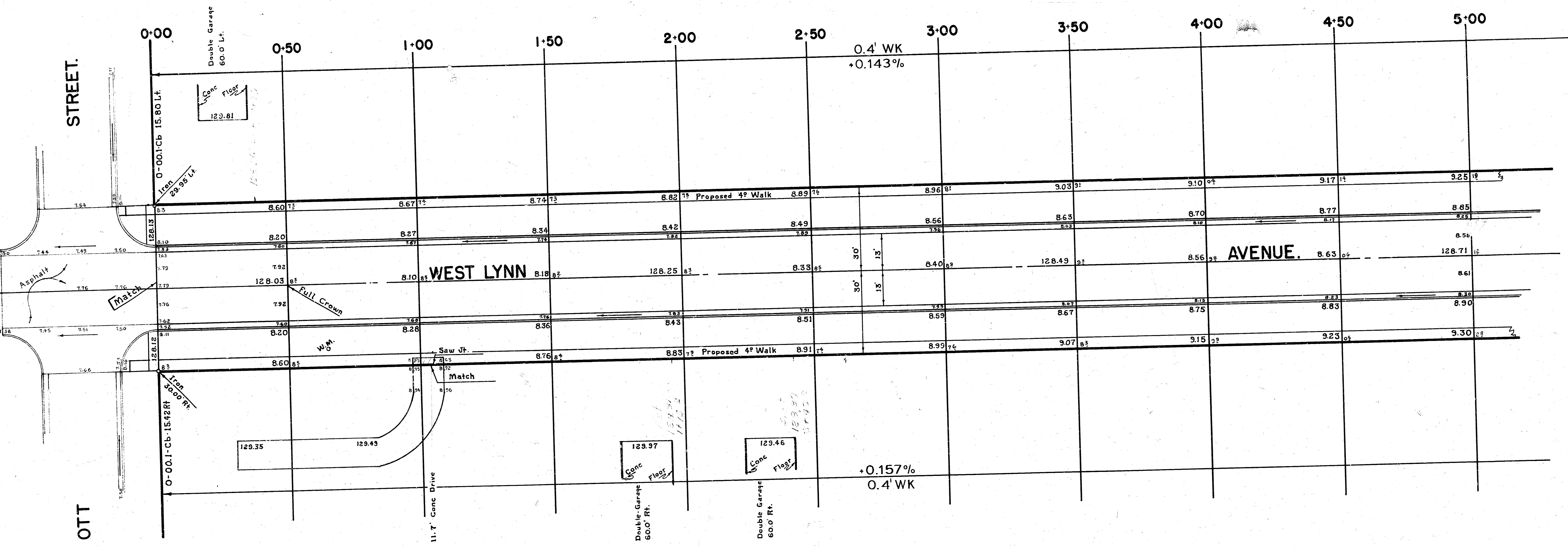
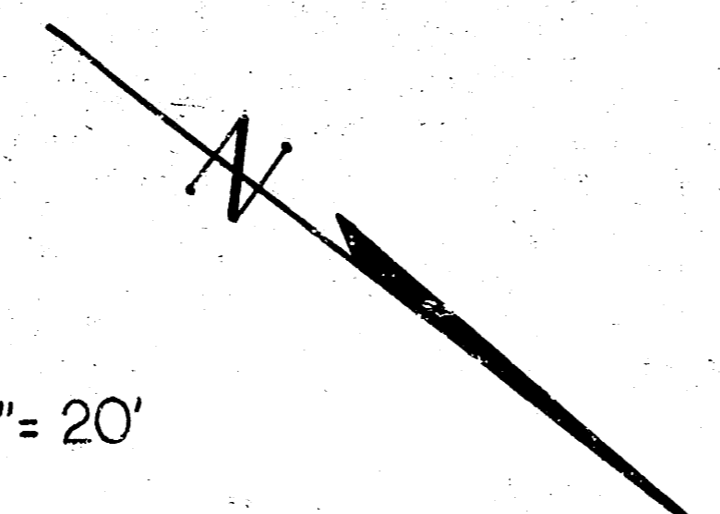

**NOTE** To Field Engineer and Contractor  
 Grade parking for proposed sidewalk.  
 Compact fill in sidewalk area.  
 Sidewalk to be constructed by others.

PROPERTY	
<b>EXCAVATION</b>	<b>COMP - FILL</b>
1,839.6 Cu Yds	126.7 Cu Yds
+10% 184.0 " "	+10% 12.7 " "
<b>TOTAL 2,023.6 Cu Yds</b>	<b>TOTAL 139.4 Cu Yds</b>

**WEST LYNN AVENUE**  
 N.L. OTT STREET to S.L. 16TH STREET  
**26' - 2' - 30' ASPHALTIC-CONCRETE**  
 City of Wichita, Kansas  
 B.E. Smith City Engineer  
 Date: JUNE 1966 Proj No. C14-51

