

B. M. 129.99 Double spike E. S. Pale E.S. West Dale Dr.
120' S. of P.C. on S.L. Westport Lane.

B. M. 132.78 S.W. cor. conc. porch W. S. of Ho.
N. E. 17th & Nevada.

Baseline = North \mp .

CURVE DATA					
Stations	Arc length North \mp	Chord length & offset from face of 1st. cb R = 102.9'	Chord length & offset from face of 2nd. cb R = 155.9'	Deflection	Total Deflection
0100 P.C.				0° 00' 00"	0° 00' 00"
0132.0	38.00'	40.36'	57.25'	10° 34' 49"	10° 34' 49"
0174.93 P.T.	36.93'	39.23'	55.46'	10° 16' 36"	20° 51' 45"

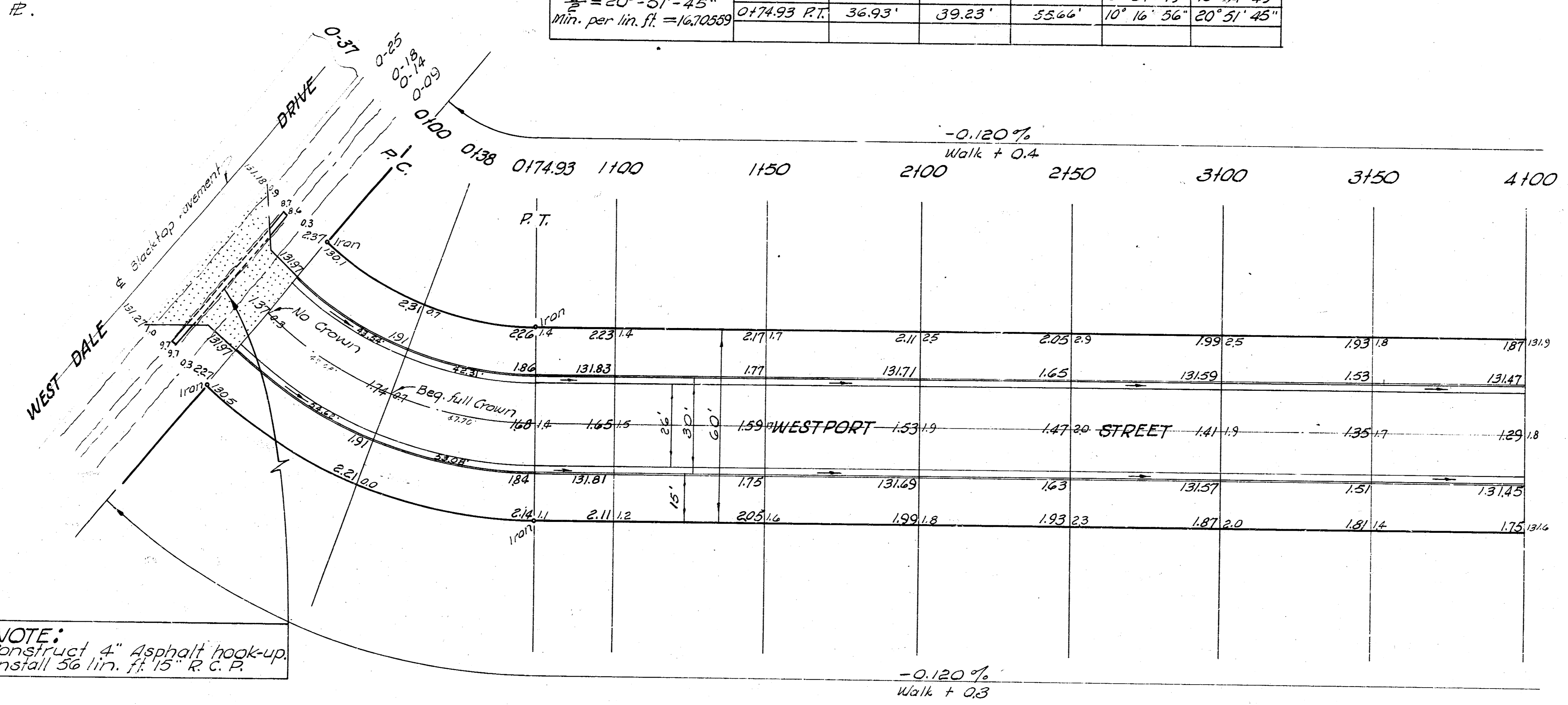
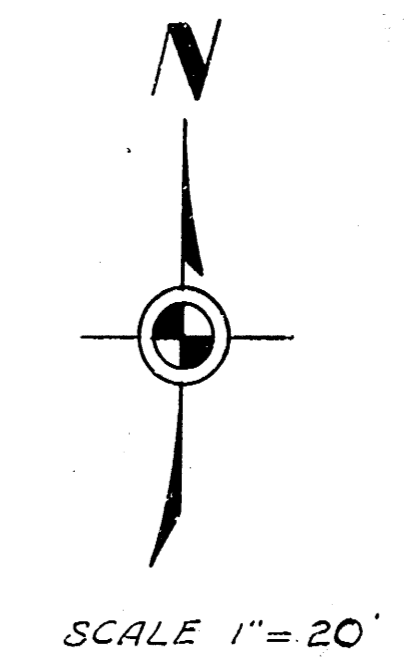

NOTE:
Construct 4" Asphalt hook-up.
Install 36 lin. ft. 15" R.C.P.

EARTHWORK			
CITY FILL COMPACTION	EXCAVATION	PROP. FILL COMPACTION	
30.4	484.1	74.3	
5.0	48.4	7.4	
55.4 Cu. yds.	532.5 Cu. yds.	81.7 Cu. yds.	

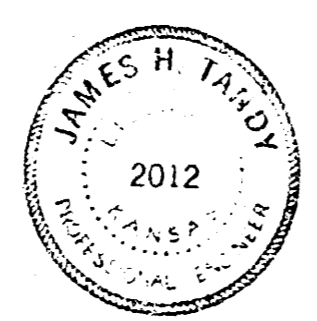

WESTPORT STREET
EL WEST DALE DR. TO W.L. NEVADA ST.
26-2-30 A.C.
CITY OF WICHITA, KANSAS
B. E. SMITH CITY ENGINEER
SEPT. 1961 PROJ. NO. C19-120

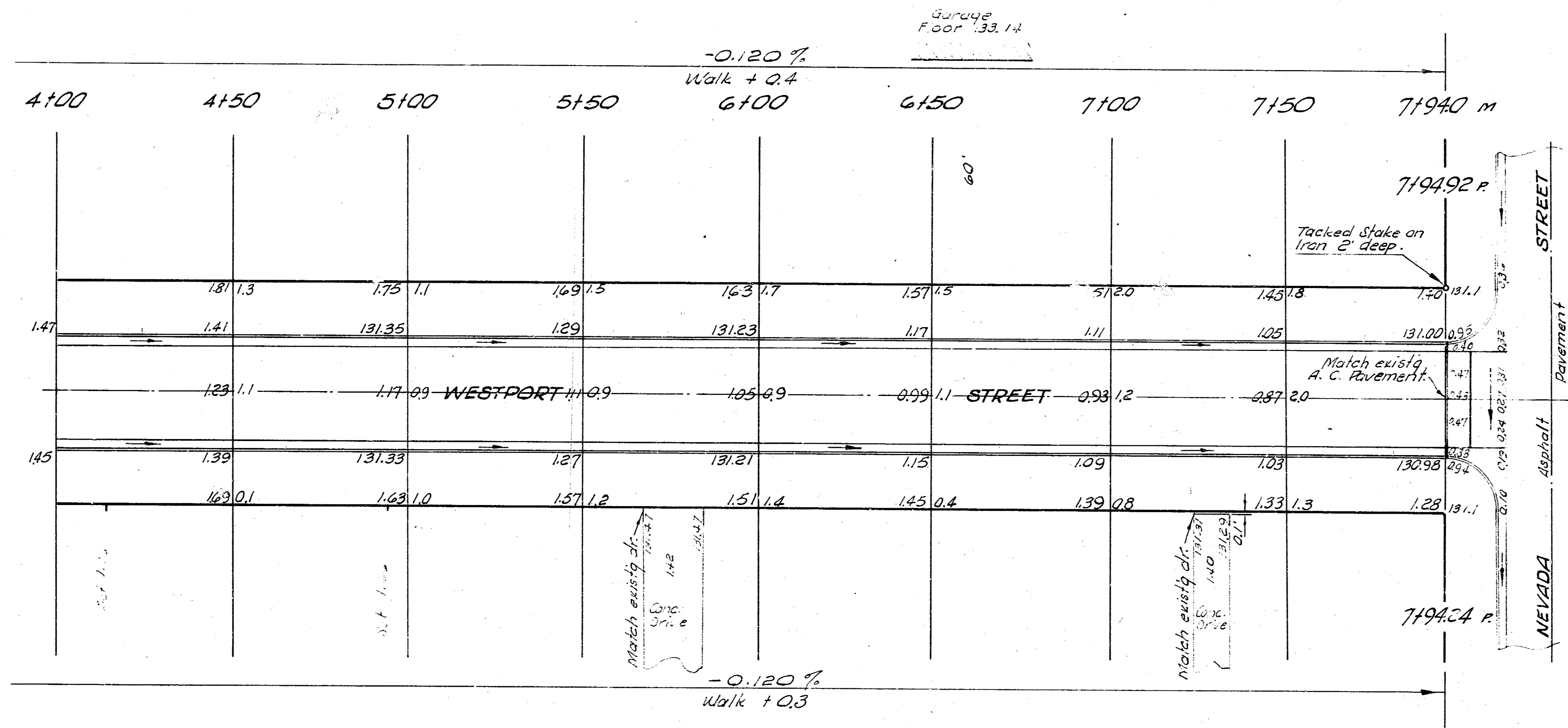
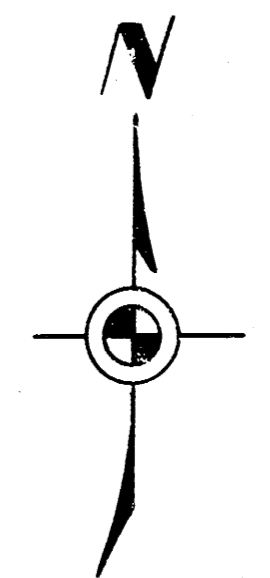

WESTPORT STREET
WEST DALE DR. TO NEVADA ST.

2/3

PROJ. NO. C19-120