

B.M. 12166 City Sta. @ S.E. Cor. Sheridan & Central

B.M. 120595 "P" in P.K.S. E. end Radius on N.E. Cor. West Ridge & Central

B.M. 12419 S.W. Cor. Tile Porch No. # 736 West Ridge

Scale: 1"=20'

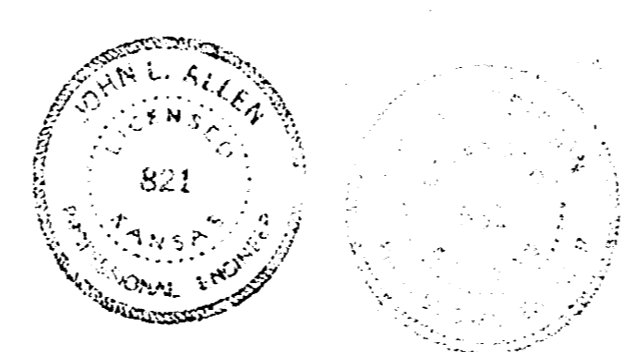
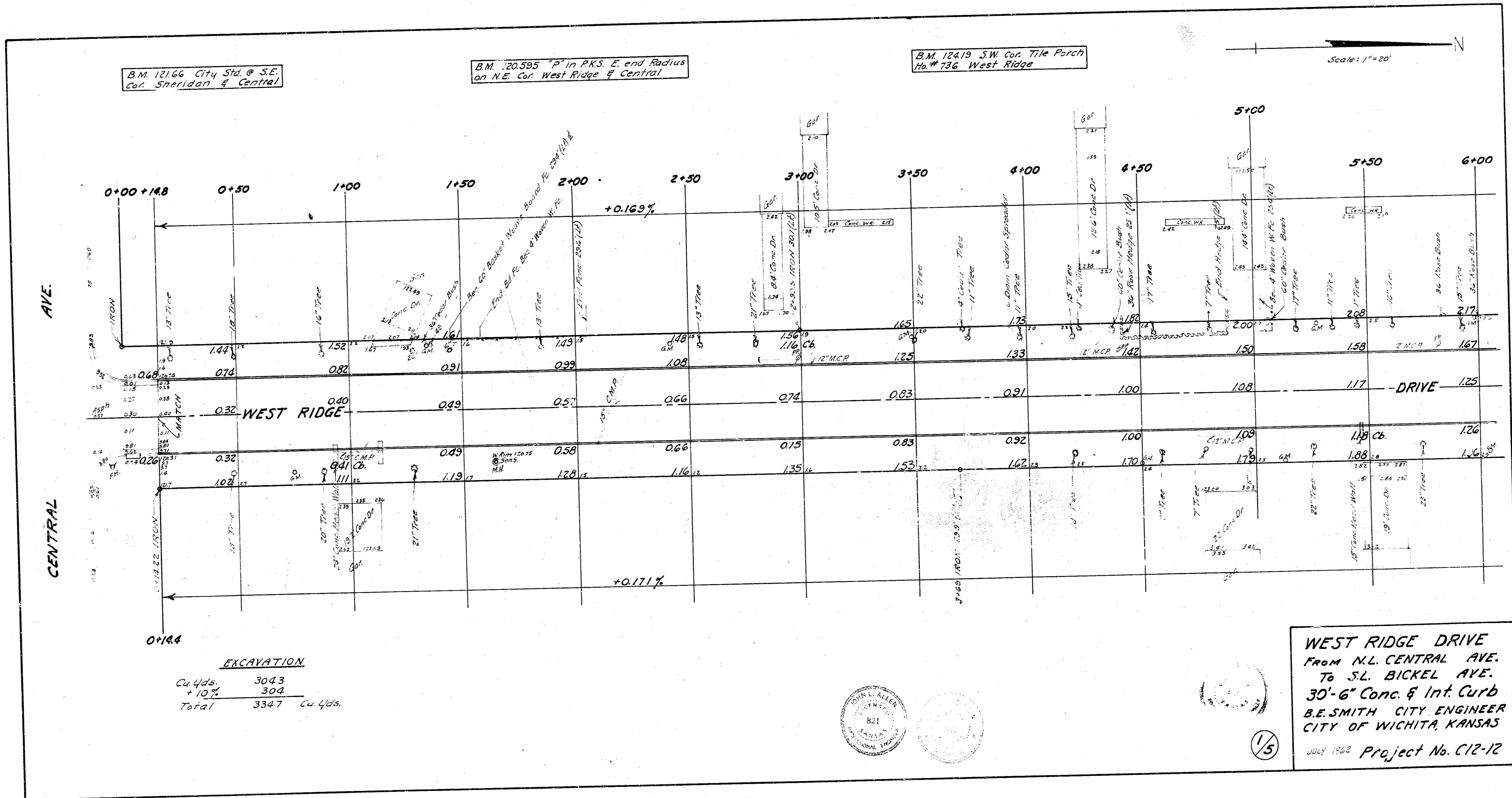

15

B.M. 123.50 N.E. Cor. Conc. Porch No. 817 West Ridge

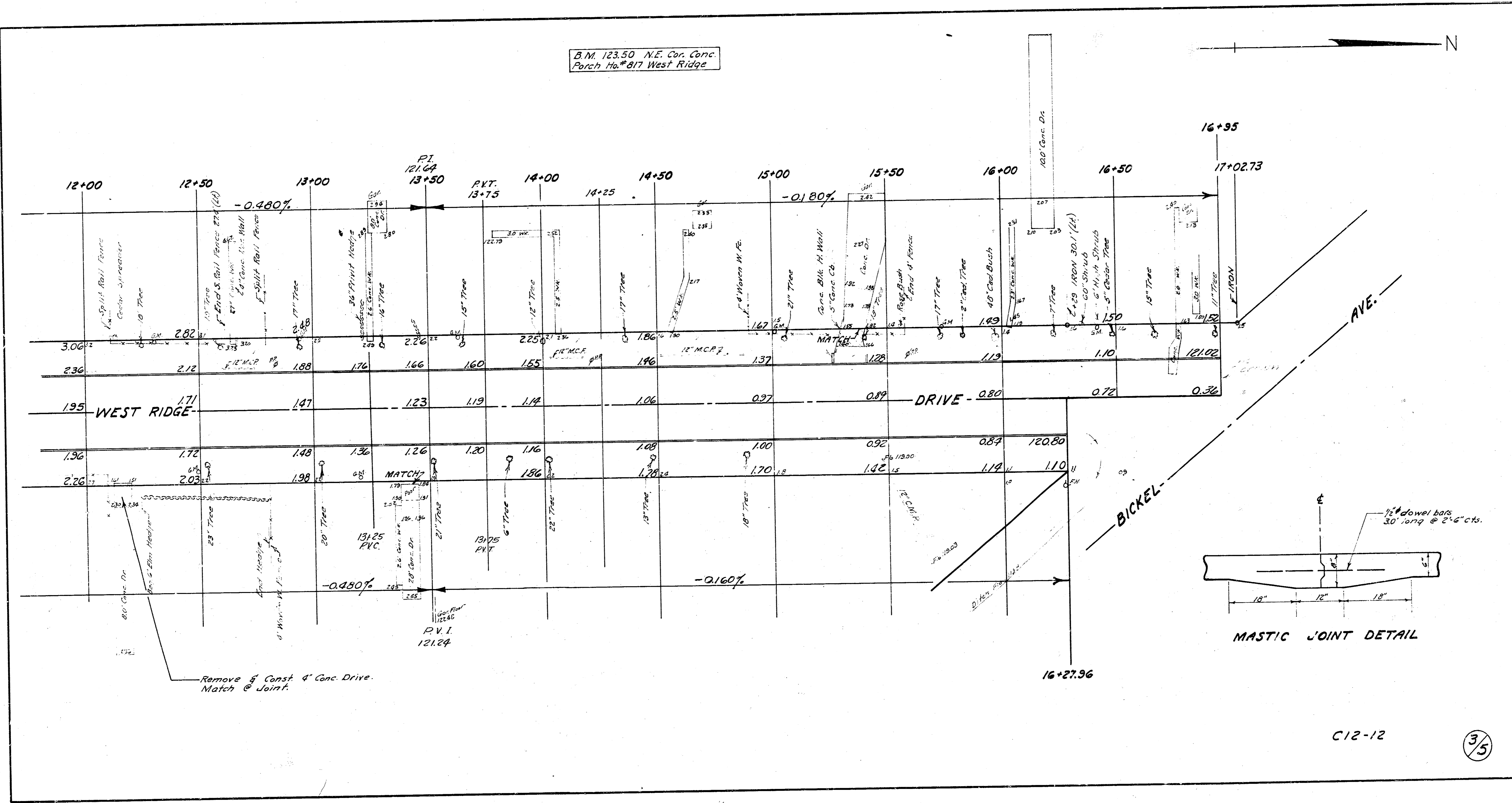

C12-12

3/5

T.P. 124.35 N.E. Cor. Step  
Ht. # 753 West Ridge

B.M. 123.67 N.W. Cor. Conc  
Porch Ht. # 768 West Ridge

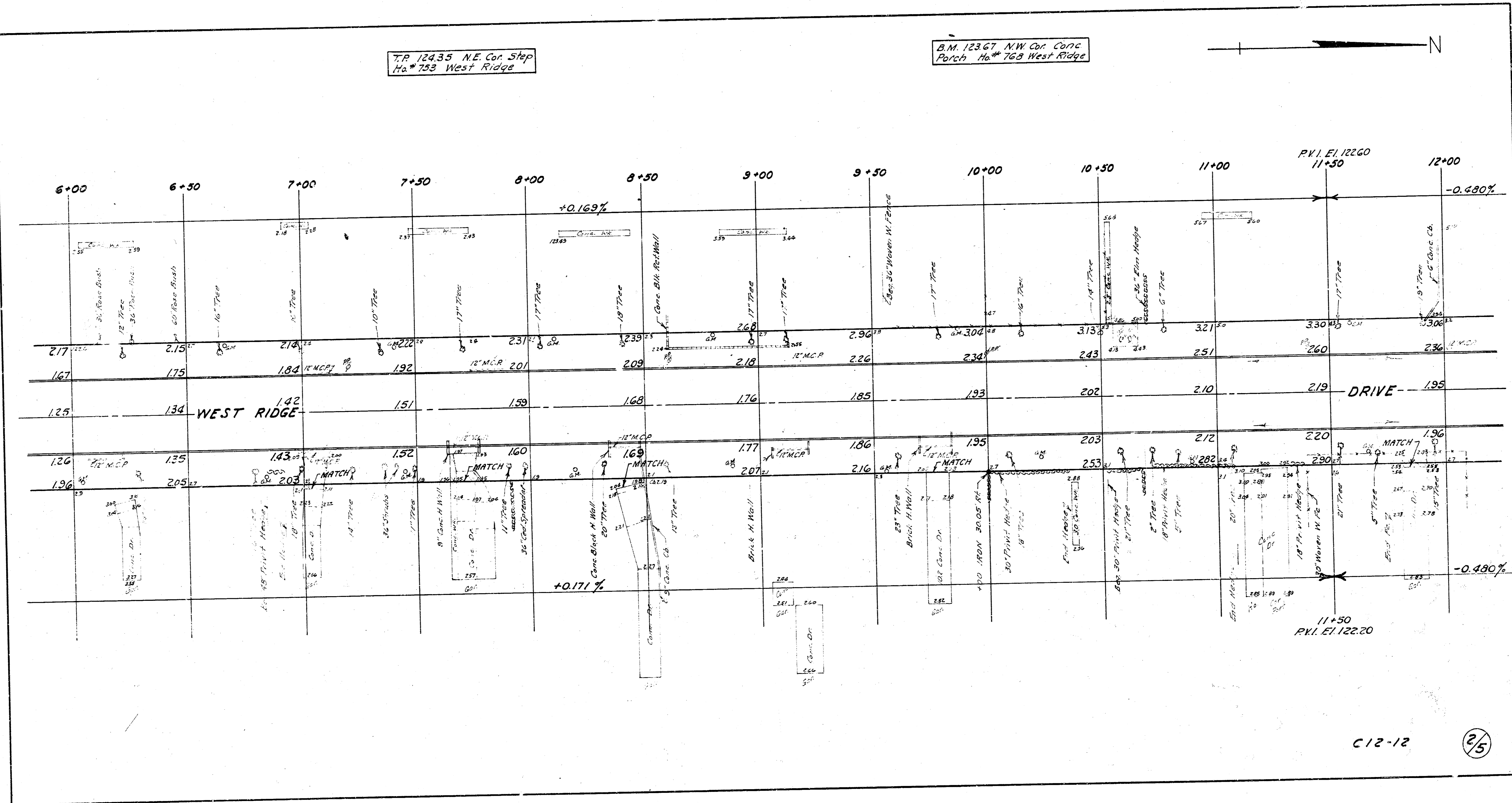

C12-12

25