

**HOLLAND LANE** E.L. SMARSH LANE TO N.L. WESTWOOD HEIGHTS SECOND ADDITION.

**TONY LANE** N.L. WESTPORT AVE TO E.L. HOLLAND LN.

**BITTERSWEET LANE** E.L. TONY LANE TO E.L. LOT 1, BLK.7, WESTWOOD HEIGHTS SECOND ADDITION.

**SMARSH LANE** N.L. WESTPORT AVE TO N.L. WESTWOOD HEIGHTS SECOND ADDITION.

PROJECT NO. 472-76-245-80799-000-000-001

*Resolution amended 2-9-82 (in Clerk's Office)  
Instructional*

*Sketch no. - 6-81*

INDEX OF SHEETS

SHEET NO.	DESCRIPTION
1	COVER SHEET
2	TYPICAL 29' PAVEMENT DETAILS
3	" 31' "
4	TYPICAL 35' PAVEMENT DETAILS
5-6	PLAN - HOLLAND LANE
7	PLAN - TONY LANE & BITTERSWEET LANE
8-9	PLAN - SMARSH LANE
10-11	CROSS SECTIONS HOLLAND LANE
12	CROSS SECTIONS BITTERSWEET LANE
13	CROSS SECTIONS TONY LANE
14	CROSS SECTIONS SMARSH LANE

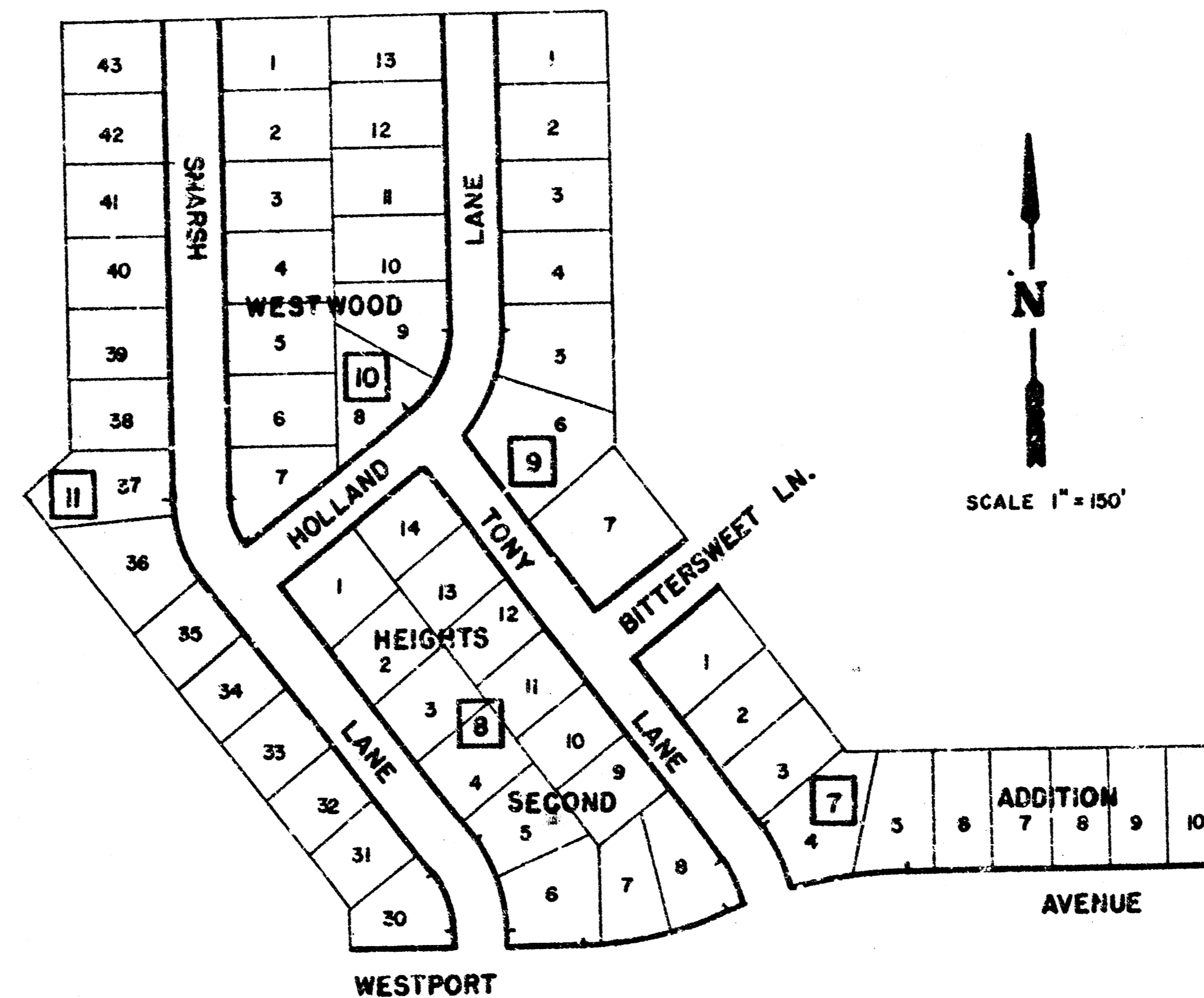

ROAD  
RIDGE

GENERAL NOTES

- (1) WIDENED GUTTER SECTION OF COMBINED CURB AND GUTTER AT INTERSECTIONS WILL NOT BE PAID FOR DIRECTLY, AND THIS COST SHALL BE CONSIDERED AS SUBSIDIARY TO THE OTHER PAY ITEMS OF WORK.
- (2) THE REMOVAL OF EXCESS PAVEMENT AND/OR CURB AND GUTTER PLACED DURING THE CONSTRUCTION OF WESTPORT AVENUE SHALL BE CONSIDERED INCIDENTAL TO EXCAVATION.

M.E. LINDEBAK - CITY ENGINEER  
CITY OF WICHITA, KANSAS

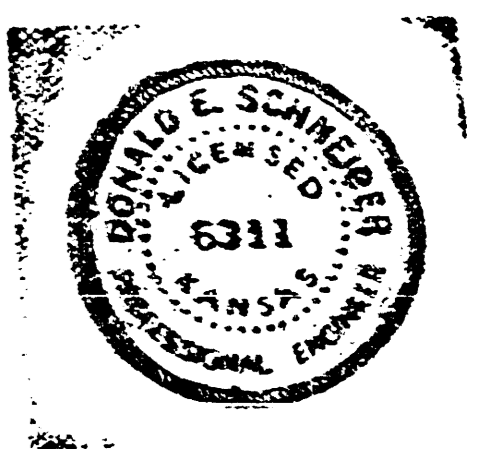

# TYPICAL 29' PAVEMENT DETAILS

## TRANSVERSE SECTION

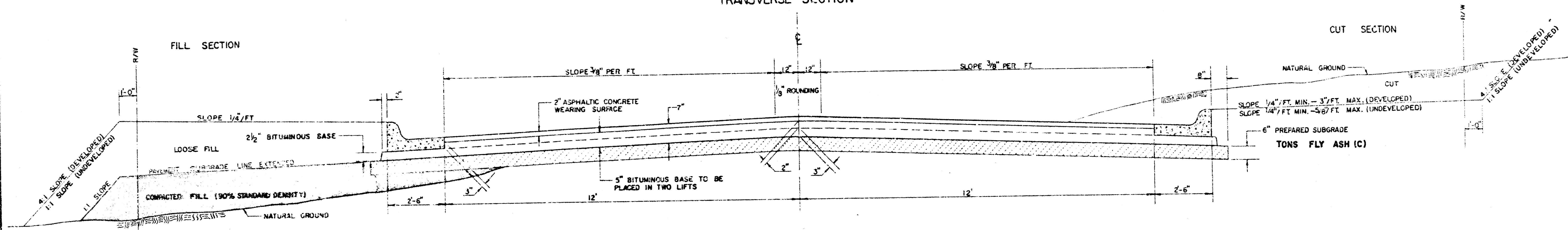

## ELEVATION OFFSETS

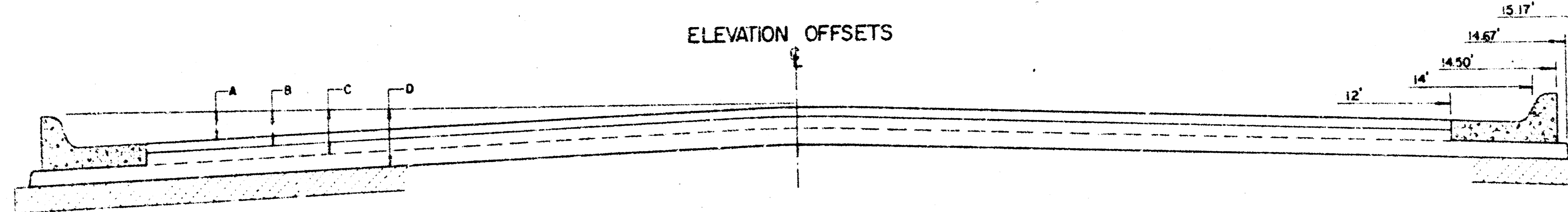

	DISTANCE FROM CENTERLINE (LT. & RT.)											
	0'	2'	4'	6'	7'	8'	10'	12'	14'	14.5'	14.67'	15.17'
A: TOP OF CURBS TO TOP OF SURFACE LIFT	0.13	0.18	0.24	0.30	0.33	0.36	0.43	0.49	---	---	---	---
B: TOP OF CURBS TO TOP OF UPPER BASE LIFT	0.30	0.35	0.41	0.47	0.50	0.53	0.60	0.66	---	---	---	---
C: TOP OF CURBS TO TOP OF LOWER BASE LIFT	0.47	0.52	0.60	0.68	0.71	0.75	0.83	0.90	0.98	1.00	1.01	---
D: TOP OF CURBS TO TOP OF SUBGRADE	0.72	0.77	0.84	0.91	0.94	0.98	1.05	1.12	1.19	1.21	1.21	1.23

### COMBINED CURB & GUTTER

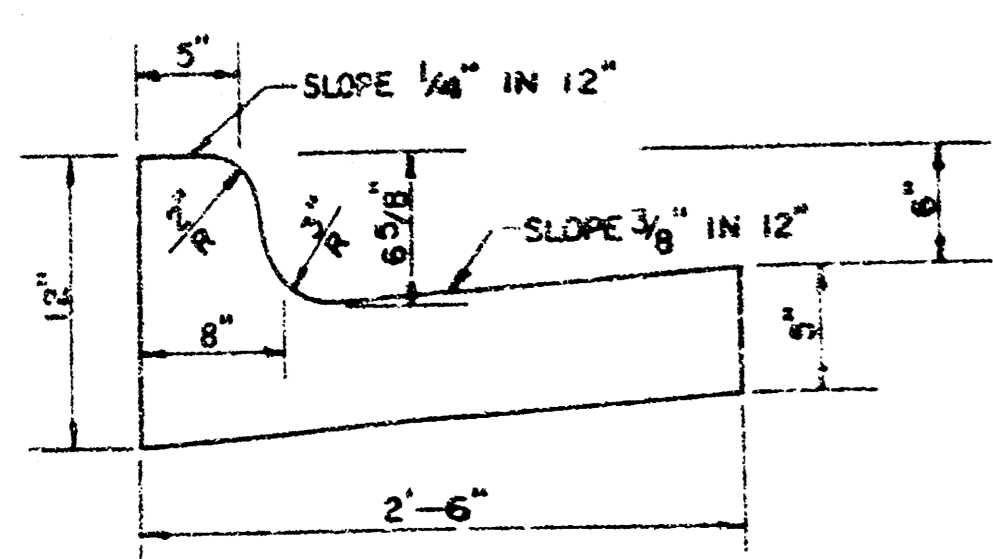

### ROLL TYPE COMBINED CURB & GUTTER

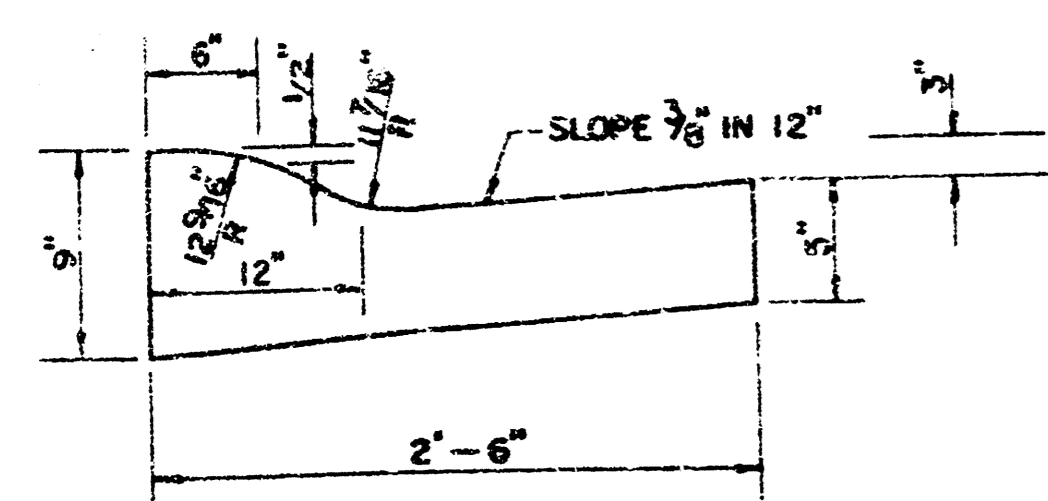

### TRANSVERSE CONSTRUCTION JOINTS

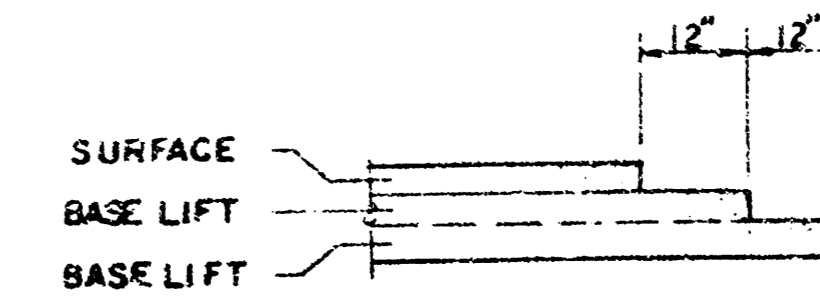

TRANSVERSE CONSTRUCTION JOINTS SHALL BE CONSTRUCTED IN FLEXIBLE BASE PAVEMENTS AT LOCATIONS WHERE PAVEMENT JOINS EXISTING FLEXIBLE BASE PAVEMENT AS SHOWN BY THE DETAIL. ALL COSTS ASSOCIATED WITH THE CONSTRUCTION OF THE TRANSVERSE JOINT SHALL BE INCLUDED IN THE BID PRICE FOR SQUARE YARDS 7" ASPHALTIC CONCRETE (5" BITUMINOUS BASE).

### GENERAL NOTES

- 1) THE ASPHALTIC CONCRETE PAVEMENT BETWEEN THE COMBINED CURB AND GUTTER SHALL BE PAID AS SQUARE YARDS OF 7" ASPHALTIC CONCRETE (5" BITUMINOUS BASE).
- 2) THE BITUMINOUS BASE UNDER AND BEHIND THE COMBINED CURB AND GUTTER SHALL BE PAID AS SQUARE YARDS OF 2 1/2" BITUMINOUS BASE.
- 3) A TACK COAT OF EMULSIFIED ASPHALT (50-1H OR 655-1H) SHALL BE APPLIED AT AN APPROXIMATE RATE OF 0.05 GALLONS PER SQUARE YARD BETWEEN EACH LIFT OF ASPHALTIC MATERIAL.
- 4) BITUMINOUS BASE AND ASPHALTIC CONCRETE WEARING SURFACE SHALL BE PLACED WITH A LAYDOWN MACHINE HAVING AUTOMATIC CONTROLS FOR LINE AND GRADE.
- 5) CONSTRUCTION JOINTS IN EACH LIFT SHALL BE STAGGERED A MINIMUM DISTANCE OF ONE (1) FOOT FROM JOINTS IN PRECEDING LIFT AND PLACED SO THAT A JOINT WILL BE CONSTRUCTED ON THE CENTERLINE OF THE TOP LIFT.
- 6) CONTRACTOR TO BID ONLY ONE SUBGRADE TREATMENT ALTERNATE WHEN ALTERNATES ARE PROVIDED IN THE PROPOSAL AND CONTRACT. THE ALTERNATE CHOSEN BY THE SUCCESSFUL BIDDER SHALL BE USED IN CONSTRUCTING THIS PROJECT.

7 INCH RESIDENTIAL ASPHALTIC CONCRETE  
PAVEMENT WITH 5 INCH BITUMINOUS BASE  
CITY OF WICHITA, KANSAS

PROJECT NUMBER  
472-76-245-80799 - 000-000-001 2/14

# TYPICAL 3' PAVEMENT DETAILS

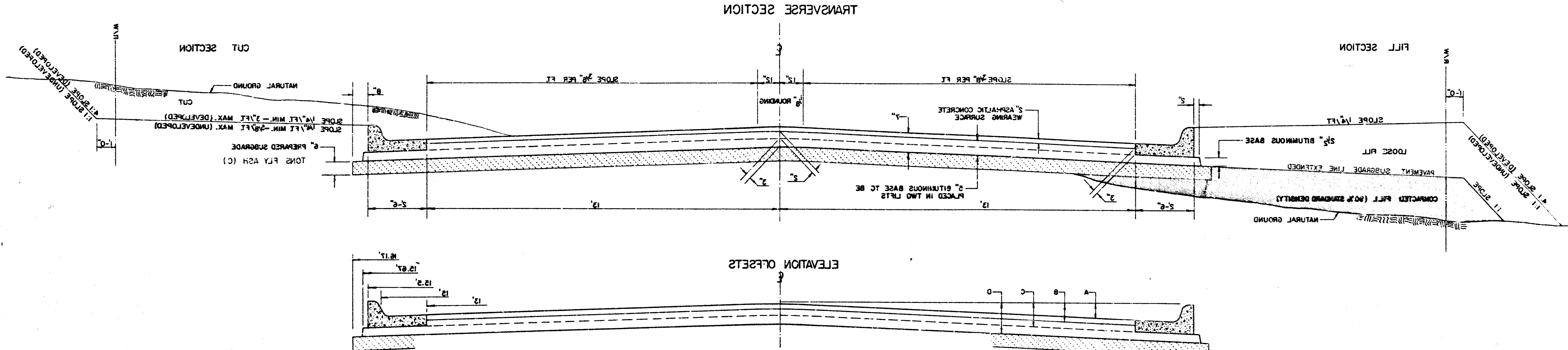

DISTANCE FROM CENTERLINE (L.T. & R.T.)	
0'	1.5'
0.00	0.00
0.01	0.01
0.02	0.02
0.03	0.03
0.04	0.04
0.05	0.05
0.06	0.06
0.07	0.07
0.08	0.08
0.09	0.09
0.10	0.10
0.11	0.11
0.12	0.12
0.13	0.13
0.14	0.14
0.15	0.15
0.16	0.16
0.17	0.17
0.18	0.18
0.19	0.19
0.20	0.20
0.21	0.21
0.22	0.22
0.23	0.23
0.24	0.24
0.25	0.25
0.26	0.26
0.27	0.27
0.28	0.28
0.29	0.29
0.30	0.30
0.31	0.31
0.32	0.32
0.33	0.33
0.34	0.34
0.35	0.35
0.36	0.36
0.37	0.37
0.38	0.38
0.39	0.39
0.40	0.40
0.41	0.41
0.42	0.42
0.43	0.43
0.44	0.44
0.45	0.45
0.46	0.46
0.47	0.47
0.48	0.48
0.49	0.49
0.50	0.50

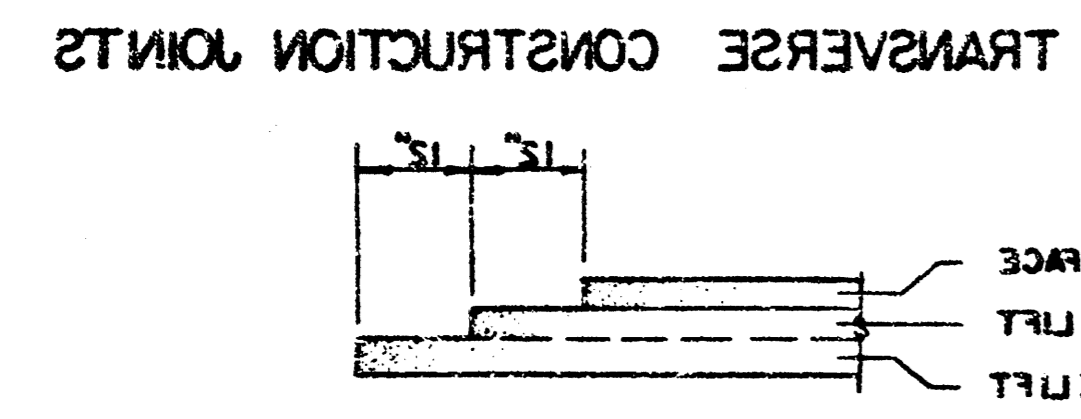
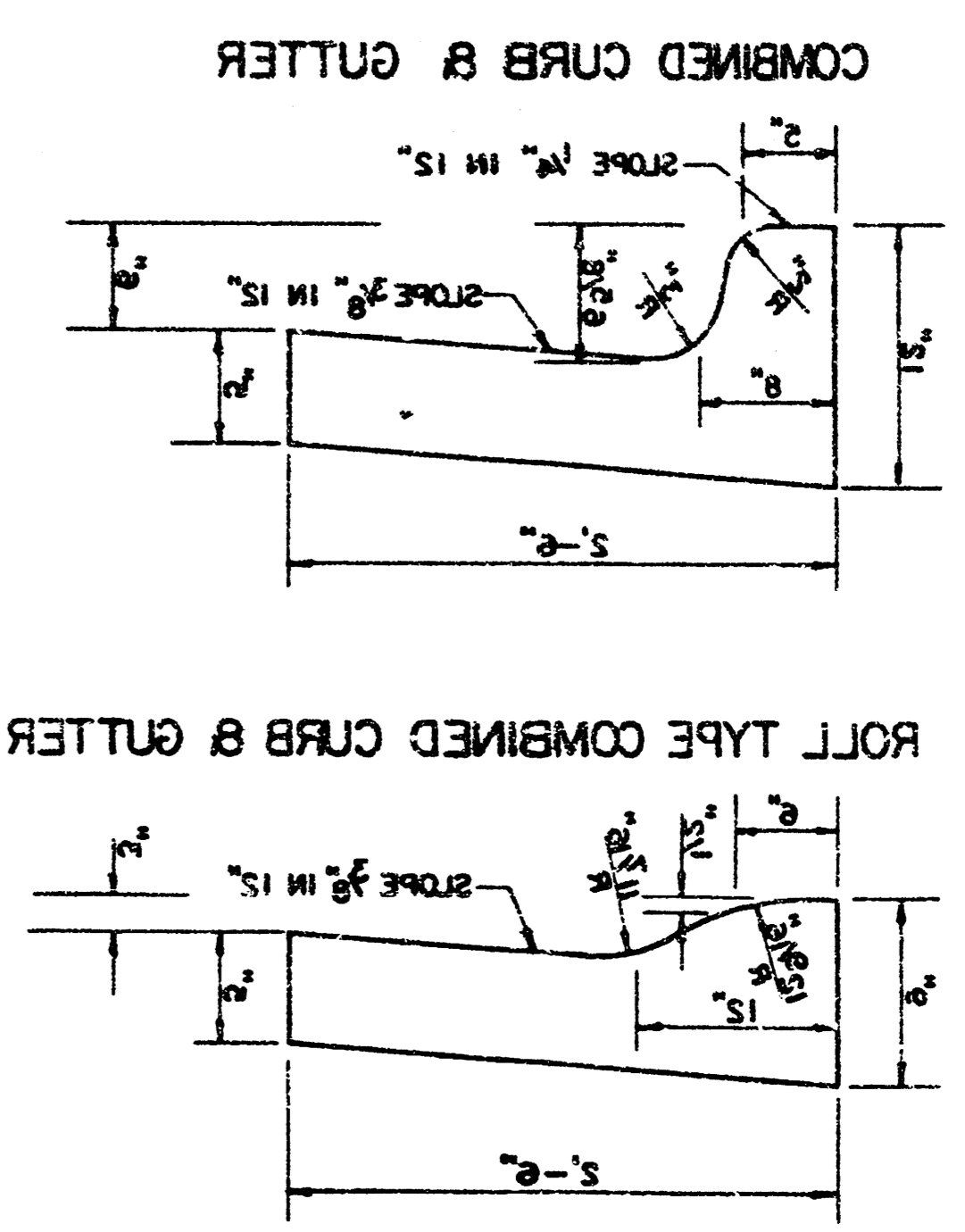

TRANSVERSE CONSTRUCTION JOINTS SHALL BE CONSTRUCTED IN THE MIDDLE OF THE PAVEMENT WIDTH. THE JOINT SHALL BE PLACED IN THE MIDDLE OF THE PAVEMENT WIDTH. THE JOINT SHALL BE PLACED IN THE MIDDLE OF THE PAVEMENT WIDTH.

- ### GENERAL NOTES
- 1) THE ASPHALTIC CONCRETE PAVEMENT BETWEEN THE COMBINED CURB AND GUTTER SHALL BE PLACED AS SQUARE YARDS OR 2' ASPHALTIC CONCRETE (2" BITUMINOUS BASE).
  - 2) THE BITUMINOUS BASE UNDER AND BEHIND THE COMBINED CURB AND GUTTER SHALL BE PLACED AS SQUARE YARDS OR 2" BITUMINOUS BASE.
  - 3) A TACK COAT OF EMULSIFIED ASPHALT (20-14 OR 22-14) SHALL BE APPLIED AT AN APPROXIMATE RATE OF 0.02 GALLONS PER SQUARE YARD BETWEEN EACH LIFT OF ASPHALTIC MATERIAL.
  - 4) BITUMINOUS BASE AND ASPHALTIC CONCRETE WEARING SURFACE SHALL BE PLACED WITH A LAYDOWN MACHINE HAVING AUTOMATIC CONTROLS FOR THE AND GRADE.
  - 5) CONSTRUCTION JOINTS IN EACH LIFT SHALL BE STAGGERED A MINIMUM 10'-0" TAKE TO ONE (1) FOOT FROM JOINTS IN PRECEDING LIFTS AND PLACED SO THAT A JOINT WILL BE CONSTRUCTED ON THE CENTERLINE OF THE TOP LIFT.
  - 6) CONTRACTOR TO BID ONLY ONE SURFACE TREATMENT ALTERNATE WHEN ALTERNATE IS PROVIDED IN THE PROJECT AND CONTRACT. THE ALTERNATE CHOSEN BY THE SUCCESSFUL BIDDER SHALL BE USED IN CONSTRUCTING THIS PROJECT.

415-26-542-8032-000-000-001  
 PROJECT NUMBER  
**CITY OF WICHITA, KANSAS**  
 PAVEMENT WITH 2 INCH BITUMINOUS BASE  
 7 INCH RESIDENTIAL ASPHALTIC CONCRETE



B.M. 14281 CITY STD. 42' N. & 32.5' E. OF 1/4 SEC. COR IRON AT 17TH AND RIDGE - NEAR RIDGE RD & SUNCREST.  
 B.M. 15274 R. ROAD SPIKE ON WEST FACE P. POLE THAT IS 1st RR S. OF S.L. OF BITTERSWEET LANE ON THE E.L. OF WESTWOOD HEIGHTS 2ND ADDN.

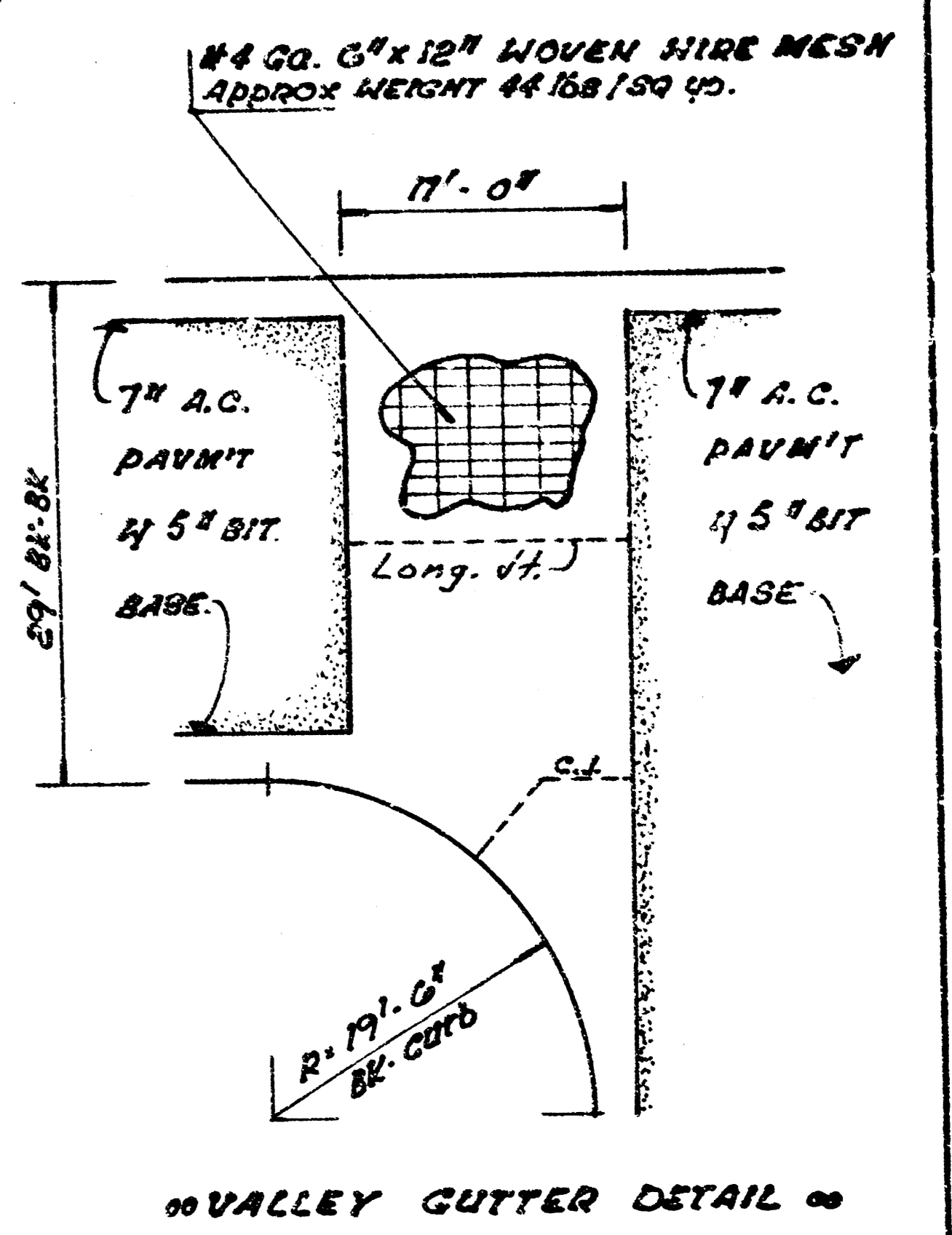
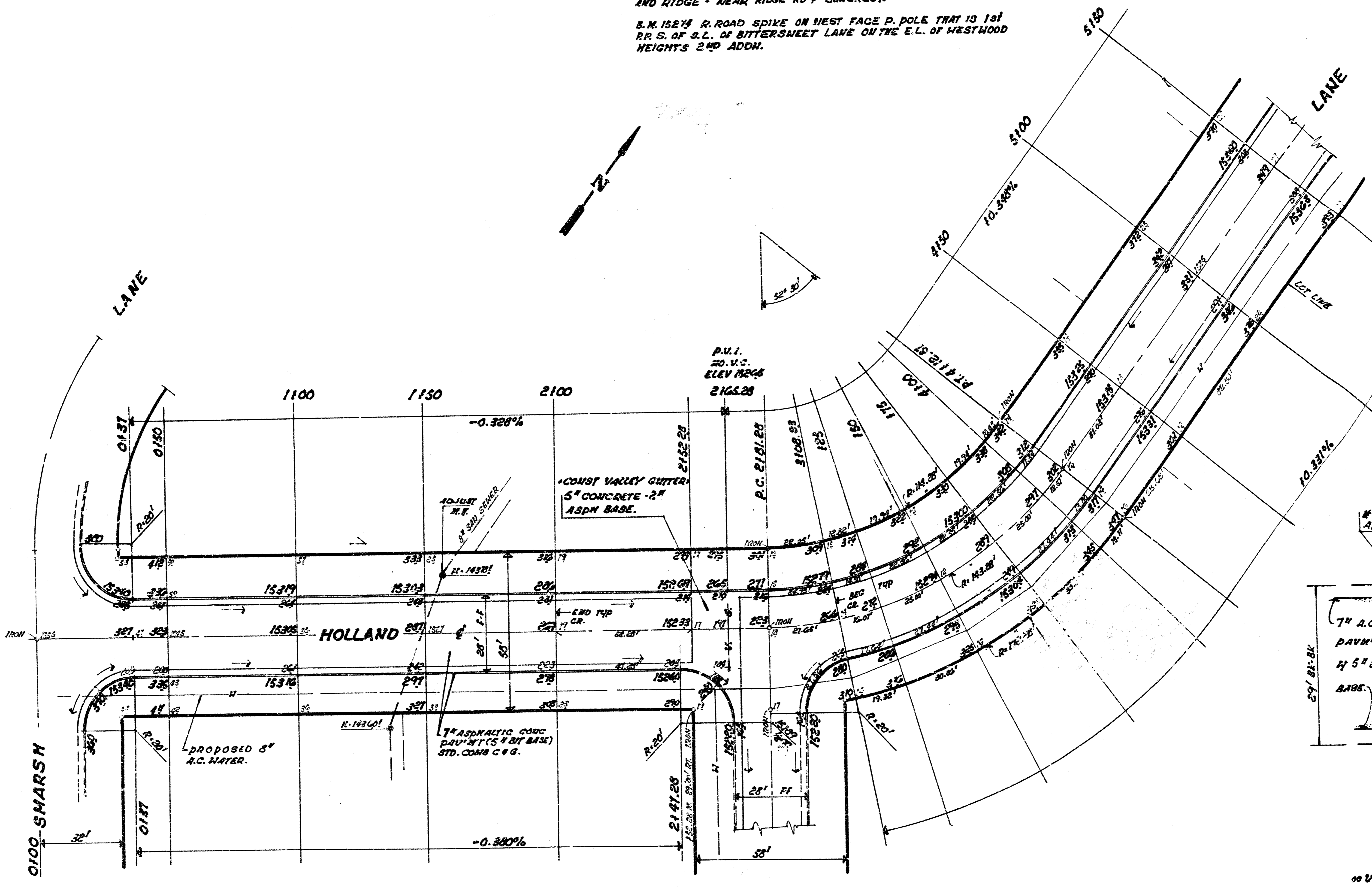

INTERSECTION QUANTITIES

125.5	S.Y.	Concrete Pavement
125.5	S.Y.	7\"/>

EXCAVATION  
 330.1 CU YDS  
 110% 33.6  
 371.9 CU YDS

COMP FILL  
 31.4 CU YDS  
 110% 3.1  
 34.5 CU YDS

NO MORE THAN 15'-20' DRIVES TO BE CONSTRUCTED.

2530 SQ YDS MANIPULATION.

CURVE DATA BASED ON RADIUS 143.28' Δ = 52° 30'

STATION	ARC	CHORD	LENGTH	DEFLECTION	TOTAL DEFLECTION
		6' OFF. M-CB	6' OFF. E-CB		
P.C. 2181.28					0° 00' 00"
3108.93	27.45'	23.37'	31.85'	3° 31' 42"	3° 31' 42"
125	16.07'	13.00'	18.53'	3° 12' 41"	6° 44' 23"
120	25.00'	21.13'	28.80'	4° 39' 55"	11° 24' 28"
175					16° 04' 19"
4100	25.00'	21.13'	28.80'	4° 39' 55"	20° 44' 14"
P.T. 4112.57	12.37'	10.24'	14.50'	2° 30' 46"	23° 15' 00"

PROJECT DESCRIPTION  
**HOLLAND LANE**  
 E.L. SMARSH LANE TO N.L. WESTWOOD HEIGHTS 2ND ADDITION.

PROJECT NUMBER  
 472-76-245-80799-000-000-001

BOOK NO. JPC #21  
 DRAWN BY

APPROVED BY  
 M.E. LINDESAK - CITY ENGINEER

DATE  
 REVISY

CITY OF WICHITA

SCALE  
 1" = 20'

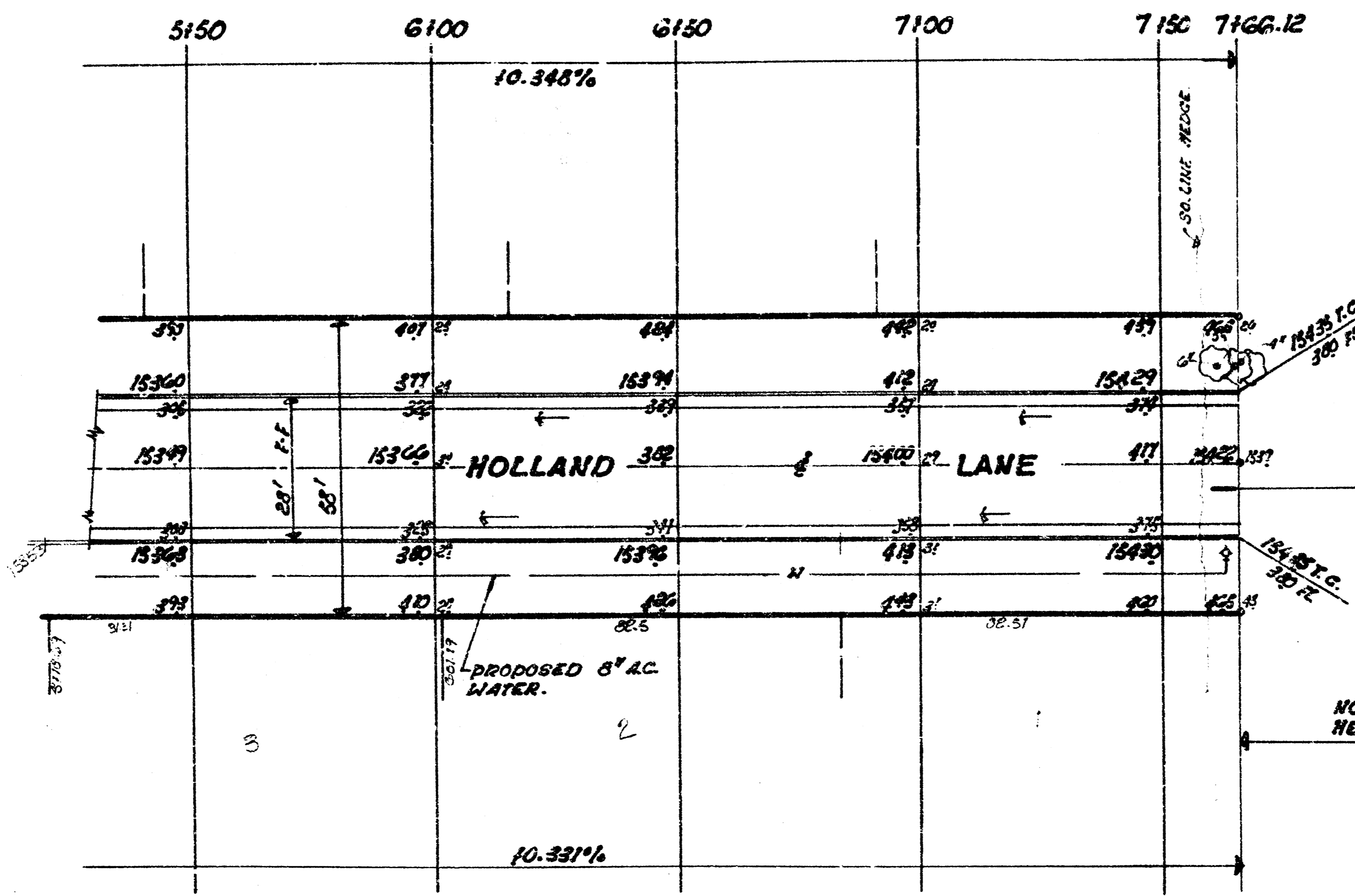

HEDGE ROW TO REMAIN - CONTRACTOR TO TRIM HEDGE TO FACILITATE CONSTRUCTION. HEDGE TRIMMING IS TO BE CONSIDERED SUBSIDIARY TO OTHER BID ITEMS.

NORTH LINE WESTWOOD HEIGHTS 2ND ADDITION.

PROJECT DESCRIPTION  
**HOLLAND LANE**  
 E.L. SMARSH LANE TO N.L. WESTWOOD HEIGHTS 2ND ADDITION  
 PROJECT NUMBER  
 413-76-245-60199-000-000-001

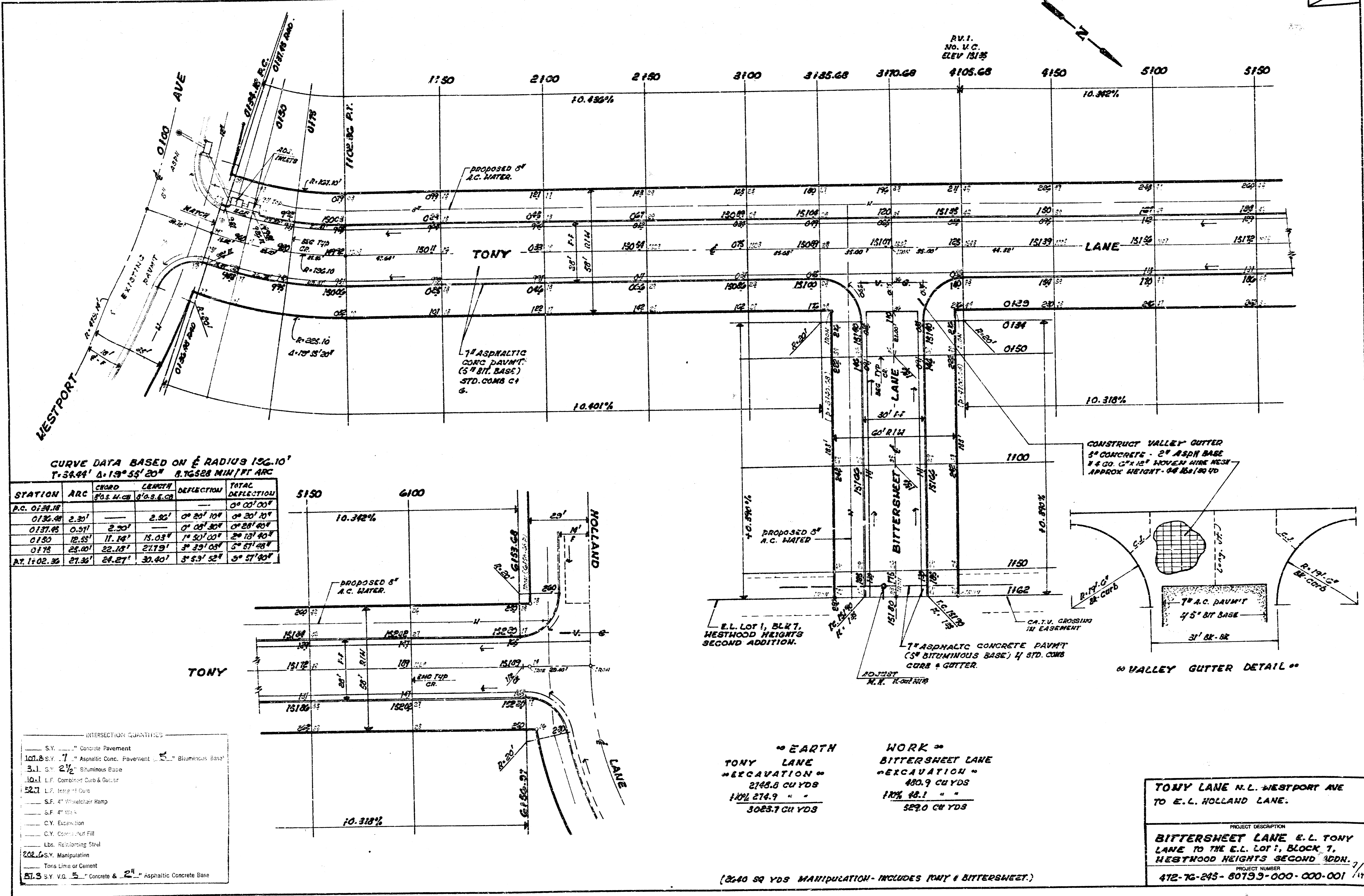

CURVE DATA BASED ON RADIUS 156.10'  
 T=38.44' Δ=19°55'20" S.TANGENT MIN/PT ARC

STATION	ARC	CHORD	LENGTH	DEFLECTION	TOTAL
P.C.		STATION	STATION	ANGLE	DEFLECTION
0134.18				0° 00' 00"	0° 00' 00"
0136.48	2.30'		2.32'	0° 20' 10"	0° 20' 10"
0137.45	0.97'	2.30'		0° 09' 20"	0° 28' 30"
0150	12.55'	11.14'	15.05'	1° 30' 00"	2° 18' 30"
0175	25.00'	22.15'	27.79'	3° 39' 05"	5° 57' 35"
P.T. 1+02.36	27.32'	24.27'	30.40'	3° 53' 52"	3° 57' 40"

- INTERSECTION QUANTITIES
- 101.8 S.Y. 7" Concrete Pavement
  - 101.8 S.Y. 7" Asphaltic Conc. Pavement
  - 3.1 S.Y. 2 1/2" Bituminous Base
  - 10.1 L.F. Combined Curb & Gutter
  - 52.1 L.F. Interlock Curb
  - S.F. 4" Wheelchair Ramp
  - S.F. 4" Walk
  - C.Y. Excavation
  - C.Y. Concrete Fill
  - Lbs. Reinforcing Steel
  - 202.6 S.Y. Manipulation
  - Tons Lime or Cement
  - 51.3 S.Y. V.G. 5" Concrete & 2 1/2" Asphaltic Concrete Base

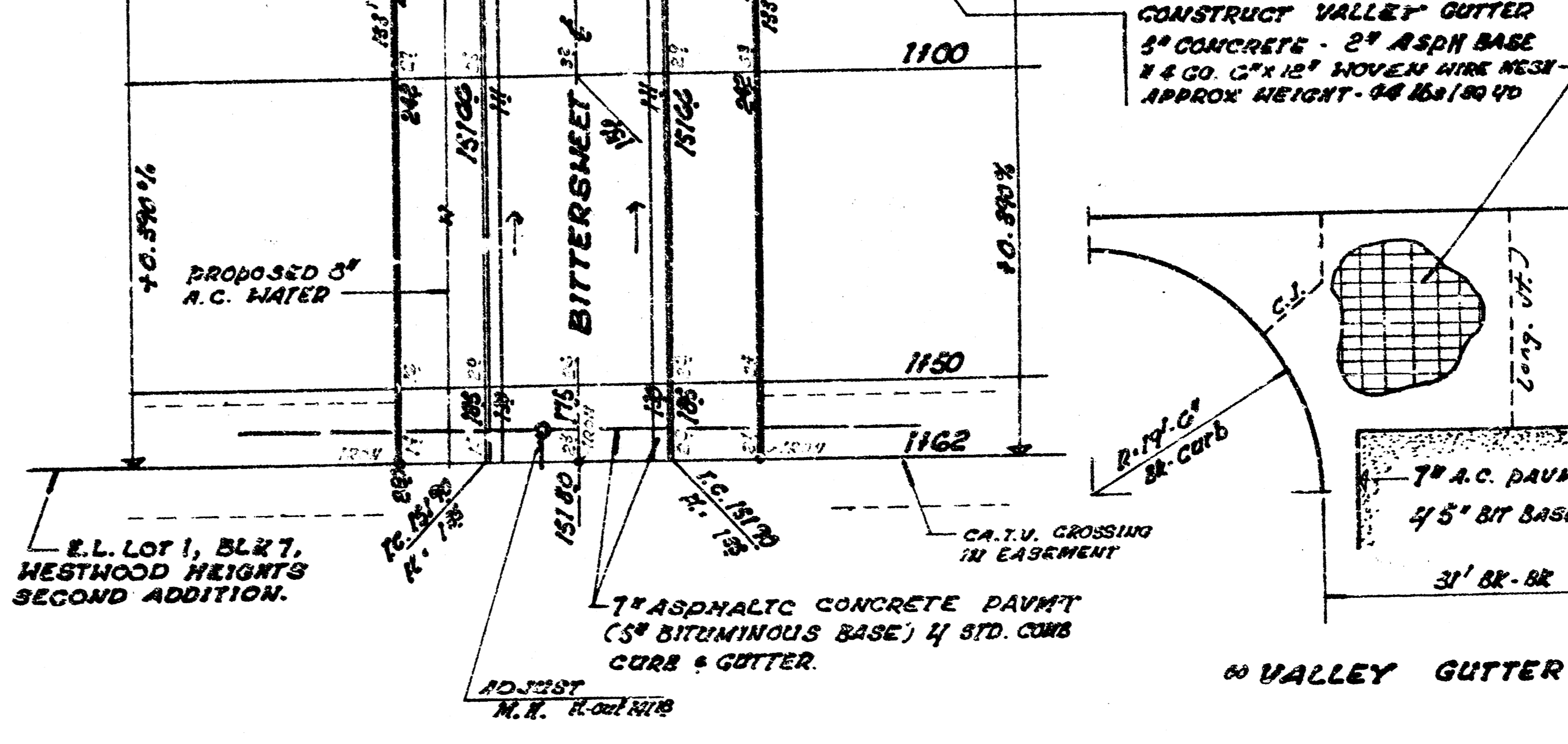

“EARTH WORK”  
 TONY LANE  
 EXCAVATION = 2745.8 CU YDS  
 10% 274.9 " "  
 3023.7 CU YDS

BITTERSHEET LANE  
 EXCAVATION = 480.9 CU YDS  
 10% 48.1 " "  
 529.0 CU YDS

TONY LANE N.L. WESTPORT AVE  
 TO E.L. HOLLAND LANE.

PROJECT DESCRIPTION  
 BITTERSHEET LANE E.L. TONY  
 LANE TO THE E.L. LOT 1, BLOCK 7,  
 WESTWOOD HEIGHTS SECOND ADDN.

PROJECT NUMBER  
 412-76-245-80799-000-000-001

(2640 SQ YDS MANIPULATION - INCLUDES TONY & BITTERSHEET.)

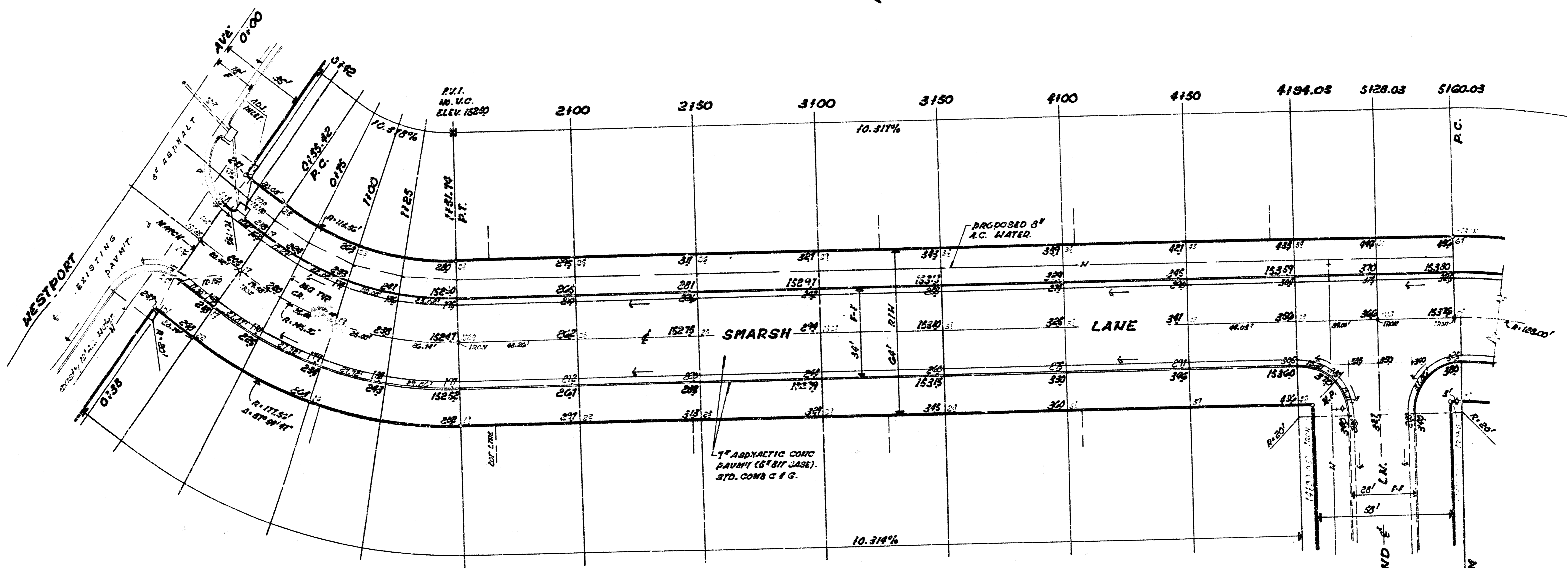
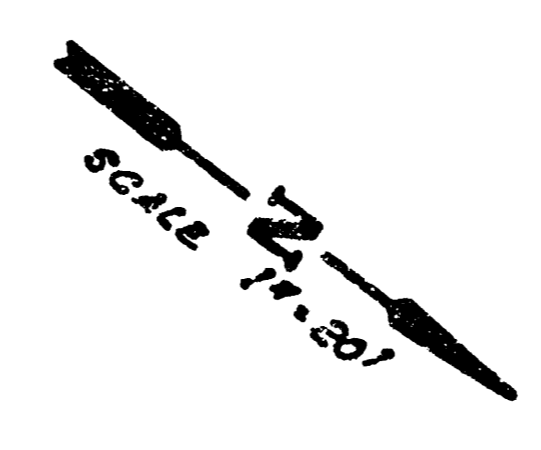

CURVE DATA BASED ON  $\frac{1}{2}$  RADIUS 143.92' -  $\Delta$  37°54'47"  
 TAN = 90.00' 11.80625 MIN/RT ARC. - ARC 36.32'

STATION	ARC	CORD		DEFLECTION	TOTAL DEFLECTION
		S'OS. N. CO	S'OS. E. CO		
PC 0135.42					0° 00' 00"
0175	19.58'	15.20'	22.32'	3° 51' 13"	3° 51' 13"
1100	25.00'	20.68'	29.26'	4° 55' 13"	8° 46' 26"
1125	25.00'	20.68'	29.26'	4° 55' 13"	13° 41' 39"
PT 1131.74	25.74'	22.11'	31.29'	5° 15' 45"	18° 57' 24"

INTERSECTION QUANTITIES

- 121.3 S.Y. Concrete Pavement
- 19.4 S.Y. Asphaltic Conc. Pavement (5" Bituminous Base)
- 43.6 S.Y. 2 1/2" Bituminous Base
- L.F. Concrete Curb & Gutter
- L.F. Manhole
- S.F. 4" Water Bar Ramp
- S.F. 4" Mark
- C.Y. Excavation
- C.Y. Compacted Fill
- Line. Retaining Wall
- 215.3 S.Y. Manipulation
- Tons Lime or Cement
- S.Y. M.C. Concrete & Asphaltic Concrete Sand

EXCAVATION  
 1978.1 CU YDS  
 110% 197.8 " "  
 2175.9 CU YDS

COMP FILL  
 1767.1 CU YDS  
 110% 176.8 " "  
 1944.5 CU YDS

4703 SQ YDS MANIPULATION

PROJECT DESCRIPTION  
**SMARSH LANE**  
 N.L. WESTPORT AVE TO N.L. WESTWOOD  
 HEIGHTS 2ND ADDITION.  
 PROJECT NUMBER  
 412-76-245-80199-000-000-001

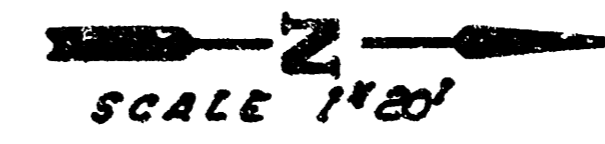

HEDGE ROW TO REMAIN. CONTRACTOR TO TRIM HEDGE TO FACILITATE CONSTRUCTION. HEDGE TRIMMING IS TO BE CONSIDERED SUBSIDIARY TO OTHER BID ITEMS.

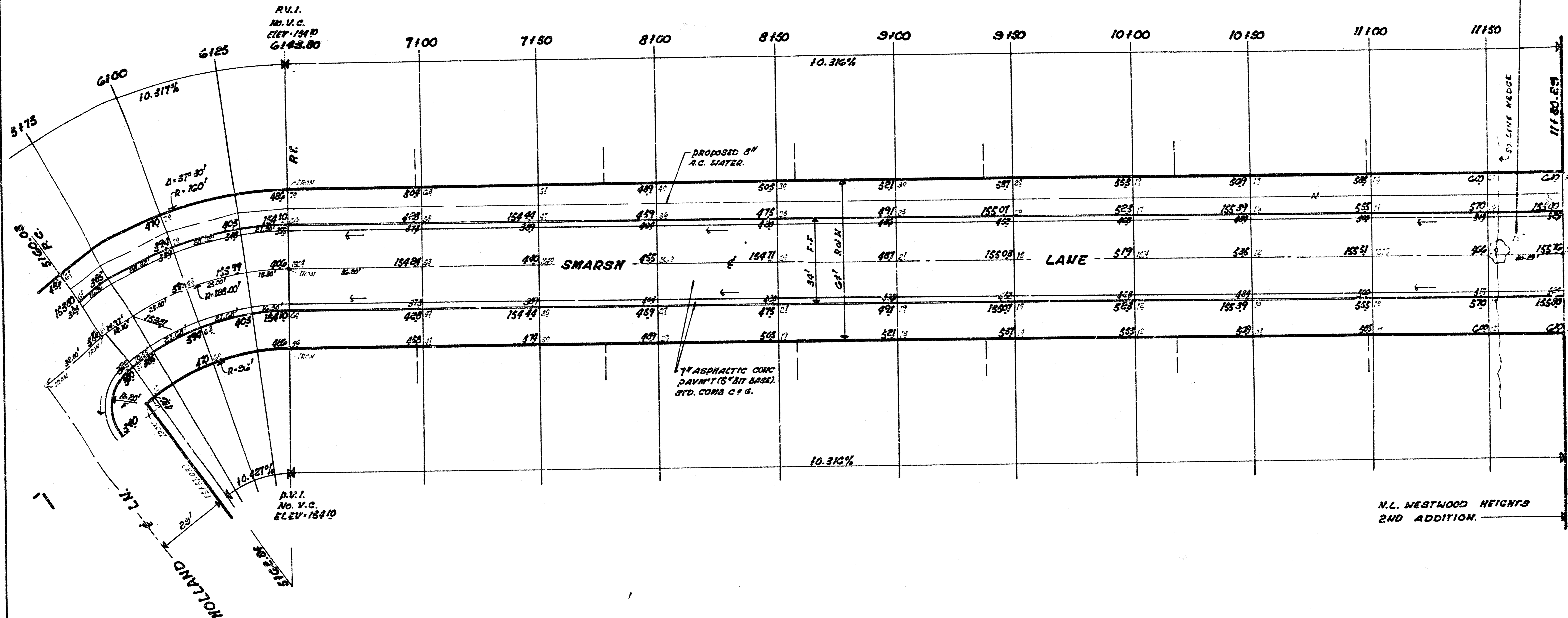

CURVE DATA BASED ON RADIUS 128.00' Δ=37°30'

STATION	ARC	CHORD		DEFLECTION	TOTAL DEFLECTION
		S.O.C.	E.O.C.		
P.C. 5120.03					0° 00' 00"
5122.84	2.81'		2.20'	0° 31' 44"	0° 31' 44"
5175	12.15'	17.00'	3.78'	2° 43' 16"	3° 21' 02"
6100	28.00'	29.54'	20.09'	5° 35' 25"	0° 50' 45"
6125	25.00'	23.83'	20.09'	5° 35' 25"	18° 30' 23"
P.T. 6143.80	18.80'	22.48'	15.11'	4° 12' 32"	18° 45' 00"

PROJECT DESCRIPTION  
**SMARSH LANE**  
 N.L. WESTPORT AVE TO N.L. WESTWOOD HEIGHTS 2ND ADDITION  
 PROJECT NUMBER  
 412-76-245-80199-000-000-001

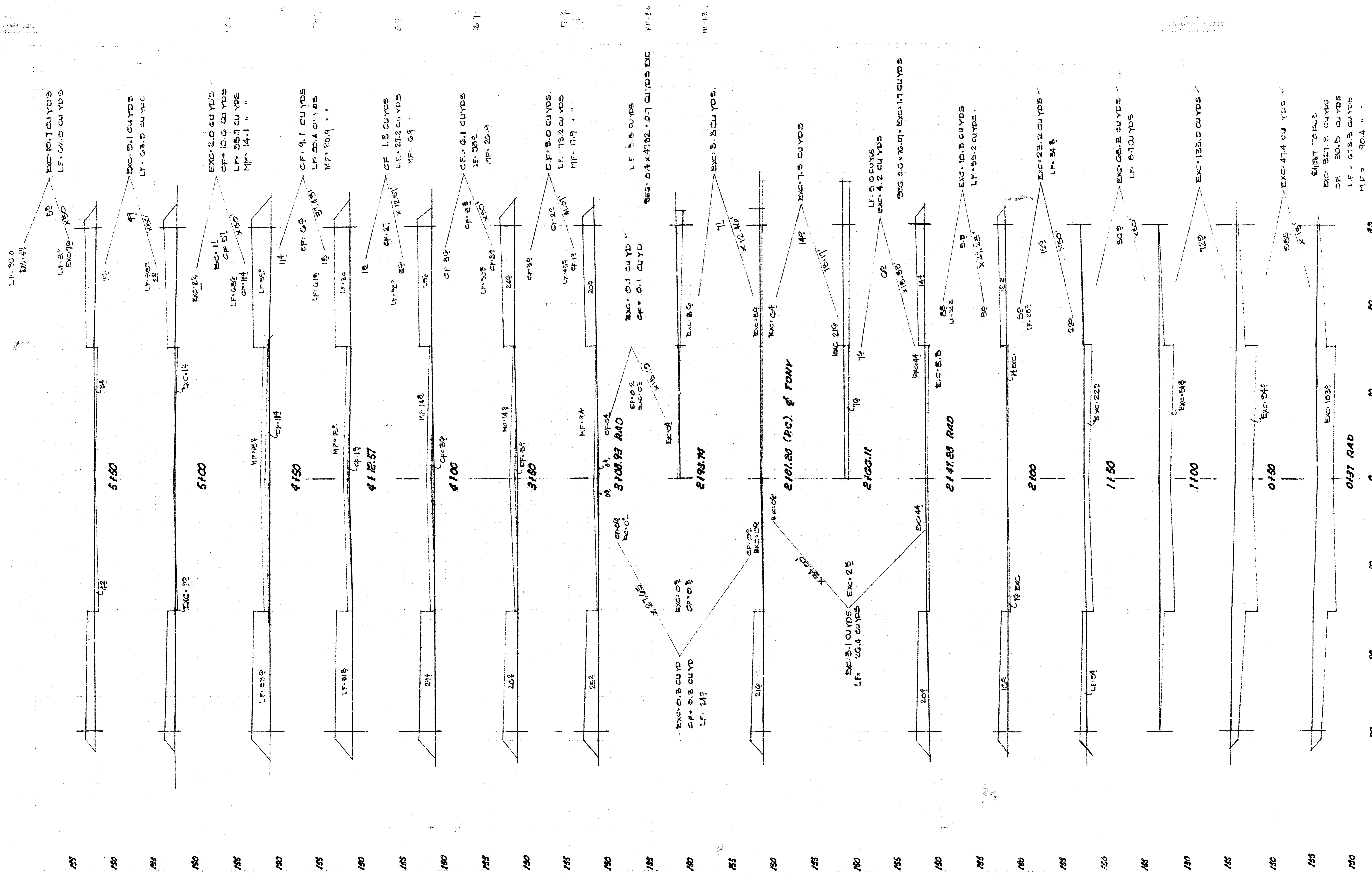

HOLLAND LANE  
 E.L. SMARSH LN TO N.E. WESTHOOD RD'S  
 SECOND ADDITION.  
 PROJ. NO. 878-76-EHS-00189-000-000-001

TOTALS  
 EXC. 388.1 CU YDS  
 CF. 314.4  
 LF. 306.2 CU YDS  
 M.P. 14.1-14.20

SHEET TOTALS  
 EXC. 321.3 CU YDS  
 CF. 30.5 CU YDS  
 LF. 678.3 CU YDS  
 M.P. 14.1-14.20

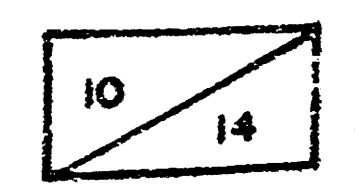





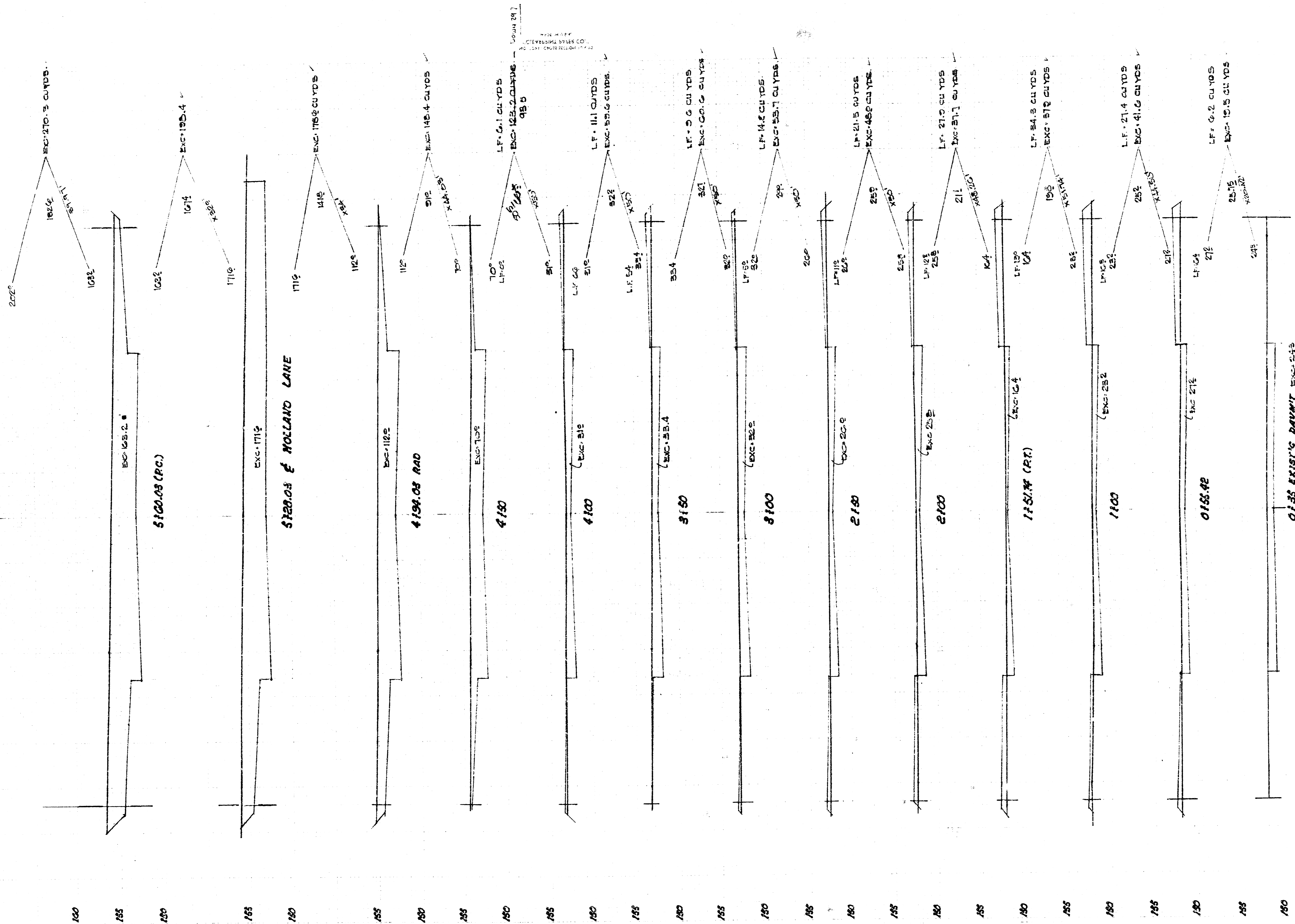

Station	Excavation (CU YDS)	Loose Fill (CU YDS)	Total (CU YDS)
160	210.3	15.5	225.8
165	185.4	0	185.4
170	176.6	0	176.6
175	148.4	0	148.4
180	112.2	0	112.2
185	109.08	0	109.08
190	51.9	0	51.9
195	53.4	0	53.4
200	52.5	0	52.5
205	50.8	0	50.8
210	21.5	0	21.5
215	48.8	0	48.8
220	21.5	0	21.5
225	21.7	0	21.7
230	24.3	0	24.3
235	21.4	0	21.4
240	41.6	0	41.6
245	15.5	0	15.5
250	15.5	0	15.5

SMARSH LANE  
 N.L. WESTPORT TO N.L. WESTWOOD HGT'S  
 SECOND ADDITION.  
 PROJ. NO. 812-73-245 80155-000-001

TOTALS:  
 LOOSE FILL 158.9 CU YDS  
 EXC 1515.1  
 CF 1774.0

