

B.M. 158 B.B. SPIKE W.S. BELL TEL. POLE 100' N N.E. EASTRIDGE & ...

STATIONING ON E.P.

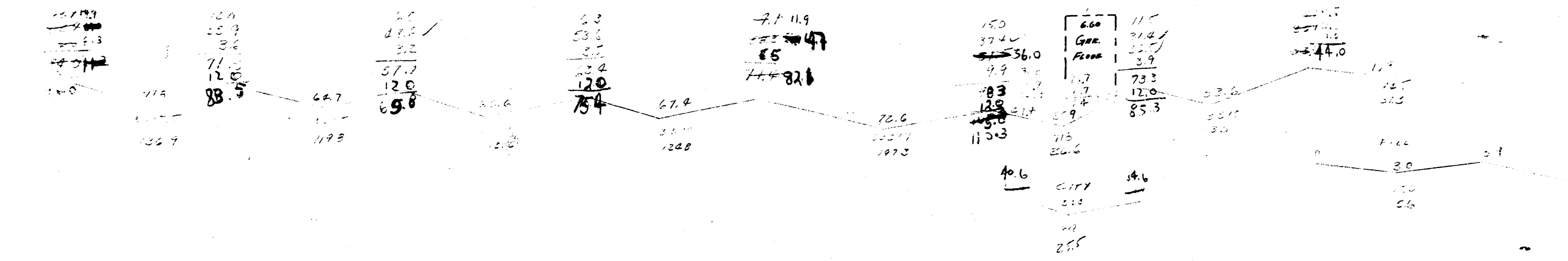
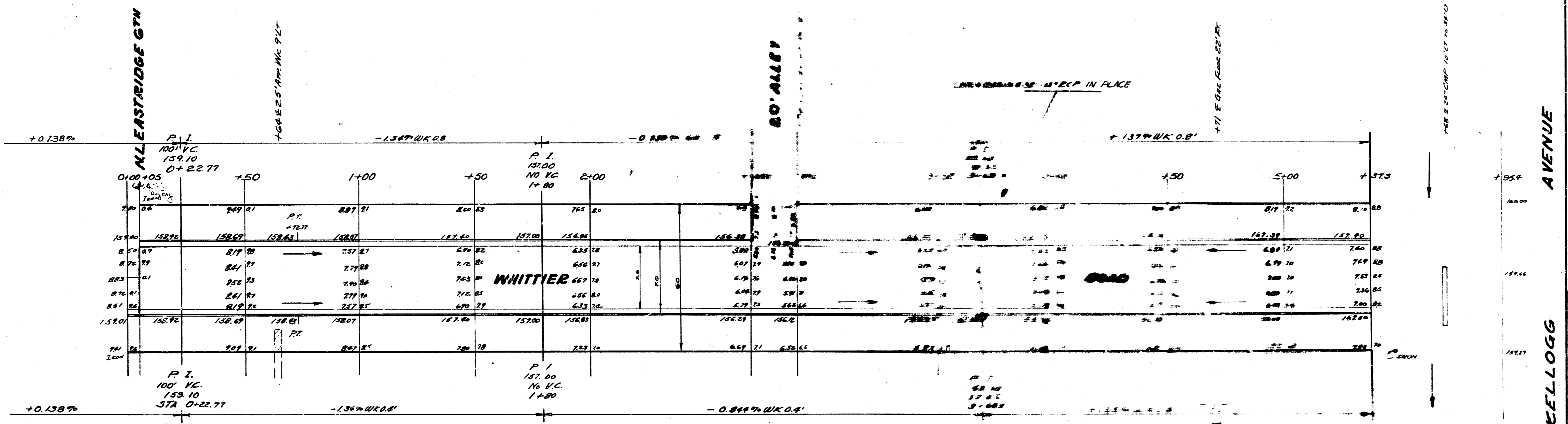

WHITTIER
 S.E. CORNER TO AL. EASTRIDGE & ...
 20-2-33 P.C.
 CITY OF WICHITA
 L.E. WHITE CITY ENGINEER
 1933