

B.M. 162.12 N.Y. Car top conc. step House # 802 Bluff  
 I.P.M. 157.00 Top North end R.C.P. entrance culvert House # 836 Bluff

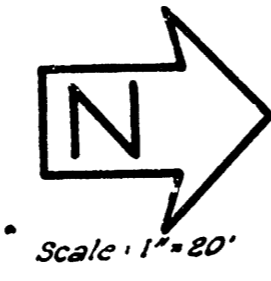

Scale 1" = 20'

Checked by: [Signature]  
 Date: 10/25/60  
 City Engineer

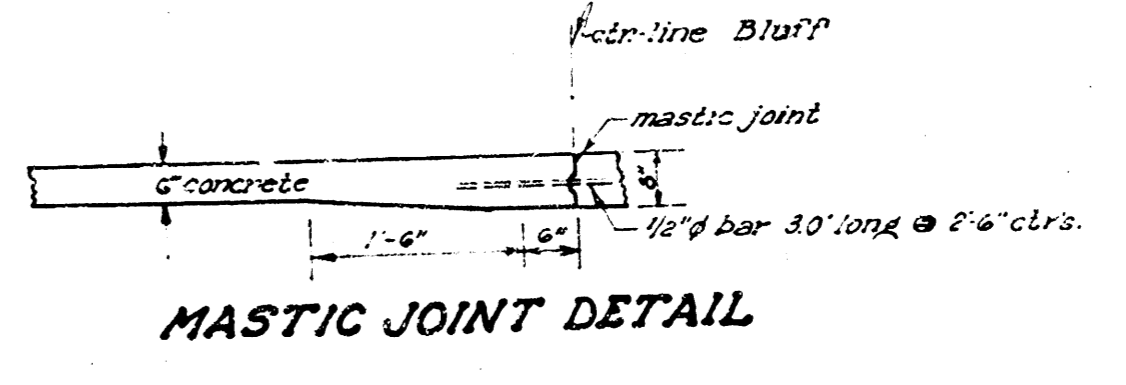
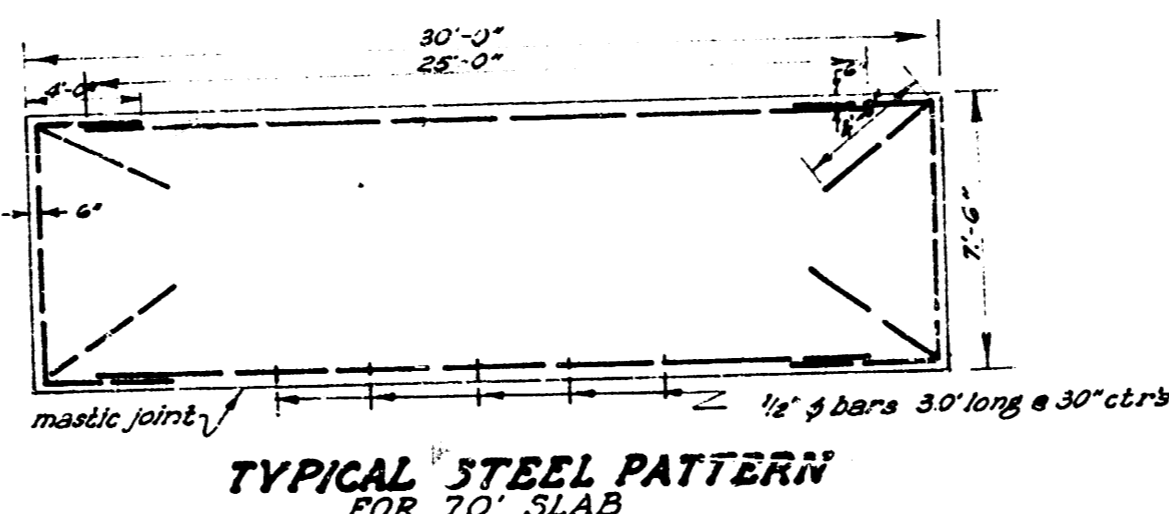
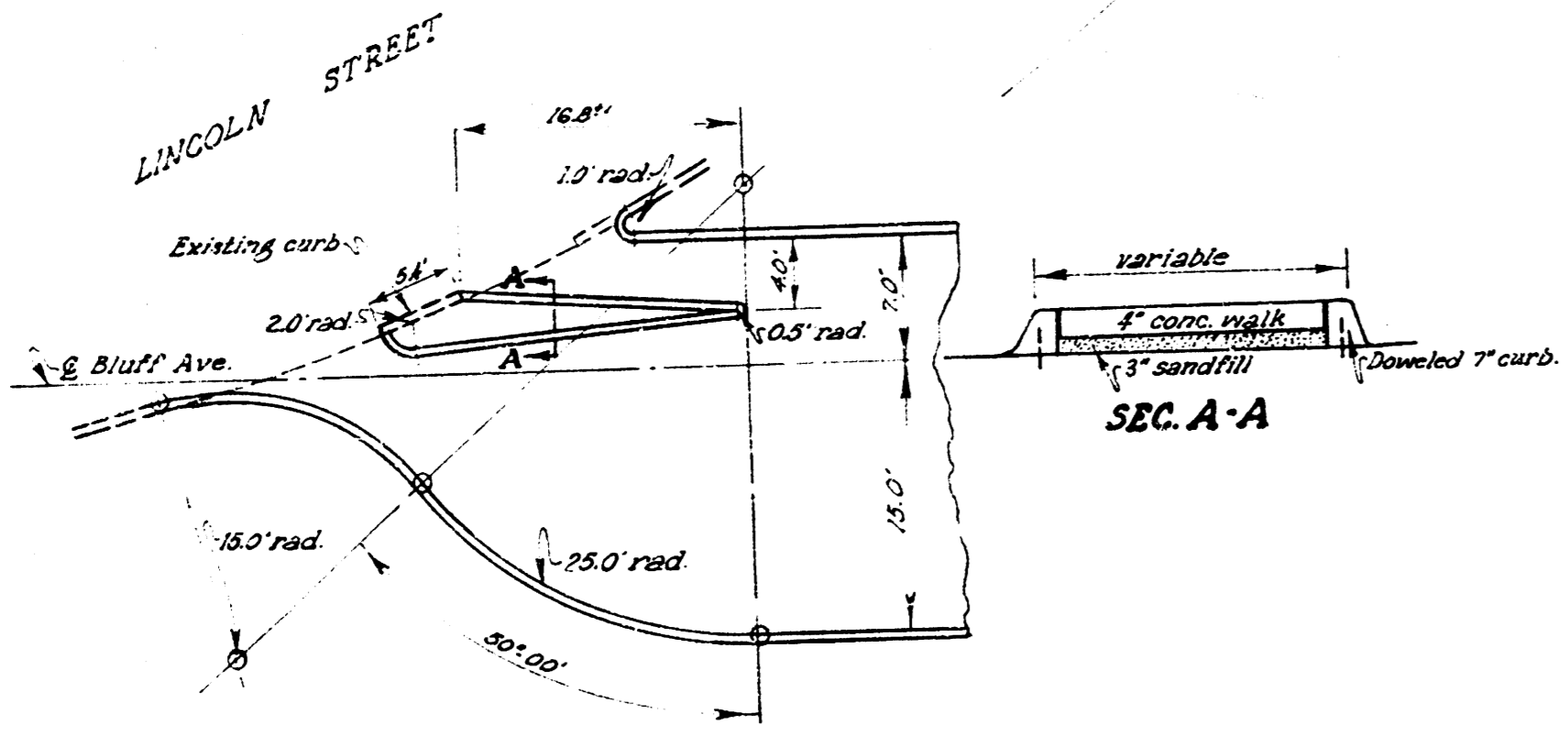
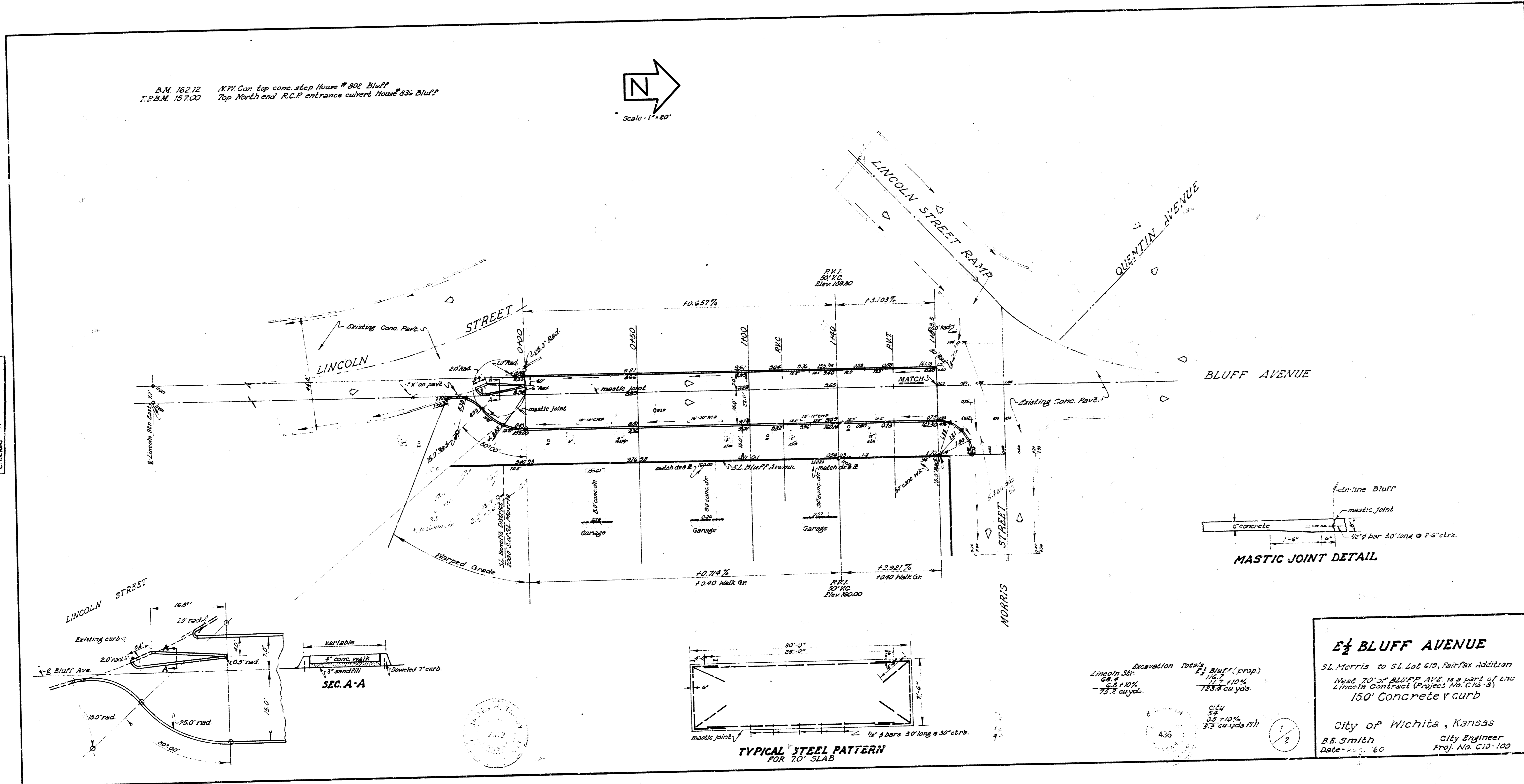

Excavation Total  
 Lincoln St. 175.0 cu yds.  
 8.8% 1.0%  
 75.2 cu yds.

City 436  
 35.10%  
 8.3 cu yds. nil

**E 1/2 BLUFF AVENUE**

SL. Morris to SL Lot 610, Fairfax Addition  
 West 20' of BLUFF AVE. is a part of the  
 Lincoln contract (Project No. C15-2)  
 150' Concrete curb

City of Wichita, Kansas  
 B.S. Smith City Engineer  
 Date: 10/25/60 Proj. No. C15-100