

B.M. 11036⁺ cut on N.E. Cor. Conc. Base to Mobil Sign on S.W. Cor. Broadway & Lewis.

Sta. 0+75.5 Re-Const Existing Inlets.

Scale: 1" = 20'

B.M. 11210⁺ N.W. Cor. Top Stone Slab on Wall Around Wichita Federal Savings Sign on N.E. Co. Broadway & Waterman.

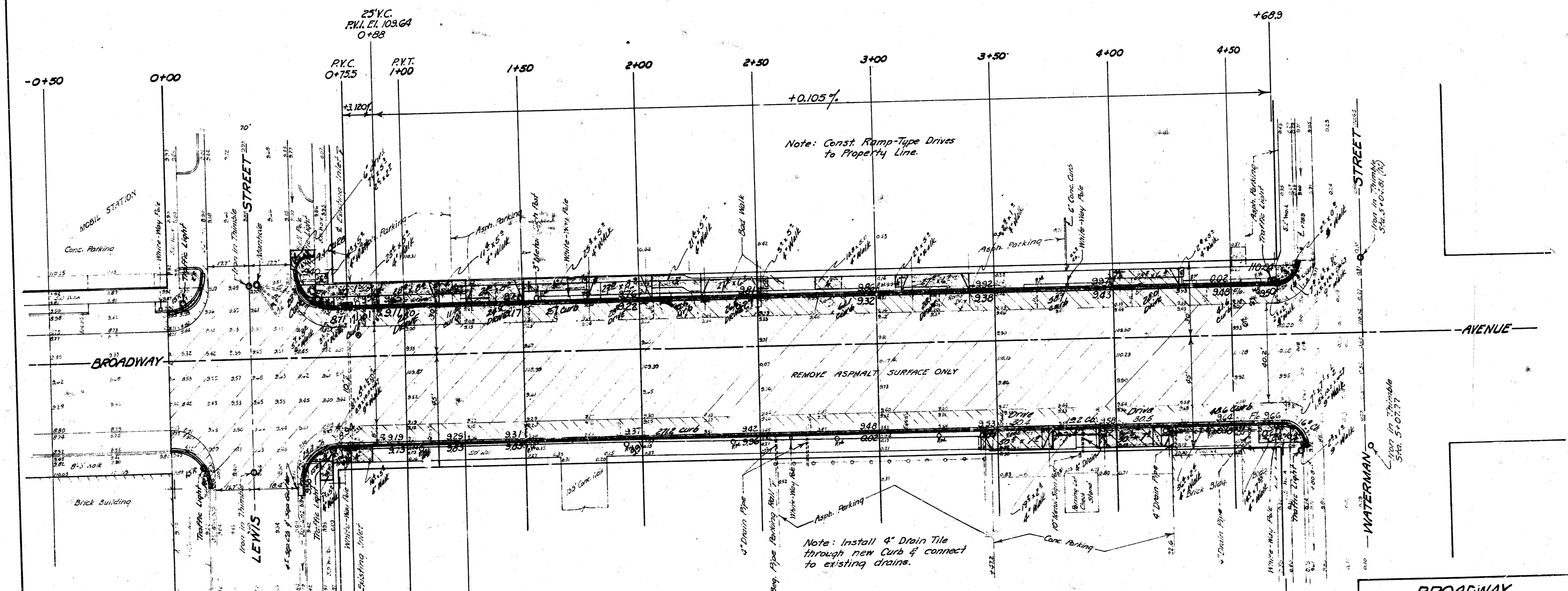

Sheet 59 of 59

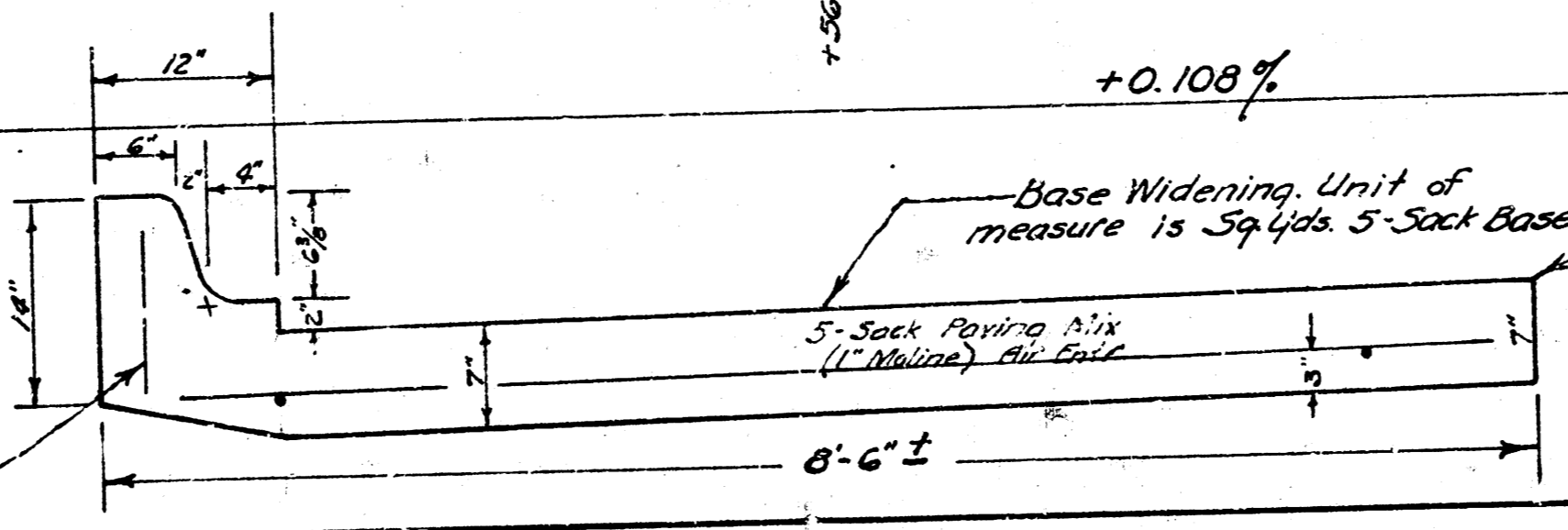
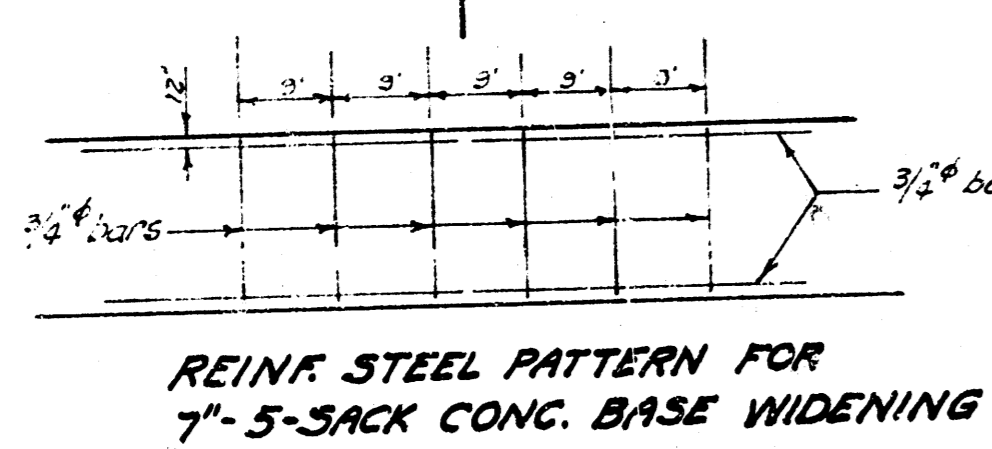

Elevation to be established by field Engineer. Use 2"x2" form at edge of existing base.

INTEGRAL CURB & GUTTER AND BASE WIDENING DETAIL

BROADWAY
 S.L. LEWIS To S.L. WATERMAN
 INTEGRAL CURB & GUTTER & BASE WIDENING.
 A.C. IMPROVE & REIMPROVE.
 CITY OF WICHITA, KANS.
 B.E. SMITH CITY ENGINEER
 OCT. 1960, Project No. C10-77

