

INTERSECTION RECONSTRUCTION

3RD & GORDON

14TH & CHAUTAUQUA

ENGLISH & ESTELLE

SEDGWICK & BURTON

PROJ. NO. 472 76 245 81234 000 000 001

CITY OF WICHITA, KANSAS

M. E. LINDEBAK - CITY ENGINEER

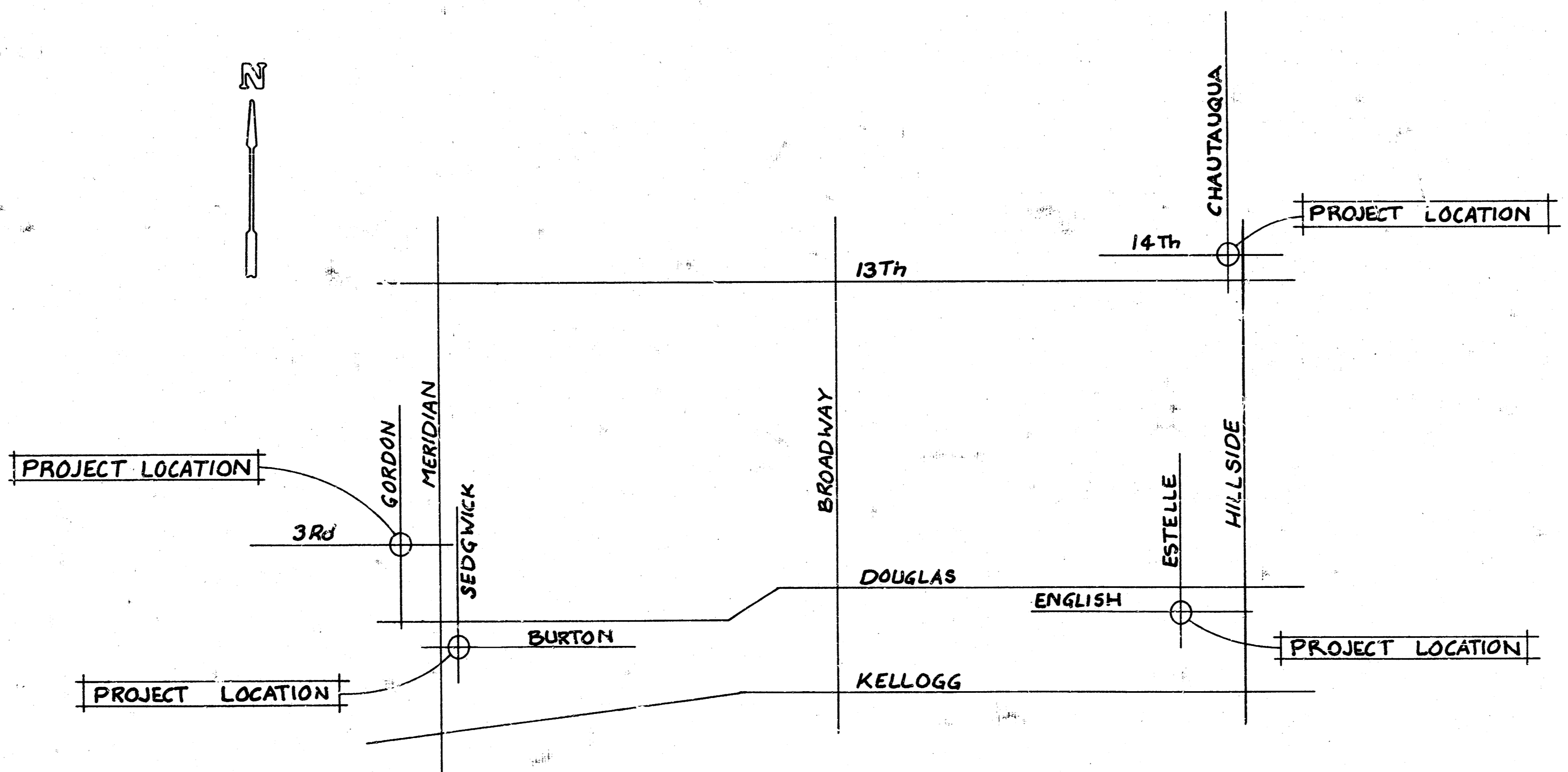

REVISED SEPT 24, 1984

PROJECT DESCRIPTION		
PROJECT NUMBER:		
BOOK NO. 000-#	APPROVED BY	DATE
DRAWN BY K.K.	REVISION	
CITY OF WICHITA		
SCALE		1" = 10'

MADE FROM THE BEST

B.M. = 118.75 S.W. CORNER BOTTOM CONC. STEP
HOUSE No. 2124 WEST 3RD STREET.

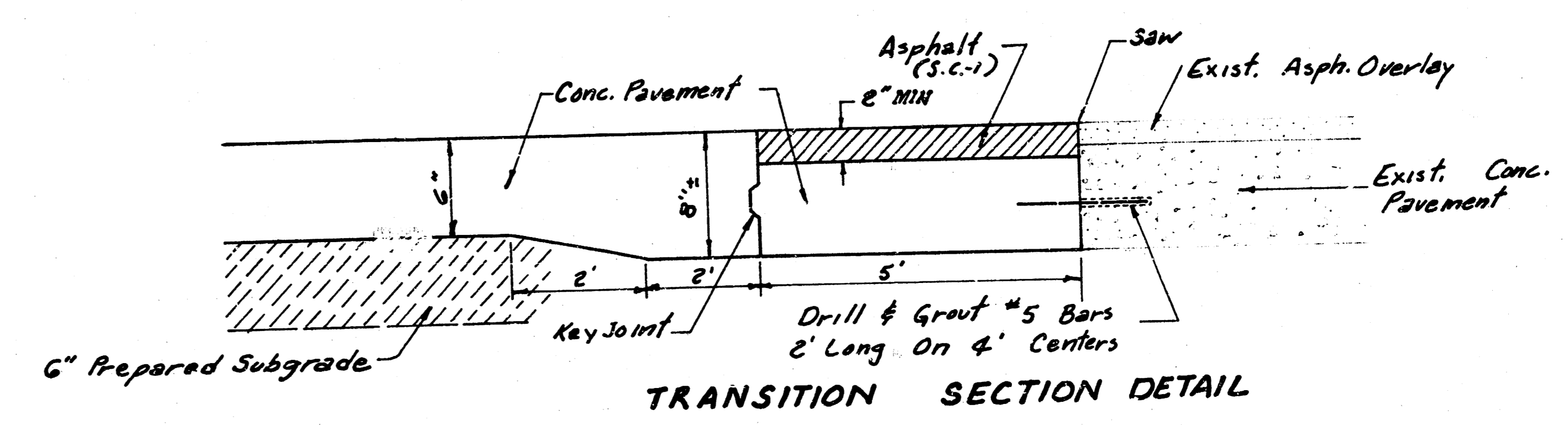
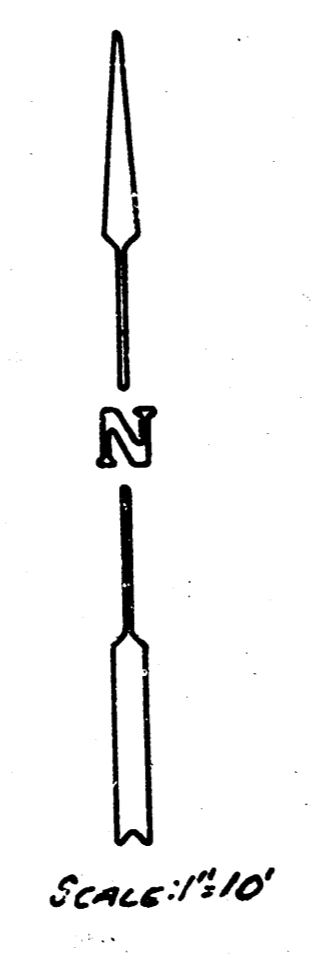

Surveying
Plan Key
Bk.
Checking

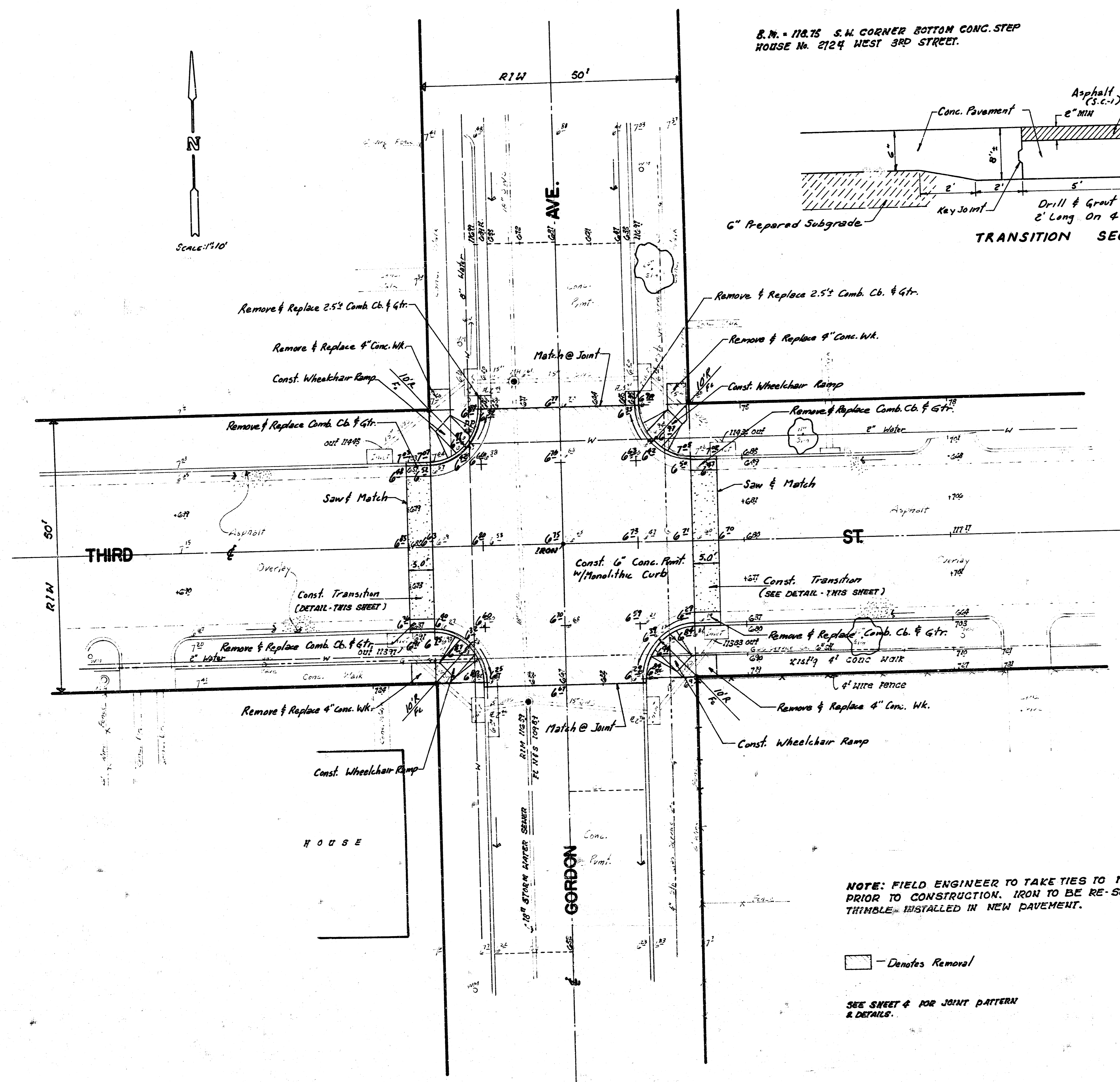

NOTE: FIELD ENGINEER TO TAKE TIES TO IRON & E.
PRIOR TO CONSTRUCTION. IRON TO BE RE-SET AND
THIMBLE INSTALLED IN NEW PAVEMENT.

Denotes Removal

SEE SHEET # FOR JOINT PATTERN
& DETAILS.

SUB-GRADE
TYPE OF SUB-GRADE TREATMENT SHALL BE DE-
TERMINED BY THE FIELD ENGINEER. SUB-GRADE
TREATMENT MAY CONSIST OF LIME TREATMENT,
CEMENT TREATMENT, SUB-GRADE MODIFI-
TION, OR ANY COMBINATION OF THESE.

PROJECT DESCRIPTION
**RECONSTRUCTION OF THIRD
& GORDON INTERSECTION**
PROJECT NUMBER
472 76 245 81234 000 000 001 2/1

FILMED FROM THE BEST

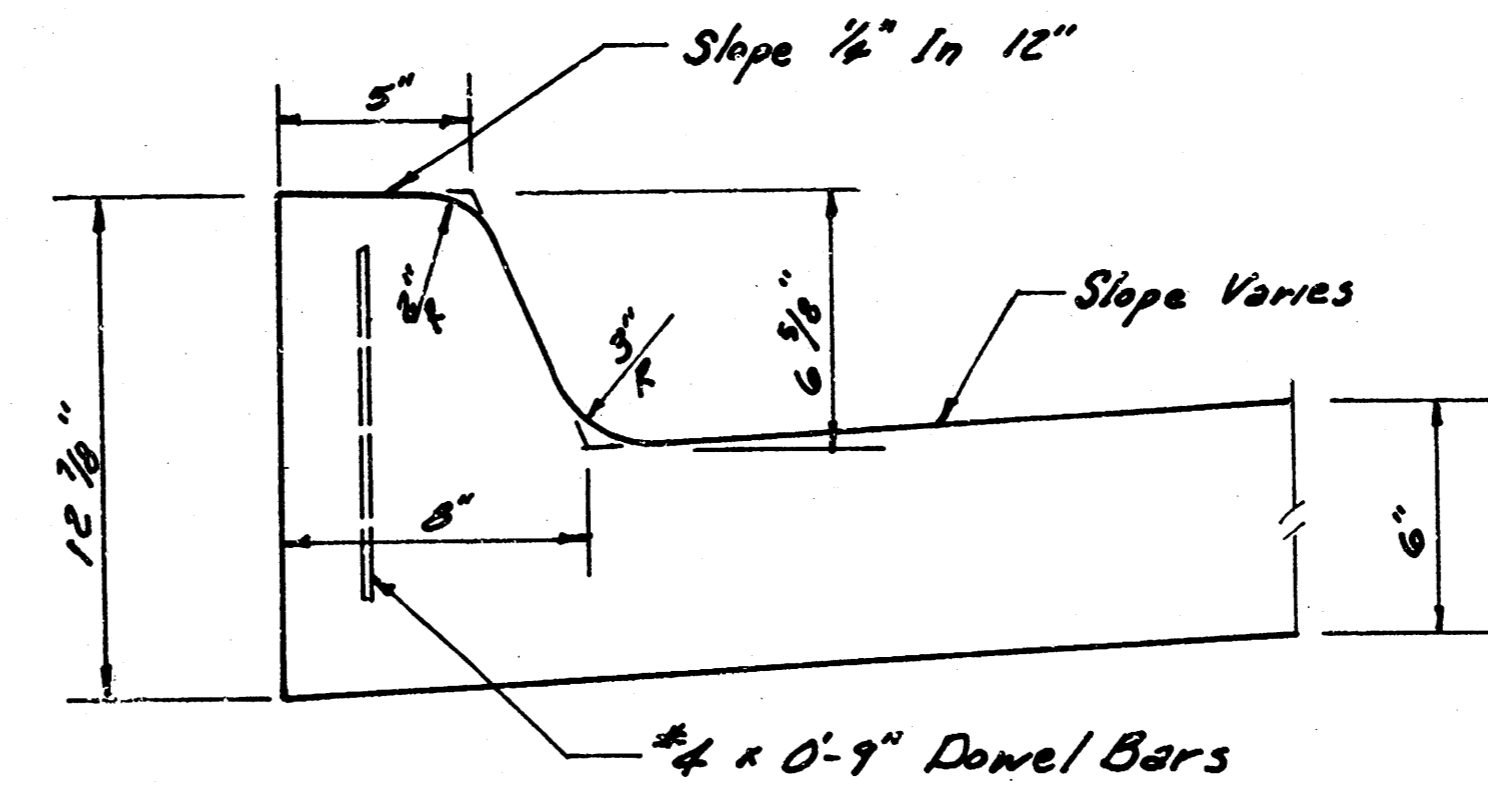
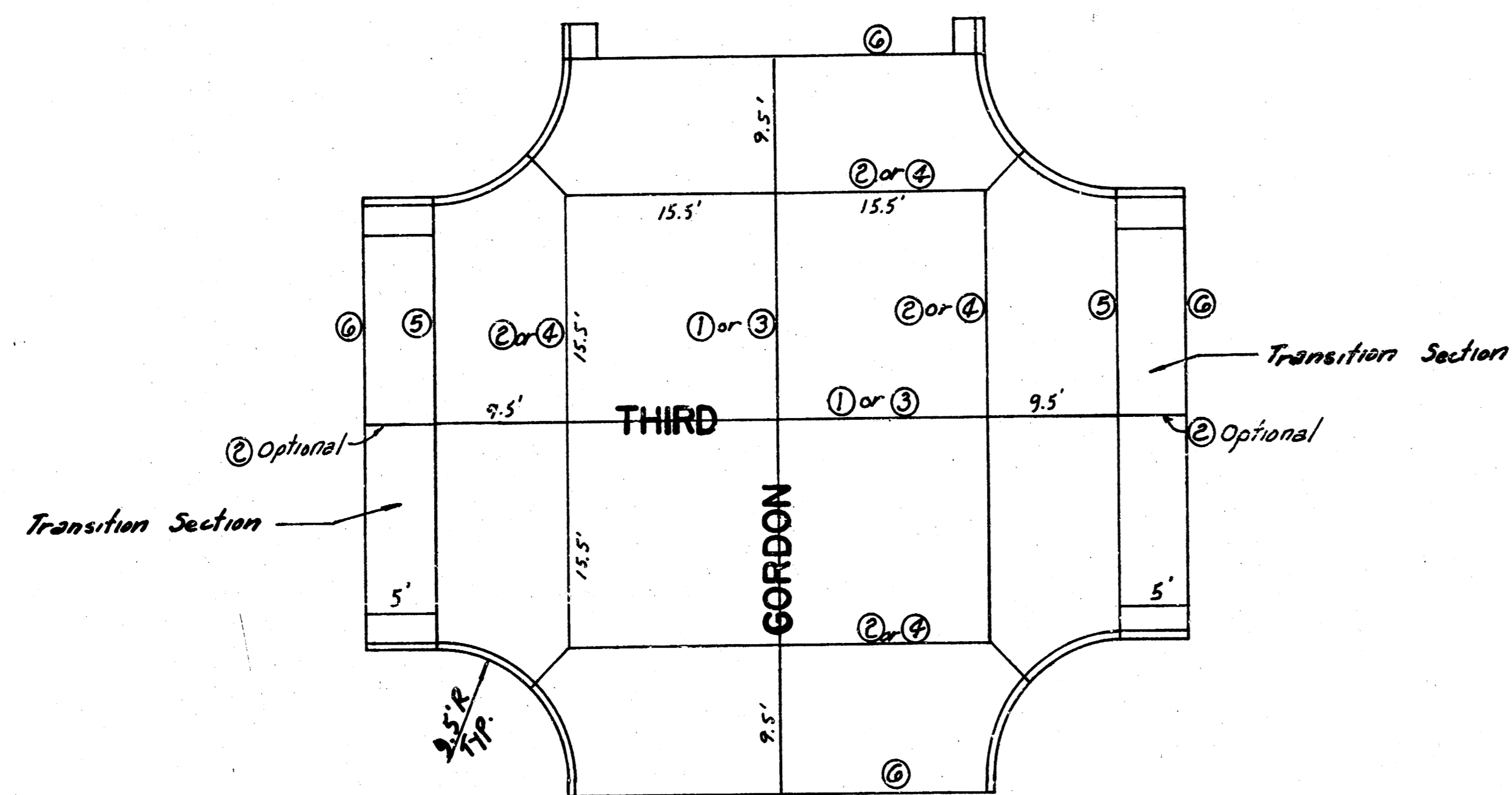

MONOLITHIC CURB

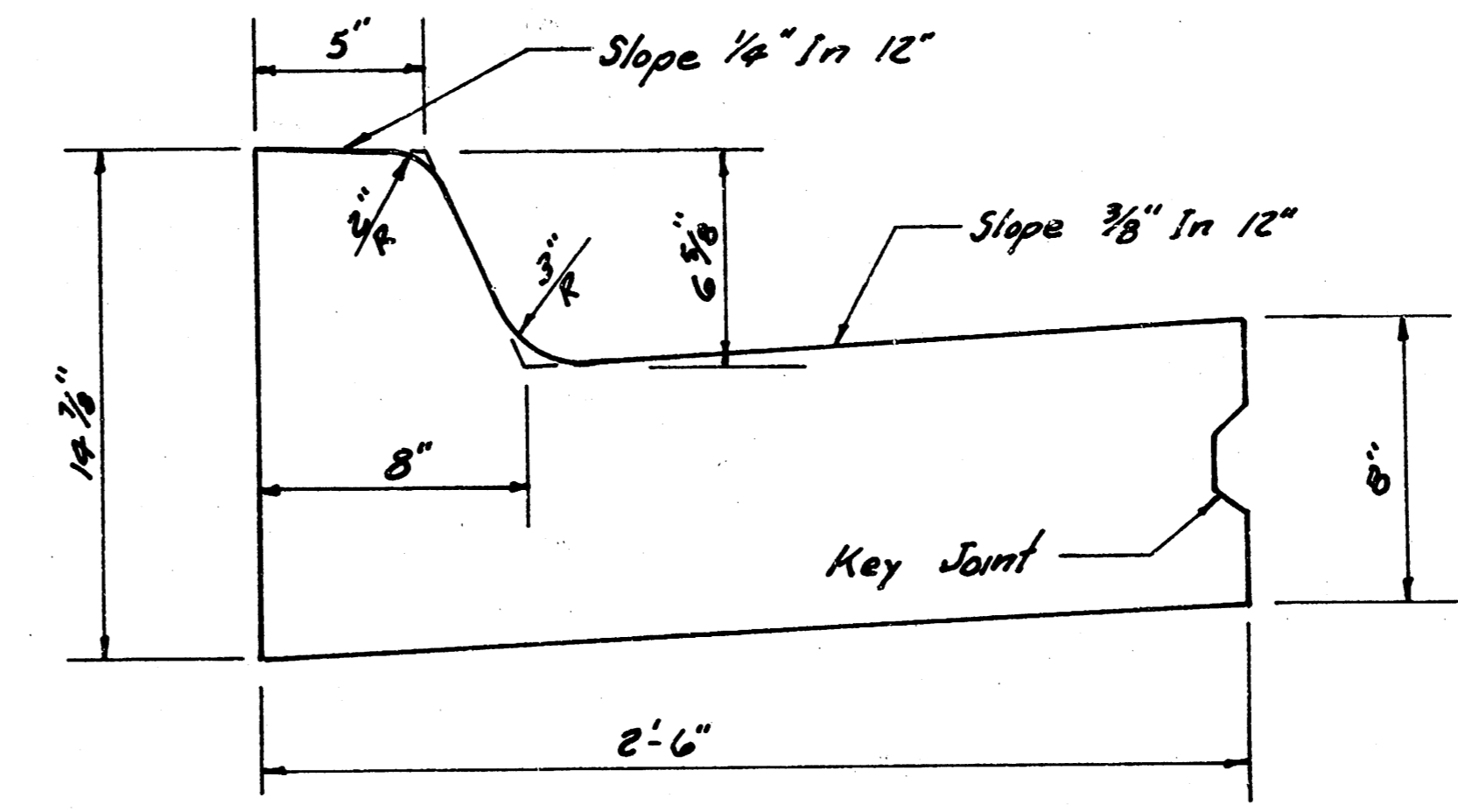

COMBINED CURB & GUTTER

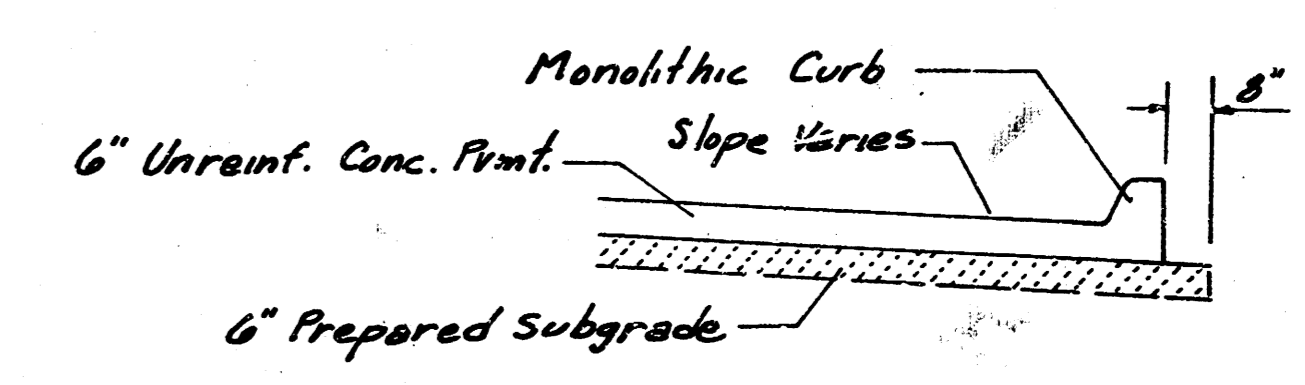

TYPICAL SECTION

- ① - Construction Joint With Steel
- ② - Construction Joint Without Steel
- ③ - Sawed Longitudinal Joint With Steel
- ④ - Sawed Longitudinal Joint Without Steel
- ⑤ - Keyed Joint (At Transition Section)
- ⑥ - Drilled & Grouted Joint

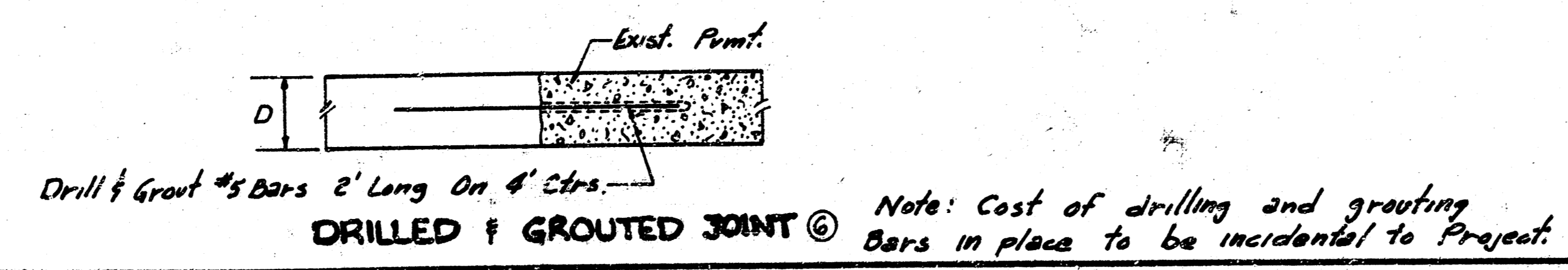
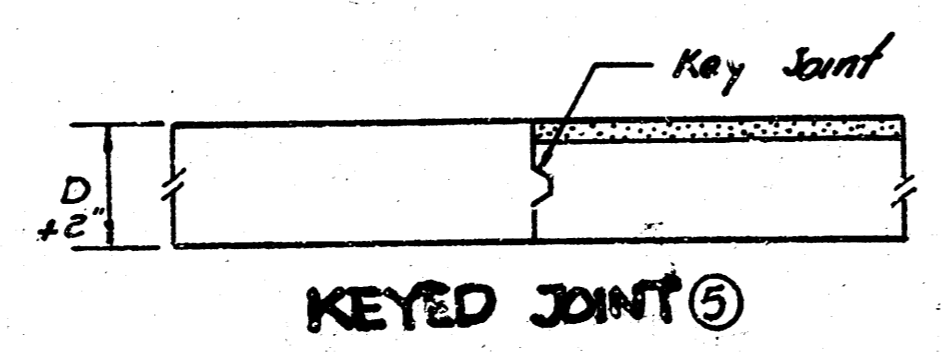
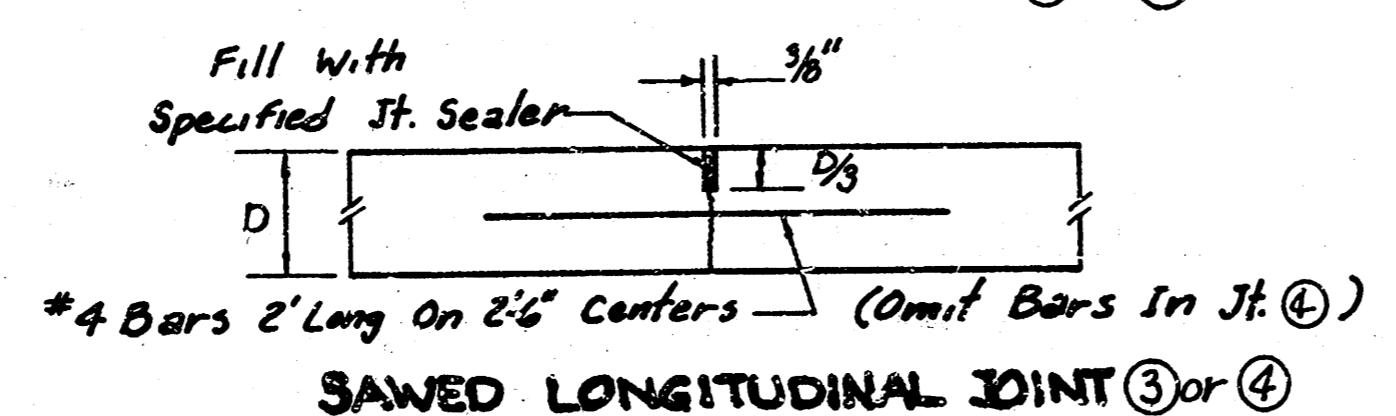
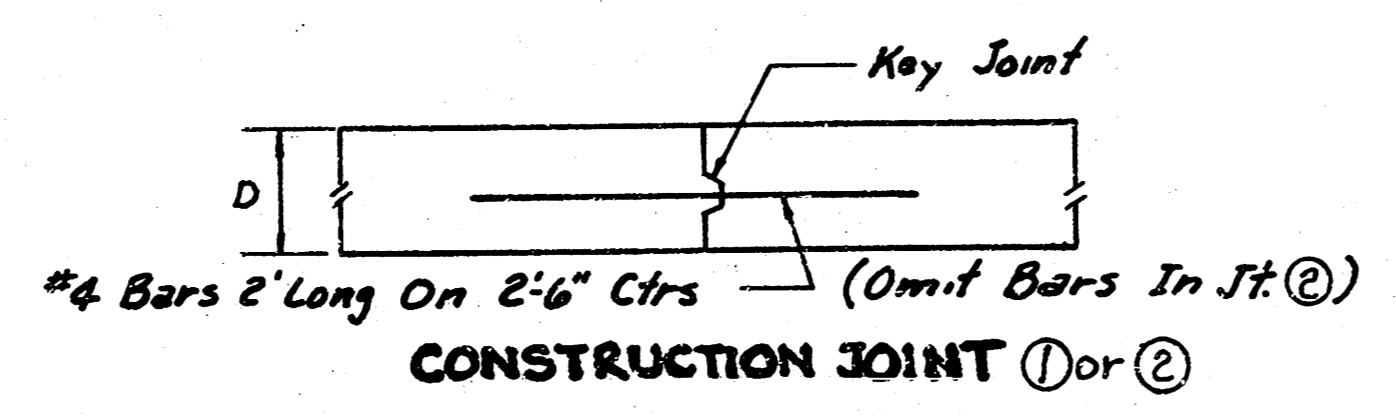

“ EARTH WORK ”

EXCAVATION, BORROW, IF ANY, AND COMPACTED FILL, EXCEPT THE COMPACTED FILL IN THE C&G IMMEDIATELY UNDER THE PAVEMENT, SHALL BE INCIDENTAL TO CURB BID ITEMS OF WORK.

JOINT PATTERNS & DETAILS	
<small>PROJECT DESCRIPTION</small>	
INTERSECTION RECONSTRUCTION THIRD AND GORDON	
<small>PROJECT NUMBER</small>	
472 76 245 81234 000 000 001 3/1	

B.M. 159.87 Top N. End 9" Conc. Retaining Wall, E. Side Chautauqua, 30' N. of N.L. 14th St. N.
B.M. 178.26 Cut on Back of Walk West, on N. Side 14th St., on N.W. Cor. Hillside f. 14th

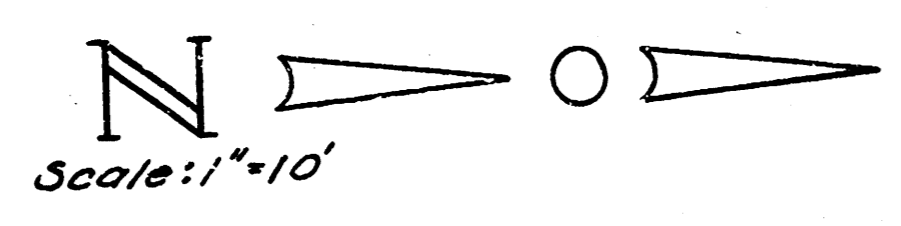

Survey Data:
Plan
Checked
Checked

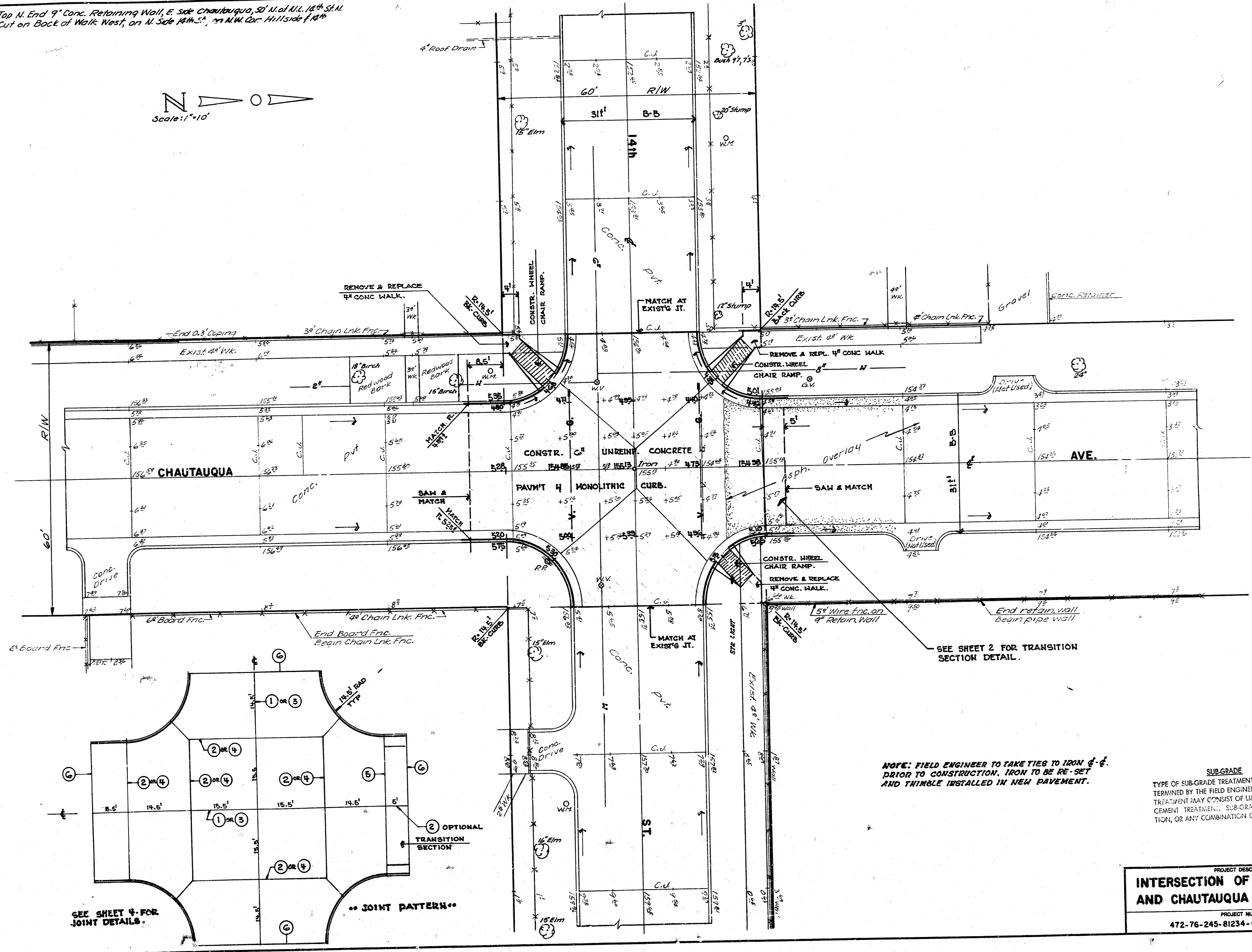

SEE SHEET 4 FOR JOINT DETAILS.

JOINT PATTERN

OPTIONAL TRANSITION SECTION

NOTE: FIELD ENGINEER TO TAKE TIES TO IRON & C. PRIOR TO CONSTRUCTION. IRON TO BE RE-SET AND TRIMBLE INSTALLED IN NEW PAVEMENT.

SUB-GRADE
TYPE OF SUB-GRADE TREATMENT SHALL BE DETERMINED BY THE FIELD ENGINEER. SUB-GRADE TREATMENT MAY CONSIST OF LIME TREATMENT, CEMENT TREATMENT, SUB-GRADE MODIFICATION, OR ANY COMBINATION OF THESE.

PROJECT DESCRIPTION
INTERSECTION OF 14TH STREET AND CHAUTAUQUA
PROJECT NUMBER
472-76-245-81234-000 -000-001

FIL MED FROM THE BEST

BM= 110.71 ~ Brass Rod In Conc. Post, 10.5' E.
 & 24' N. SW Cor. Grove & Douglas
 B.M. 114.33 S. E. COR. BOTTOM CONC STEP. NO. # 139 S. ESTELLE

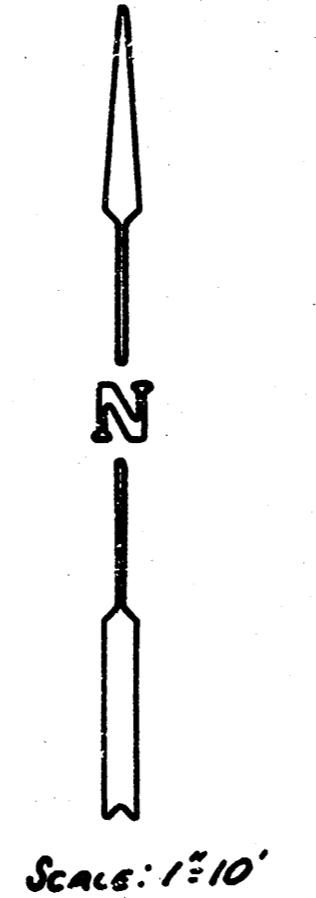

Survey by: JWC/XXA
 Plan: 1/10/19
 Date: 1/10/19

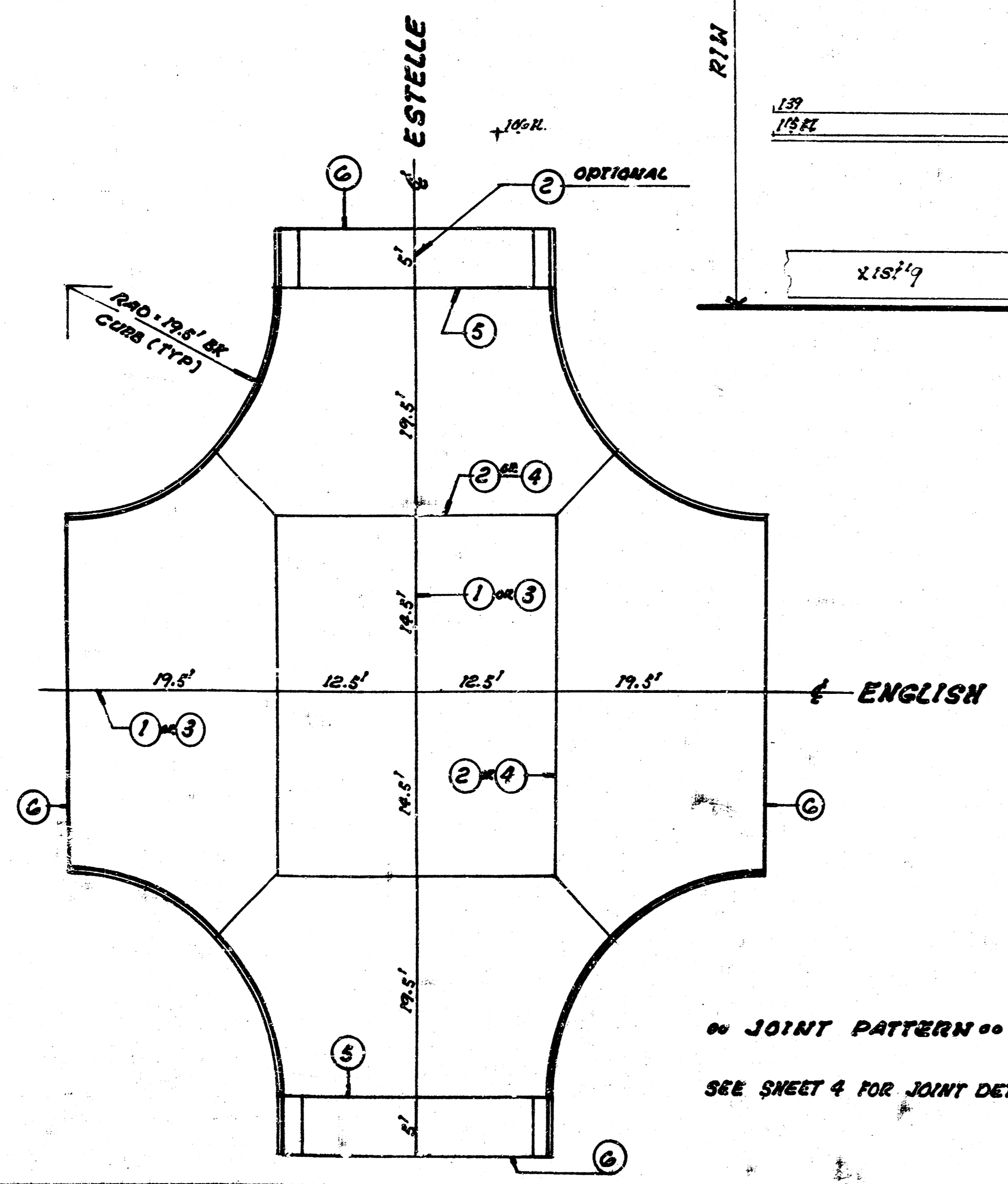
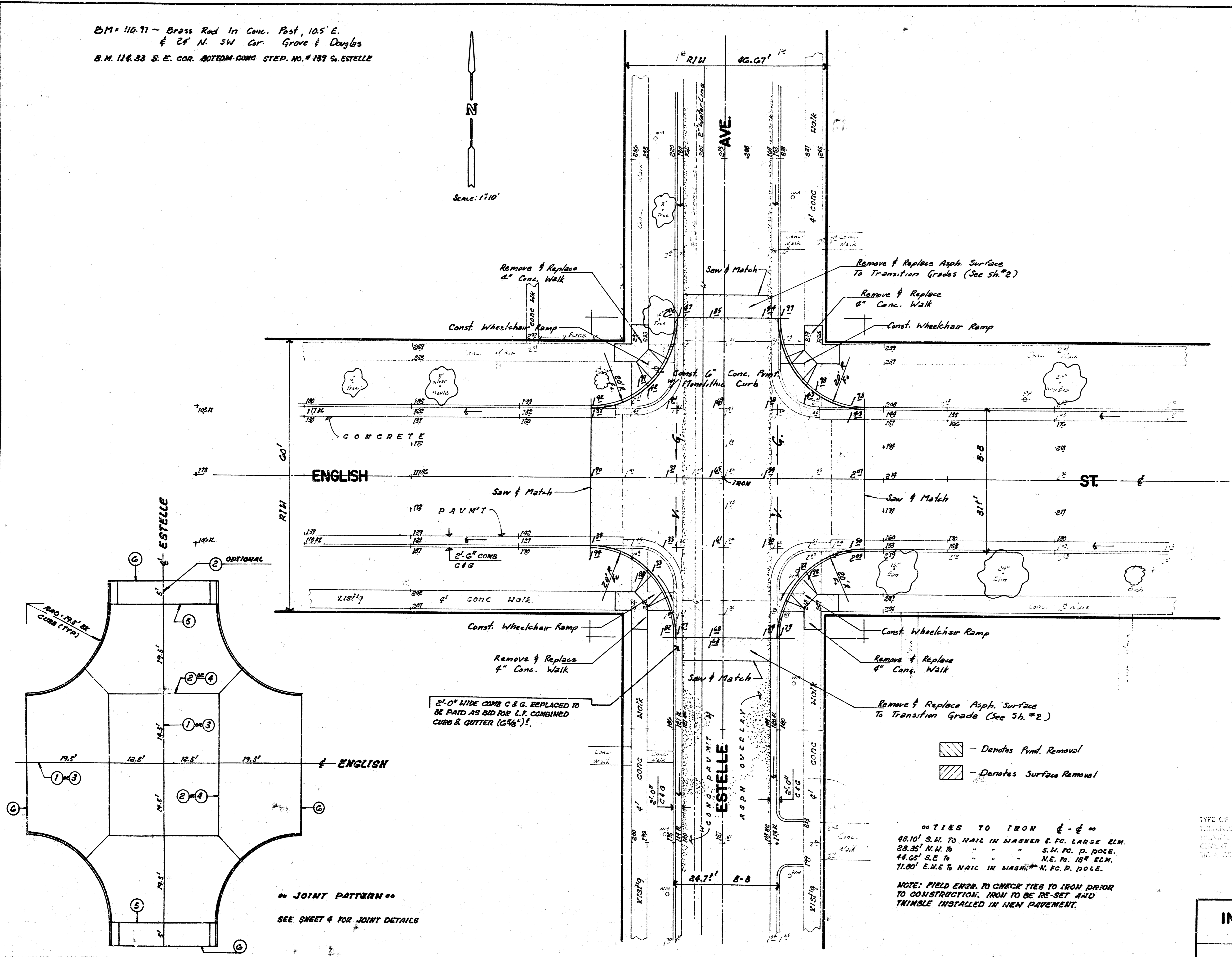

2'-0" WIDE CONC C & G. REPLACED TO BE PAID AS BID FOR L.F. COMBINED CURB & GUTTER (6%)!

TIES TO IRON & - & -
 48.10' S.M. TO NAIL IN WASHER E. FC. LARGE ELM.
 29.35' N.W. TO " " " S.M. FC. P. POLE.
 44.05' S.E. TO " " " N.E. FC. 18" ELM.
 11.80' E.N.E. TO NAIL IN WASHER N. FC. P. POLE.

NOTE: FIELD ENGR. TO CHECK TIES TO IRON PRIOR TO CONSTRUCTION. IRON TO BE RE-SET AND THIMBLE INSTALLED IN NEW PAVEMENT.

PROJECT DESCRIPTION
INTERSECTION OF ENGLISH AND ESTELLE
 PROJECT NUMBER
 472 76 245 81234 000 000 001 5/17

BM = 114.76 - Brass Rod In Conc. Post SW Cor. Vine & Second, 22.5' S. & 22.5' W. of E. Bath.
 BM = 111.28 - Brass Rod In Conc. Post NE Cor. Meridian & Maple, 26.7' N. of E Maple E. & 31.2' E. of E Meridian N.

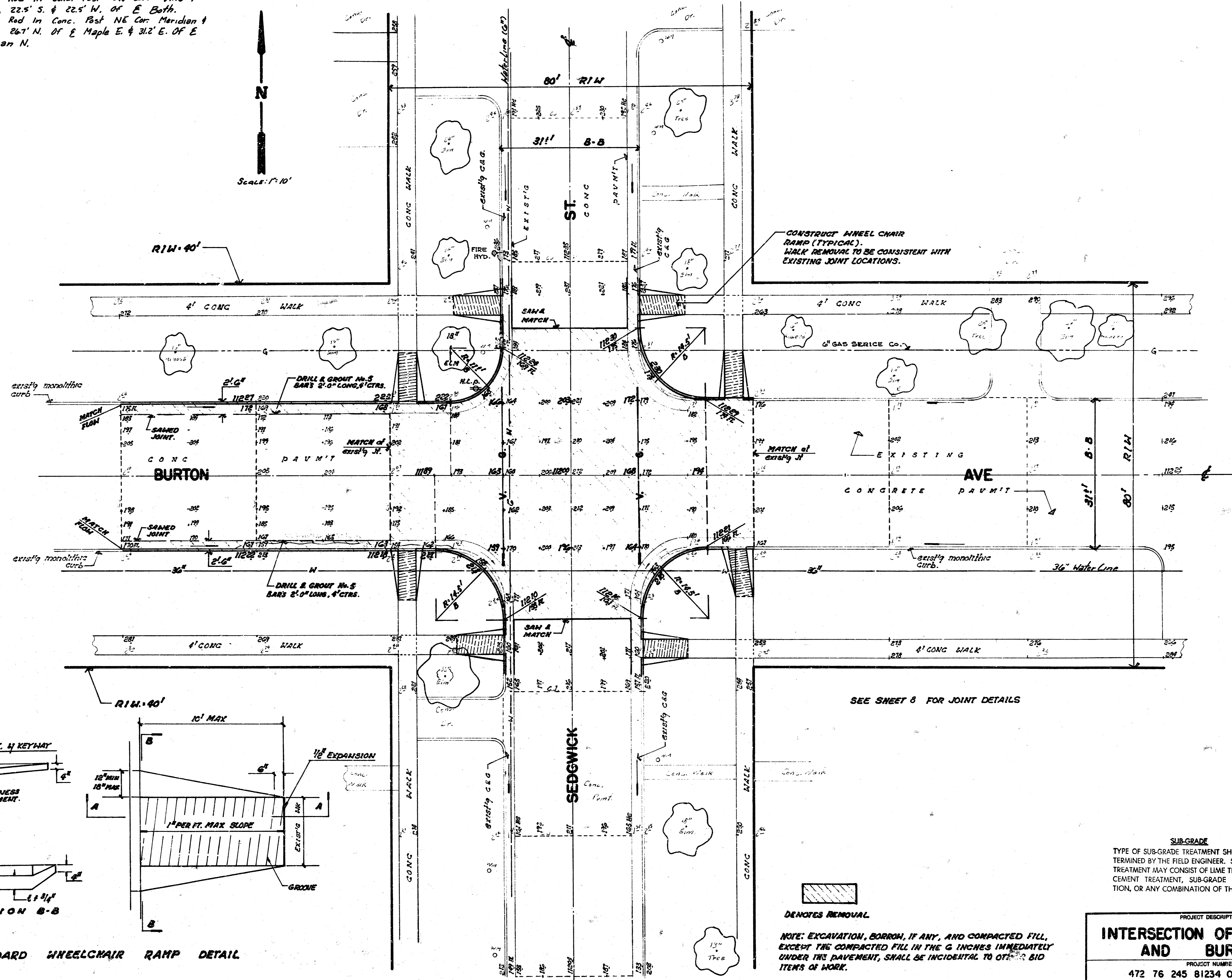
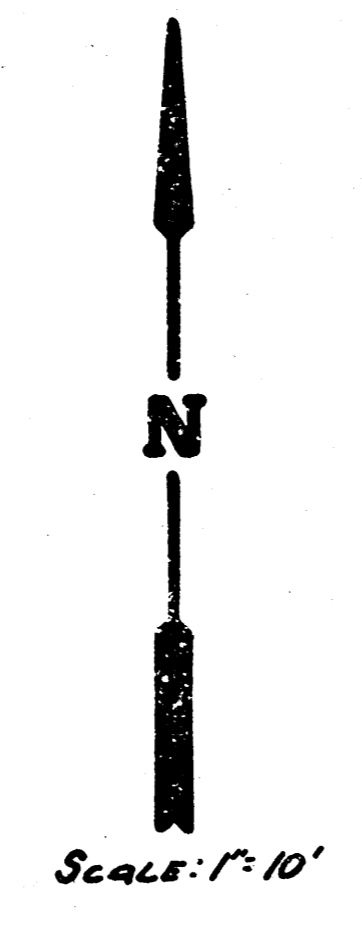

CONSTRUCT WHEEL CHAIR RAMP (TYPICAL). WALK REMOVAL TO BE CONSISTENT WITH EXISTING JOINT LOCATIONS.

SEE SHEET 6 FOR JOINT DETAILS

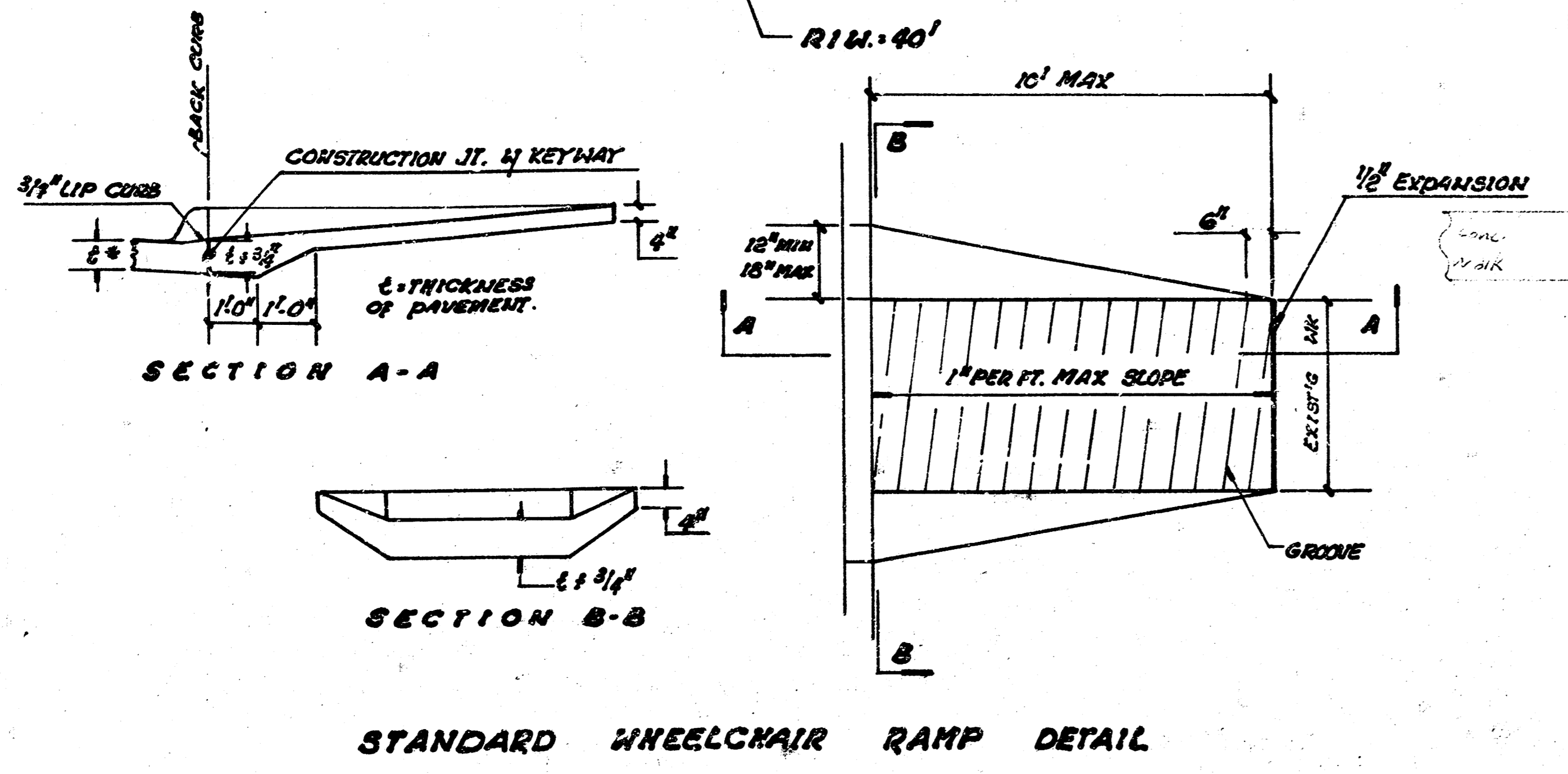

STANDARD WHEELCHAIR RAMP DETAIL

■ DENOTES REMOVAL

NOTE: EXCAVATION, BORROW, IF ANY, AND COMPACTED FILL, EXCEPT THE COMPACTED FILL IN THE 6 INCHES IMMEDIATELY UNDER THE PAVEMENT, SHALL BE INCIDENTAL TO OTHER BID ITEMS OF WORK.

SUB-GRADE
 TYPE OF SUB-GRADE TREATMENT SHALL BE DETERMINED BY THE FIELD ENGINEER. SUB-GRADE TREATMENT MAY CONSIST OF LIME TREATMENT, CEMENT TREATMENT, SUB-GRADE MODIFICATION, OR ANY COMBINATION OF THESE.

PROJECT DESCRIPTION
INTERSECTION OF SEDGWICK AND BURTON
 PROJECT NUMBER
 472 76 245 81234 000 000 001

Survey
 Plan
 A.V. & M.E.E. Jr.
 Chicago

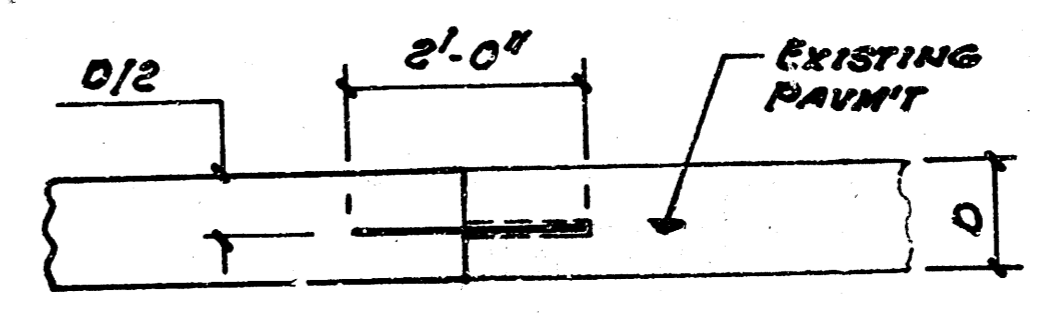
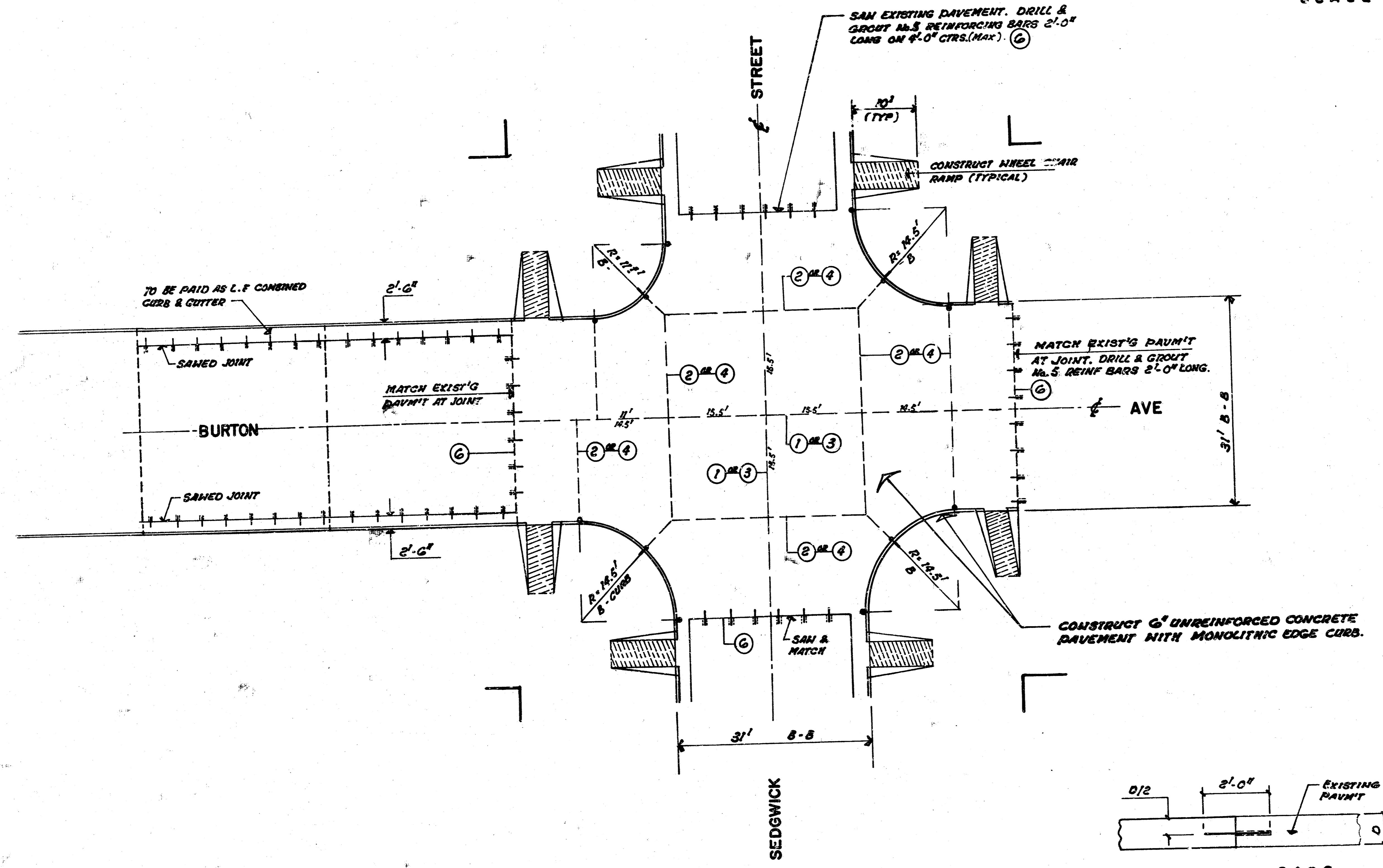
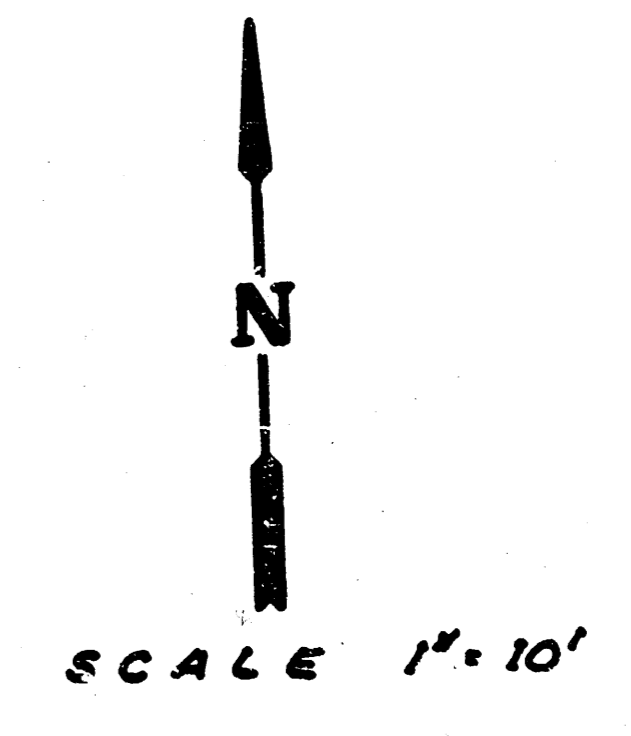

DOWEL BARS
 ALL LABOR AND MATERIAL NECESSARY TO INSTALL NO. 5 REINF. BARS SHALL BE SUBSIDIARY TO BID ITEM SQ YDS 6" UNREINFORCED CONCRETE PAV'T.

- ① CONSTRUCTION JOINT WITH STEEL
 - ② CONSTRUCTION JOINT WITHOUT STEEL
 - ③ SAWED LONGITUDINAL JOINT WITH STEEL
 - ④ SAWED LONGITUDINAL JOINT WITHOUT STEEL
 - ⑤ KEYED JOINT (AT TRANSITION SECTION)
 - ⑥ DRILLED & GROUTED JOINT.
- SEE SHEET 4 FOR JOINT DETAILS

JOINT PATTERNS & DETAILS
 PROJECT DESCRIPTION
**INTERSECTION RECONSTRUCTION AT
 SEDGWICK AND BURTON**
 PROJECT NUMBER
 472-76-245-81234-000-000-001