

B.M. 110.58 N. Elm R.G.E. M.H. S.W. Cor. Broadway & Douglas, on Wk.  
 B.M. 111.02 On Wk. W.L. Alley N.C. William, At Cor. of Bldg.  
 B.M. 110.80 "C" in Const. on Wk. W.L. Alley 2' S. of N.C. English

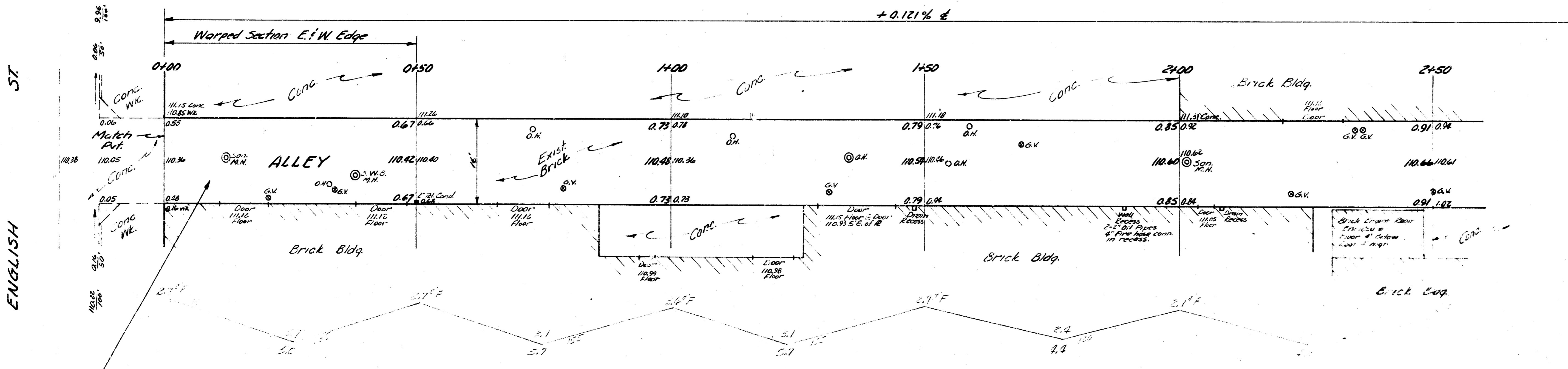

Grading Total Fill  
 276  
 7161 40.7 cu yds



Remove exist. Pav. in alley as shown & replace with 8" Conc. Pav.

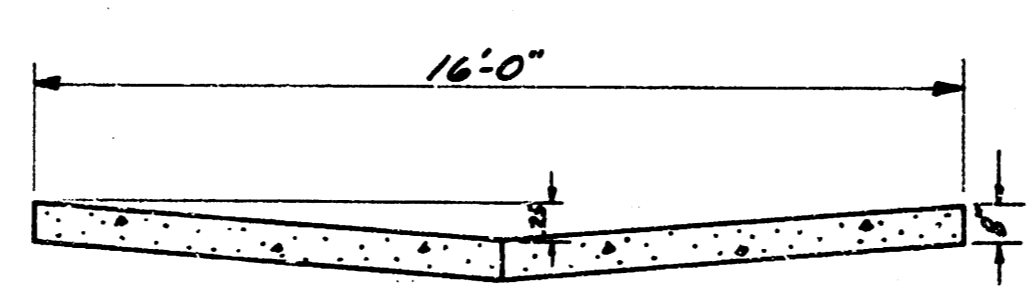
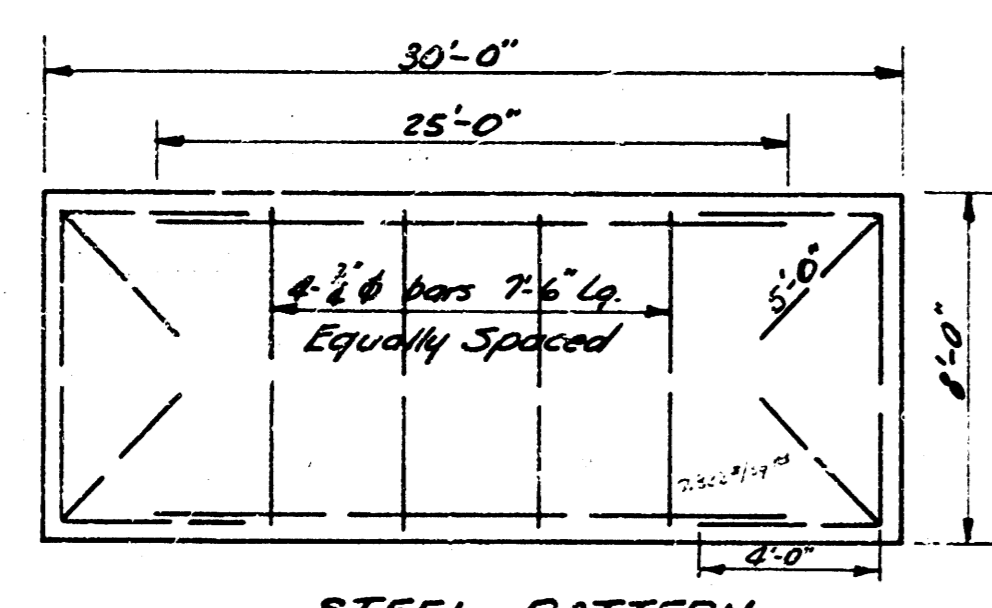

TYPICAL SECTION  
 Sta. 0+50 to Sta. 4+02.8  
 No SCALE

1/2

ALLEY BTWN BROADWAY & MARKET  
 N.L. ENGLISH TO S.L. WILLIAM  
 16" CONC.-8" REPAVE  
 CITY OF WICHITA, KANSAS  
 B.E. SMITH CITY ENGINEER  
 Sept. 1954 Prod. 1/4 C16-120

C.M.P. DEC. 1954

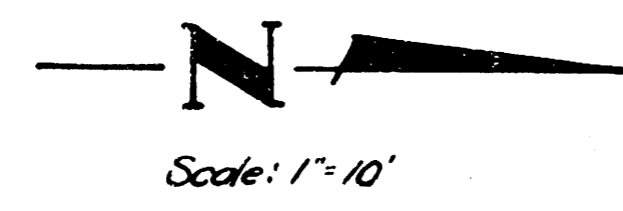

PLT  
11/1/50  
2/11  
2

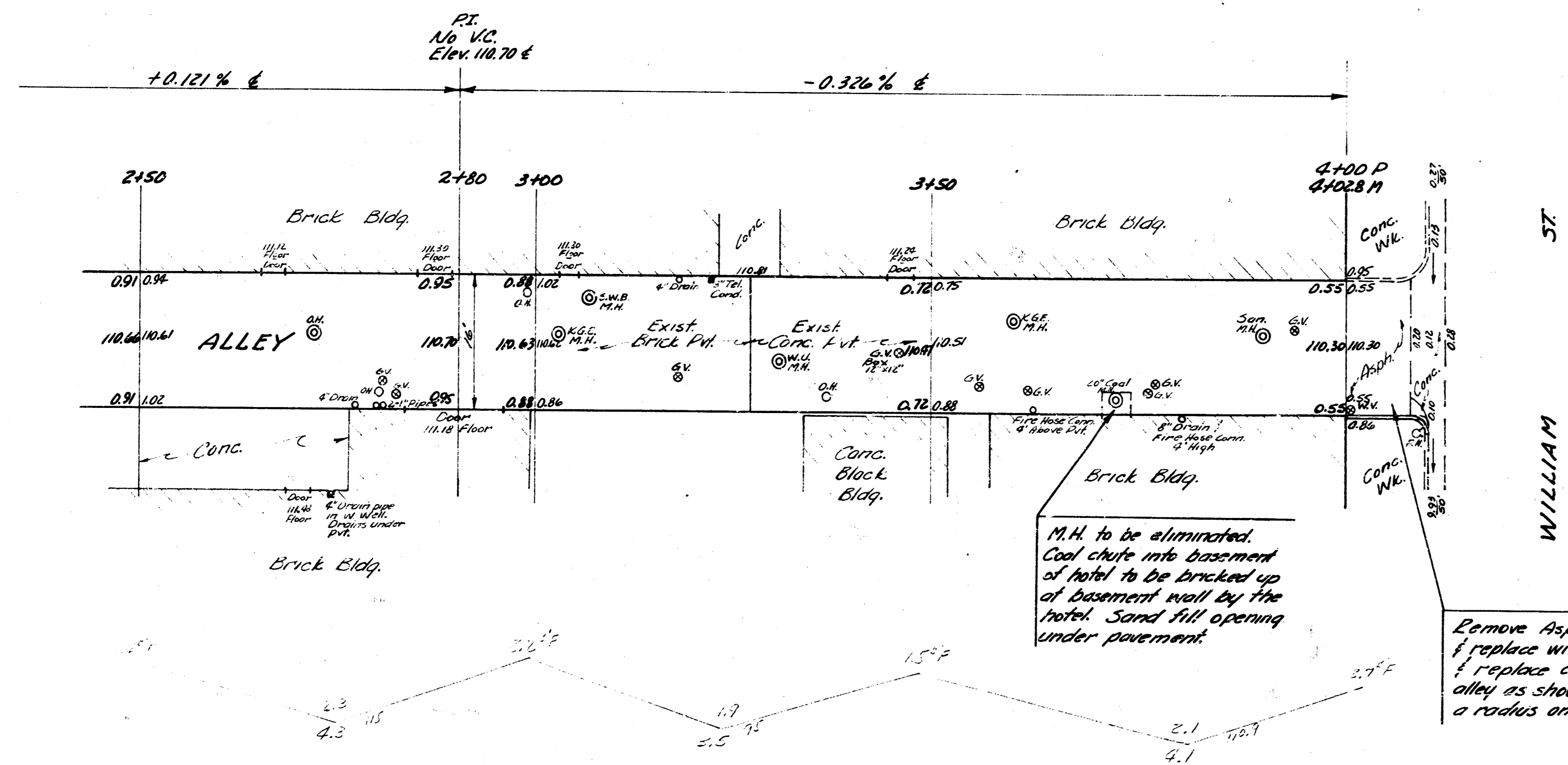

2  
2