

B.M. = 93.57 CITY BENCH MARK DISC. 8' SOUTH AND 3'
W. OF NORTHWEST COR. WEST GLEN & 31ST STREET. 50.

Utility service lines, poles, valve boxes, meters, etc. are to be adjusted as necessary by others prior to construction unless the plans specifically call for their adjustment by the contractor. Existing utilities and their location, as shown on the plans, represent the best information obtainable for design. Location information has been obtained from the various utility companies and is either from company record drawings or company provided field locations. The plan locations shown are not guaranteed. Additional existing utilities may also be encountered. The contractor will be required to work around existing utilities within the right-of-way which do not conflict with proposed construction.

Rubble from the removal of miscellaneous structures and excess excavation which is to be wasted shall be disposed of on sites to be provided by the Contractor. These sites shall be approved by the Engineer as to suitability, appearance and site location. Locations that, in the opinion of the Engineer, will leave an unsightly appearance will not be approved.

All disposal sites must be approved by the Kansas Department of Health and Environment. Material either stockpiled or disposed of in a flood plain would require a Kansas State Board of Agriculture permit. Any material dumped in waters of the United States or wetlands is subject to U.S. Corps of Engineers permitting regulations. Any material buried or stockpiled beyond approved construction limits would require additional archaeological investigations unless buried in a previously approved borrow location.

CONTRACTOR WILL BE REQUIRED TO PROVIDE A MINIMUM ADVANCE NOTICE OF TWENTY-FOUR (24) HOURS TO UTILITY COMPANIES PRIOR TO STARTING ANY EXCAVATION AS FOLLOWS:

KANSAS ONE-CALL 1-800-344-7233

THE CONTRACTOR MUST NOTIFY THE FOLLOWING IN CASE OF EMERGENCY:

CABLEVISION 262-4270 or 263-2061
 KPL GAS SERVICE COMPANY 263-7511
 KANSAS GAS & ELECTRIC 264-1141
 ARKLA GAS COMPANY 942-8350 or 263-8161
 SOUTHWEST BELL TELEPHONE COMPANY 1-571-2611
 CITY OF WICHITA WATER DEPARTMENT 268-4000
 CITY OF WICHITA SEWER MAINTENANCE 268-4071

LIST OF QUANTITIES (APPROX.)		
QUANTITY		ITEM
375	S.Y.	8" REINF. DRIVEWAY CONC. PAYM'T
105	L.F.	COMBINED CURB & GUTTER
1490	lbs	REINF. STEEL (6"x12" W4xW4)
1	EA.	MANHOLE ADJUSTED
50	S.F.	4" SIDEWALK CONC. PAYM'T
105	C.Y.	EXCAVATION
80	L.E.	COMB. CURB & GUTTER REMOVED
900	S.F.	CONC. SIDEWALK AND DRIVE REMOVED

EXPANSION MATERIAL FULL DEPTH OF DRIVE SHAPE WITH EDGING TOOL

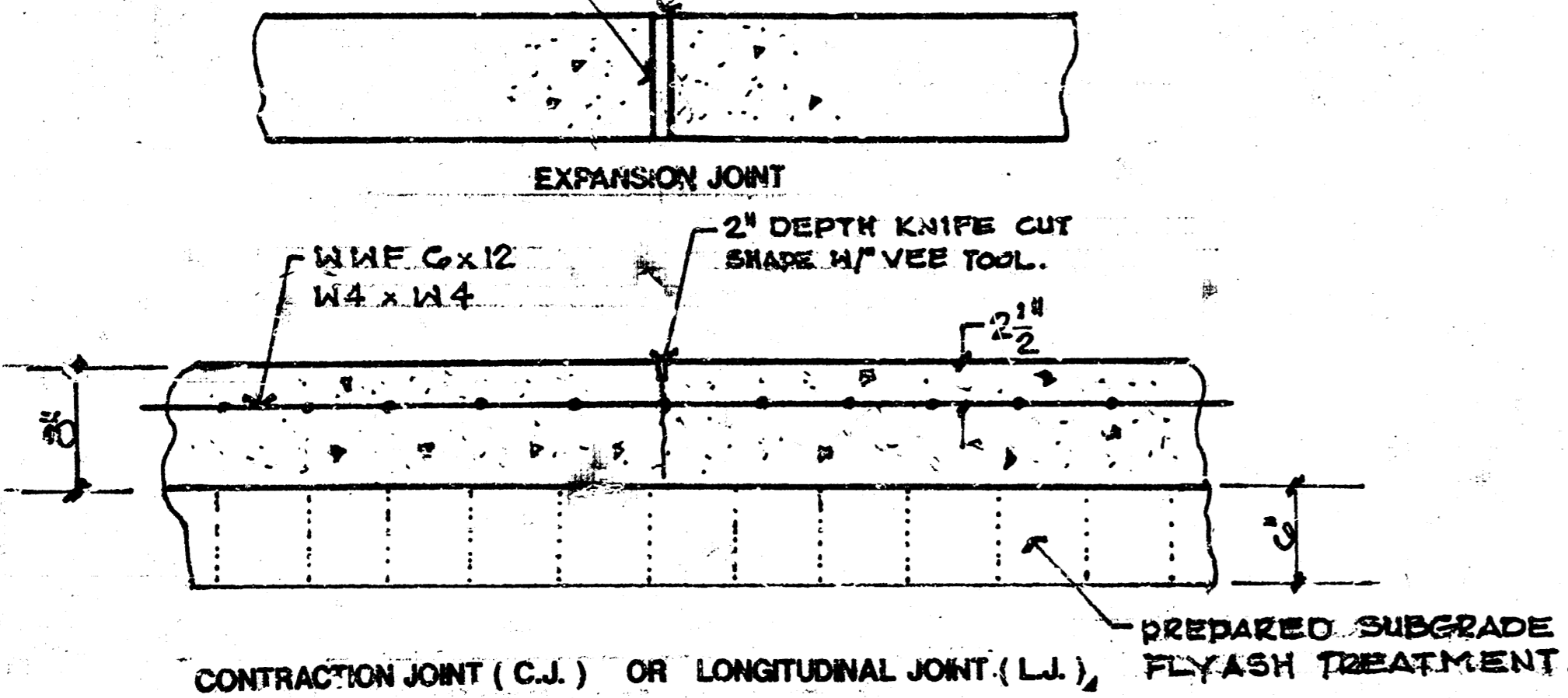

8" REINF. CONC. PAVEMENT SECTION

325	S.Y.	SUBGRADE STABIL. MANIPULATION
14	TONS	FLY ASH SUBGRADE STABILIZATION

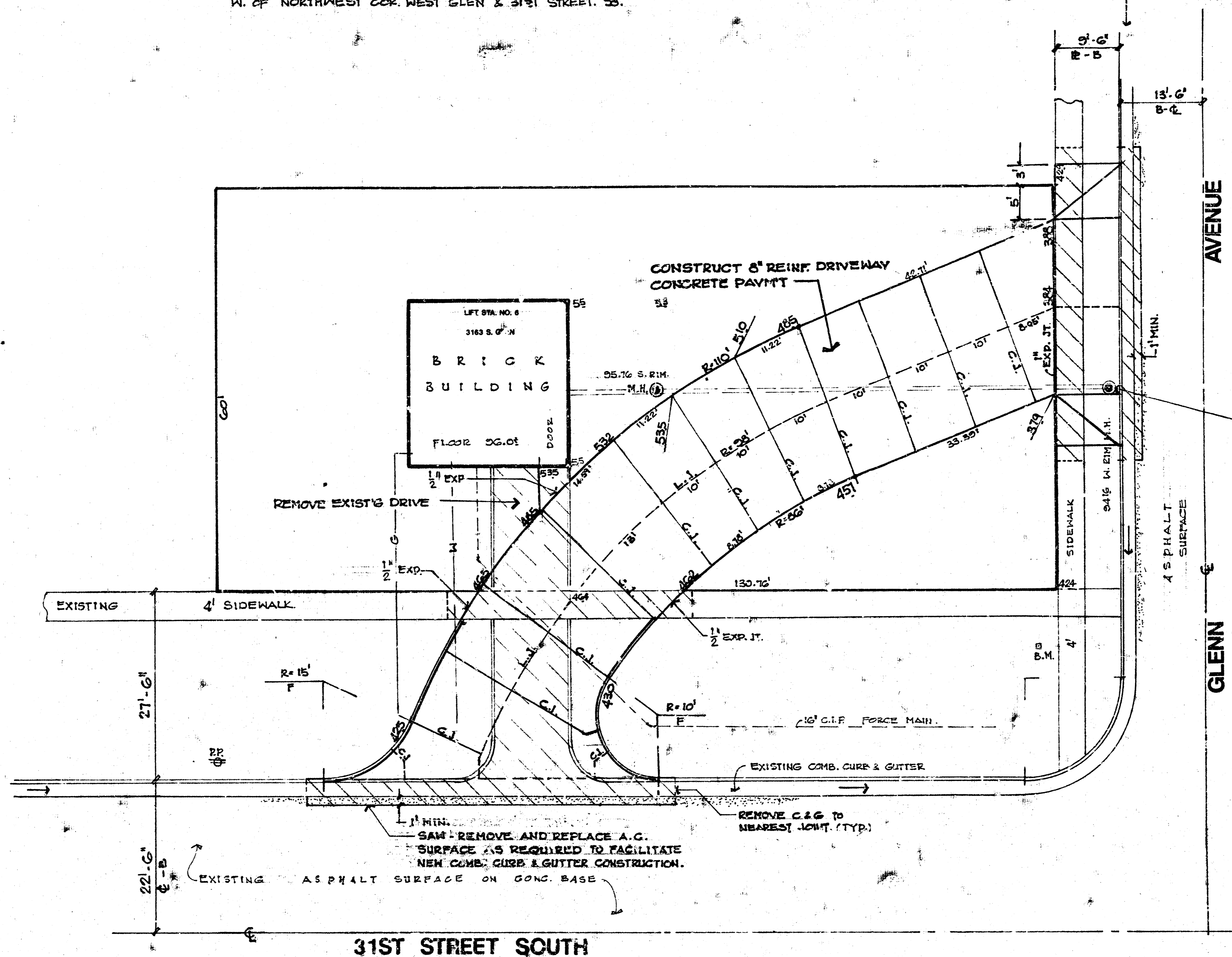

ADJUST M.H.
 EXISTING EL. 94.16
 NEW EL. 93.50'
 NOTE: NEW RING & COVER TO BE FURNISHED BY C.O.P. W. SEWER MAINTENANCE. INSTALLATION BY PAVING CONTRACTOR.



PROJECT DESCRIPTION		
DRIVEWAY CONSTRUCTION FOR LIFT STATION NO. 6 AT 31ST STREET SO. AND GLENN AVE.		
INDEX NO. 630655		
BOOK NO.	APPROVED BY	DATE Nov-98
DRAWN BY		REVISED
CITY OF WICHITA		
		SCALE 1"=10'

14 5 3 2