

BM 112.08 R.P. Spd N.S.P.P. on S.S. Burton bet. Walnut & Handley  
 BM 111.67 R.P. Spd S.S. R.P. on N.S. Texas bet. Walnut & Handley

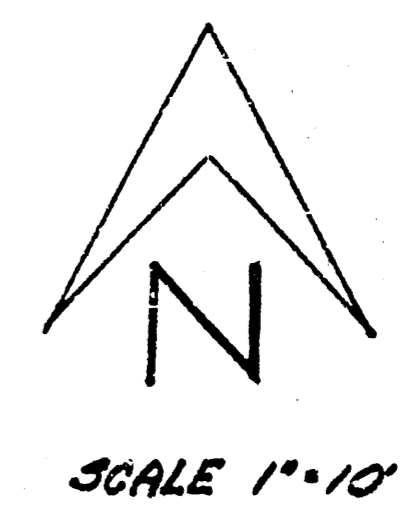

EXCAVATION  
 PROP.  
 50.3 C.Y.  
 5.0' x 10'  
 55.3 C.Y. Total

11/24/65  
 B.E. SMITH  
 11/24/65  
 B.E. SMITH

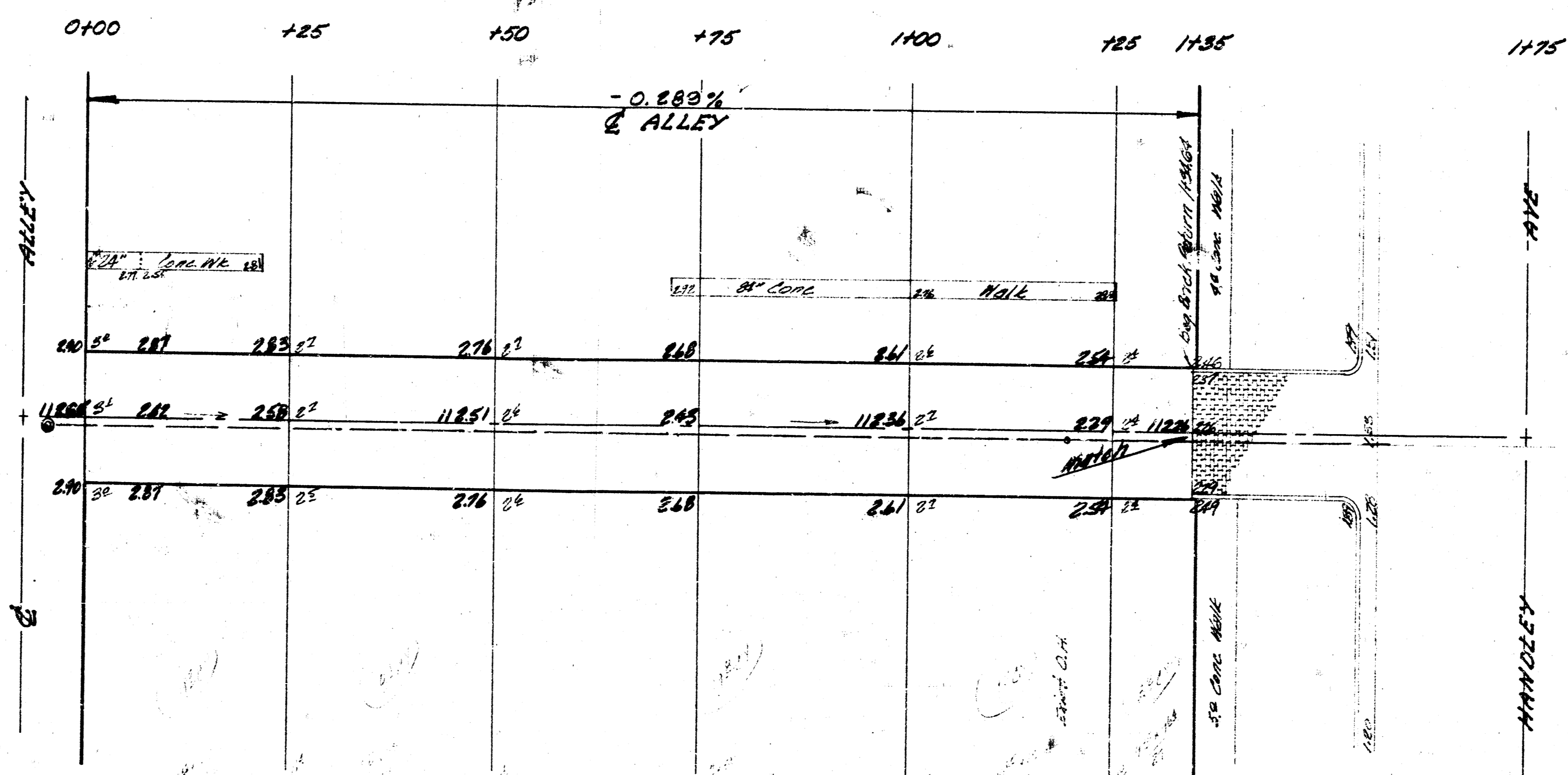
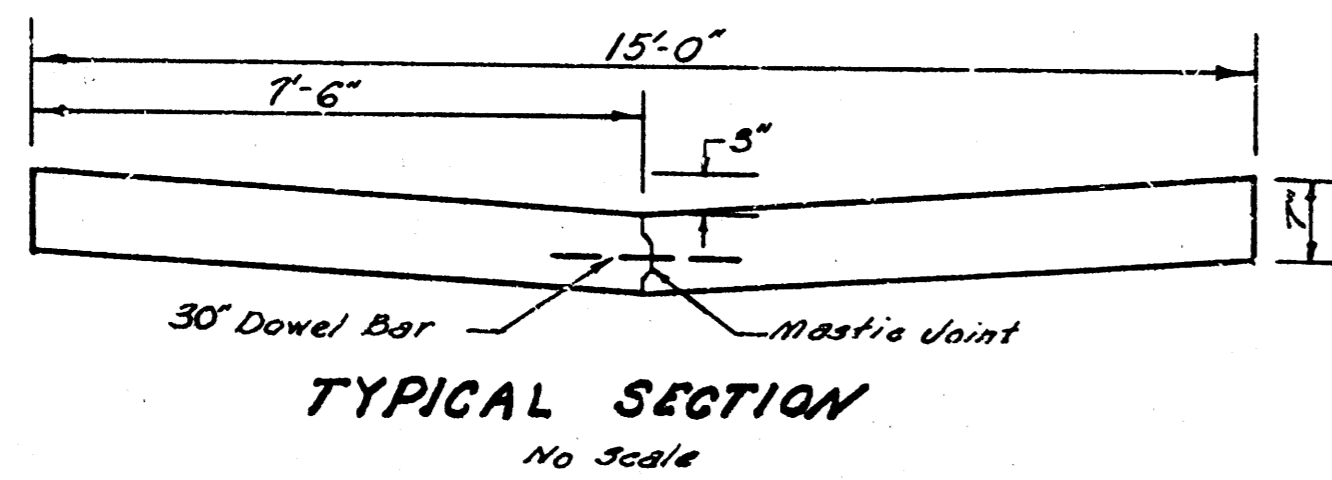
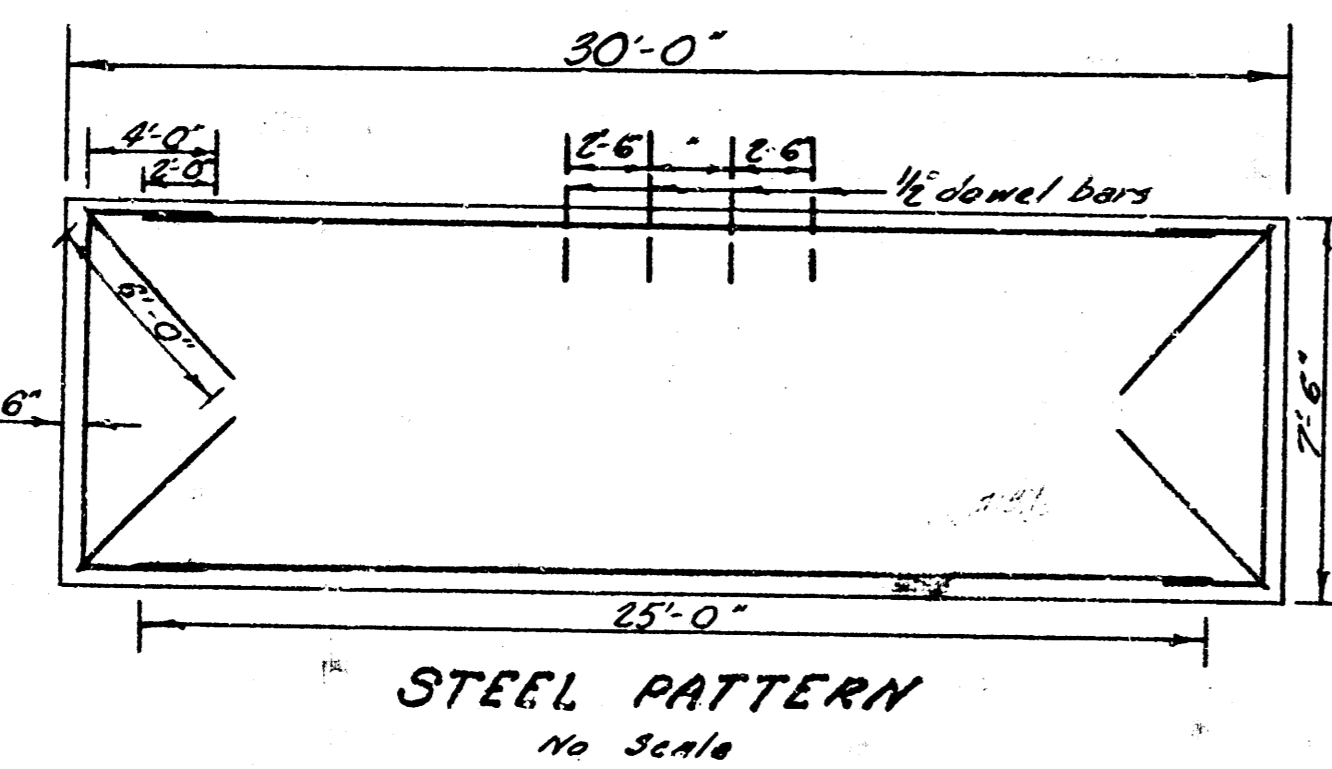

ALLEY BET. BURTON & TEXAS  
 EL ALLEY W. OF HANDLEY TO  
 W.L. HANDLEY  
 7" CONC. - 15' WIDTH  
 CITY OF WICHITA, KANSAS  
 B.E. SMITH CITY ENGINEER  
 DATE March 1965 PROJ. C-16-65