

Bench Mark: City Standard Disc.
52' North & 42' East of the C.
of Oliver & Pawnee.
Elev. = 121.15 City Datum.

TBM: Top of RR Spike at Sta 11+24.8
on Alley Project.
Elev. = 127.66 City Datum.

HO-J
SCALE 1" = 20'

GENERAL NOTES

- ALL CONSTRUCTION AND MATERIALS TO COMPLY WITH CITY OF WICHITA SPECIFICATIONS AND STANDARDS.
- ALL ELEVATIONS SHOWN ARE CITY OF WICHITA DATUM (USGS-1187.4 - CITY DATUM).
- AT LEAST 48 HOURS PRIOR TO BEGINNING EXCAVATION (EXCLUDING WEEKENDS AND HOLIDAYS), THE CONTRACTOR SHALL CONTACT THE KANSAS ONE-CALL SYSTEMS, A UTILITY LOCATION SERVICE AT (316) 687-2470 TO REQUEST THE FOLLOWING UTILITY COMPANIES TO LOCATE ANY EXISTING LINES WITHIN THE PROJECT AREA: ARKLA GAS COMPANY, GAS SERVICE COMPANY, K.C.&E., THE WICHITA WATER DEPARTMENT, AND AIR CAPITAL CABLEVISION.
- THE CONTRACTOR MUST ALSO NOTIFY BELL TELEPHONE COMPANY AT (913) 571-2115 43 HOURS PRIOR TO BEGINNING EXCAVATION AND REQUEST THAT ANY LINES WITHIN THE PROJECT AREA BE FLAGGED.
- THE BURIED UTILITIES AS LOCATED ON THE PLANS ARE APPROXIMATE LOCATIONS ONLY. IT SHOULD BE NOTED THAT OTHER BURIED LINES AND CABLES MAY EXIST WHICH ARE NOT SHOWN ON THESE PLANS. THE CONTRACTOR SHALL EXERCISE EXTREME CAUTION DURING TRENCHING OPERATIONS TO AVOID DAMAGING THESE LINES. ANY LINES DAMAGED SHALL BE REPLACED OR REPAIRED IMMEDIATELY AS DIRECTED BY THE ENGINEER AT THE CONTRACTOR'S EXPENSE.
- THE CONTRACTOR SHALL BE RESPONSIBLE FOR PRESERVING PROPERTY IRONS. THE CONTRACTOR SHALL BE REQUIRED TO RE-ESTABLISH ANY PROPERTY IRONS WHICH ARE DAMAGED OR DESTROYED BY HIS CONSTRUCTION OPERATIONS. SUCH IRONS SHALL BE RE-ESTABLISHED BY A LICENSED LAND SURVEYOR OR BY A LICENSED PROFESSIONAL ENGINEER IN ACCORDANCE WITH STATE LAWS. ALL COST FOR THIS WORK SHALL BE SUBSIDIARY TO THE OTHER ITEMS OF WORK.
- SANITARY SEWER LINE WILL BE TELEVIEWED PRIOR TO START OF ALLEY PAVEMENT CONSTRUCTION; AND ANY DEFECTS WILL BE REPAIRED BY SEWER MAINTENANCE PERSONNEL.
SANITARY SEWER LINE WILL BE RETELEVIEWED AFTER SUB-GRADE WORK HAS BEEN COMPLETED BUT BEFORE THE PAVEMENT IS PLACED SO SEWER MAINTENANCE PERSONNEL CAN DETERMINE IF THE LINE WAS DAMAGED DURING CONSTRUCTION.
ANY DAMAGE TO SEWER SHALL BE CORRECTED BY THE CONTRACTOR AT HIS OWN EXPENSE.
- TREES TO BE REMOVED ARE MARKED \otimes . ALL TREES WHICH IN THE OPINION OF THE FIELD ENGINEER CAN BE SAVED, SHALL BE SAVED.
- HOT FOUNDED CONCRETE JOINT SEAL MATERIAL SHALL CONFORM TO ASTM D-3569 OR ASTM D-1190.

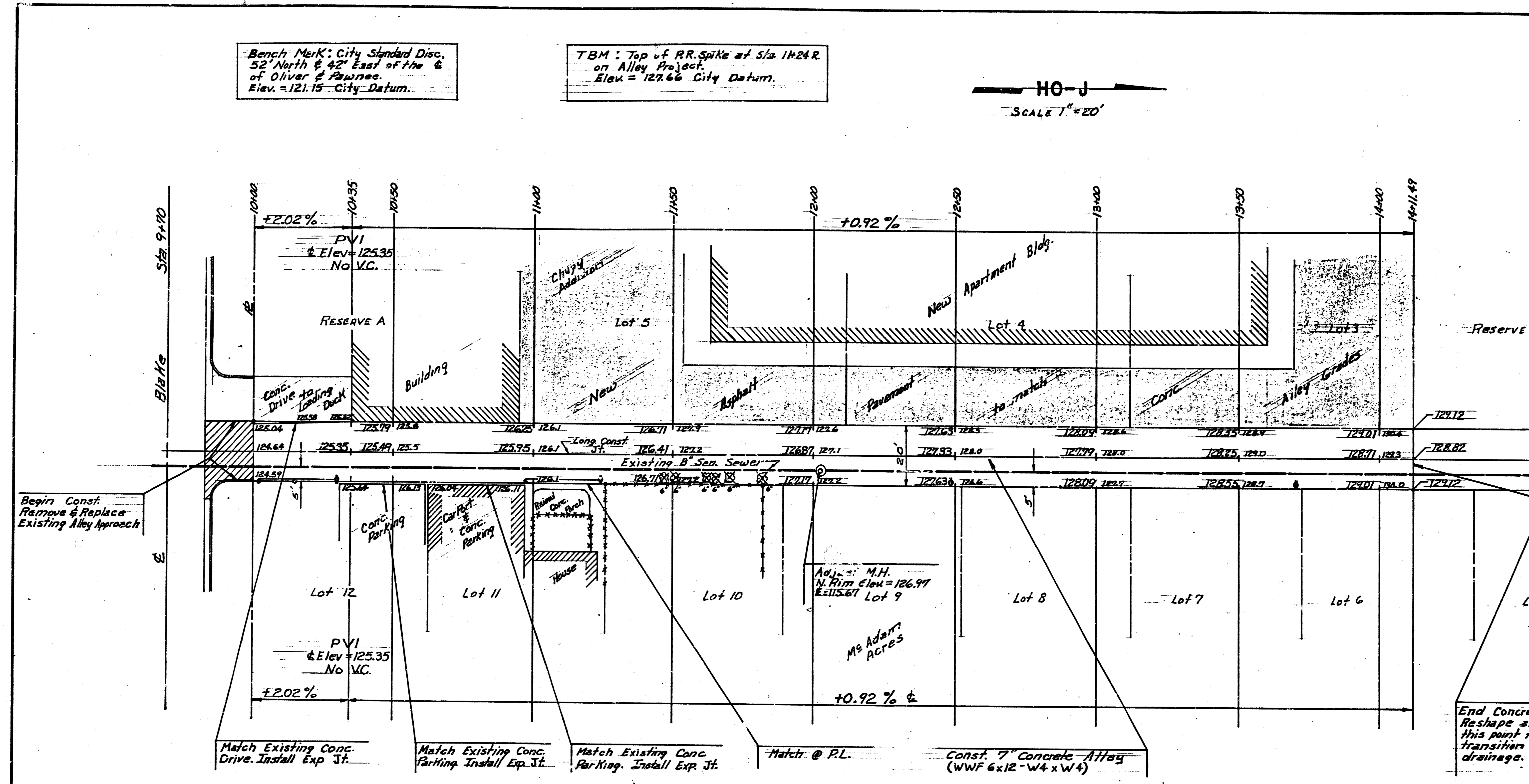

End Concrete Alley Const.
Reshape alley north of
this point to provide smooth
transition of grade and
drainage.

APPROVED AS NOTED
By CITY ENGINEER OF WICHITA

- Sanitary Sewers _____
- Storm Sewers _____
- Driveway Approaches _____
- Water Mains _____
- Paving 10-17-85

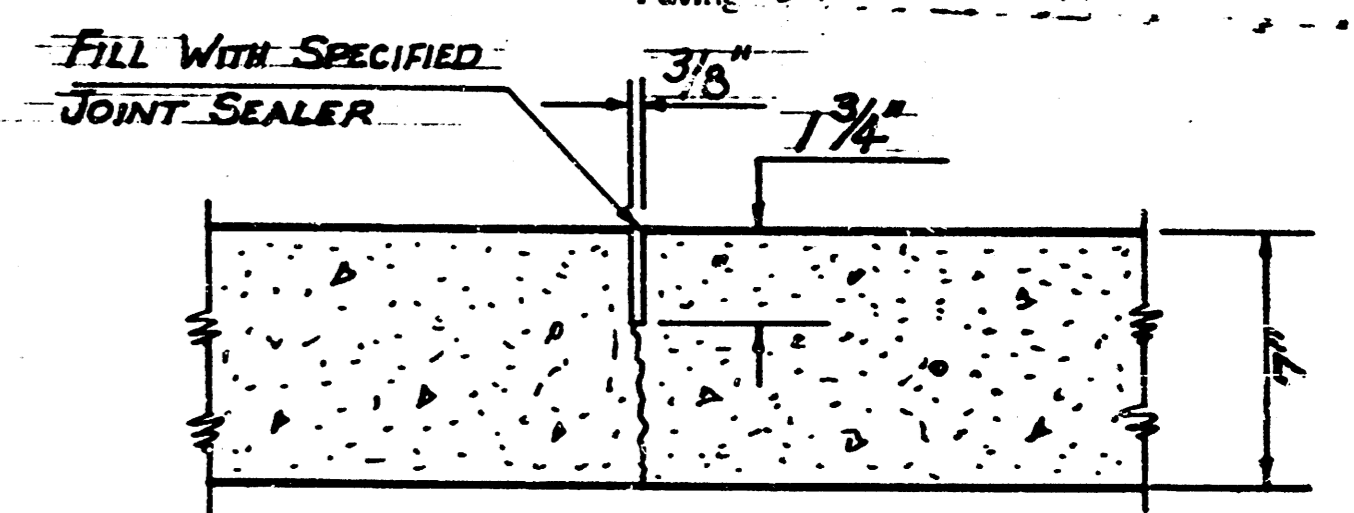

SAWED TRANSVERSE CONTRACTION JOINT AT 20' INTERVALS

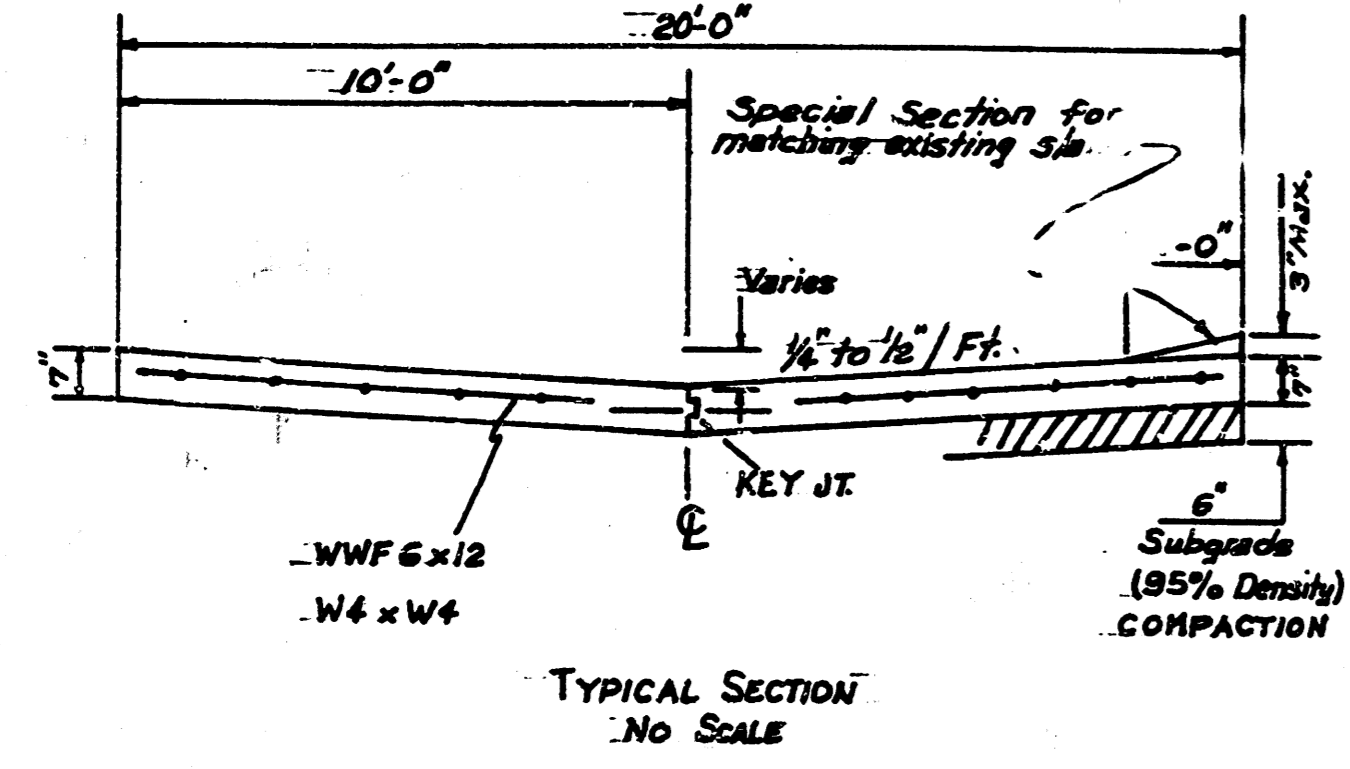
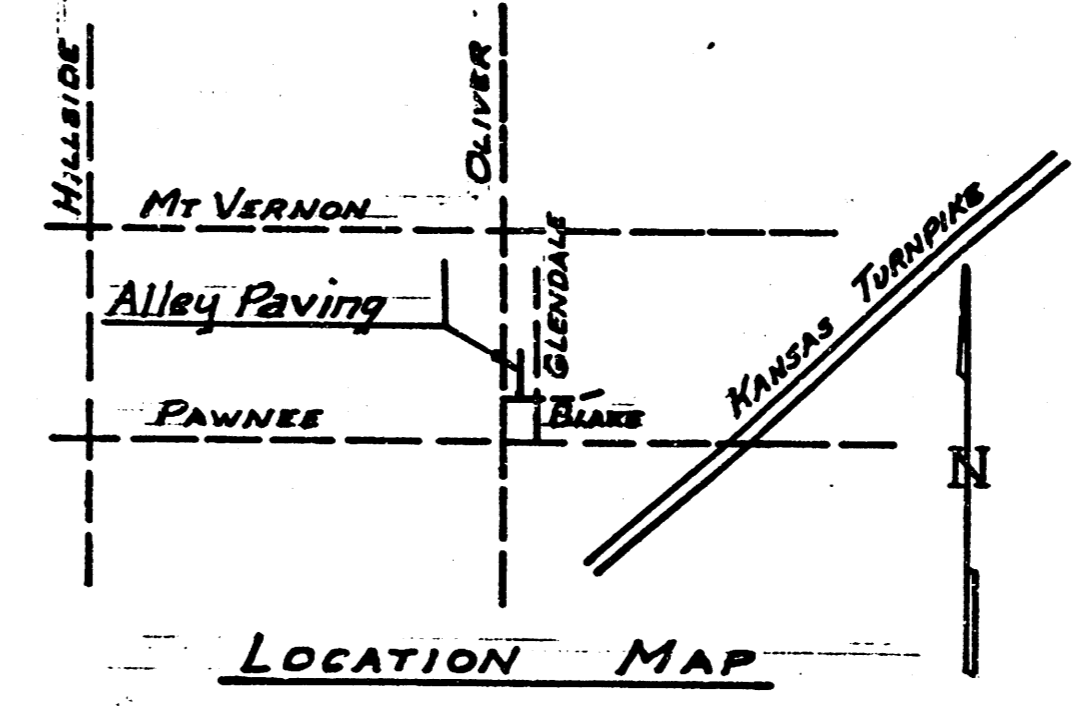
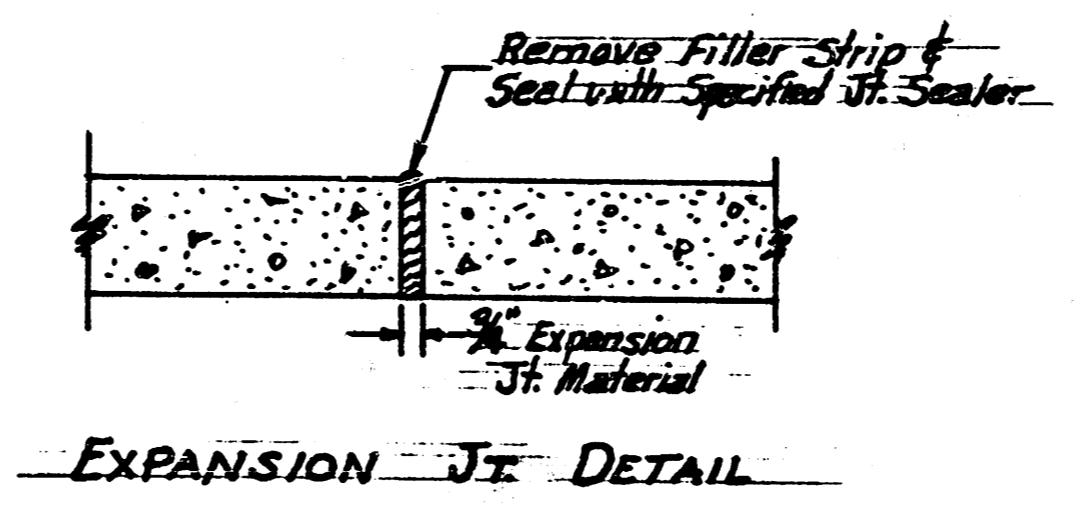

TYPICAL SECTION No SCALE

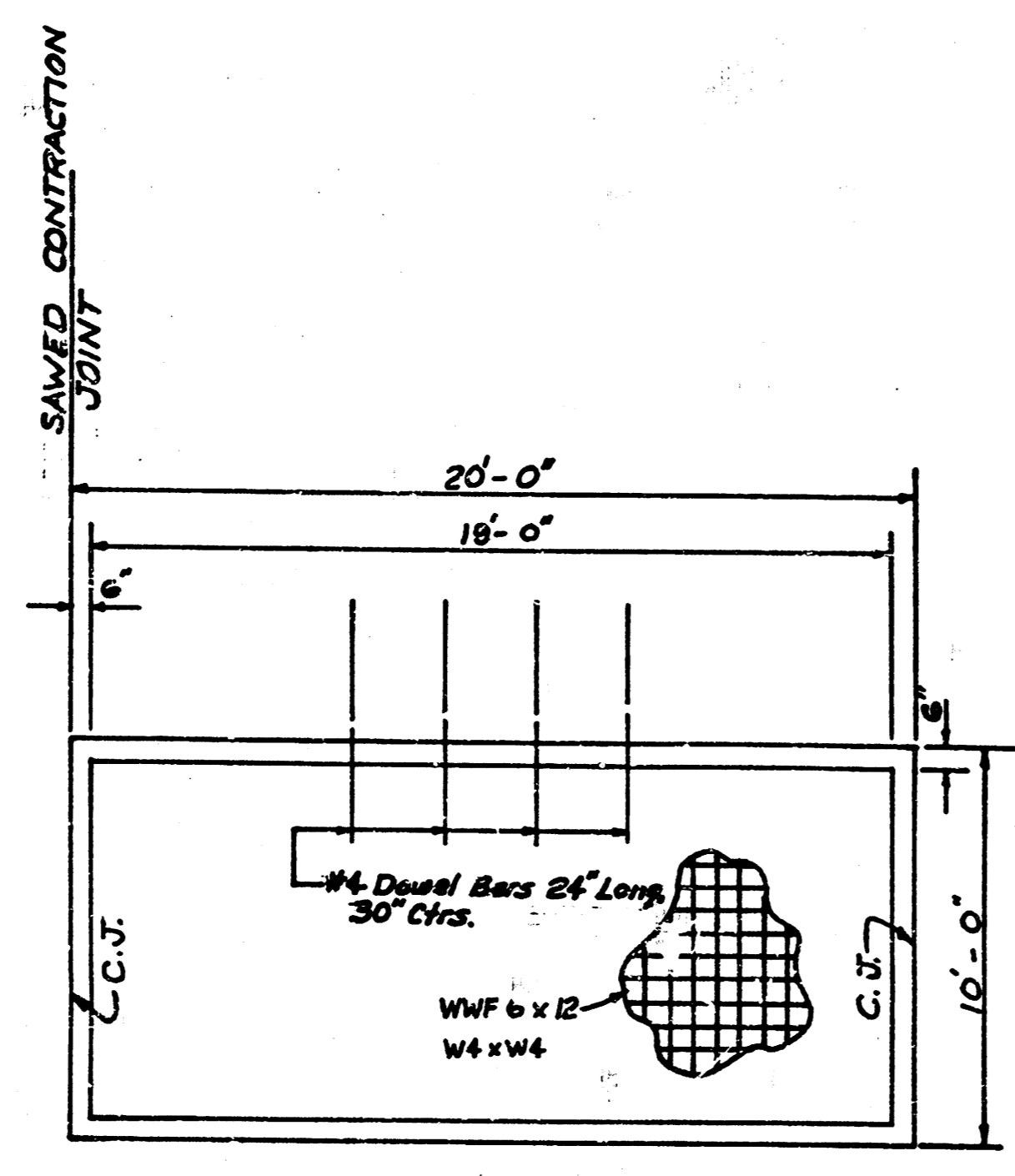

TYPICAL STEEL PATTERN No SCALE

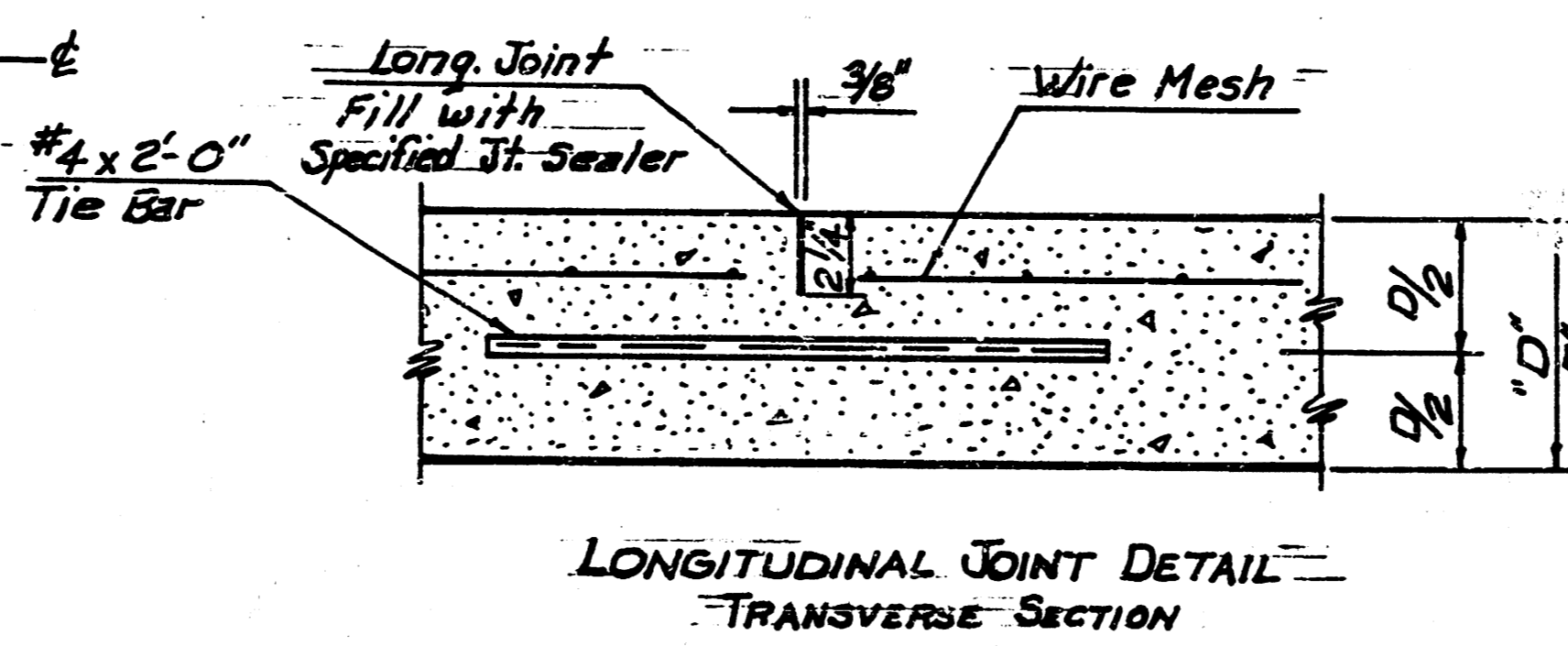

LONGITUDINAL JOINT DETAIL - TRANSVERSE SECTION

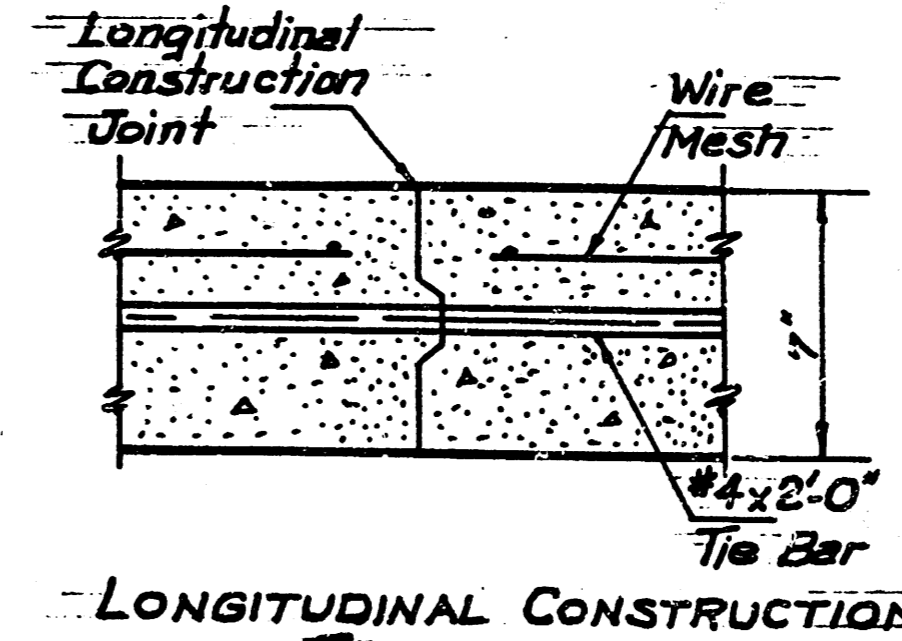

LONGITUDINAL CONSTRUCTION JOINT DETAIL - TRANSVERSE SECTION

All costs for reinforcing steel is to be included in Bid Price for Sp. Pds. 7" Conc. Pavement.

NOTE: Longitudinal joint formed by sawing 2 1/2\"/>



HO-J PRIVATE ALLEY PAVING
ALLEY BETWEEN OLIVER & GLENDALE
(FROM NL BLAKE-NORTH 411.49 FEET)
Project No. 472-76-245-80001-000-011
CITY OF WICHITA, KANSAS

HO-J ENGINEERING OCTOBER 1985
1542 SOUTH ST. FRANCIS
WICHITA, KANSAS 67211 264-0341