

B.M. = 10997(R) in Ritchie ctr. push block N.S. 1st. Str. E. of d. alley bet Penn & New York.  
 = 111.23 So rim M.H. & 2nd. Str. & alley So. bet. Pennsylvania & New York.  
 = 111.48 Brass rod in conc. post 22.5'E. 32.0'S of  $\frac{1}{2}$  both Hydraulic & Central.

Base Line = Centerline of ALLEY

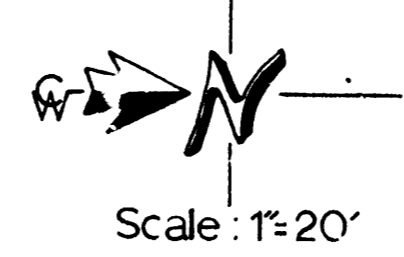

Scale: 1" = 20'

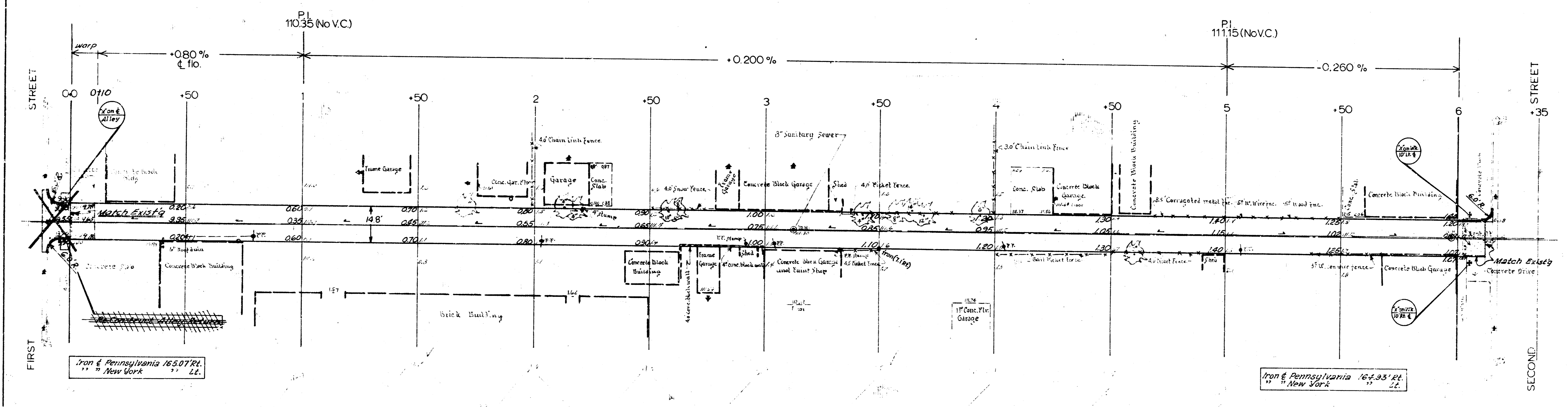

Iron & Pennsylvania 16507RL  
 " " New York " " " "

Iron & Pennsylvania 16493'RL  
 " " New York " " " "

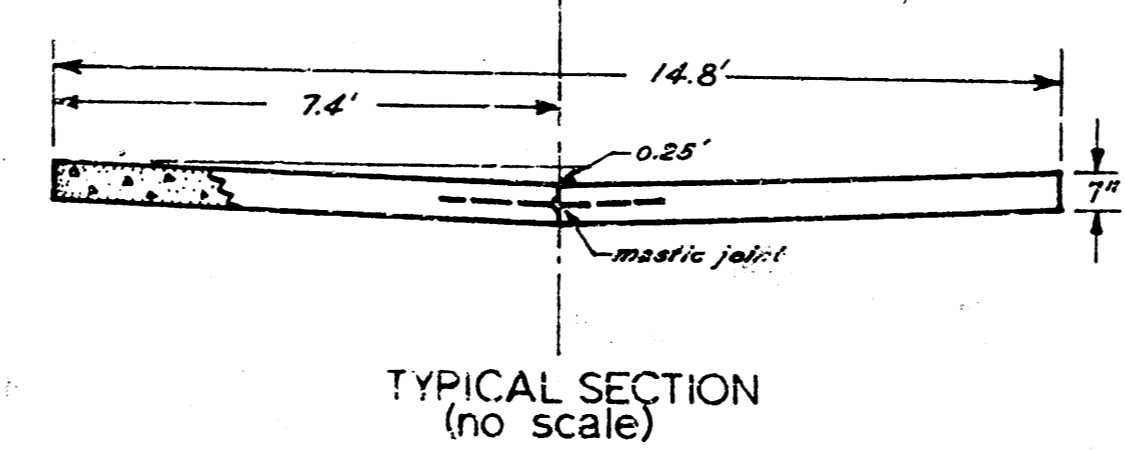
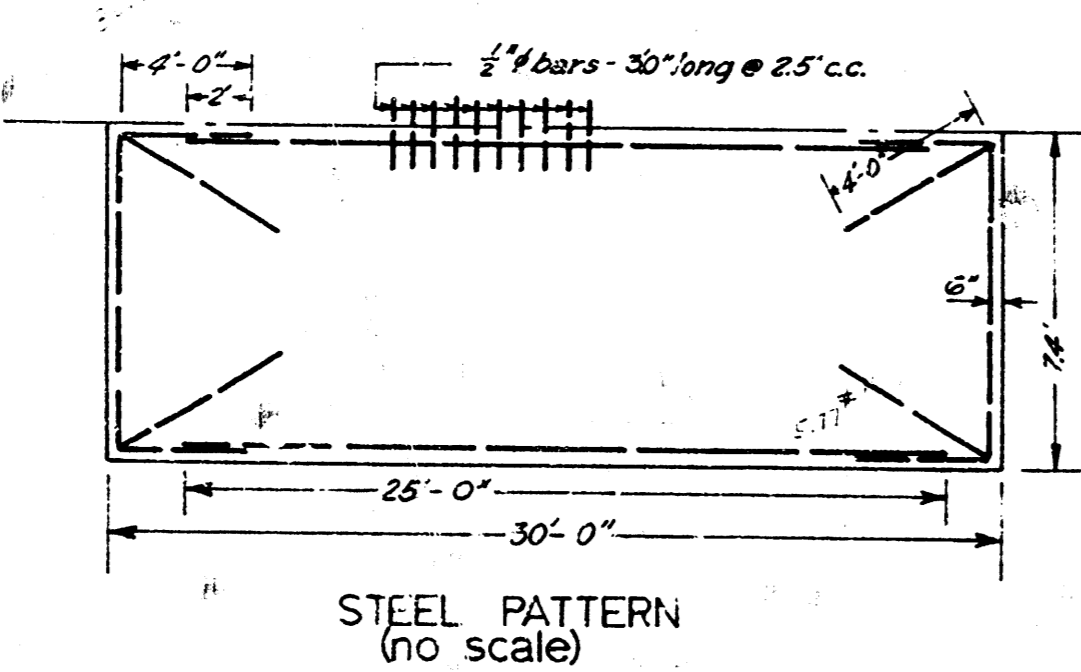

Earthwork  
 Prod. 358.9  
 34.0 110%  
 355.3 Cu.yds.  
 City 2.0  
 0.2 10%  
 2.2 Cu.yds.

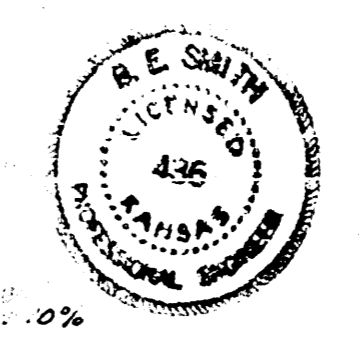

ALLEY BETWEEN PENNSYLVANIA & NEW YORK	
N.L. FIRST STREET to S.L. SECOND STREET	
14'8"-7" Concrete	
Dept. of Public Works - Engineering Division CITY OF WICHITA, KANSAS	
B.E. Smith	City Engineer
Date: APRIL 1952	Proj. No C11-68