

Sheet C.H. 108
 128
 Tandy
 11

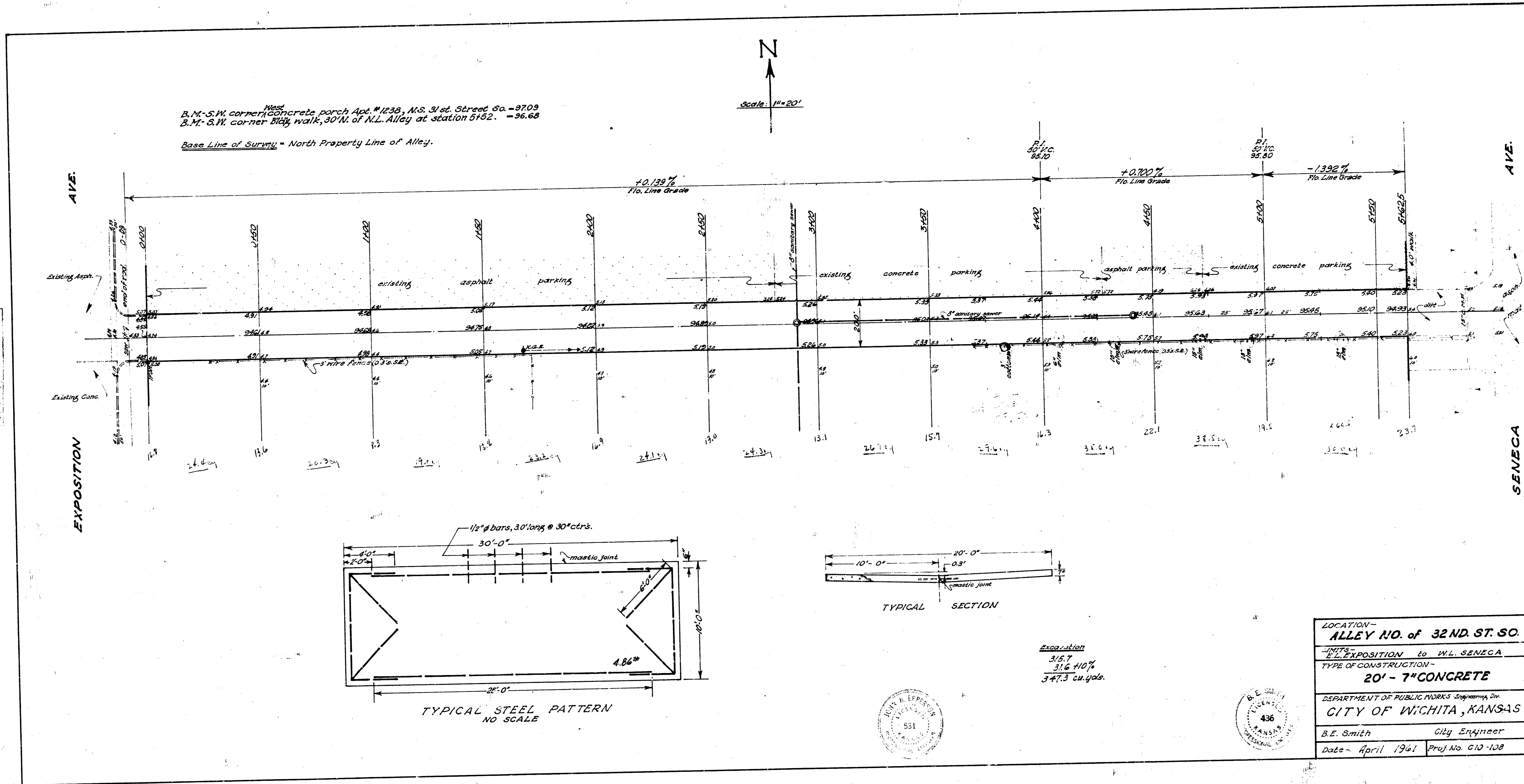

West
 B.M. S.W. corner concrete porch Apt. #1230, N.G. 31st Street So. - 97.09
 B.M. S.W. corner Bldg. walk, 30' W. of N.L. Alley at station 5152. - 96.68
 Base Line of Survey = North Property Line of Alley.

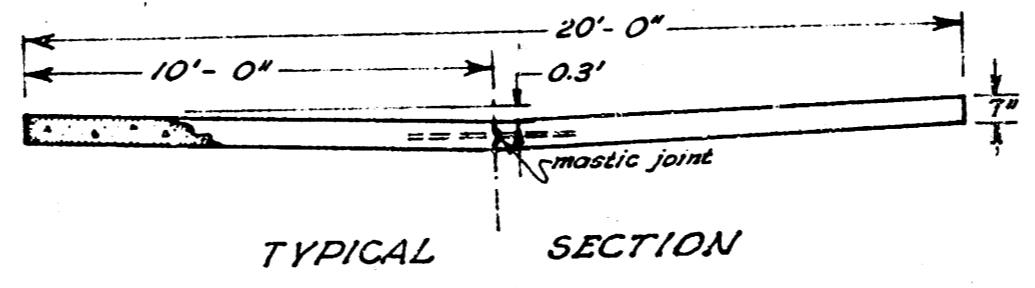
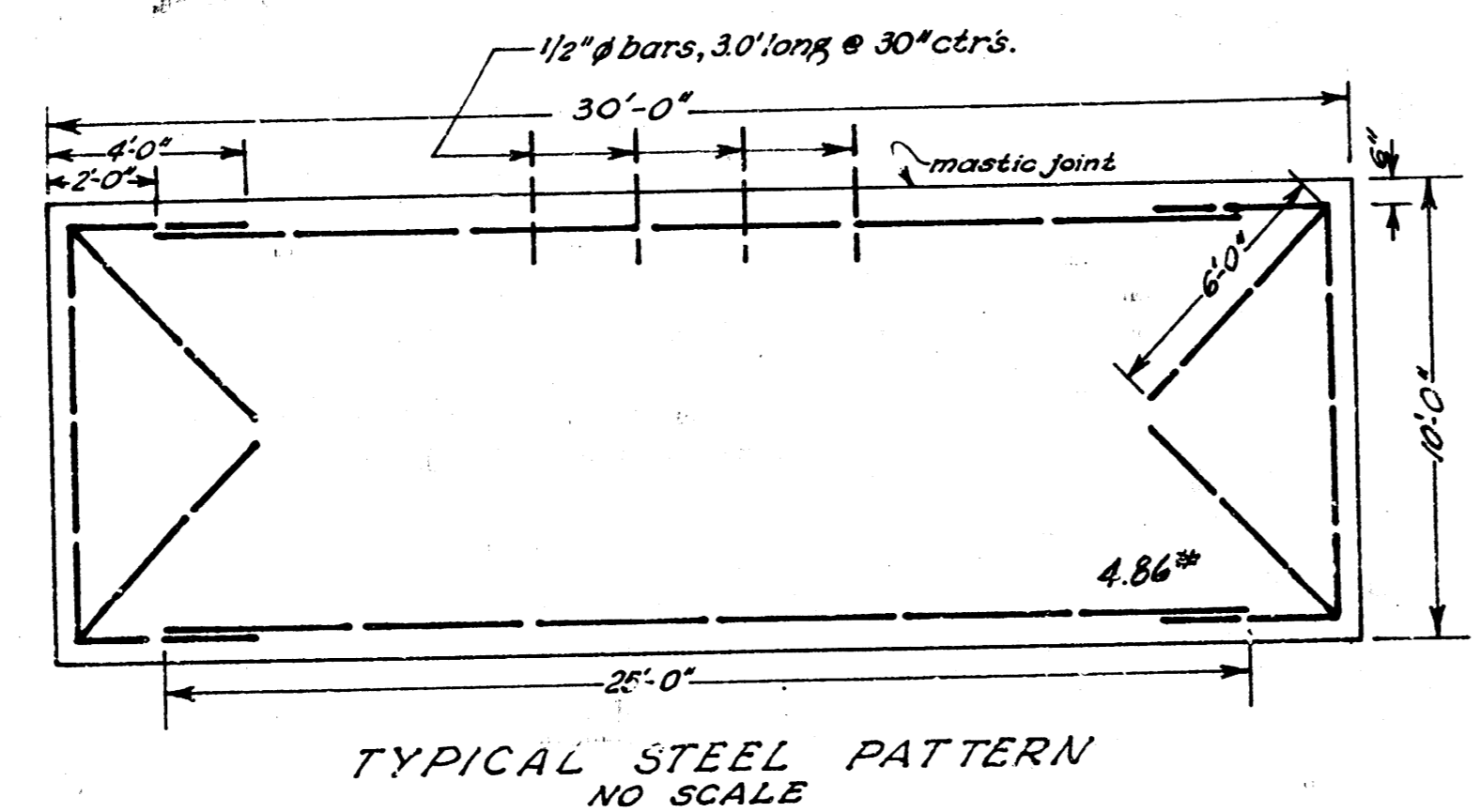
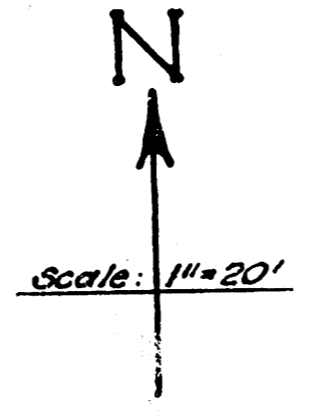

Excavation
 315.7
 31.6 10%
 347.3 cu. yds.

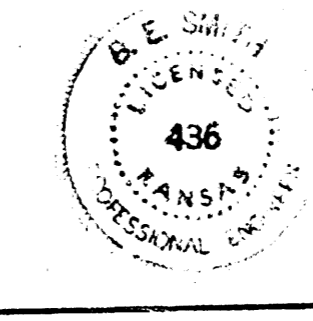

LOCATION -	ALLEY NO. of 32ND ST. SO.
TYPE OF EXPOSITION	to W.L. SENECA
TYPE OF CONSTRUCTION -	20' - 7" CONCRETE
DEPARTMENT OF PUBLIC WORKS - Engineering Div.	
CITY OF WICHITA, KANSAS	
B.E. Smith	City Engineer
Date - April 1961	Proj. No. C10-108