

B.M. 104.86 Top Iron in Tim. & Hydraulic
 B.M. 104.60 "4" on Conc. & Alley f & Orme

Chain N. on &

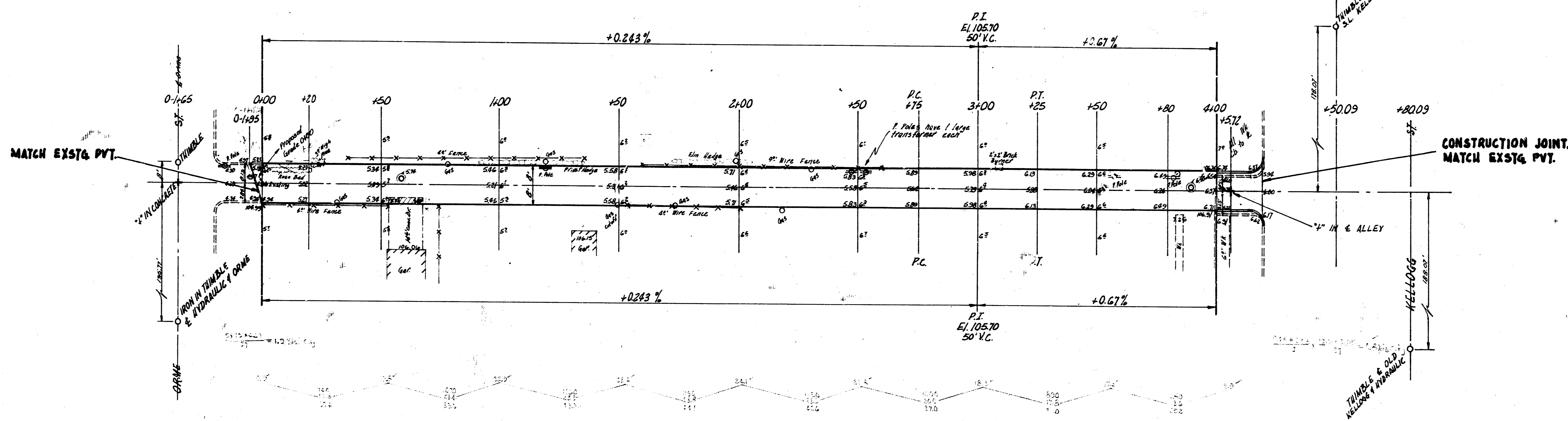
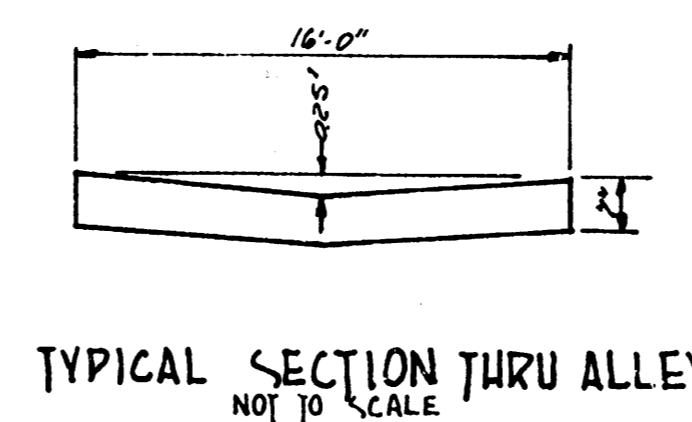
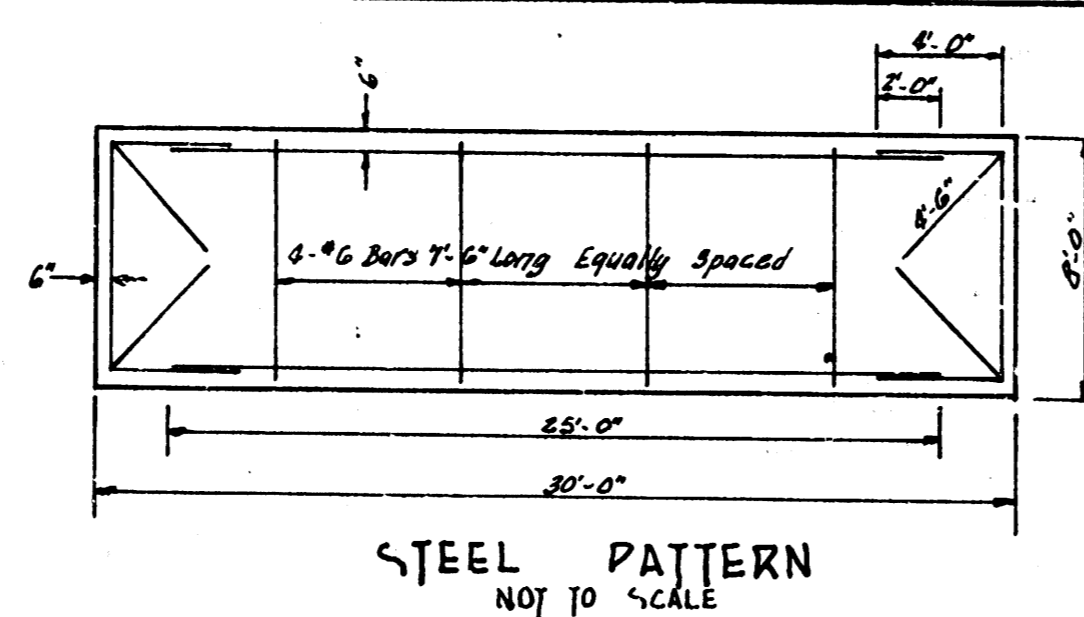

E.L. KELLOGG
 CIVIL ENGINEER
 142
 142

ALLEY BETW'N GREENWOOD & HYDRAULIC
 WL ORME - SL KELLOGG
 7" CONC. - 16' WIDE
 CITY OF WICHITA, KANS.
 B.E. SMITH CITY ENGINEER
 Aug 1955 PROJ. NO. C15-161

TOTAL EXCAV.	
2200	217
157.0	21
107.0	40.5
327.7 Cu Yds	5.0 Cu Yds

