

BM 15045 "G" in Glade E of Elpyco St Harry
 BM 14634 Walk SW Corner of Glendale 32C West Alley

Sta on E

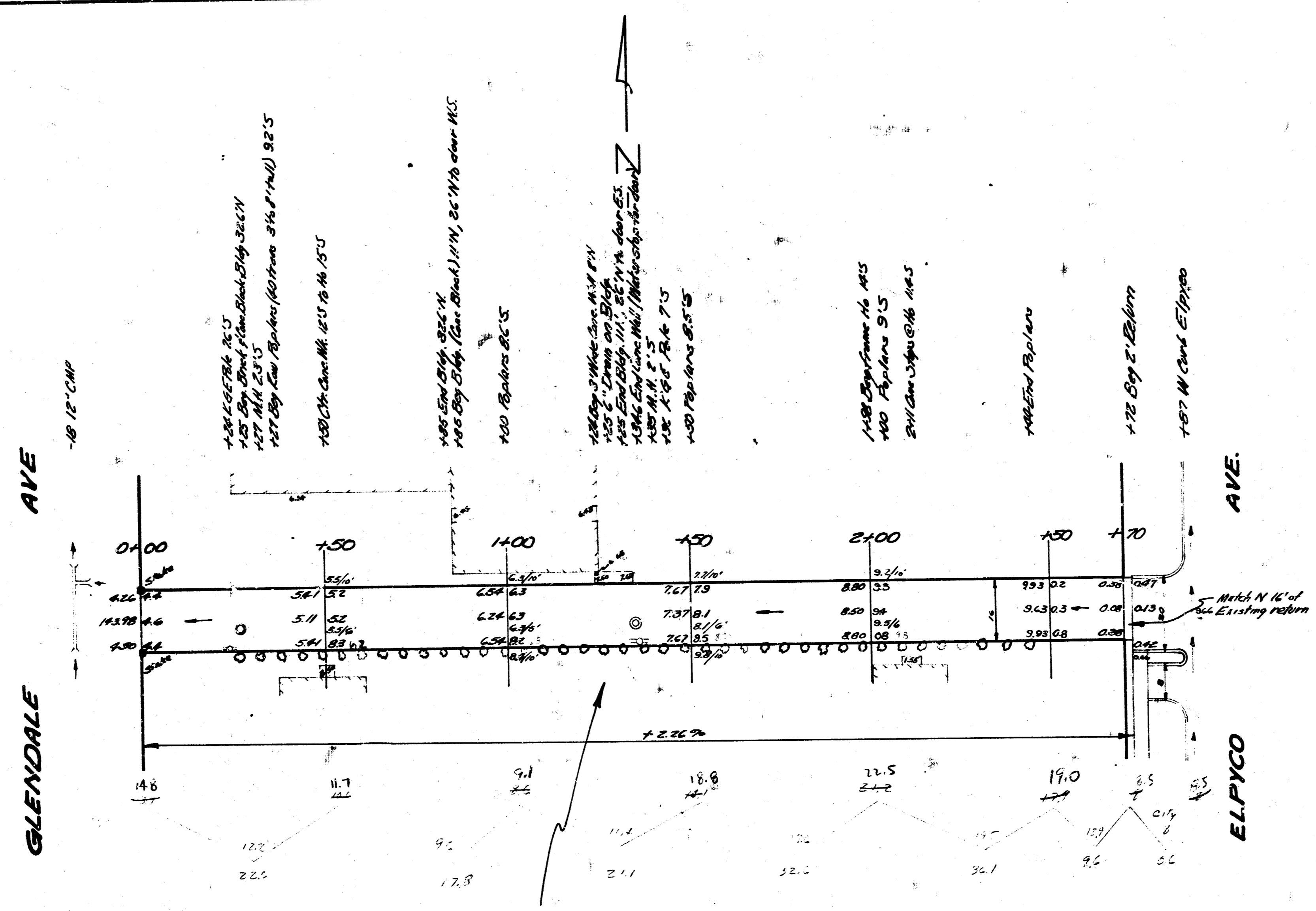

NOTE
 Do not disturb trees without owners permission.

Checked by
 Drawn by
 Examined by
 Checked by

ALLEY S. OF HARRY
 EL GLENDALE TO WL ELPYCO
 6" CONCRETE - 16' WIDE
 CITY OF WICHITA
 B. E. SMITH CITY ENGINEER
 SEPT 1953 Plan C13-149

