

Submitted by
 Checked by

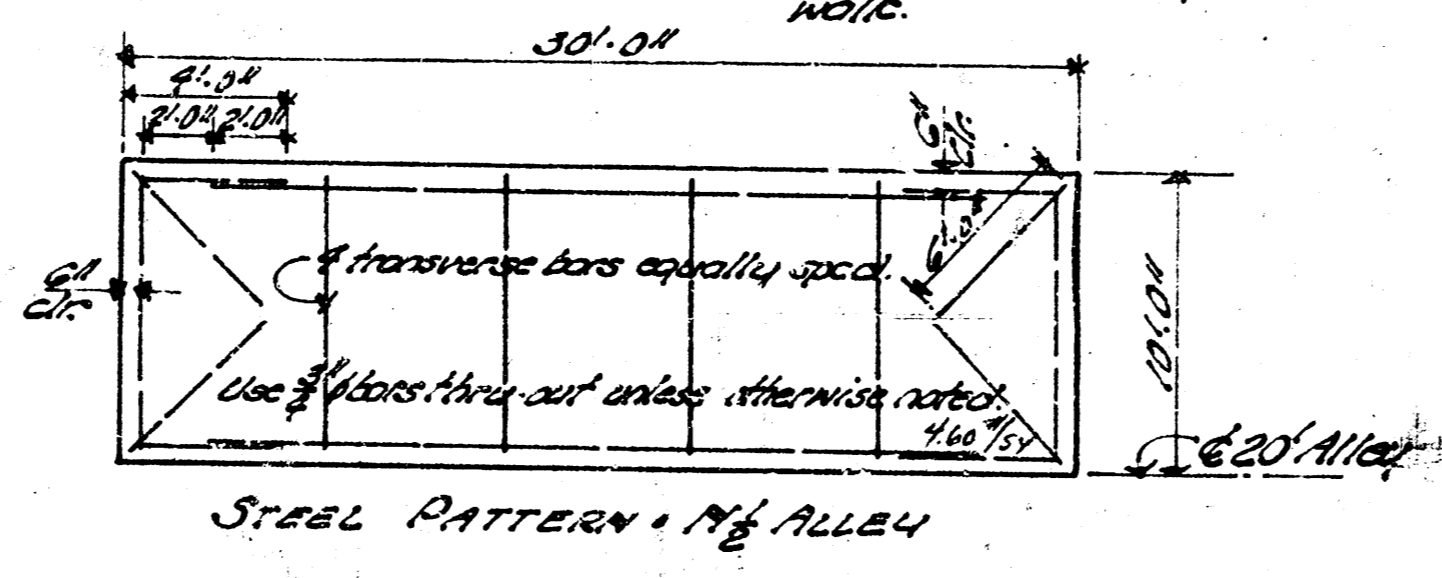
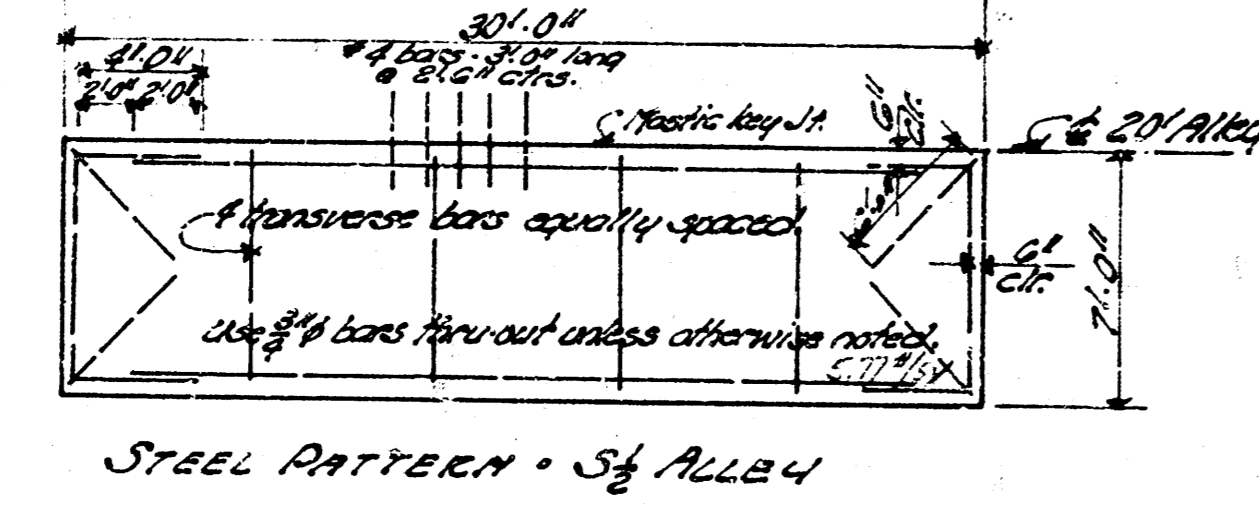
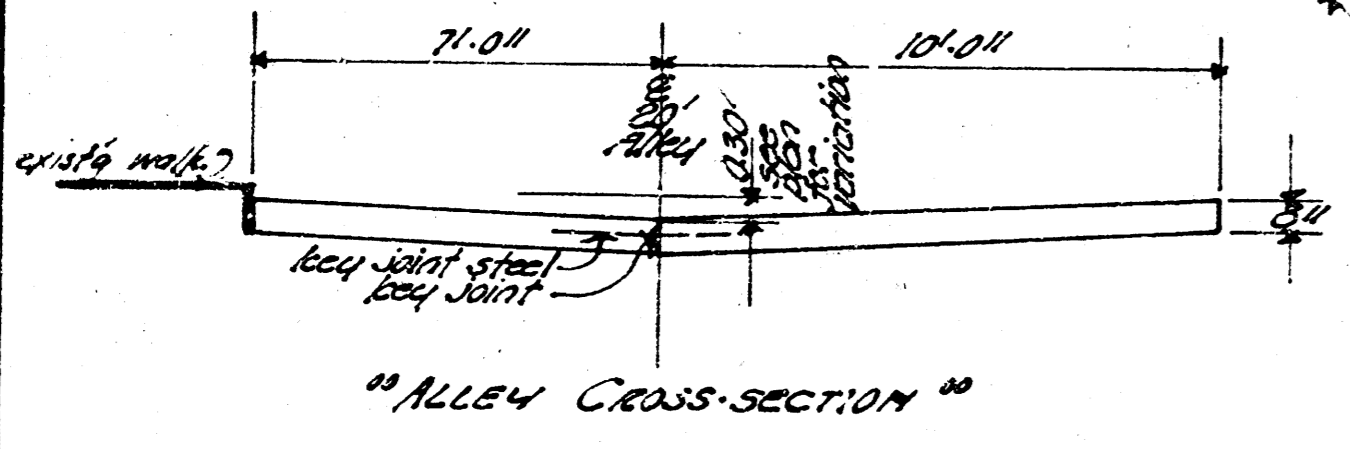
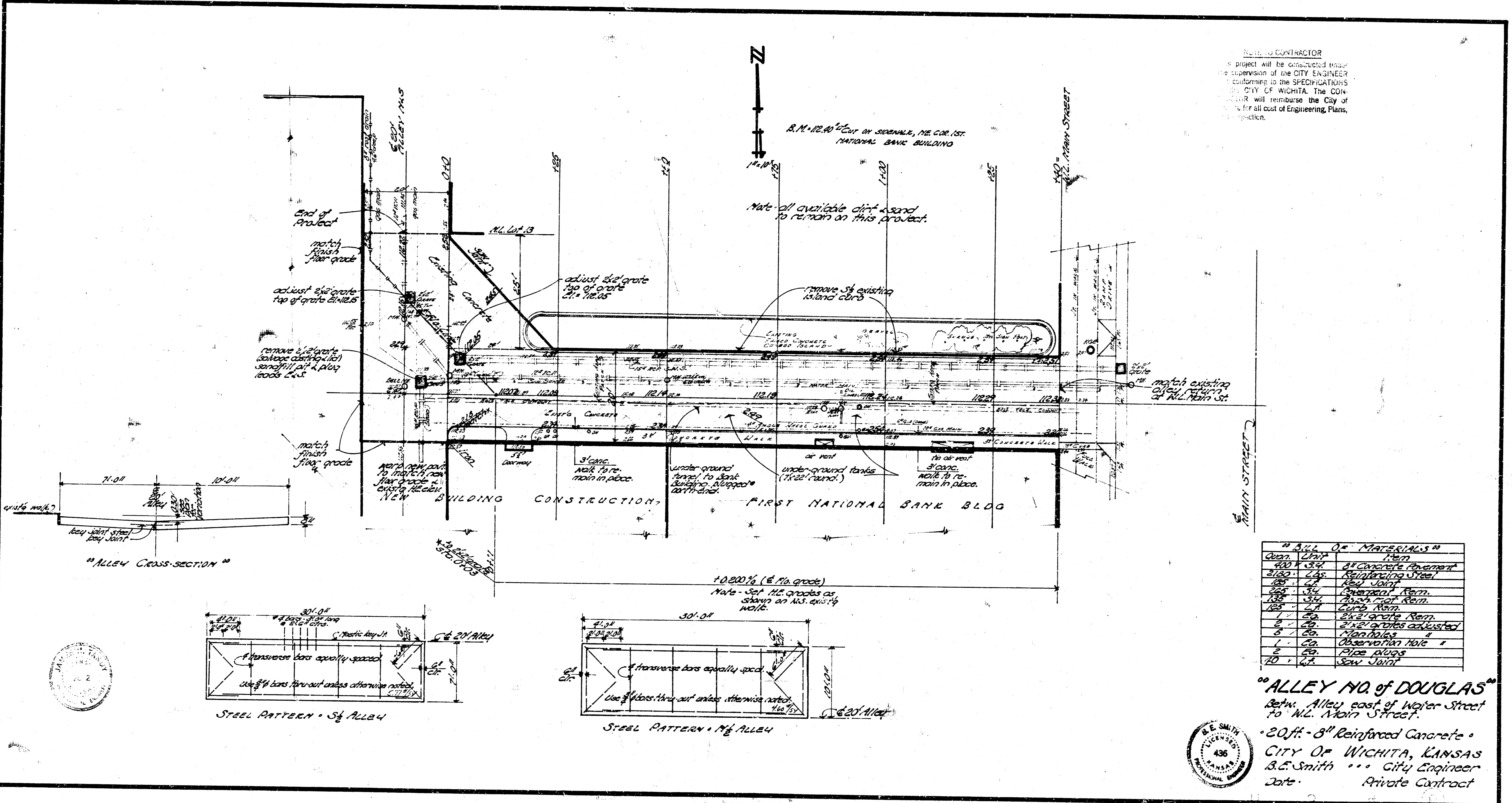

NOTE TO CONTRACTOR
 This project will be constructed under the supervision of the CITY ENGINEER conforming to the SPECIFICATIONS of the CITY OF WICHITA. The CONTRACTOR will reimburse the City of Wichita for all cost of Engineering, Plans, and Inspection.

"BILL OF MATERIALS"

Quan.	Unit	Item
400	cu yd	Concrete (Placement)
2100	lb	Reinforcing Steel
100	lb	Red Joint
100	lb	Special Form
100	lb	Form Release
100	lb	Curb Form
1	ea	2' x 2' concrete Rem.
2	ea	2' x 2' concrete adjusted
1	ea	Manhole
1	ea	Observation Hole
2	ea	Place plugs
10	ea	Sew Joint

"ALLEY NO. OF DOUGLAS"
 Betw. Alley east of Water Street
 to W.L. Main Street.
 • 20ft - 8" Reinforced Concrete •
 CITY OF WICHITA, KANSAS
 B.E. Smith ... City Engineer
 Date: Private Contract

