

B.M. 118.23 R.R. Spt. W.S. Power Pole, 271' N. of N.L. Toff, 12'E. & Alley Btwn Illinois & West
 3. M. 115.91 " & Alley Btwn Illinois & West, 100' N. of N.L. Toff
 3. M. 115.89 " S. Face 42" Wk. E. & W., S. Side Toff, 12.2' E. of E.L. West St.
 3. M. 117.01 West St. & U.S. 54 HWY, City Std. Disc. on W.S. Btwn Slabs, 45' N. & W. of & Both
 3. M. 117.00 West St. & Maple, City Std. Disc., 42' E. & 40' N. of & Both

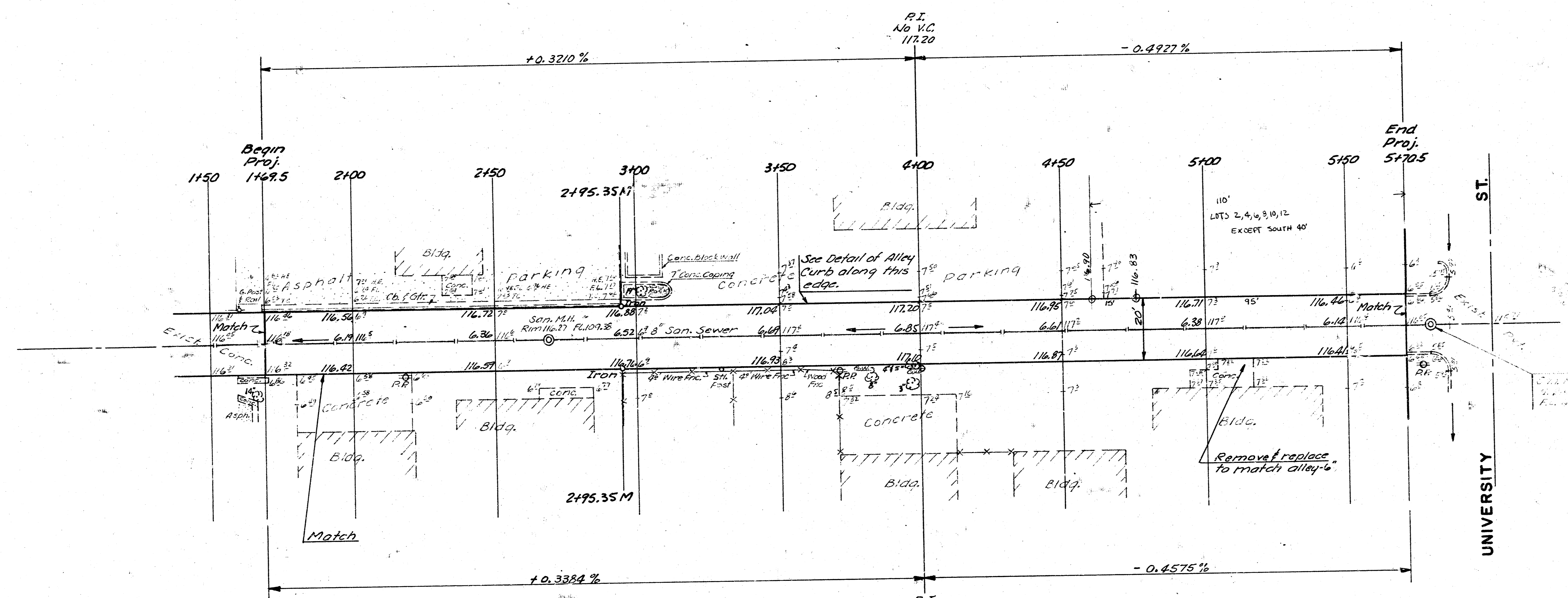
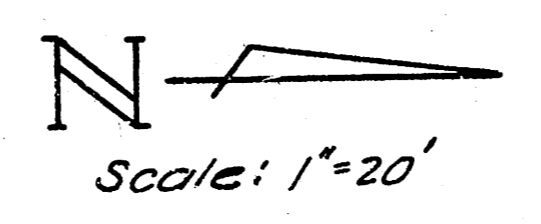

Earthwork

Excav
 Prop. 286.1 C.Y.
 410% 28.6
 Total 314.7 C.Y.

Manipulation = 891.1 S.Y.

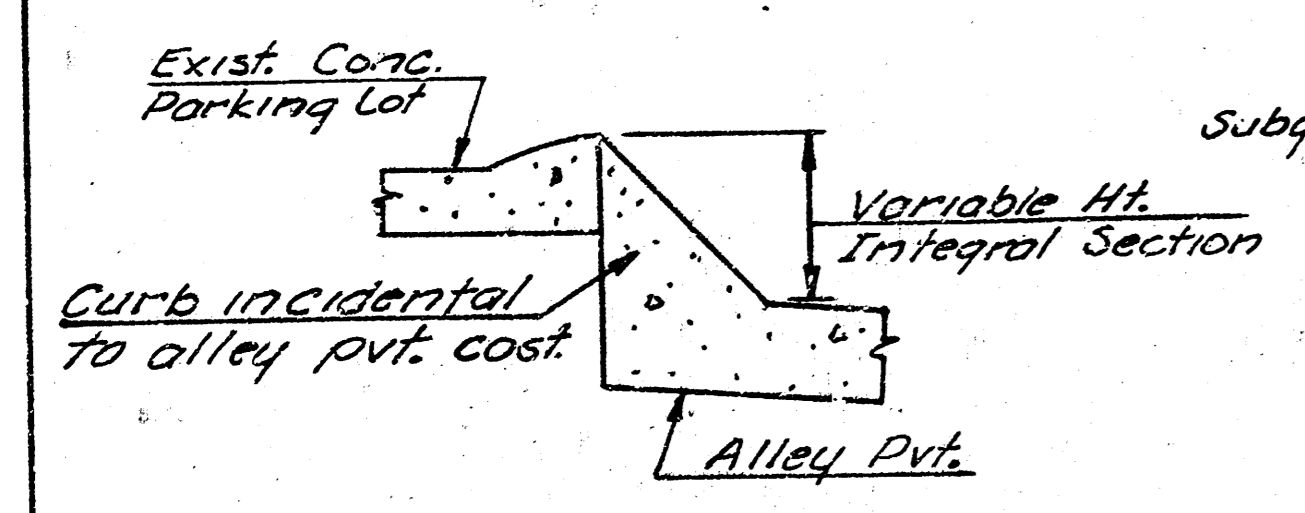

DETAIL - ALLEY CURB - W.S.
 STA. 2+95.35 TO STA. 4+68.4
 No Scale

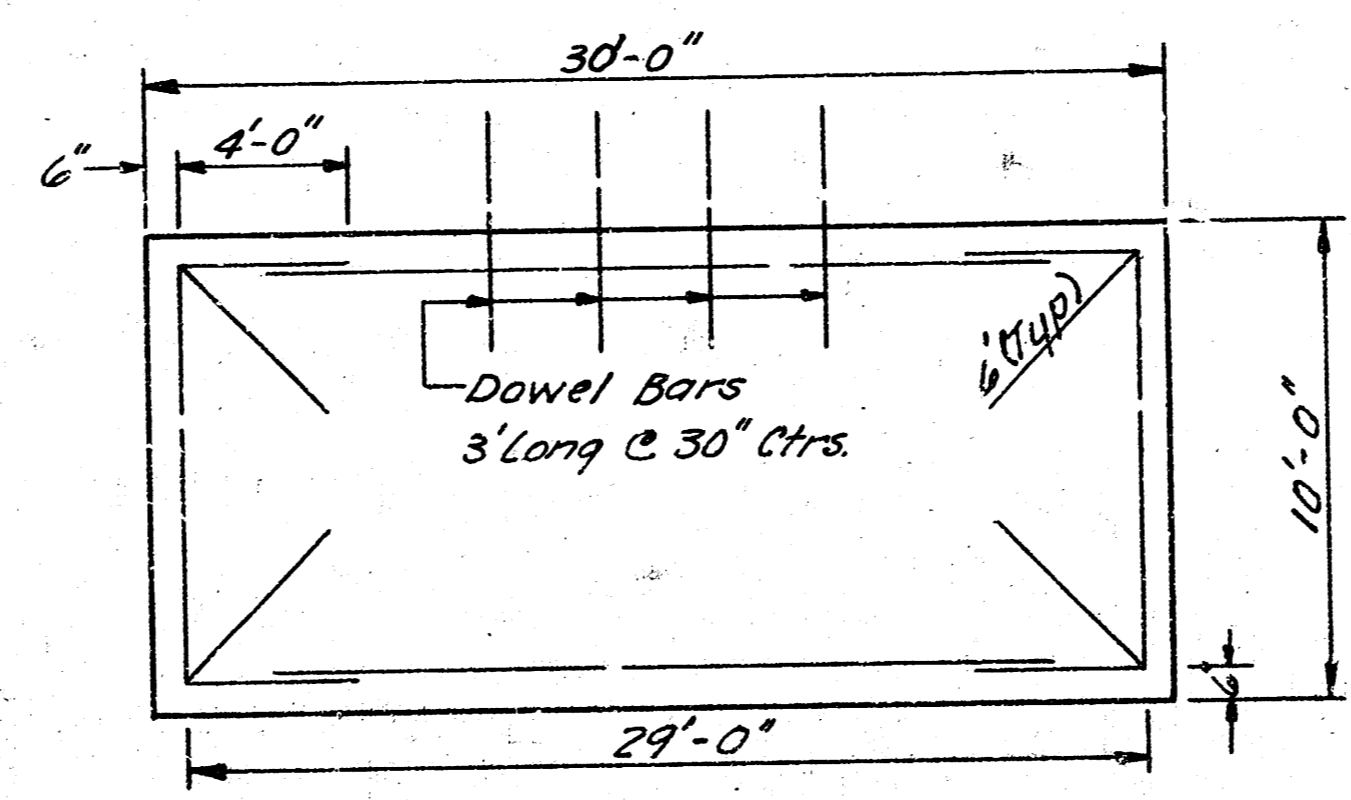
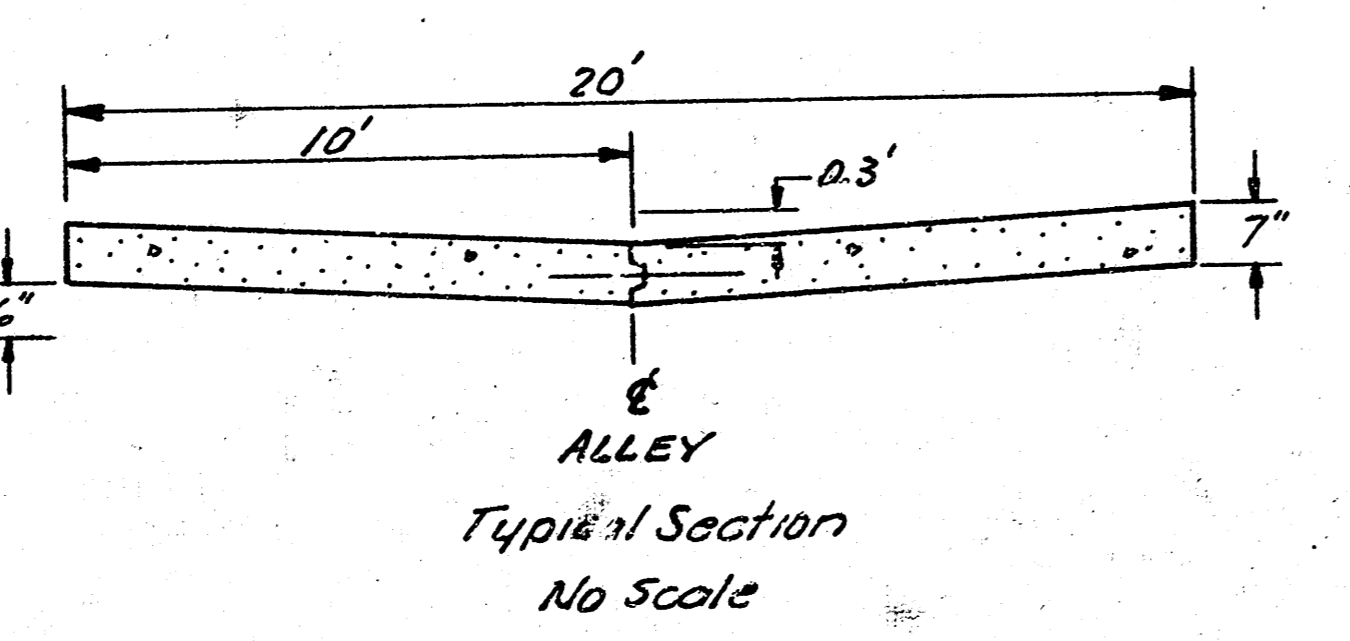

TYPICAL STEEL PATTERN
 No Scale
 (all bars to be No.6)

SUBGRADE
 TYPE OF SUB-GRADE TREATMENT SHALL BE DETERMINED BY THE FIELD ENGINEER. SUB GRADE TREATMENT MAY CONSIST OF LIVE TREATMENT, CEMENT TREATMENT, SUB-GRADE MODIFICATION, OR ANY COMBINATION OF THESE.

THE CONTRACTOR SHALL BE RESPONSIBLE FOR PRESERVING PROPERTY RIGHTS. THE CONTRACTOR SHALL BE REQUIRED TO RE-ESTABLISH ANY TAG EARTHWORKS WHICH ARE DAMAGED OR DESTROYED BY HIS CONSTRUCTION. SUCH DAMAGE SHALL BE REPAIRED BY A LICENSED LAND SURVEYOR OR A LICENSED PROFESSIONAL ENGINEER IN ACCORDANCE WITH STATE LAWS.

ALLEY BETWEEN WEST AND ILLINOIS
 S.L. LOTS 31 & 32, BLK. 5, QUINCY ADDN, TO
 S.L. UNIVERSITY
 CITY OF WICHITA, KANSAS
 R.W. BRUGGEMAN, DIR. ENGINEERING/CITY ENGINEER
 PROJ. NO. 472 76 245 81057 000 000 001

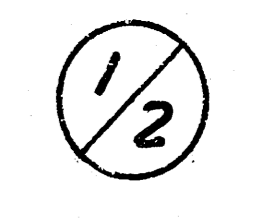

Survey B.C.
 Plan D.F.C.
 E.K.
 Checked