

B.M. 13.72 4' in G.C. E. of Jeannette W. 13TH ST.
 B.M. 124.01 W. cor. NW Wing 13th St. bridge (Minisq)
 Stationing of base line on E Alley from Sta 0+00 to 1+50.

SCALE 1" = 10'

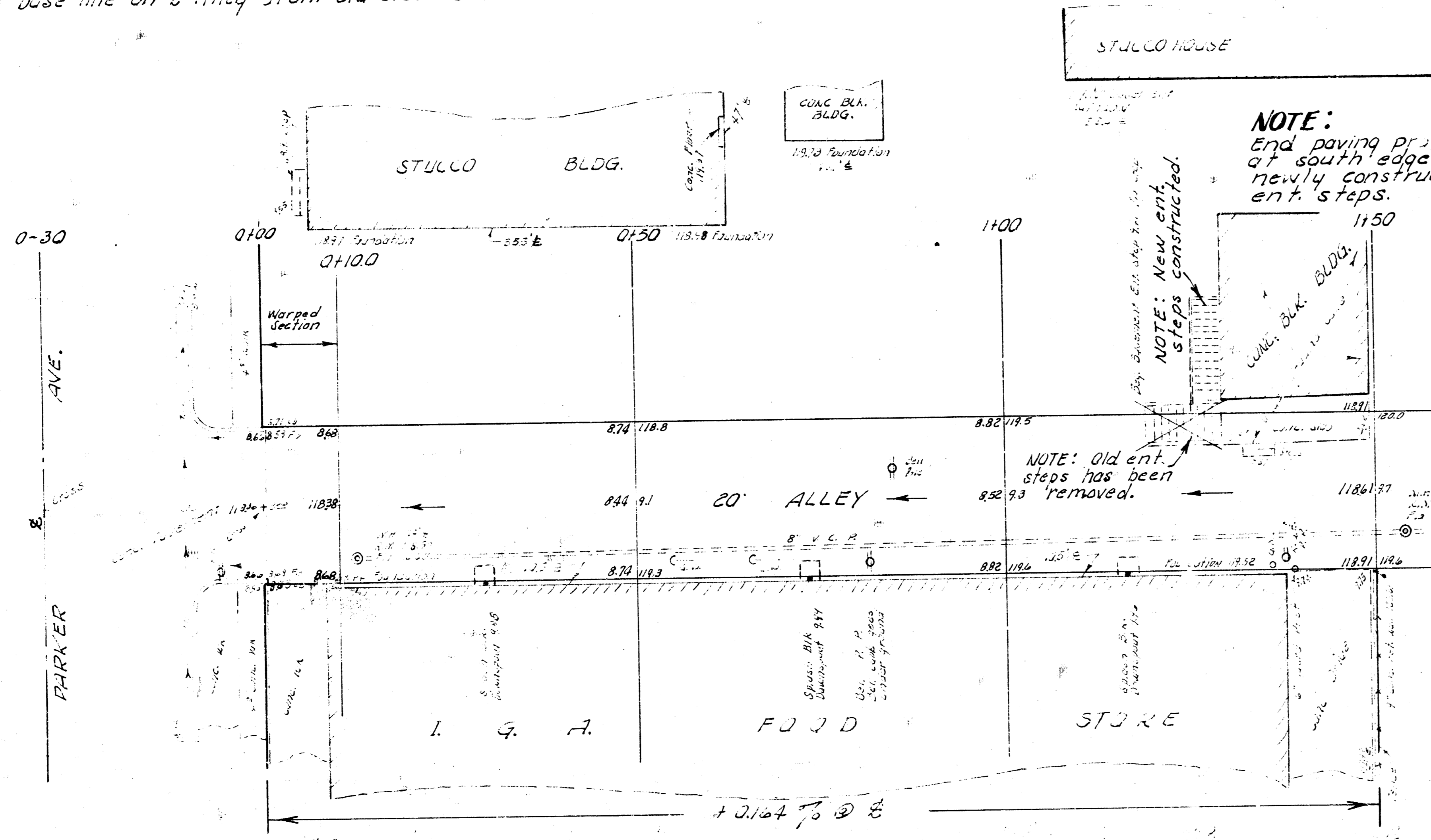

ESTIMATED QUANTITIES*	
* 277.8	Sq. Yd. 6" Conc.
1875.0	Lbs. Reinf. Steel
101.4	Cu. Yd. Excavation
125.0	Lin. Ft. of Mastic Joint
1.93	Cu. Yds. Conc.
1.93	Cu. Yds. Special Excav.

*NOTE: Quantities estimated for 125 lin. ft. of pavement.

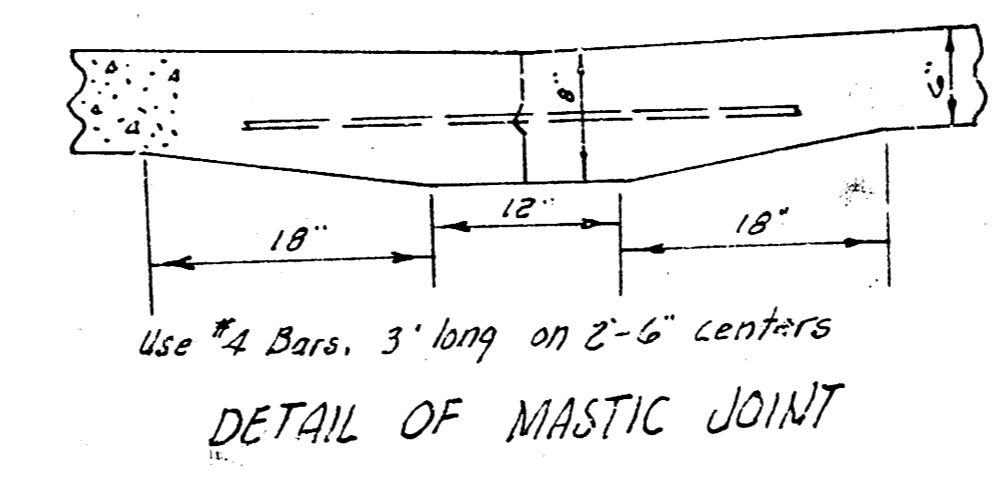
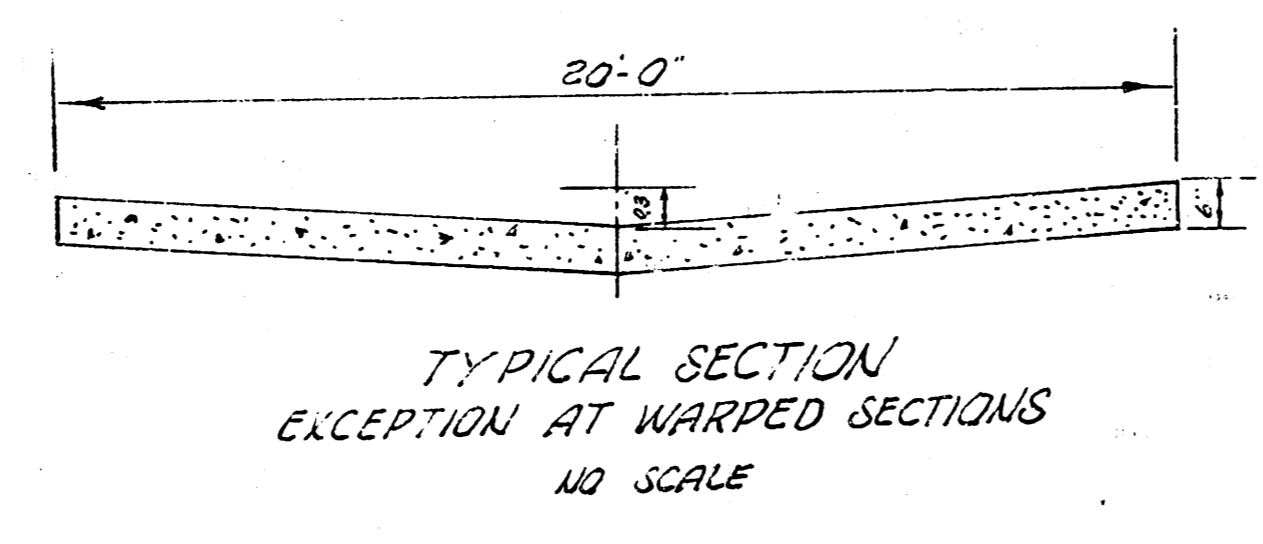
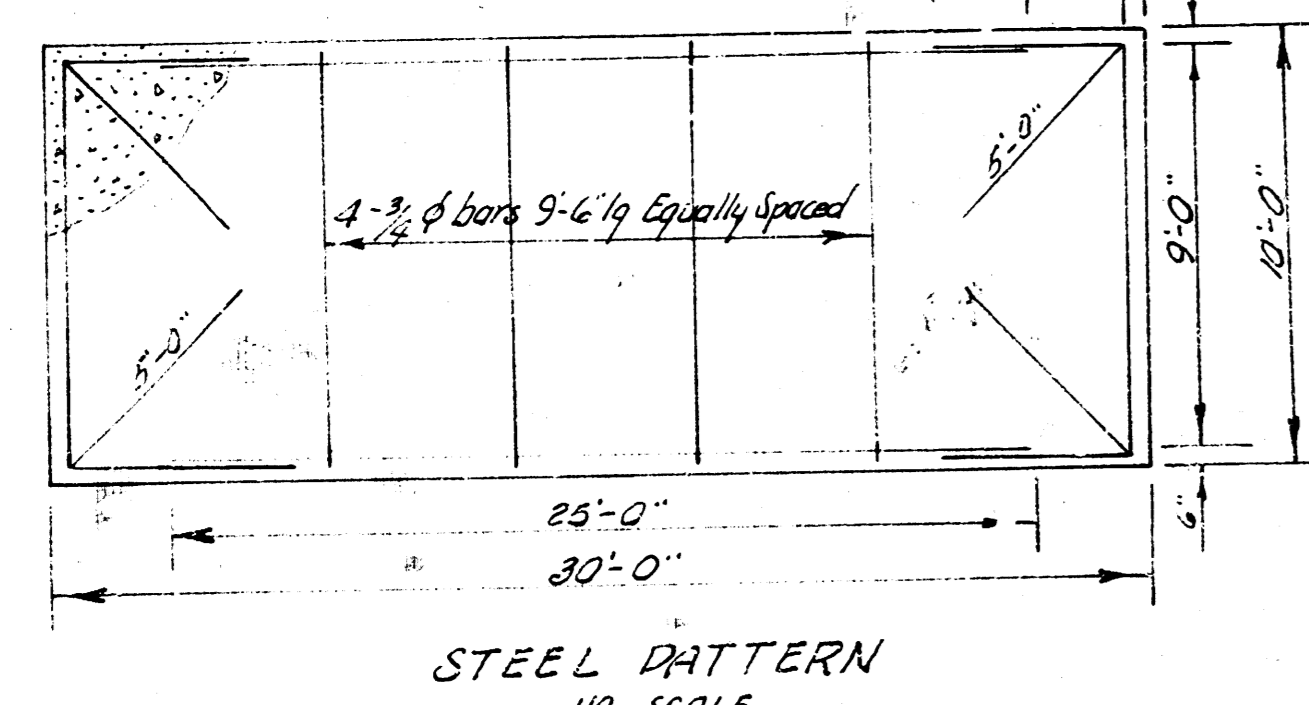

ALLEY
 BETW. WOODLAND AVE. & JEANNETTE AVE.
 NW PARKER AVE. TO 125' W. OF NW PARKER AVE.
 20' CONC. - 6"
 CITY OF WICHITA, KANSAS
 B. E. SMITH - CITY ENGINEER
 JAN. 1959, PRIVATE CONTRACT

